

Legend

- RL- 66.27  
PROPOSED LEVEL  
PROPOSED POOL COPING  
GARDEN AREA  
LAWN AREA  
DECK  
EXISTING DRIVEWAY  
TREE TO BE RETAINED  
EXISTING RETAINING WALL



THIS PLAN IS TO BE READ IN  
CONJUNCTION WITH  
THE CONDITIONS OF DEVELOPMENT  
CONSENT

DA2019/0990

SWIMMING POOL FILTRATION EQUIPMENT  
WITHIN ACOUSTIC CONTROLLED  
STRUCTURE

PROPOSED POOLSIDE CABANA

POOL ACCESS GATE

1800mm HIGH POOLSAFE  
BOUNDARY FENCING -  
FENCE SHALL BE 1.8m HIGH  
AND COMPLIANT TO  
AS1926.1-2012

SWIMMING POOL SAFETY FENCE  
AND GATE - POOL FENCE SHALL  
BE 1.2m HIGH AND COMPLIANT TO  
AS1926.1-2012

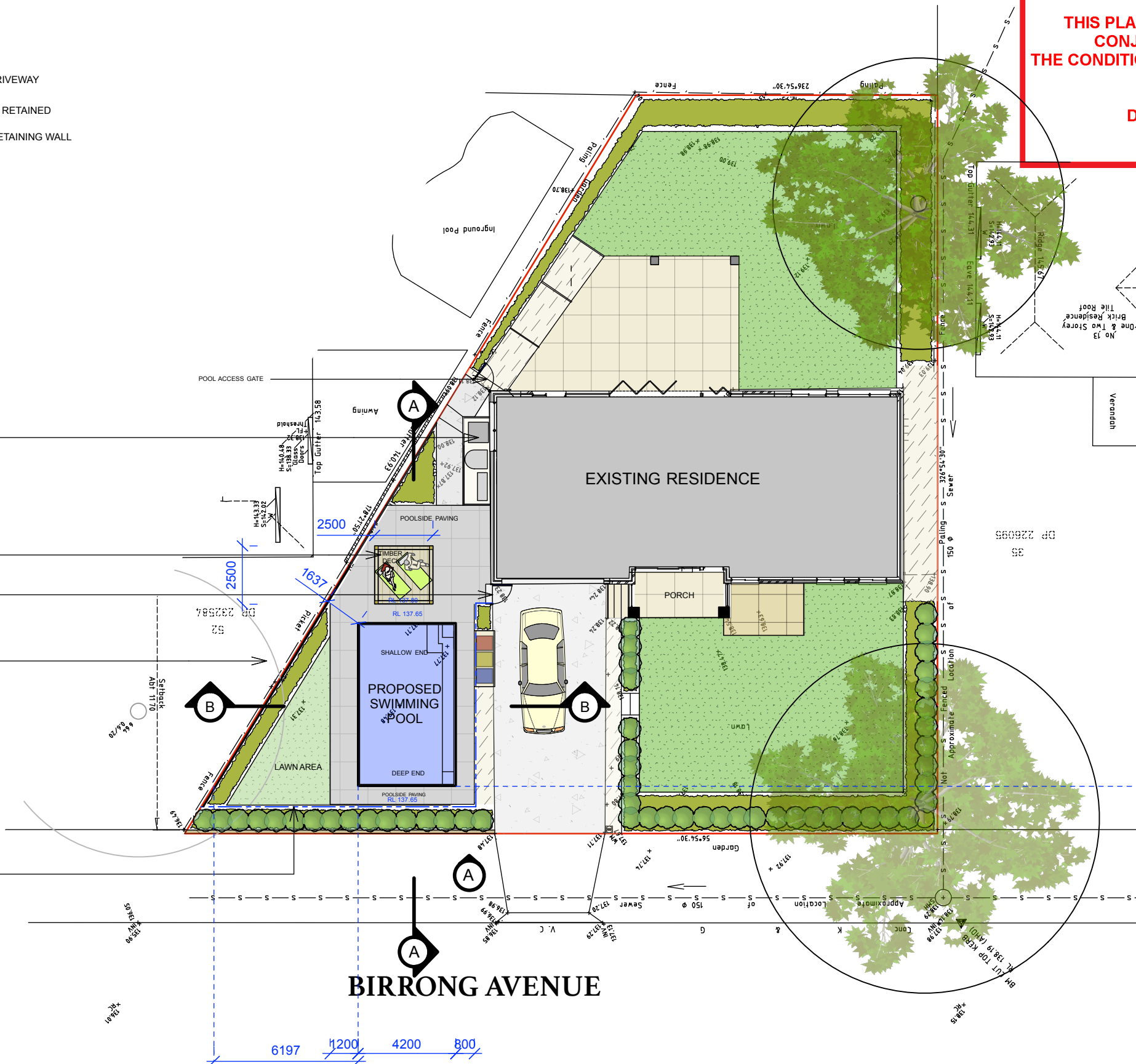

BIRRONG AVENUE

CONTOUR  
LANDSCAPE ARCHITECTURE

PO Box 698 MONA VALE NSW 1660  
Tel: 0434 500 705 - AIDLM

PROJECT  
**Ami Cook**

No.15 Birrong Avenue,  
Belrose, NSW 2085

DATE  
26/08/19  
02/09/19  
REV. ISSUE  
A PRELIMINARY  
B DA

NOTES

comply with building code of australia and all relevant australian standards  
all works shall be in accordance with development application and construction certificate conditions of consent  
all levels to and  
refer to survey information relating to existing site data  
verify all dimensions prior to works  
do not scale from drawings  
use figured dimensions in preference to scaling  
refer all discrepancies to landscape architect for determination  
this drawing is copyright and must not be retained, copied, used or reproduced in any way without prior written permission of  
contour landscape architects.

DATE: 04/09/19

SCALE: 1:200 @ A3

DRAWN: SW

DRAWING  
**SITE PLAN**

DRAWING NO:  
C1\_N

REV:  
B





<u>DATE</u>	<u>REV.</u>	<u>ISSUE</u>
26/08/19	A	PRELIMINARY
02/09/19	B	DA

## NOTES

comply with building code of australia and all relevant australian standards  
all works shall be in accordance with development application and construction certificate conditions of consent  
all levels to and  
refer to survey information relating to existing site data  
verify all dimensions prior to works  
do not scale from drawings  
use figured dimensions in preference to scaling  
refer all discrepancies to landscape architect for determination  
this drawing is copyright and must not be retained, copied, used or reproduced in any way without prior written permission of

**DRAWING**  
**POOL PLAN**

DRAWING NO:  
C2\_N

REV:  
B





THIS PLAN IS TO BE READ IN  
CONJUNCTION WITH  
THE CONDITIONS OF DEVELOPMENT  
CONSENT  
DA2019/0990

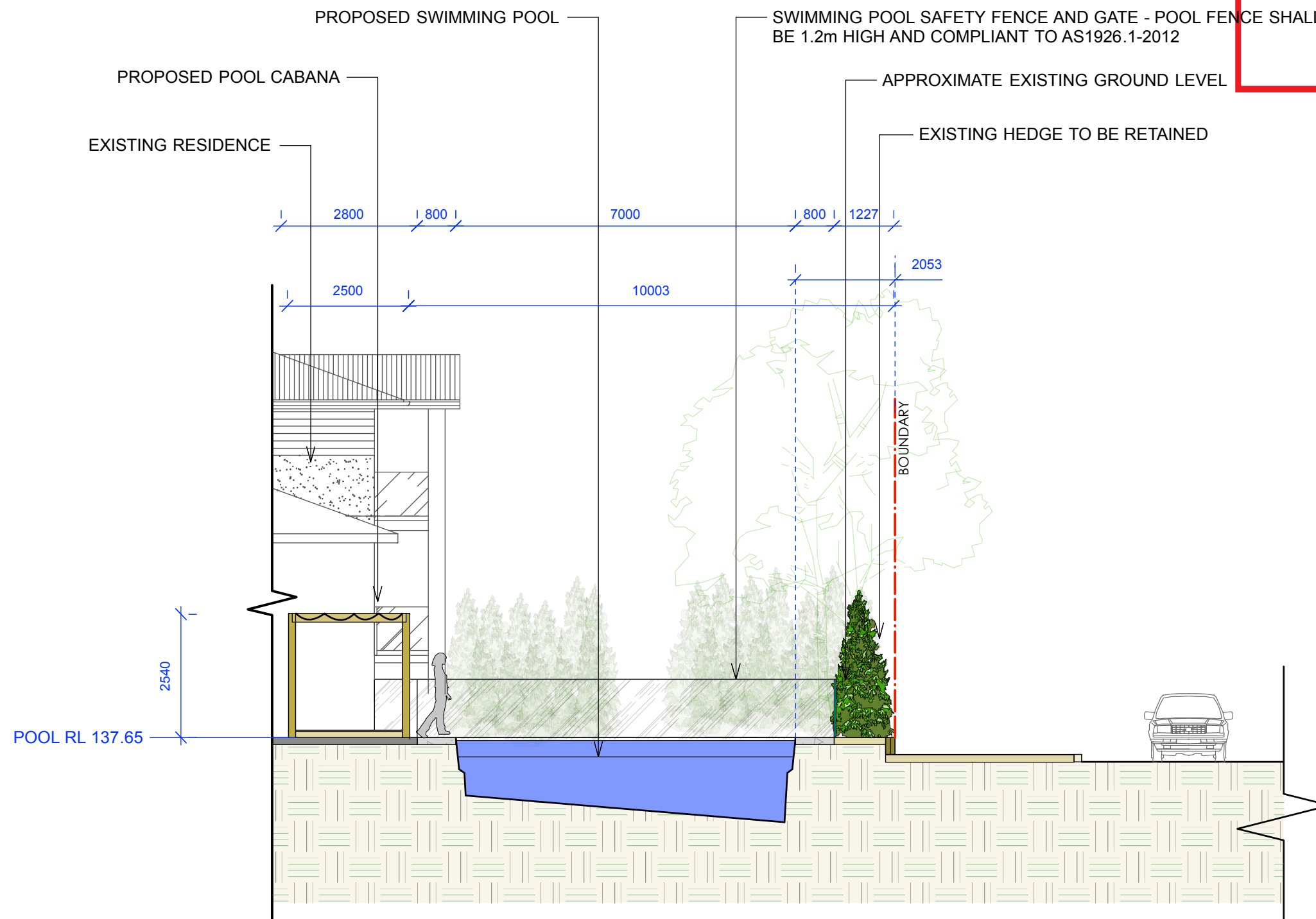

**SECTION AA**  
SCALE 1:100  
(DIAGRAMMATIC ONLY)

CONTOUR  
LANDSCAPE ARCHITECTURE

PO Box 698 MONA VALE NSW 1660  
Tel: 0434 500 705 - AIDLM

PROJECT  
**Ami Cook**

No.15 Birrong Avenue,  
Belrose, NSW 2085

DATE	REV.	ISSUE
26/08/19	A	PRELIMINARY
02/09/19	B	DA

NOTES

comply with building code of australia and all relevant australian standards  
all works shall be in accordance with development application and construction certificate conditions of consent  
all levels to ahd  
refer to survey information relating to existing site data  
verify all dimensions prior to works  
do not scale from drawings  
use figured dimensions in preference to scaling  
refer all discrepancies to landscape architect for determination  
this drawing is copyright and must not be retained, copied, used or reproduced in any way without prior written permission of  
contour landscape architects.

DATE: 04/09/19

SCALE: 1:100 @ A3

DRAWN: SW

DRAWING  
**SECTION A**

DRAWING NO:  
C3\_N

REV:  
B





THIS PLAN IS TO BE READ IN  
CONJUNCTION WITH  
THE CONDITIONS OF DEVELOPMENT  
CONSENT

DA2018/0990

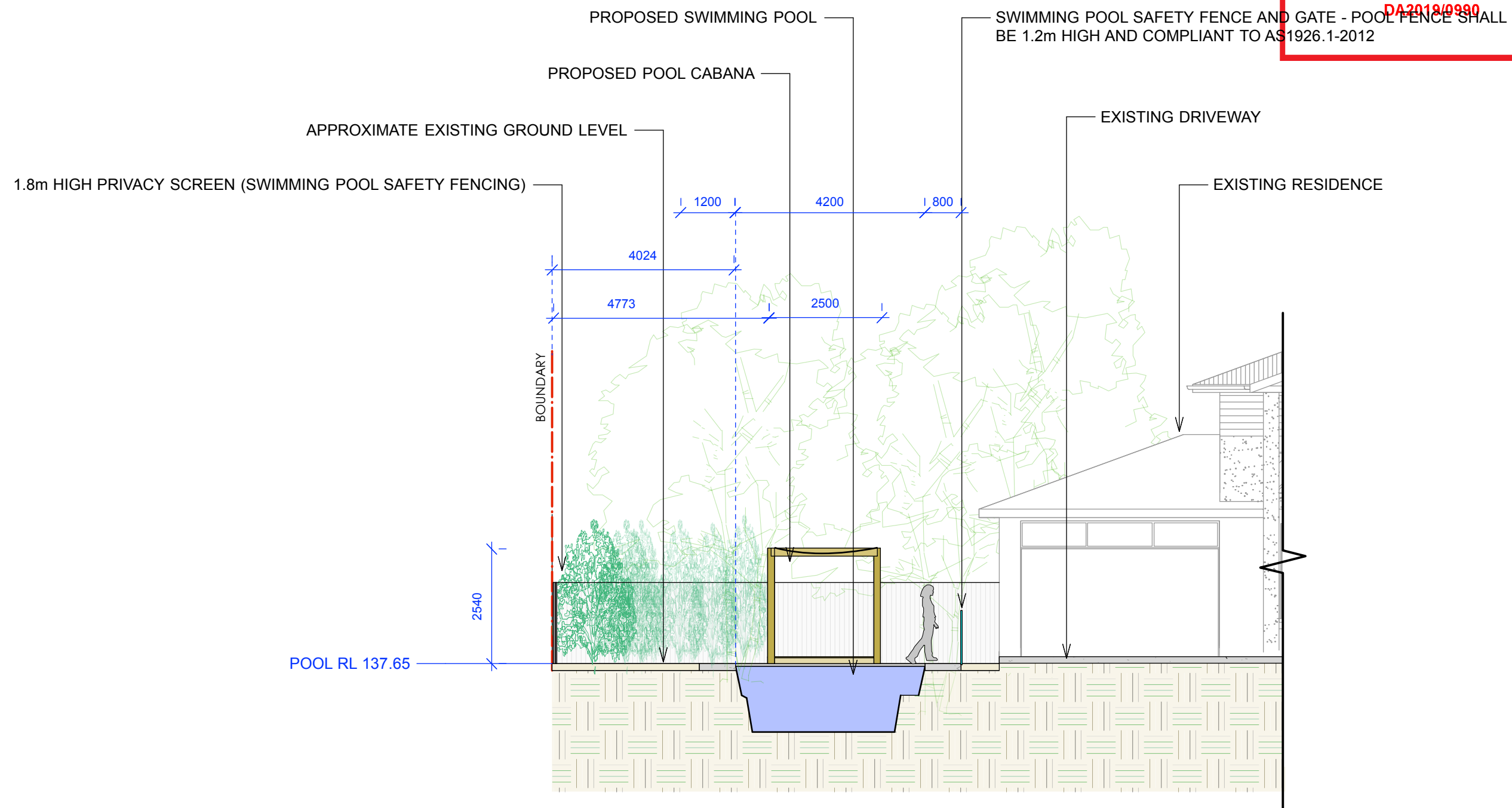

**SECTION BB**  
**SCALE 1:100**  
(DIAGRAMMATIC ONLY)

CONTOUR  
LANDSCAPE ARCHITECTURE

PO Box 698 MONA VALE NSW 1660  
Tel: 0434 500 705 - AIDLM

PROJECT  
**Ami Cook**

No.15 Birrong Avenue,  
Belrose, NSW 2085

DATE	REV.	ISSUE
26/08/19	A	PRELIMINARY
02/09/19	B	DA

NOTES

comply with building code of australia and all relevant australian standards  
all works shall be in accordance with development application and construction certificate conditions of consent  
all levels to ahd  
refer to survey information relating to existing site data  
verify all dimensions prior to works  
do not scale from drawings  
use figured dimensions in preference to scaling  
refer all discrepancies to landscape architect for determination  
this drawing is copyright and must not be retained, copied, used or reproduced in any way without prior written permission of  
contour landscape architects.

DATE: 04/09/19

SCALE: 1:100 @ A3

DRAWN: SW

DRAWING  
**SECTION B**

DRAWING NO:  
C4\_N

REV:  
B





**THIS PLAN IS TO BE READ IN  
CONJUNCTION WITH  
CONDITIONS OF DEVELOPMENT  
CONSENT**

**DA2019/0990**

## ELEVATION A (EXISTING)

SCALE 1:100  
(DIAGRAMMATIC ONLY)

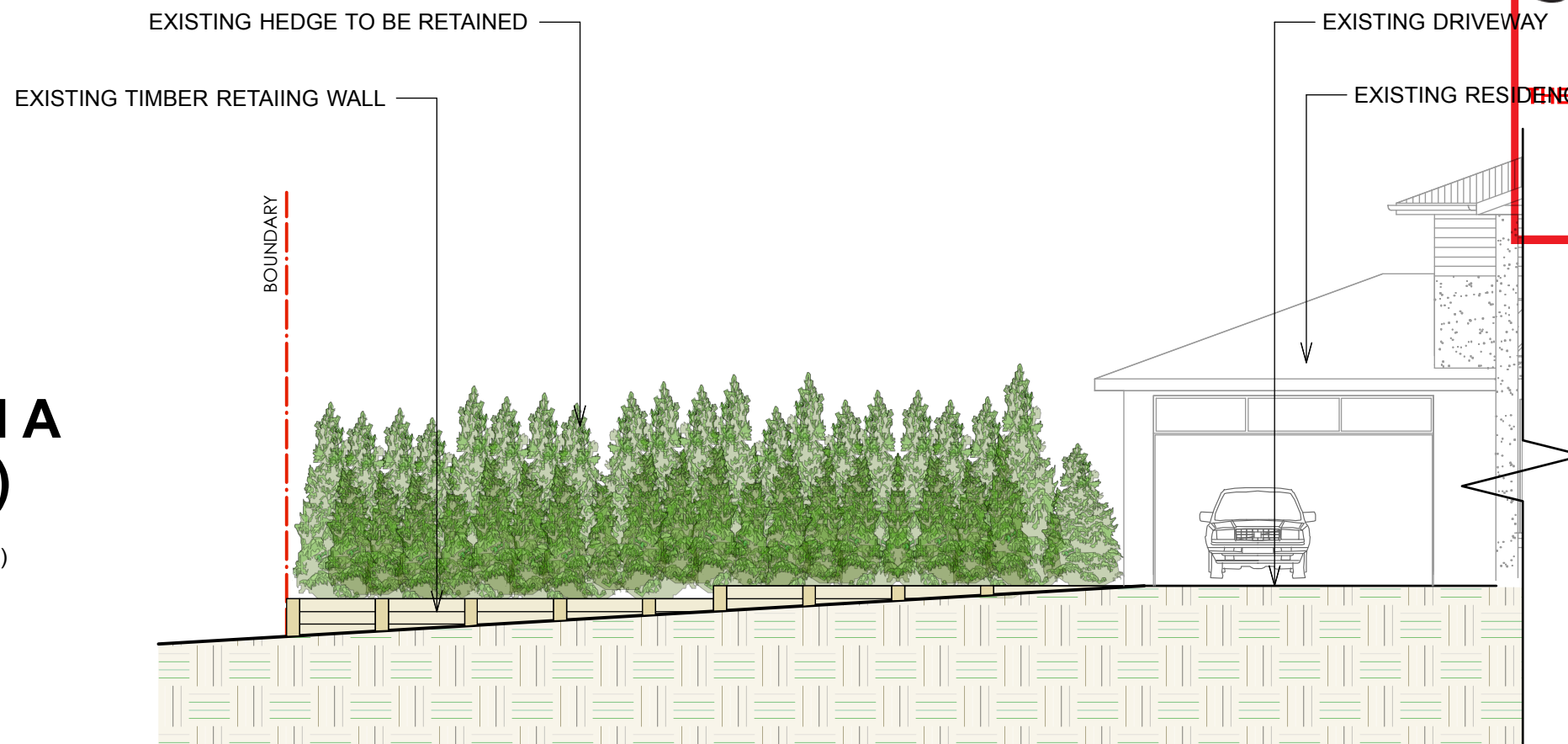

SWIMMING POOL AND CABANA (BEYOND) NOT VISABLE FROM THE STREETScape

## ELEVATION A (PROPOSED)

SCALE 1:100  
(DIAGRAMMATIC ONLY)

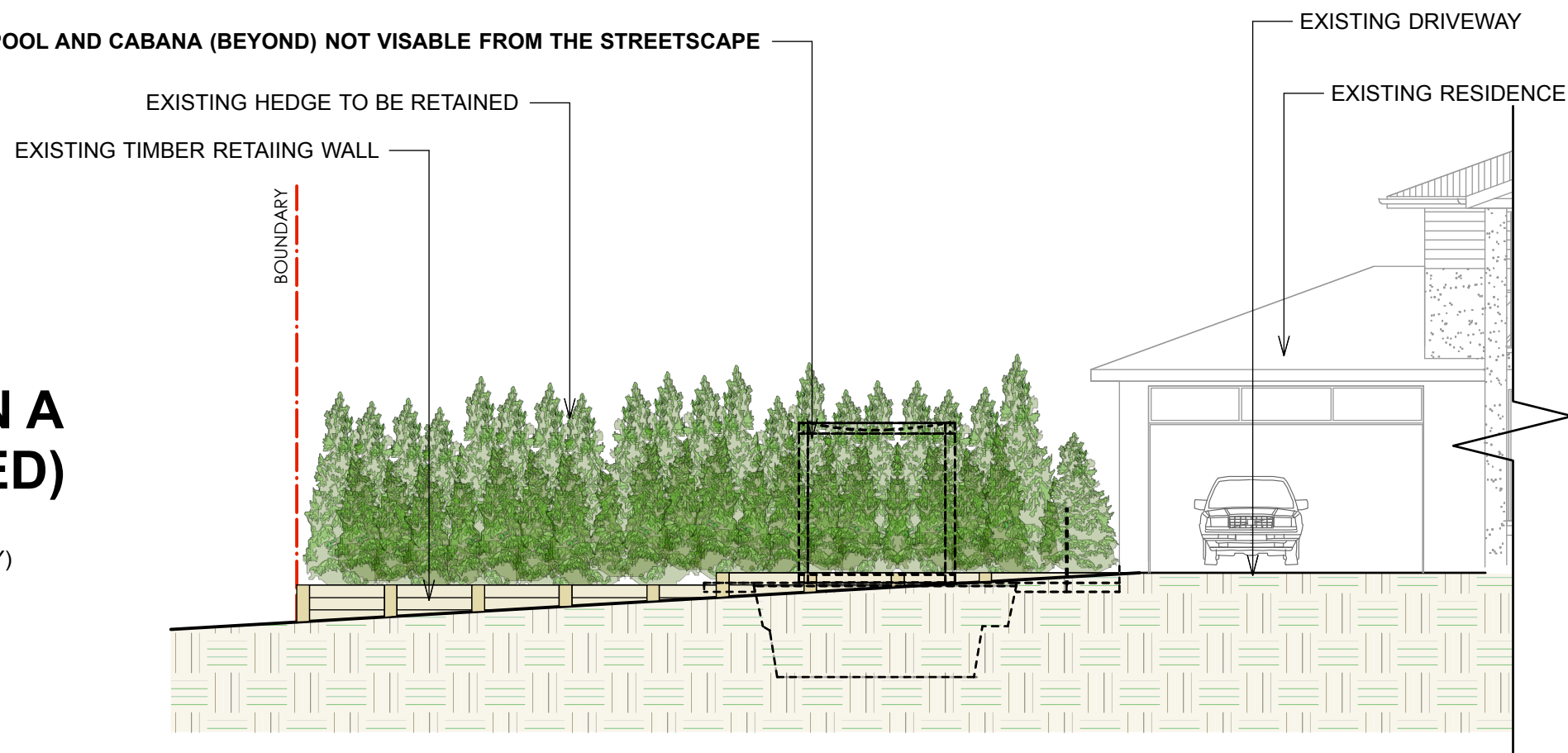



northern  
beaches  
council

THIS PLAN IS TO BE READ IN  
CONJUNCTION WITH  
THE CONDITIONS OF DEVELOPMENT  
CONSENT

DA2019/0990

PROPOSED LANDSCAPED AREA

COMPLIANCE TABLE

LANDSCAPED AREA		COMPLY
SITE AREA	719.2m2	N/A
MINIMUM LANDSCAPED AREA - 40%	287.68m2	N/A
PROPOSED LANDSCAPED AREA	325.22m2	YES

- PROPOSED SWIMMING POOL AND SURROUNDS SHALL BE NO GREATER THAN 600mm ABOVE EXISTING LEVELS

- SWIMMING POOL WATER CAPACITY IS LESS THAN 40 000 LITRES - 38,000LT

- SWIMMING POOL LOCATED IN REAR YARD

- SWIMMING POOL SAFETY FENCING & SWIMMING POOL SHALL COMPLY WITH;

- COUNCIL CODES

- BUILDING CODE OF AUSTRALIA

- SWIMMING POOLS ACT 1992-NO. 49

- SWIMMING POOL SAFETY AS 1926.1-2007

- SWIMMING POOL SAFETY AS 1926.2-2007

- SWIMMING POOL SAFETY AS AS1926.1-2012 AS APPLICABLE.

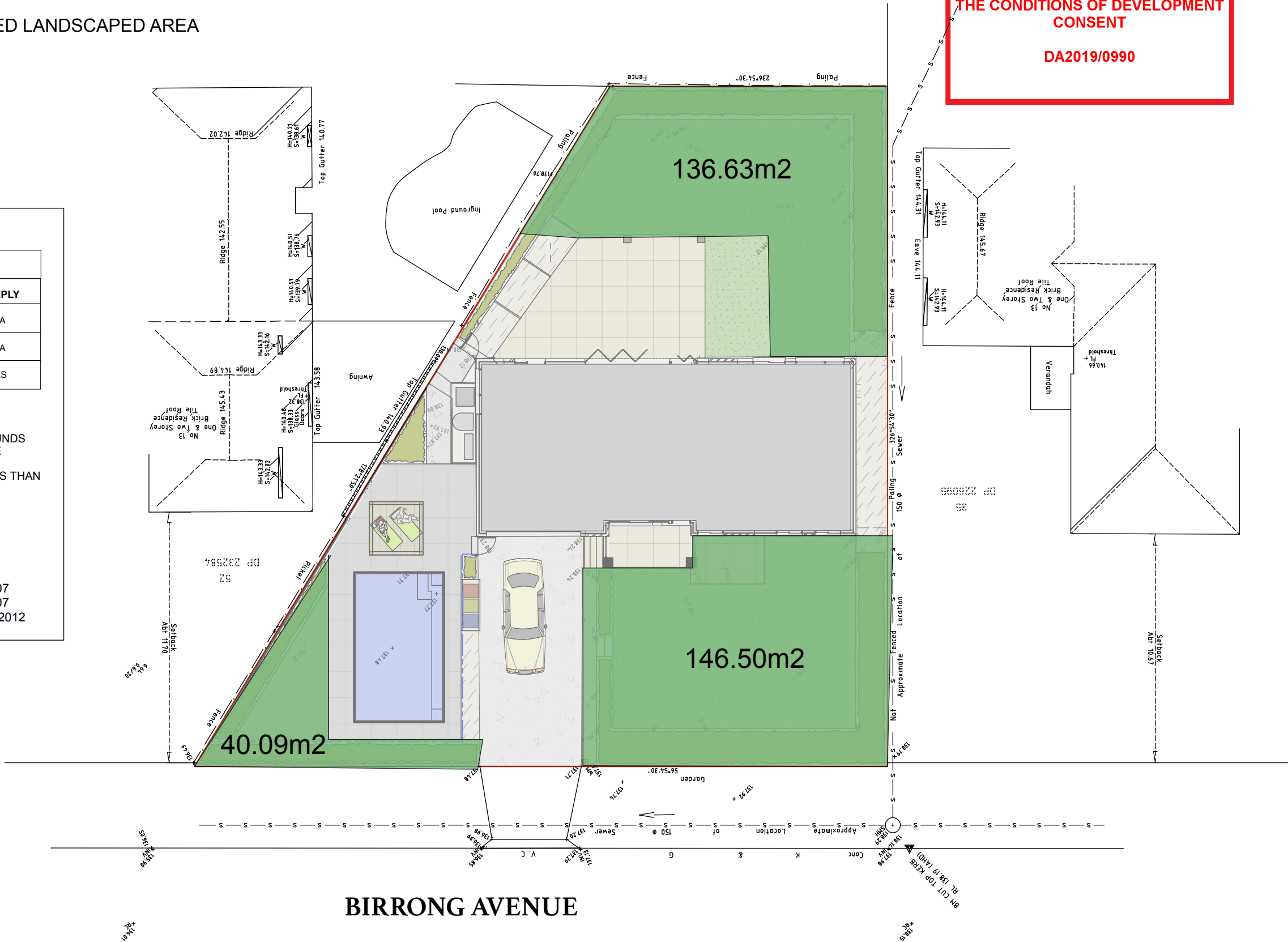

BIRRONG AVENUE

CONTOUR

LANDSCAPE ARCHITECTURE

PO Box 698 MONA VALE NSW 1660  
Tel: 0434 500 705 - AIDLM

PROJECT

Ami Cook

No.15 Birrong Avenue,  
Belrose, NSW 2085

DATE	REV.	ISSUE
26/08/19	A	PRELIMINARY
02/09/19	B	DA

NOTES

comply with building code of australia and all relevant australian standards

all works shall be in accordance with development application and construction certificate conditions of consent

all levels to ahd

refer to survey information relating to existing site data

verify all dimensions prior to works

do not scale from drawings

use figured dimensions in preference to scaling

refer all discrepancies to landscape architect for determination

this drawing is copyright and must not be retained, copied, used or reproduced in any way without prior written permission of contour landscape architects.

DATE: 04/09/19

SCALE: 1:200 @ A3

DRAWN: SW

DRAWING

LANDSCAPE  
AREA PLAN

DRAWING NO:  
C7\_N

REV:  
B



## LEGEND

— — — — SEDIMENT CONTROL BARRIER EXTENT

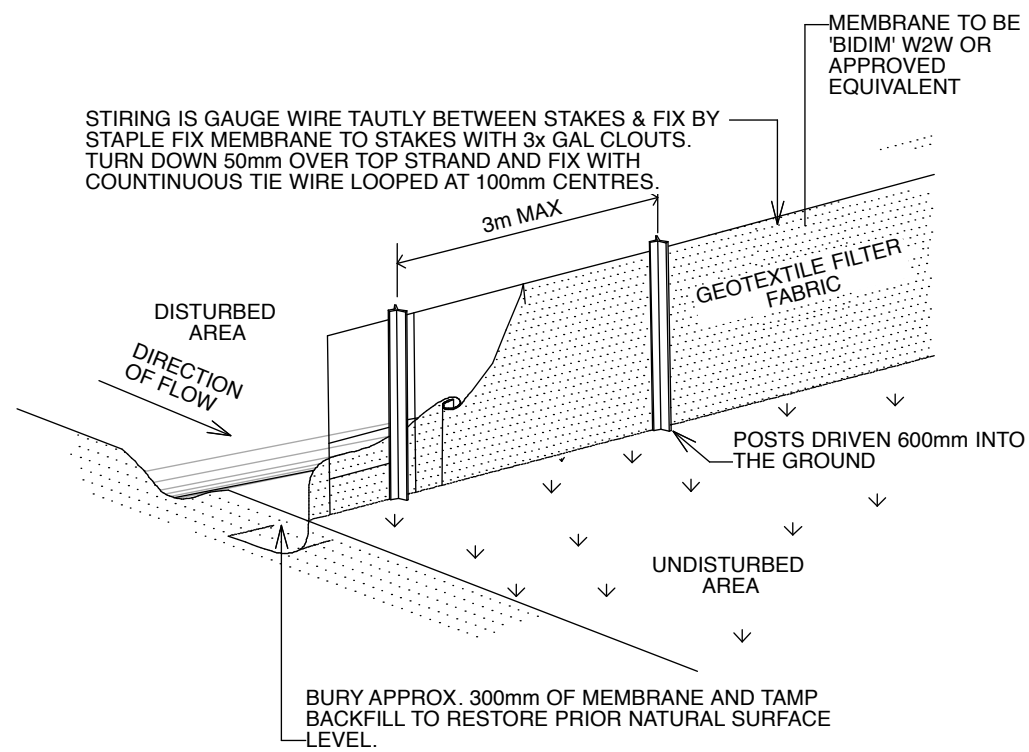

## SEDIMENT FENCE

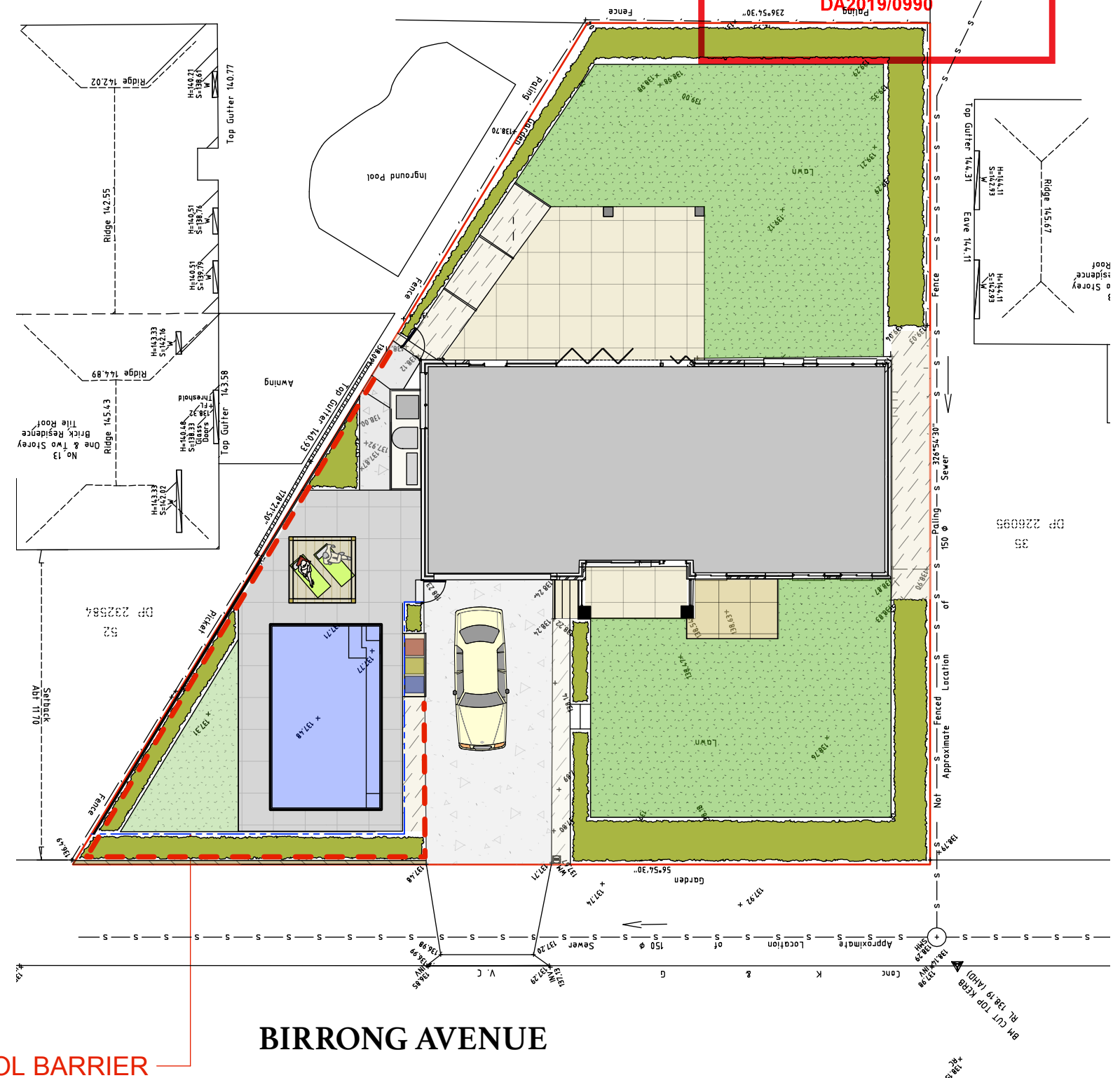

PO Box 698 MONA VALE NSW 1660  
Tel: 0434 500 705 - AIDLM

No.15 Birrong Avenue,  
Belrose, NSW 2085

---

NOTES

comply with building code of australia and all relevant australian standards  
all works shall be in accordance with development application and construction certificate conditions of consent  
all levels to and  
refer to survey information relating to existing site data  
verify all dimensions prior to works  
do not scale from drawings  
use figured dimensions in preference to scaling  
refer all discrepancies to landscape architect for determination  
this drawing is copyright and must not be retained, copied, used or reproduced in any way without prior written permission of  
contour landscape architects.

DATE: 04/09/19

SCALE: 1:200 @ A3

DRAWN: SW

DRAWING  
**SEDIMENT  
CONTROL PLAN**  
DRAWING NO:  
C8\_N  
  
REV:  
B

