



LEGEND:

- EXISTING STRUCTURES TO REMAIN
- EXISTING STRUCTURES TO BE DEMOLISHED
- EXISTING FLOOR STRUCTURE TO BE DEMOLISHED

ASBESTOS NOTE:

THE BUILDER SHALL GIVE NOTICE IMMEDIATELY IF ASBESTOS IS FOUND ON SITE. ASBESTOS REMOVAL MUST ONLY BE UNDERTAKEN BY SUITABLY QUALIFIED BUILDERS IN ACCORDANCE WITH THE AUSTRALIAN WORK, HEALTH AND SAFETY STRATEGY 201-2022 NATIONAL OCCUPATIONAL HEALTH AND SAFETY STRATEGY 2002-2012 AND TO THE MOST CURRENT COUNCIL'S ASBESTOS POLICY. IF ASBESTOS IS FOUND AN "ASBESTOS REMOVAL" SIGNAGE MUST BE DISPLAYED AND NEIGHBORHOODS NOTIFIED IN ACCORDANCE TO DA CONDITIONS. ASBESTOS SIGNAGE MUST BE ERECTED AND DISPLAYED IN A PROMINENT POSITION.

ANY LEAD PAINT REMOVAL REQUIRED: SHOULD IMPLEMENT SAFE PAINT AND ASBESTOS WORK PRACTICES. PAINT REMOVER HAS A DUTY TO THE COMMUNITY, CLIENT, EMPLOYEES AND THEMSELVES TO FAITHFULLY IMPLEMENT THE REQUIREMENTS OF AS/NZS GUIDE TO HAZARDOUS PAINT MANAGEMENT AND THE ADDITIONAL REQUIREMENTS OF LOCAL AGENCIES WITH RESPONSIBILITIES FOR THE ENVIRONMENT, WASTE DISPOSAL, PUBLIC HEALTH AND WORKPLACE HEALTH AND SAFETY.

DEMOLITION WORKS TO BE CARRIED OUT IN ACCORDANCE WITH AS 2601-2001, The Demolition of Structures)Part 7.2(1)(a) ALL SERVICES ARE TO BE DISCONNECTED IN ACCORDANCE WITH THE REQUIREMENTS OF THE RELEVANT AUTHORITIES

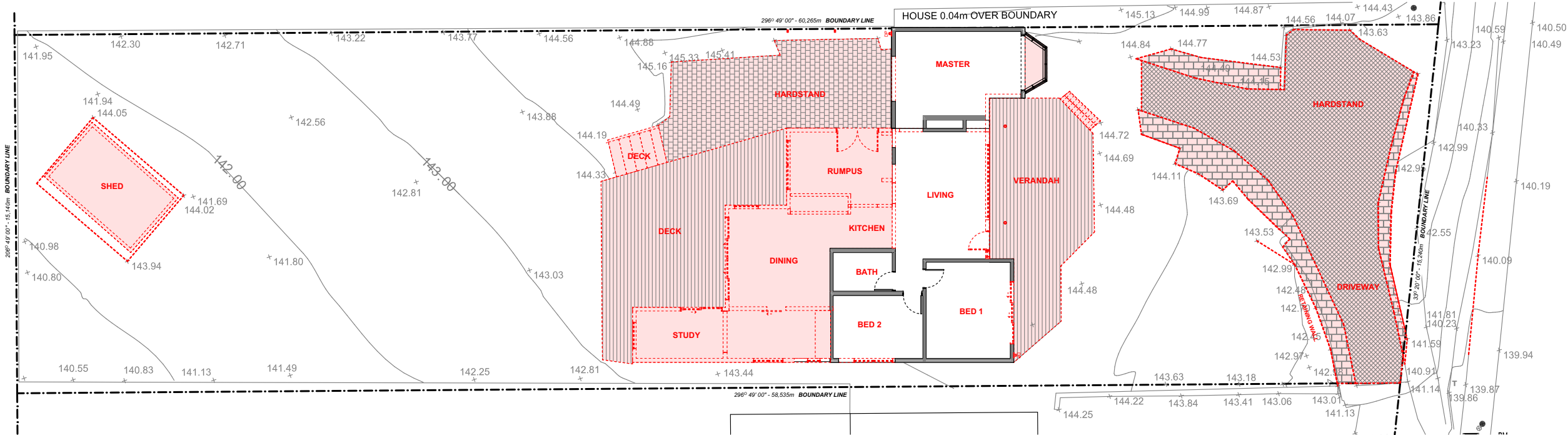

WASTE MANAGEMENT:

OBJECTIVES

TO ENSURE THAT NECESSARY MEASURES ARE EMPLOYED ON THE SITE THAT PROTECT BOTH THE NEIGHBOURHOOD AMENITY AND THE SURROUNDING ENVIRONMENT AND MINIMISE SITE DEGRADATION. THE RECYCLING OF MATERIALS WILL REDUCE TIPPING COSTS.

REFER TO WASTE MANAGEMENT PLAN REPORT.

RESPONSIBILITY

THE CONTRACTOR WILL BE RESPONSIBLE AND LIABLE FOR ALL WORKS CARRIED OUT ON THE SITE. THIS INCLUDES ASSUMING RESPONSIBILITY FOR THE ACTIONS OF ALL THE SUBCONTRACTORS AS WELL AS ADVISING THEM OF COUNCIL'S REQUIREMENTS WHEN CARRYING OUT THE WORK.

IT IS THE RESPONSIBILITY OF THE CONTRACTOR TO HAVE VIEWED ALL APPROVED PLANS PRIOR TO THE COMMENCEMENT OF DEMOLITION, EARTHWORKS AND CONSTRUCTION WORKS.

CONTAINMENT OF SITE WASTE

BUILDING MATERIALS MUST NOT BE BURIED ON SITE. DEMOLITION WASTE RESULTING FROM THE WORKS IS NOT TO BE STORED ON FOOTPATHS, STREET GUTTERS OR ROADWAYS ETC. ALL WASTE TO BE PLACED IN RUBBISH SKIPS, OR CONTAINERS FOR COLLECTION.

COUNCIL PROPERTY

COUNCIL PROPERTY IS NOT TO BE USED FOR CONSTRUCTION OR STORAGE ACTIVITIES UNLESS PRIOR WRITTEN APPROVAL HAS BEEN OBTAINED. COUNCIL PROPERTY IS NOT TO BE DAMAGED AND IS TO BE KEPT IN A CLEAN, SAFE AND FUNCTIONAL CONDITION BEFORE, DURING AND ON COMPLETION OF THE WORKS.

SHOULD ANY COUNCIL PROPERTY INCLUDING FOOTPATHS BE INADVERTENTLY DAMAGED AS A RESULT OF THE WORKS, COUNCIL MUST BE NOTIFIED IMMEDIATELY.

BUILDING MATERIAL STOCKPILE

AT NO TIME MAY BUILDING MATERIALS OR STOCKPILES BE SITUATED ON A PUBLIC RESERVE, ROAD GUTTER OR FOOTPATH, THIS INCLUDES BUILDING OR DEMOLITION MATERIAL, WASTE CONTAINERS, PROTABLE SHEDS, PORTABLE TOILETS AND THE LIKE.

ALL BUILDING MATERAILS ARE TO BE STORED WITHIN THE SUBJECT SITE. ALL LOOSE MATERIAL TO BE COVERED WITH TARPULINS.

A SUFFICIENT AREA MUST BE ALLOCATED WITHIN THE SITE FOR SUCH STORAGE OF BUILDING MATERIALS, DEMOLITION WASTE, WASTE CONTAINERS ETC. AS REQUIRED. THE FEASIBILITY OF THE NOMINATED SITE FOR THE STOCKPILE MUST BE CONFIRMED PRIOR TO COMMENCEMENT.

VEHICLE MOVEMENTS

ALL VEHICLES VISITING THE SITE ARE TO COMPLY WITH THE PARKING REGULATIONS IN THE AREA.

ALL TRUCKS AND UTILITIES MUST COVER THEIR LOADS. NO VEHICLE VISITING THE SITE IS TO IMPEDE LOCAL AREA TRAFFIC FLOWS.

DUST CONTROL

APPROPRIATE METHODS ARE TO BE USED TO PREVENT WIND BLOWN DUST CREATING AN UNACCEPTABLE HAZARD OR NUISANCE ON THE SITE OR ADJOINING PROPERTIES. WHERE DUST IS CREATED AS A RESULT OF THE WORKS. MINIMISE DUST & KEEP THE AREA TIDY AT ALL TIMES.

HAZARDOUS MATERIALS

ASBESTOS CEMENT SHEETING IF ENCOUNTERED IS TO BE WRAPPED TIGHTLY IN PLASTIC TO COMPLY WITH THE AUSTRALIAN STANDARD AND WORK COVER AUTHORITIES REQUIREMENTS AND TAKEN TO AN APPROVED LANDFILL TIP.

8

DEMOLITION / WASTE MANAGEMENT PLAN

1:200

Figured dimensions to be used in preference to scaling this drawing. Do not assume - if in doubt ASK.

Plot Date: Wednesday, 14 May 2025

<div>ERA</div> <div>www.erarchitect.com.au</div>	<div>Level 1 . 2 Epsom Road, Zetland, Sydney, NSW, 2017 office 0421 813 873 e hello@erarchitect.com.au licence No.7530</div>	<div>N</div> <div></div>	ISSUE FOR DA	REV	DATE	AMENDMENT	Copyright. ©	DRAWING: DEMOLITION PLAN LOT:52 DP:12838 154 PLATEAU RD BILGOLA PLATEAU, NSW 2107	CLIENT: JENNY & JANNIS KEARNEY BOTT		
				A	14.04.25	ISSUE FOR DA - AH/JK	THIS DOCUMENT IS OWNED BY AND THE INFORMATION CONTAINED IN ITS IS PROPRIETARY TO ELAINE RICHARDSON ARCHITECT. BY RECEIPT HERE OF THE HOLDER AGREES NOT TO USE THE INFORMATION DISCLOSE IT TO ANY THRD PARTY, NOR REPRODUCE THIS DOCUMENT WITHOUT PRIOR WRITTEN CONSENT OF ELAINE RICHARDSON ARCHITECT. AND AGREES TO RETURN THIS DOCUMENT FORTHWITH UPON REQUEST.		LGA: NORTHERN BEACHES COUNCIL		
									DESIGN: ALTS & ADDS TO EX SINGLE STOREY DWELLING		
									JOB No:1962024	SHEET SIZE: A3	SHEET No:8 of 30

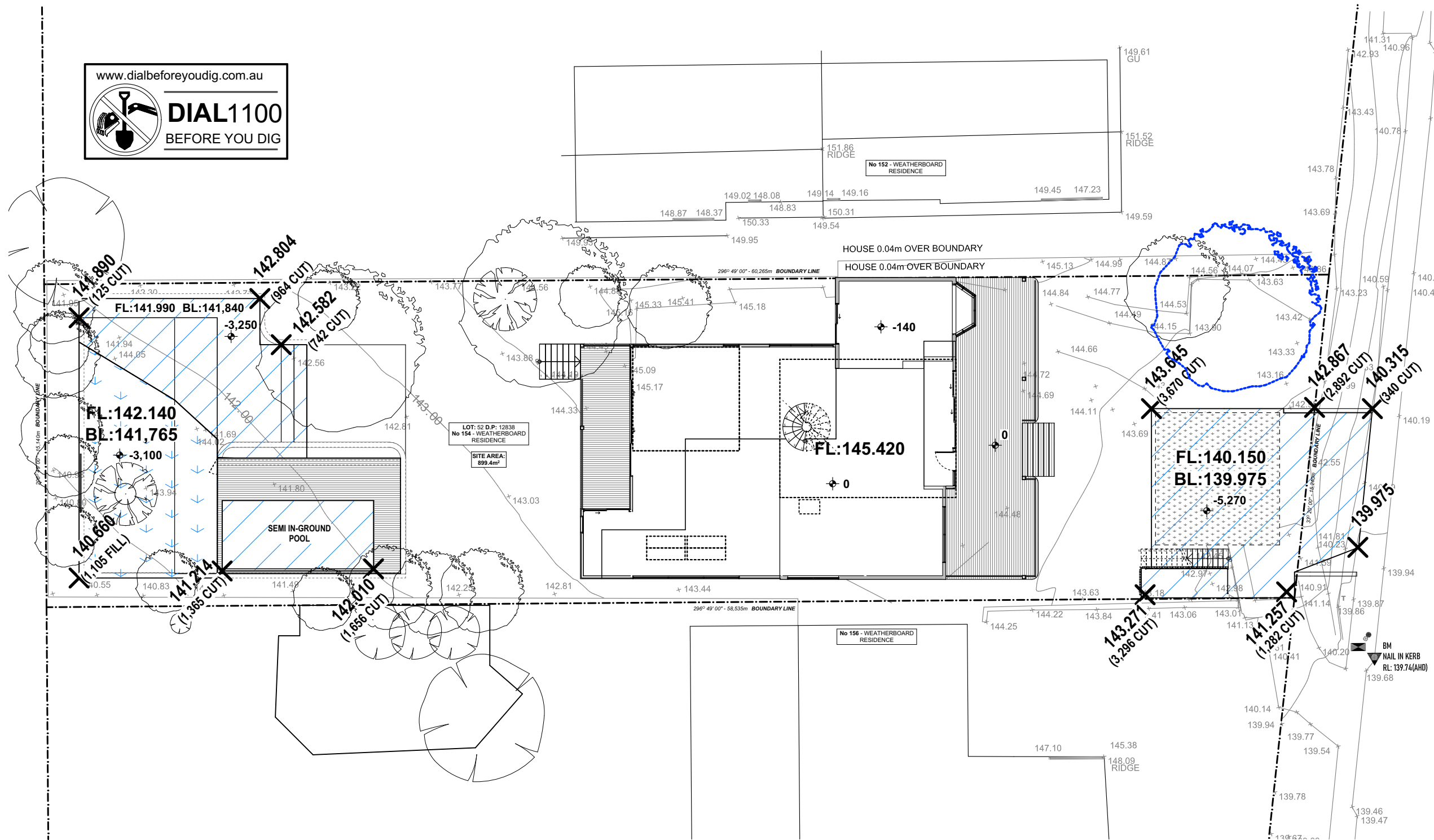

9
-

SITE WORKS CUT & FILL PLAN
1:200

Figured dimensions to be used in preference to scaling this drawing. Do not assume - if in doubt ASK.

Plot Date: Wednesday, 14 May 2025

<div>ERA</div> <div>www.erarchitect.com.au</div>	<div>Level 1 . 2 Epsom Road, Zetland, Sydney, NSW, 2017</div> <div>office 0421 813 873</div> <div>e hello@erarchitect.com.au</div> <div>licence No.7530</div>	<div>N</div> <div></div>	<div>ISSUE FOR</div> <div>DA</div>	<div>REV</div> <div>DATE</div> <div>AMENDMENT</div>	<div>Copyright. ©</div> <div>THIS DOCUMENT IS OWNED BY AND THE INFORMATION CONTAINED IN ITS IS PROPRIETARY TO ELAINE RICHARDSON ARCHITECT. BY RECEIPT HERE OF THE HOLDER AGREES NOT TO USE THE INFORMATION DISCLOSE IT TO ANY THIRD PARTY, NOR REPRODUCE THIS DOCUMENT WITHOUT PRIOR WRITTEN CONSENT OF ELAINE RICHARDSON ARCHITECT, AND AGREES TO RETURN THIS DOCUMENT FORTHWITH UPON REQUEST.</div> <div>CONTRACTOR TO VERIFY DIMENSIONS PRIOR CONSTRUCTION. DO NOT SCALE OFF DRAWING.</div>	<div>DRAWING:</div> <div>SITE WORKS CUT/FILL PLAN</div> <div>LOT:52 DP:12838</div> <div>154 PLATEAU RD</div> <div>BILGOLA PLATEAU, NSW 2107</div>	<div>CLIENT: JENNY & JANNIS KEARNEY BOTT</div>		
				<div>A</div> <div>14.04.25</div> <div>ISSUE FOR DA - AHUJK</div>			<div>LGA: NORTHERN BEACHES COUNCIL</div>		
							<div>DESIGN: ALTS & ADDS TO EX SINGLE STOREY DWELLING</div>		
							<div>JOB No:1962024</div>	<div>SHEET SIZE: A3</div>	<div>SHEET No:9 of 30</div>