

Contact Us		Office Use Only	
The General Manager, 725 Pittwater Road, Dee Why NSW 2099 or Customer Service Centre, Northern Beaches Council DX9118 Dee Why			
Email	council@warringah.nsw.gov.au		
Fax	9942 2606		
If you need help lodging your application call Customer Service on (02) 9942 2111 or come in and talk to us at the Civic Centre, Dee Why.			

Part 1: Declaration

1. DECLARATION	
I hereby certify that the shadow diagrams submitted with the proposal at	
Address	157 AVALON PARADE AVALON BEACH NSW 2107.
For the erection of Description of development	REMARKS + ADDITIONS.
<ul style="list-style-type: none"> In accordance with the survey (prepared by a registered surveyor) which is required to be submitted with the application Drawn to true north Indicate shadow cast by the proposal at 9am, noon, 3pm, 21 June To indicate the shadow cast by existing buildings and structures on the site and in the surrounding area 	

Part 2: Certification

2. CERTIFIER			
Title	<input checked="" type="radio"/> Mr <input type="radio"/> Mrs <input type="radio"/> Ms <input type="radio"/> Other		
Full family name (no initials) (or Company)	ANDY LENMAN DESIGN.		
Full given names (no initials) (or A.C.N)			
Phone		Alternate	
Mobile	0414 466 665	Fax	
Qualification (e.g. Architect, Planner, Computer Technician, Surveyor)			

Part 3: Signature

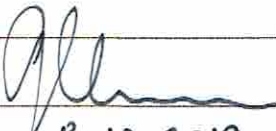
3. APPLICANT(S) SIGNATURE	
Signature	
Date	8.10.2019

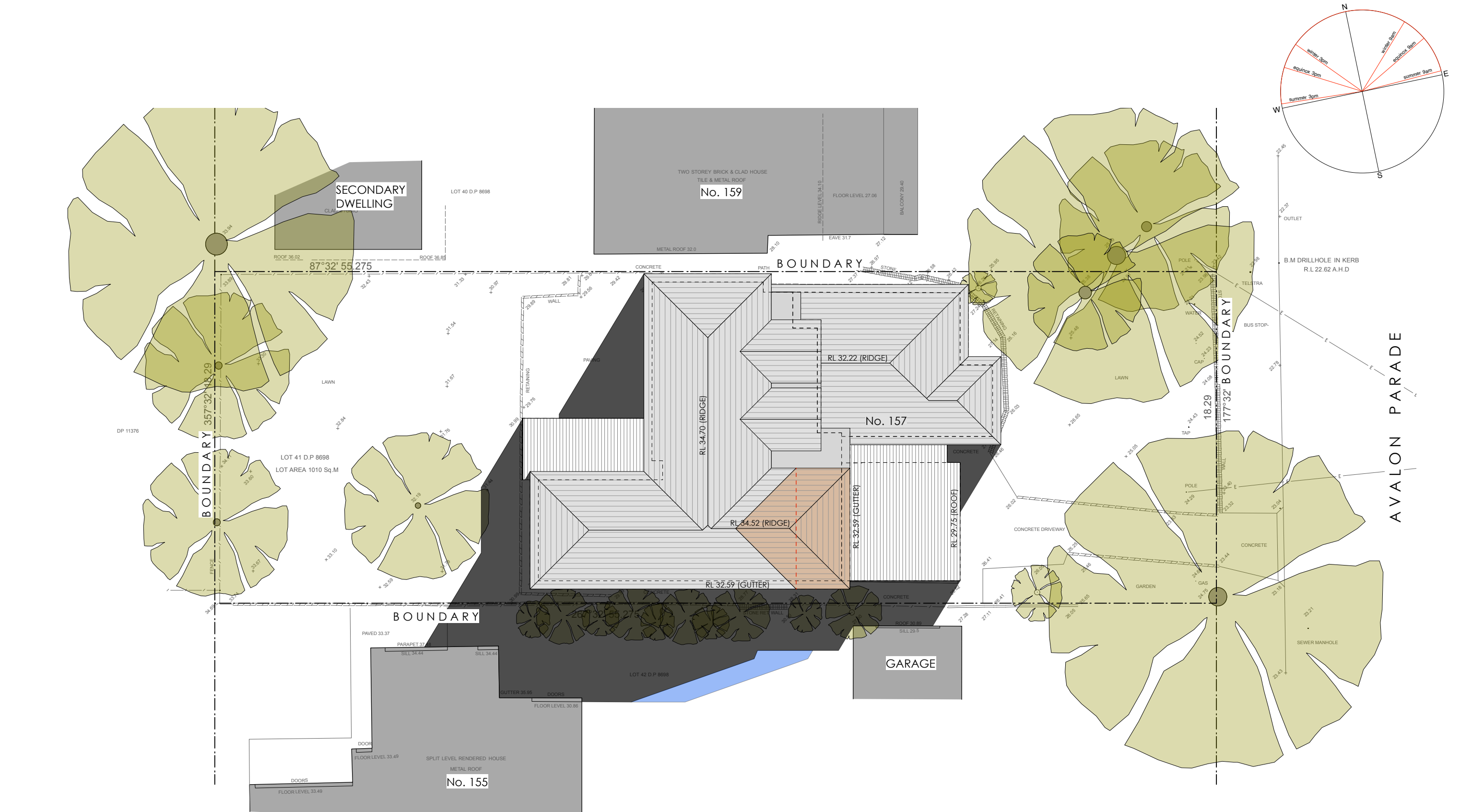

Shadows - 9am Winter Solstice

Shadows as cast by existing dwelling

Additional Shadows as cast by alterations & additions

	Note: All footings to future engineers details. All framing to NCC & future engineers details. Rainwater from gutters to connect to existing stormwater system to relevant NCC + Council requirements. Wastewater/sewage to connect to existing sewage system to relevant NCC + Council requirements. All works to comply with all relevant Building Codes + Council requirements.		BAL BALUSTRADE EX EXISTING LC LIGHTWEIGHT CLADDING TO MATCH EX. RT ROOF TILES TO MATCH EX. NGL NATURAL GROUND LEVEL TIM TIMBER FLOOR TO MATCH EX. EX. WALLS TO REMAIN EX. WALLS TO BE REMOVED NEW TIMBER FRAMED WALLS	NORTHERN BEACHES COUNCIL ZONE: R2 (LOW DENSITY RESIDENTIAL) LOT 41 DP 8698 SITE AREA: 1,010m ²		LEIGH 157 AVALON PARADE AVALON BEACH NSW 2107			
	PROJECT	ALTERATIONS & ADDITIONS				ANDY LEHMAN DESIGN		DA.08	
	DRAWING	SHADOW DIAGRAM - 9AM WINTER SOLSTICE		Tel. 0414 466 665 Email: andy@andylehman .com.au If in doubt ask.		DWG. NO. SCALE DATE ISSUE		1:200@A3 27 SEP 2019	
	NOTES	Please print in A3 or A1. This drawing is copyright and is for Development Application purposes only. Do not measure off drawings.							

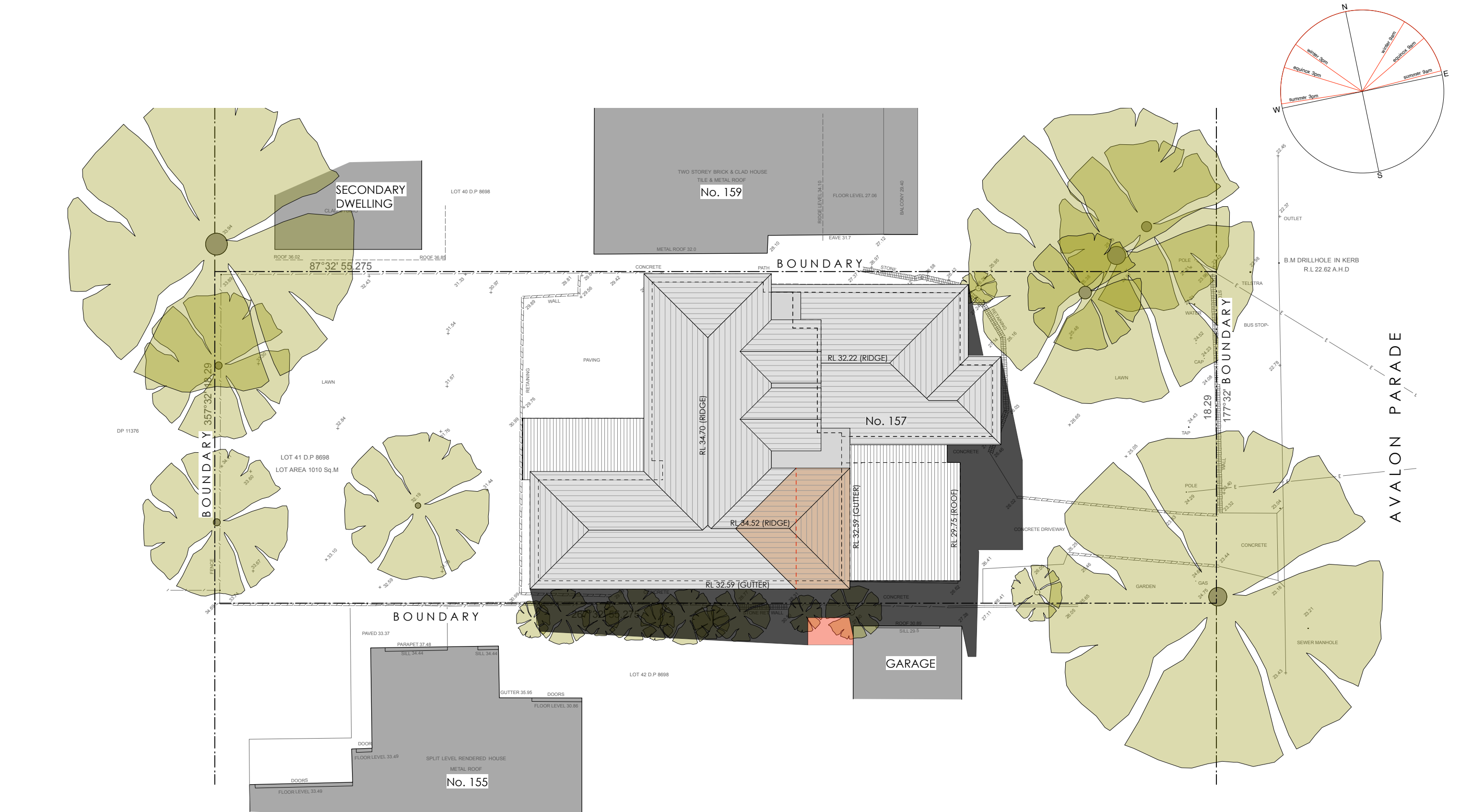

Shadows - 12 noon Winter Solstice

Shadows as cast by existing dwelling

Additional Shadows as cast by alterations & additions

	Note: All footings to future engineers details. All framing to NCC & future engineers details. Rainwater from gutters to connect to existing stormwater system to relevant NCC + Council requirements. Wastewater/sewage to connect to existing sewage system to relevant NCC + Council requirements. All works to comply with all relevant Building Codes + Council requirements.	BAL BALUSTRADE EX EXISTING LC LIGHTWEIGHT CLADDING TO MATCH EX. RT ROOF TILES TO MATCH EX. NGL NATURAL GROUND LEVEL TIM TIMBER FLOOR TO MATCH EX. <div><div></div> EX. WALLS TO REMAIN <div></div> EX. WALLS TO BE REMOVED <div></div> NEW TIMBER FRAMED WALLS</div>	NORTHERN BEACHES COUNCIL ZONE: R2 (LOW DENSITY RESIDENTIAL) LOT 41 DP 8698 SITE AREA: 1,010m²	LEIGH 157 AVALON PARADE AVALON BEACH NSW 2107	
	PROJECT	ALTERATIONS & ADDITIONS		ANDY LEHMAN DESIGN	
	DRAWING	SHADOW DIAGRAM - 12 NOON WINTER SOLSTICE		Tel. 0414 466 665	DWG. NO. DA.09
	NOTES	Please print in A3 or A1. This drawing is copyright and is for Development Application purposes only. Do not measure off drawings.		Email: andy@andylehman .com.au	DATE 27 SEP 2019
				If in doubt ask.	ISSUE

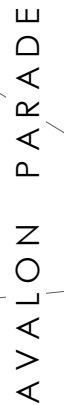
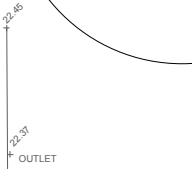

Shadows - 3pm Winter Solstice



Shadows as cast by existing dwelling

Additional Shadows as cast by alterations & additions

Note:

- All footings to future engineers details.
- All framing to NCC & future engineers details.
- Rainwater from gutters to connect to existing stormwater system to relevant NCC + Council requirements.
- Wastewater/sewage to connect to existing sewage system to relevant NCC + Council requirements.
- All works to comply with all relevant Building Codes + Council requirements.

BAL	BALUSTRADE
EX	EXISTING
LC	LIGHTWEIGHT CLADDING TO MATCH EX.
RT	ROOF TILES TO MATCH EX.
NGL	NATURAL GROUND LEVEL
TIM	TIMBER FLOOR TO MATCH EX.

 EX. WALLS TO REMAIN
 EX. WALLS TO BE REMOVED
 NEW TIMBER FRAMED WALLS

NORTHERN BEACHES COUNCIL
ZONE: R2 (LOW DENSITY RESIDENTIAL)
LOT 41
DP 8698
SITE AREA: 1,010m²

LEIGH
157 AVALON PARADE AVALON BEACH NSW 2107

PROJECT	ALTERATIONS & ADDITIONS	ANDY LEHMAN DESIGN		DA. 10
DRAWING	SHADOW DIAGRAM - 3PM WINTER SOLSTICE		DWG. NO.	
NOTES	Please print in A3 or A1. This drawing is copyright and is for Development Application purposes only. Do not measure off drawings.	Tel: 0414 466 665	SCALE	1:200@A3
		Email: andy@andylehman.com.au	DATE	27 SEP 2019
		If in doubt ask.	ISSUE	