

GENERAL NOTES

1. DENOTES EXISTING LEVEL
2. DENOTES PROPOSED LEVEL
3. ALL PITS HAVING AN INTERNAL DEPTH THAT EXCEEDS 10m SHALL BE PROVIDED WITH GALVANISED STEP IRONS AT 300mm CENTRES PLACED IN A STAGGERED PATTERN AND SHALL BE IN ACCORDANCE WITH THE AUSTRALIAN STANDARDS
4. THE BUILDER/CONTRACTOR SHALL LOCATE ALL EXISTING PUBLIC UTILITY SERVICES WITHIN THE SITE, FOOTPATH AREA AND ROAD RESERVE PRIOR TO THE COMMENCEMENT OF ANY WORKS. ALL LOCATIONS AND LEVELS OF SERVICES SHALL BE REPORTED TO THE STORMWATER ENGINEER PRIOR TO THE COMMENCEMENT OF ANY WORKS
5. ALL LEVELS SHALL RELATE TO THE ESTABLISHED BENCH MARK.
6. THE BASE OF ALL DRAINAGE PITS SHALL BE BENCH TO THE INVERT OF THE OULET PIPE.
7. ALL GUTTERS SHALL BE MINIMUM 100 x 75mm AND DOWNPIPES SHALL BE MINIMUM 100 x 75mm UNLESS NOTED OTHERWISE
8. ALL STORMWATER DRAINAGE PIPES SHALL BE A MINIMUM ϕ 100mm PVC LAID AT 1% MINIMUM GRADE UNLESS NOTED OTHERWISE ON THE DRAWING, WHERE GROUND COVER OVER THE PIPES IS LESS THAN 300mm THE STORMWATER PIPES SHALL BE SEWER GRADE PVC
9. THE BUILDER SHALL ENSURE THAT THE STORMWATER ENGINEERING DRAWINGS CORRESPOND TO THE ARCHITECTURAL, STRUCTURAL AND LANDSCAPE DRAWINGS. IF THERE EXISTS ANY DISCREPANCIES BETWEEN THE DRAWINGS THE BUILDER SHALL REPORT THE DISCREPANCIES TO THE ENGINEER PRIOR TO COMMENCEMENT OF ANY WORKS
10. ALL MULCHING TO BE SHALL BE OF A NON-FLOATABLE MATERIAL SUCH AS DECORATIVE RIVER GRAVEL
11. ALL WORKS WITHIN THE FOOTPATH AREA SHALL BE SUITABLY BARRICADED AND SIGNPOSTED IN ACCORDANCE WITH A TRAFFIC MANAGEMENT PLAN THAT HAS BEEN PREPARED BY A QUALIFIED AND RTA ACCREDITED TRAFFIC ENGINEER AND APPROVED BY COUNCIL. IT IS THE RESPONSIBILITY OF THE BUILDER OR CONTRACTOR CARRYING OUT THE WORKS WITHIN THE FOOTPATH AREA AND ROAD RESERVE TO OBTAIN THE NECESSARY APPROVED DOCUMENTS AS OUTLINED ABOVE.
12. ALL RETAINING WALLS SHALL BE CONSTRUCTED COMPLETELY WITHIN THE PROPERTY BOUNDARY LIMITS TO DETAILS PREPARED BY THE STRUCTURAL ENGINEER.
13. ALL SUB-SOIL DRAINAGE SHALL BE A MINIMUM OF ϕ 65mm AND SHALL BE PROVIDED WITH A FLITER SOCK. THE SUBSOIL DRAINAGE SHALL BE INSTALLED IN ACCORDANCE WITH DETAILS TO BE PROVIDED BY THE LANDSCAPE ARCHITECT.
14. THE BUILDER SHALL CHECK ALL LEVELS OF THE SITES STORMWATER CONNECTION POINT INTO THE KERB/COUNCIL DRAINAGE SYSTEM PRIOR TO COMMENCEMENT OF BUILDING WORKS ONT THE SITE TO ENSURE THEY MATCH THE DESIGN LEVELS. ANY DISCREPANCIES SHALL BE REPORTED TO THE DESIGN ENGINEER IMMEDIATELY.

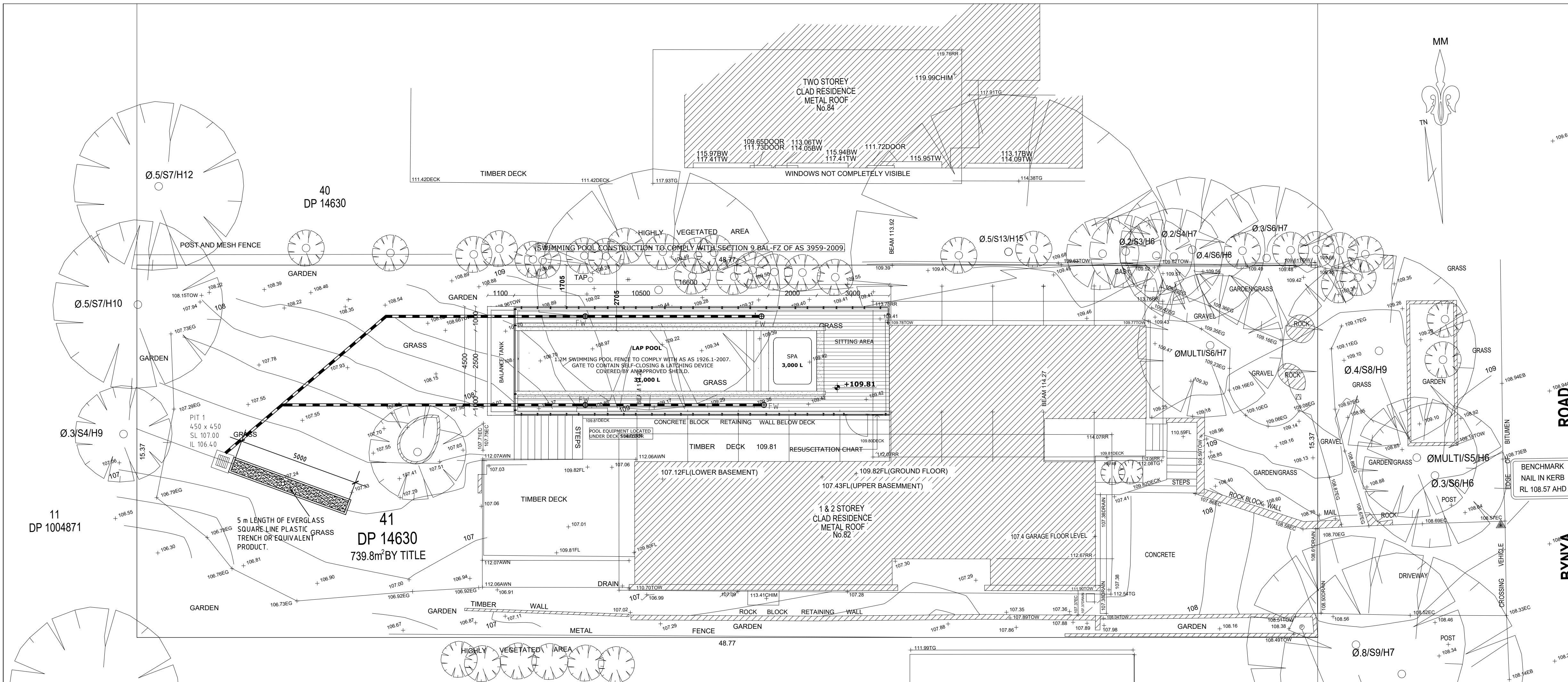
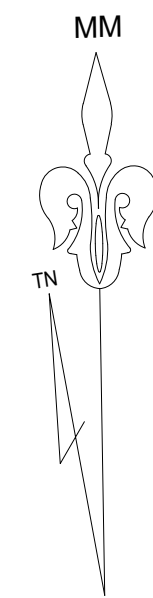

ROOF AND SITE PLAN LAYOUT

ALL PIPES TO BE ϕ 100 @ 1 % PVC U.O.N.

SEDIMENT CONTROL NOTES:

- 1- ALL EROSION AND SEDIMENT CONTROL MEASURES TO BE INSTALLED PRIOR TO SITE DISTURBANCE.
- 2- STRIPPING OF GRASS AND VEGETATION ETC. FROM SITE SHALL BE KEPT TO A MINIMUM.
- 3- ALL SEDIMENT CONTROL STRUCTURES TO BE INSPECTED AFTER EACH RAINFALL EVENT FOR AND ALL TRAPPED SEDIMENT TO STRUCTURAL DAMAGE BE REMOVED TO A NOMINATED STOCKPILE SITE.

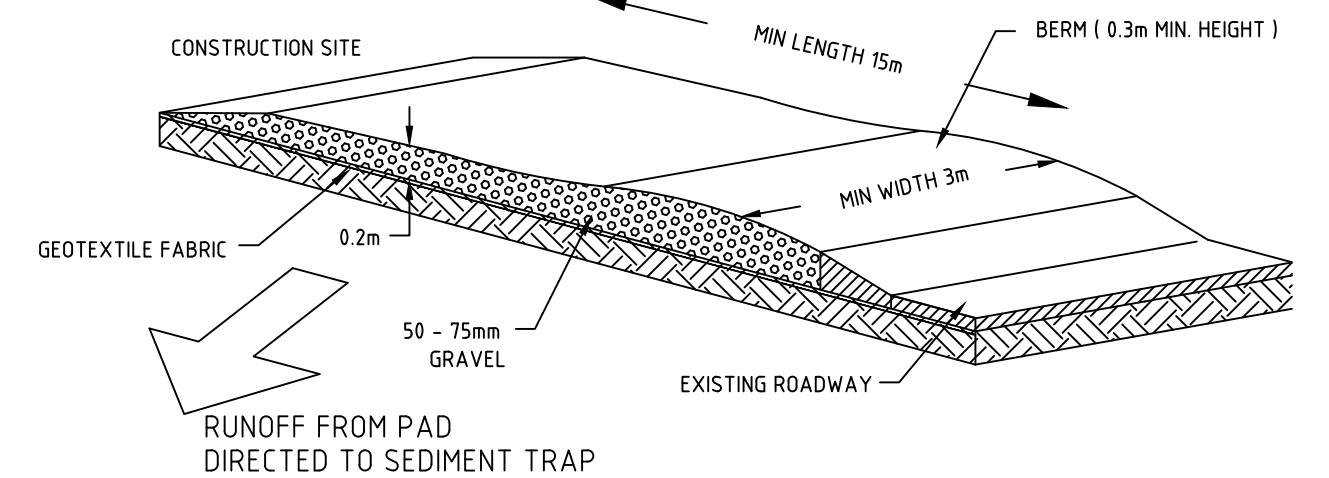
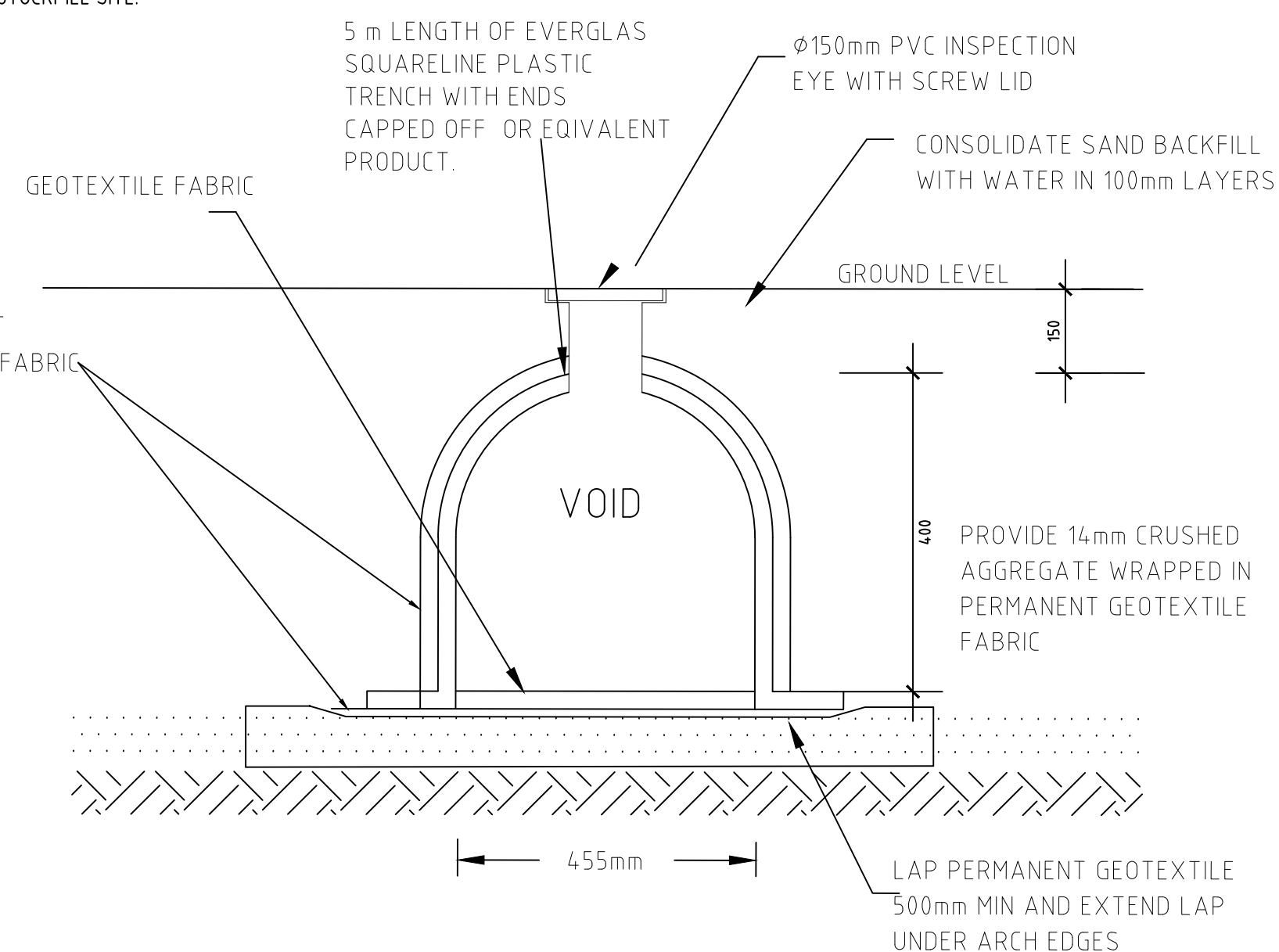
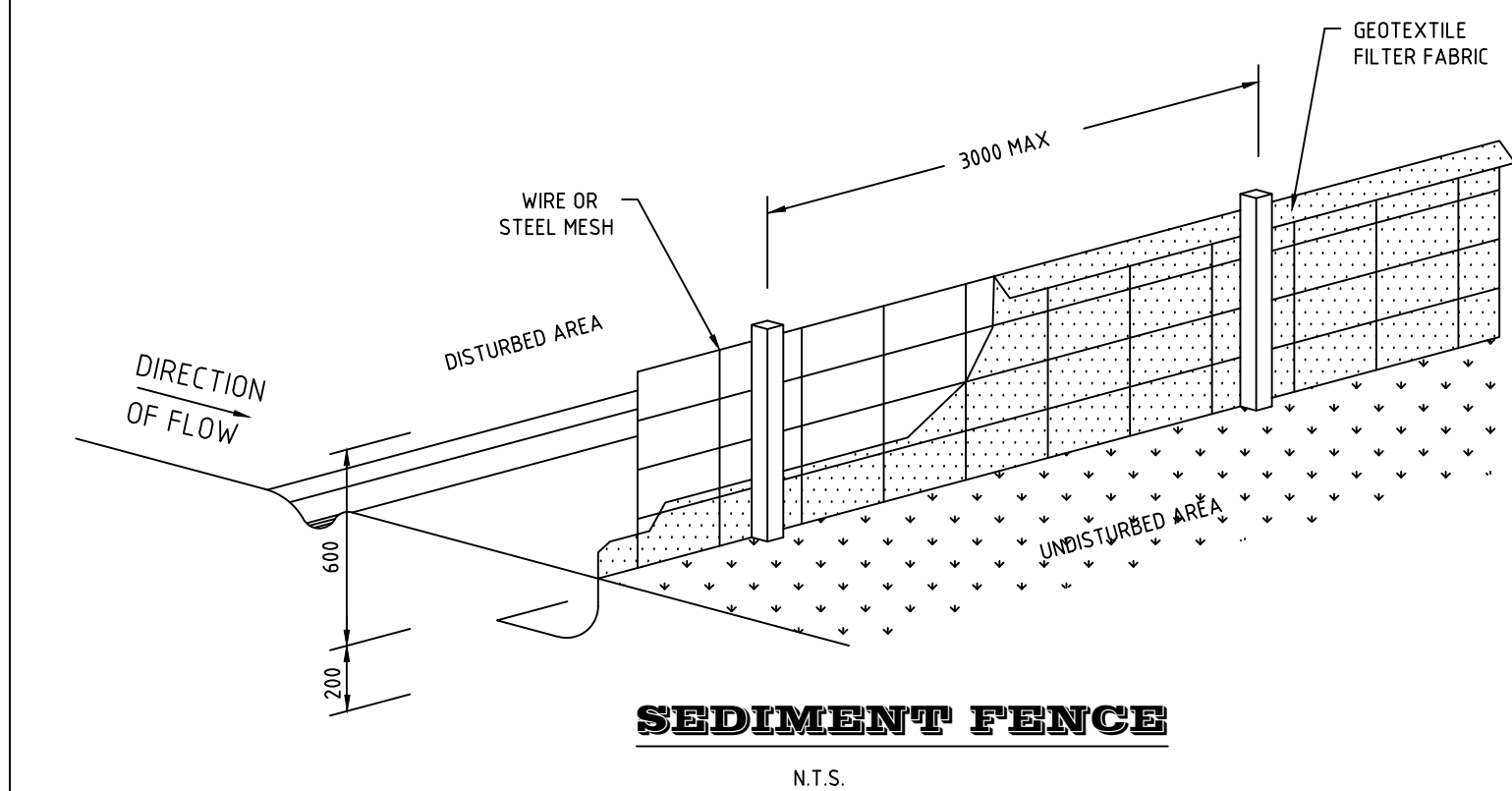

TEMPORARY CONSTRUCTION

EXIT / ENTRANCE

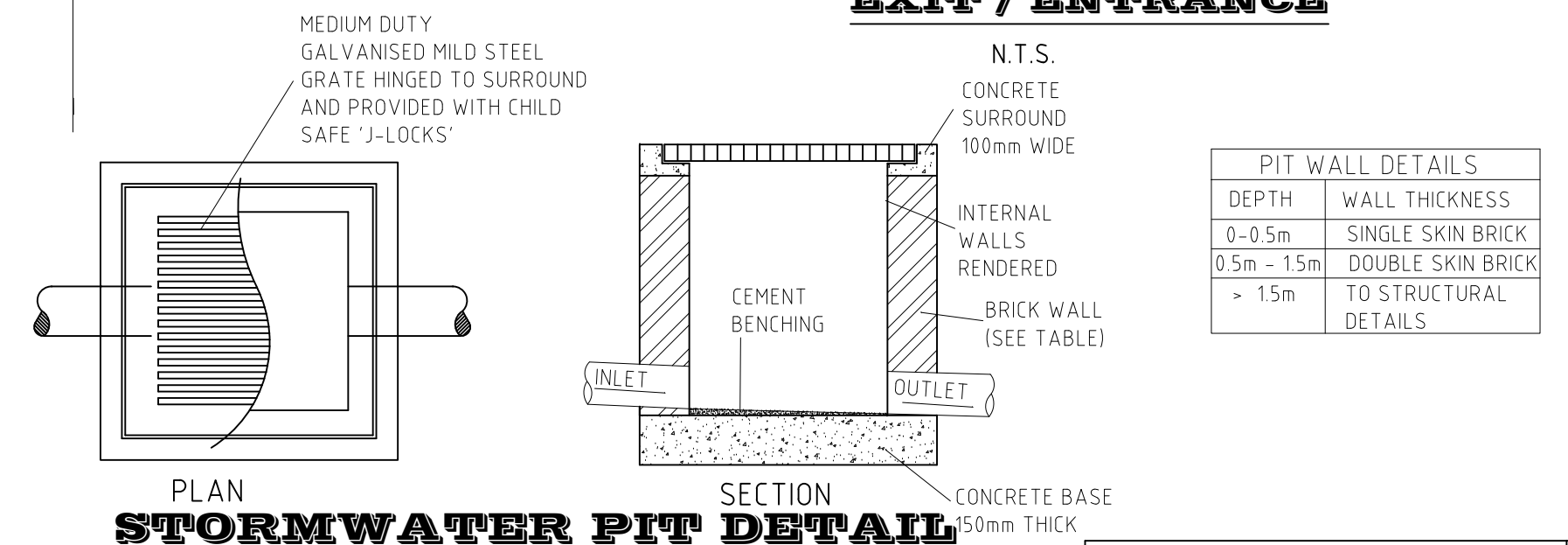

SECTION OF COVERED ABSORPTION PIT

<div> <div> NOT TO SCALE </div> </div>		<div> <div>AMENDMENTS</div> </div>	<div> <div>DATE</div> </div>
<div> <div>M.M.FARAH CIVIL/STRUCTURAL PTY/LTD</div> </div>		<div> <div>DESIGNED</div> </div>	<div> <div>SCALE</div> </div>
<div> <div>PROPOSED NEW SWIMMING POOL</div> <div>AT NO 82 BYNYA ROAD,</div> <div>PALM BEACH</div> <div>NEW SOUTH WALES</div> </div>		<div> <div>M.M.FARAH CIVIL/STRUCTURAL P/L</div> <div>LEVEL 1, 3/18 MCFARLANE ST</div> <div>MERRYLANDS</div> <div>NSW 2160</div> <div>0411 780 327</div> </div>	<div> <div>1:100 @ A1</div> <div>1:200 @ A3</div> <div>DRAWN</div> <div>MMF</div> <div>15-09-2019</div> </div>
<div> <div>HYDRAULIC AND SEDIMENT CONTROL PLAN</div> </div>		<div> <div>SHEET No. 1 OF 1</div> </div>	
		<div> <div>JOB #</div> <div>SW- 82 BYNYA</div> </div>	