

**BOUNDARY IDENTIFICATION  
& DETAIL PLAN OF**

LOT 93 IN D.P. 12749  
AT No.43 FLORENCE TCE., SCOTLAND ISLAND.  
SCALE 1:100@A0 DATUM A.H.D.

**SITE AREA = 951.0 M SQ.**

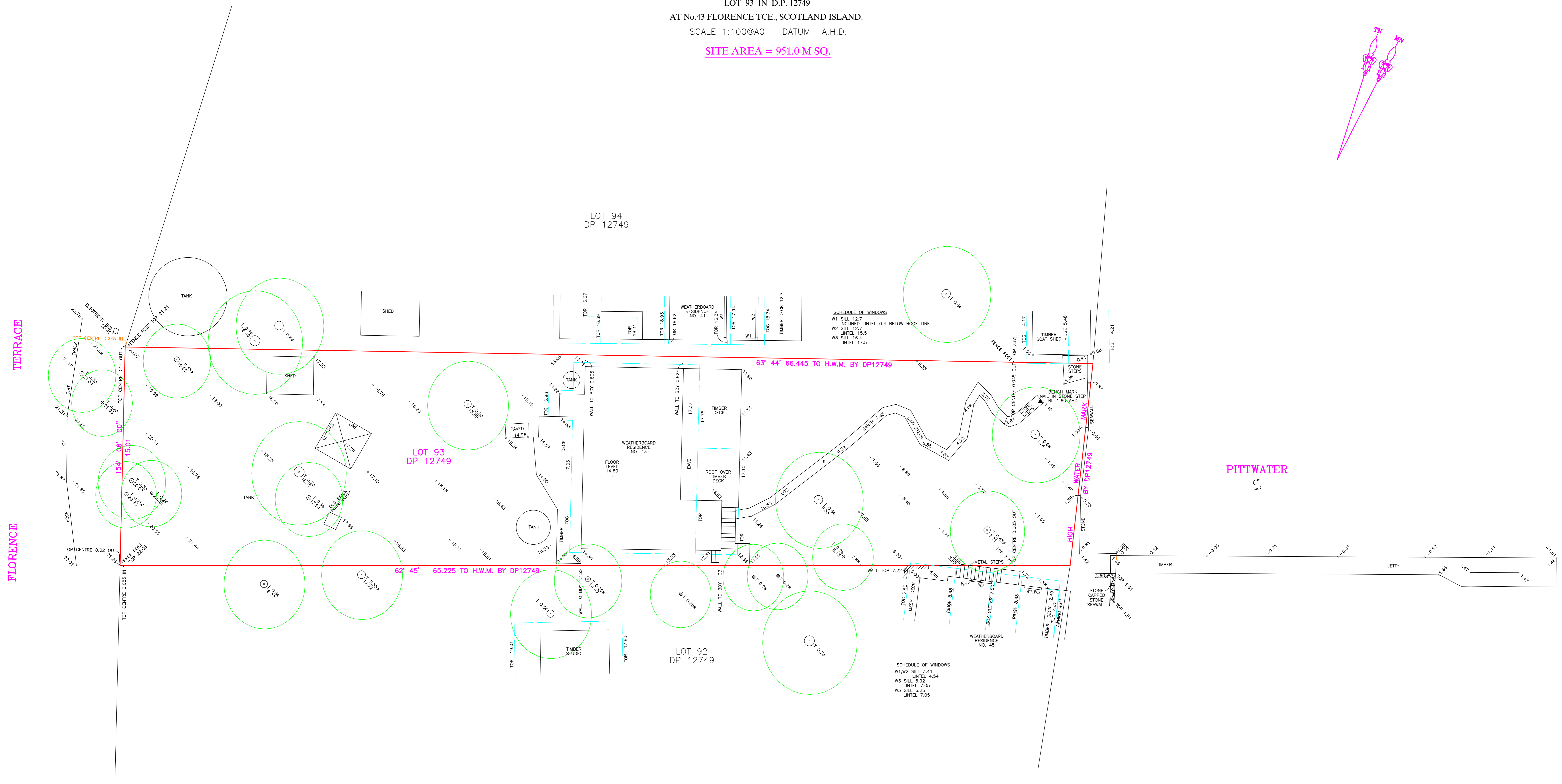
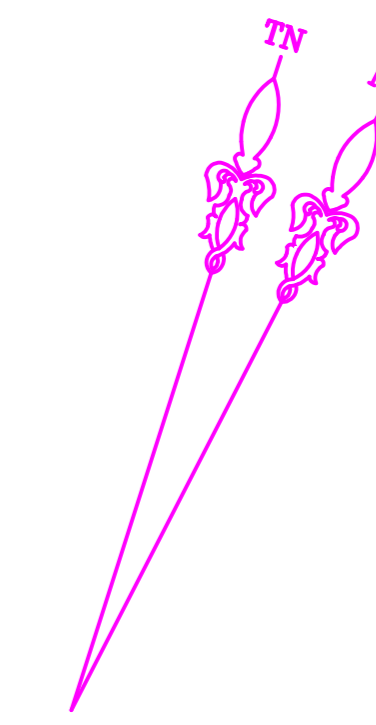

- NOTES:
1. CAUTION: SHOULD ANY DEVELOPMENT OR CONSTRUCTION BE PLANNED ON OR NEAR THE BOUNDARIES, THE BOUNDARIES SHOULD BE CLEARLY MARKED ON SITE.
  2. SERVICES SHOWN HEREON HAVE BEEN DETERMINED FROM VISUAL EVIDENCE ONLY. PRIOR TO ANY DEMOLITION, EXCAVATION OR CONSTRUCTION ON THE SITE THE RELEVANT AUTHORITY SHOULD BE CONTACTED TO ESTABLISH DETAILED LOCATION AND DEPTH. MINIMISE YOUR RISK AND DIAL 1100 BEFORE YOU DIG.
  3. BOUNDARY IDENTIFICATION AND DETAIL PLAN BY DAVID PARSONS, REGISTERED SURVEYOR NO.1819. BOUNDARIES HAVE BEEN DETERMINED ON 15/12/2021, BEARINGS SHOWN ARE BASED ON A MAGNETIC MERIDIAN.
  4. W DENOTES WINDOW, D DENOTES DOOR, WINDOW AND DOOR DEPTHS SHOWN ARE INDICATIVE ONLY.
  5. ALL NEW WORKS MUST REFER TO THE BENCHMARK FOR LEVEL CONTROL.
  6. TREE SPREADS ARE DIAGRAMMATIC ONLY AND MAY NOT BE SYMMETRICAL.
  7. SWW, BRW, BLKRW, LW, SLRW - DENOTE STONE, BRICK, BLOCK, LOG OR SLEEPER RETAINING WALL.
  8. TOG, TOR DENOTE TOP OF GUTTER OR ROOF, K DENOTES TOP OF KERB, C DENOTES ROAD GUTTER.
  9. SUBJECT LAND IS AFFECTED BY A COVENANT NO. D973693 WHICH HAS NOT BEEN INVESTIGATED.

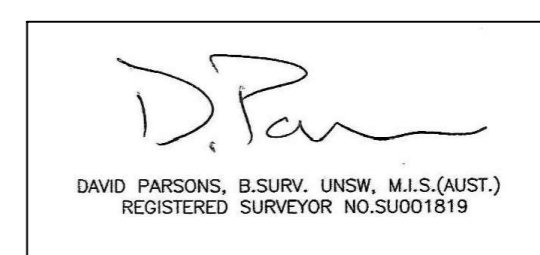

**DP SURVEYING**  
REGISTERED LAND & ENGINEERING SURVEYORS  
55 WHALE BEACH RD, AVALON BEACH 2107  
PHONE : 0414183220  
EMAIL : david@dpurveying.com.au  
DATE : 15 DECEMBER, 2021  
MY REF : 3452