

02/07/2024

Watershed Building Group
68 Delmar Parade
DEE WHY NSW 2099

Ref:1676

RE: BUILDING COMPLIANCE SURVEY
PROPERTY: 68 DELMAR PARADE, DEE WHY NSW 2099

As instructed, I have surveyed part of the land comprised in Folio Identifier 192/506377, being lot 192 in Deposited Plan 506377, in the Local Government area of Northern Beaches, Parish of Manly Cove, County of Cumberland.

The survey is for building compliance purposes only. This report must not be used for any other matter or purpose.

The date of the survey was 10/10/2022.

I attended the above-mentioned property and located:

- A newly constructed 3 storey concrete and clad addition, roofed in metal.
- A newly constructed swimming pool at the rear of the property.

In my opinion:

The relationship between the new works and the boundaries of the land are shown on the attached plan.

Reduced levels relative to Australian Height Datum (AHD) are shown on the attached plan.

Encumbrances and rights affecting Title have not been investigated as part of this survey.

The report was updated on 02/07/2024 to show offsets from the granny flat to the property boundaries.

Regards



Michael Joyce
Registered surveyor
ID. 8268

ORIGIN OF LEVELS:
 DATUM: AUSTRALIAN HEIGHT DATUM
 BM ADOPTED: PM 2844
 R.L.50.04
 SOURCE: SCIMS

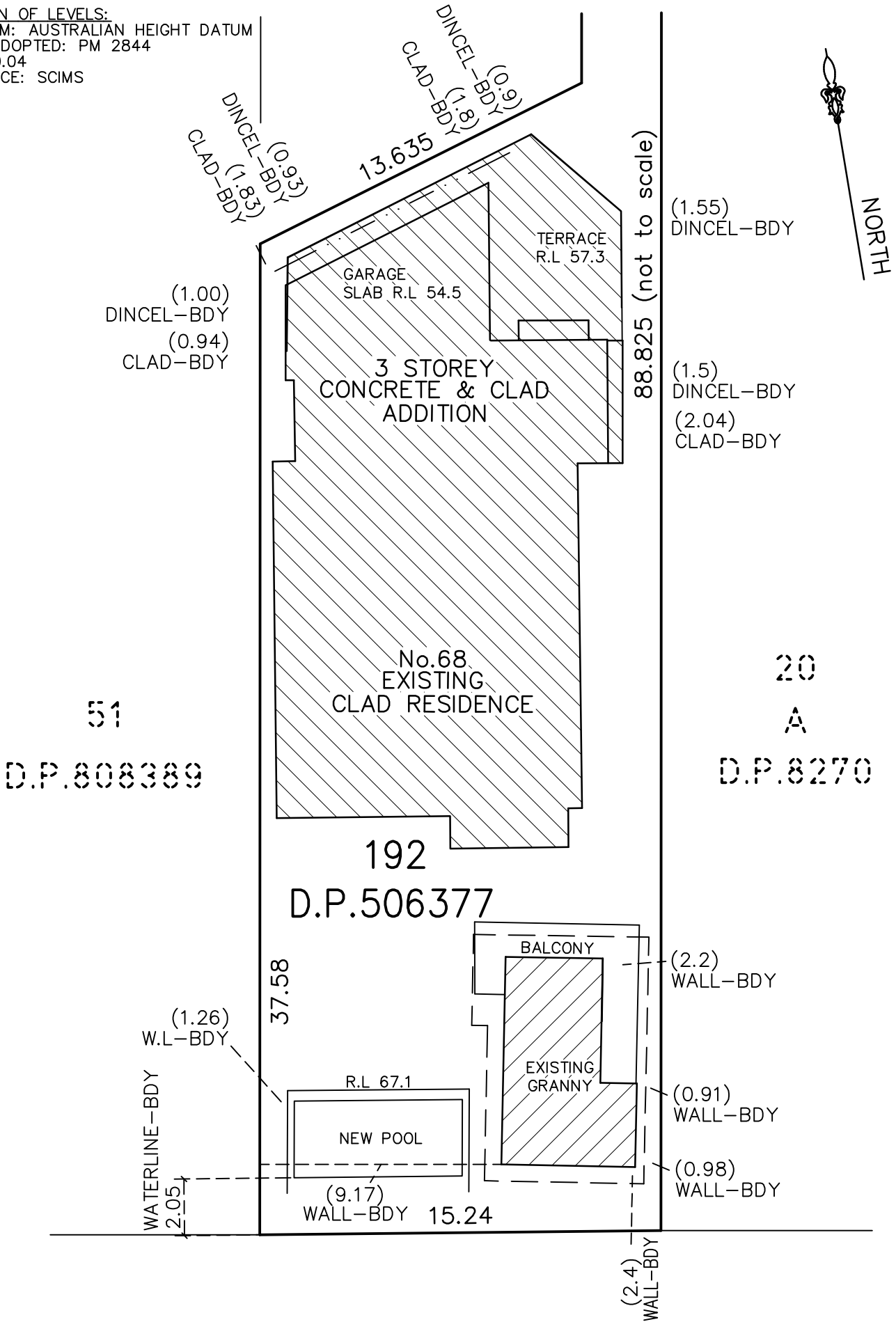
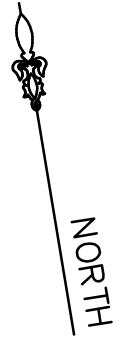

Waterview
 SURVEYING SERVICES
 PO BOX 310, MONA VALE NSW 1660
 ACN 610 583 572
 michael@wvsurveying.com.au
 0474 843 180

[Handwritten Signature]

 REGISTERED SURVEYOR

THIS IS PAGE 2 OF MY REPORT DATED 02/07/24		
SURVEY INSTRUCTION 1676	SCALE NOT TO SCALE	DATE OF SURVEY 10/10/22 & 02/07/24
DRAWING NAME 1676compliance I		ISSUE I
CAD FILE 1676compliance I.dwg		