

LOT 19 / SEC 01
DP 7022



**THIS PLAN IS TO BE READ IN
CONJUNCTION WITH
THE CONDITIONS OF DEVELOPMENT
CONSENT**

DA2025/222645

LOT 20 / SEC 01
DP 7022

DRIVEWAY

LOT 21 / SEC 01
DP 7022

LOT 22 / SEC 01
DP 7022

PILU BARETTO

THE PILU PAVILION

THE BALCONY ROOM

PILU RESTAURANT

LOT B
DP 329073

LOT A
DP 329073

THE GARDEN ROOM

UNDERCLIFF ROAD

NOTES:

THIS SITE PLAN HAS BEEN DRAWN BY
THE REFERENCING AND OVERLAY OF
SITE SURVEY AND AERIAL IMAGERY IN
AUTOCAD.

SITE PLAN FOR INFORMATION.
CONFIRM ALL BUILDINGS AND
ELEMENTS WITH EXISTING AND NEW
SITE SURVEY INFORMATION.

SURVEY

PLAN No. A1 - 11104D, ISSUE A, 18/10/20
"LEVEL & DETAIL OVER PART OF LOT B IN DP329073 &
PART OF ADJOINING LANDS No. 80 UNDERCLIFF ROAD,
FRESHWATER"

PLAN No. A1 - 10837D2, ISSUE B, 03/02/17
"LEVEL & DETAIL SURVEY OF SECTIONS 1, 2 & 3
FRESHWATER BEACH, FRESHWATER"

AERIAL

APPLE MAPS
AERIAL RETRIEVED 16/08/2022

VENUE

KEY VENUE

- THE PILU PAVILION
- OUTDOOR TERRACE

© This work is copyright. Apart from any use permitted under the copyright act
1986, no part may be reproduced by any process, nor may any other
exclusive right be exercised, without the permission of McIntosh & Phelps Pty
Ltd, Australia.



LEGEND KEY PLAN

USE DIMENSIONS IN PREFERENCE TO SCALING
CHECK ALL DIMENSIONS ON SITE

200MM

300MM ON ORIGINAL

REVISION

| ISS | DATE | COMMENT |
|-----|------------|---------------------|
| A | 29/09/2022 | SITE PLAN |
| B | 11/10/2022 | SITE PLAN - AMENDED |

LANDSCAPE ARCHITECT

MONTOSH & PHELPS
12/2021 1401

McINTOSH&PHELPS

ARCHITECTURE
LANDSCAPE ARCHITECTURE

Suite 311, 350 George Street
Sydney NSW 2000
02 9221 1401
info@mcintoshandphelps.com.au
ABN: 78 612 181 689
Registered Architect
William Phelps ARN 6675
www.mcintoshandphelps.com.au

CLIENT

PILU RESTAURANT

NORTH



PROJECT
PILU BARETTO
Moore Rd, Freshwater
NSW 2096

DRAWING TITLE
SITE PLAN

SCALE @ A1

1:100

DRAWN
GM

APPROVED TO ISSUE

GLENN MUNTOSH AIA

SCALE @ A1

1:200

VERIFIED
GM

CONTRACT NUMBER

0000000

SHEET NO

L01

ISSUE

B

EXISTING ACCESSIBLE WC

PROPOSED WET AREA REFURBISHMENT (INDICATIVE LAYOUT)

NOTES:

THIS SITE PLAN HAS BEEN DRAWN BY THE REFERENCING AND OVERLAY OF SITE SURVEY, AERIAL IMAGERY AND ORIGINAL DRAWINGS BY LOUIS D. MAURER (DEC. 1980) UPDATED WITH SITE MEASURE IN AUTOCAD.

SITE PLAN FOR INFORMATION. CONFIRM ALL BUILDINGS AND ELEMENTS WITH EXISTING AND NEW SITE SURVEY INFORMATION.

SURVEY

PLAN No. A1 - 11104D, ISSUE A, 18/10/20
"LEVEL & DETAIL OVER PART OF LOT B IN DP329073 & PART OF ADJOINING LANDS No. 80 UNDERCLIFF ROAD, FRESHWATER"

PLAN No. A1 - 10837D2, ISSUE B, 03/02/17
"LEVEL & DETAIL SURVEY OF SECTIONS 1, 2 & 3 FRESHWATER BEACH, FRESHWATER"

AERIAL

APPLE MAPS
AERIAL RETRIEVED 16/08/2022

VENUE DINING ZONES

| KEY | DINING ZONE | PAX. |
|-----|---------------|------|
| (A) | 'FLOORBOARDS' | 20 |
| (B) | 'VERANDAH' | 30 |
| (C) | 'BLUE ROOM' | 10 |
| (D) | 'GARDEN ROOM' | 20 |

© This work is copyright. Apart from any use permitted under the copyright act 1986, no part may be reproduced by any process, nor may any other exclusive right be exercised, without the permission of McIntosh & Phelps Pty Ltd, Australia.

LEGEND KEY PLAN



USE DIMENSIONS IN PREFERENCE TO SCALING
CHECK ALL DIMENSIONS ON SITE

200MM

300MM ON ORIGINAL

| REVISION | ISS | DATE | COMMENT |
|----------|------------|------|-----------------------------------|
| A | 19/02/2023 | | UPPER GROUND FLOOR PLAN |
| B | 17/10/2024 | | UPPER GROUND FLOOR PLAN - AMENDED |

LANDSCAPE ARCHITECT
MCINTOSH & PHELPS
12/2021 1401

McINTOSH & PHELPS
ARCHITECTURE
LANDSCAPE ARCHITECTURE
Suite 311, 350 George Street
Sydney NSW 2000
02 9221 1401
info@mcintoshandphelps.com.au
ABN: 78 612 181 689
Registered Architect
William Phelps ARN 6675
www.mcintoshandphelps.com.au

CLIENT
PILU RESTAURANT

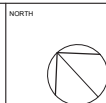

PROJECT
PILU BARETTO
Moore Rd, Freshwater
NSW 2096
DRAWING TITLE
UPPER GROUND FLOOR PLAN 1
GENERAL VENUE SEATING

SCALE @ A1
1:50
SCALE @ A2
1:100
DRAWN
GM
VERIFIED
GM
APPROVED TO ISSUE
GLENN MCINTOSH AILA

CONTRACT NUMBER
00000000

SHEET NO
L02
ISSUE
B



THIS PLAN IS TO BE READ IN CONJUNCTION WITH THE CONDITIONS OF DEVELOPMENT CONSENT

DA2025/222645

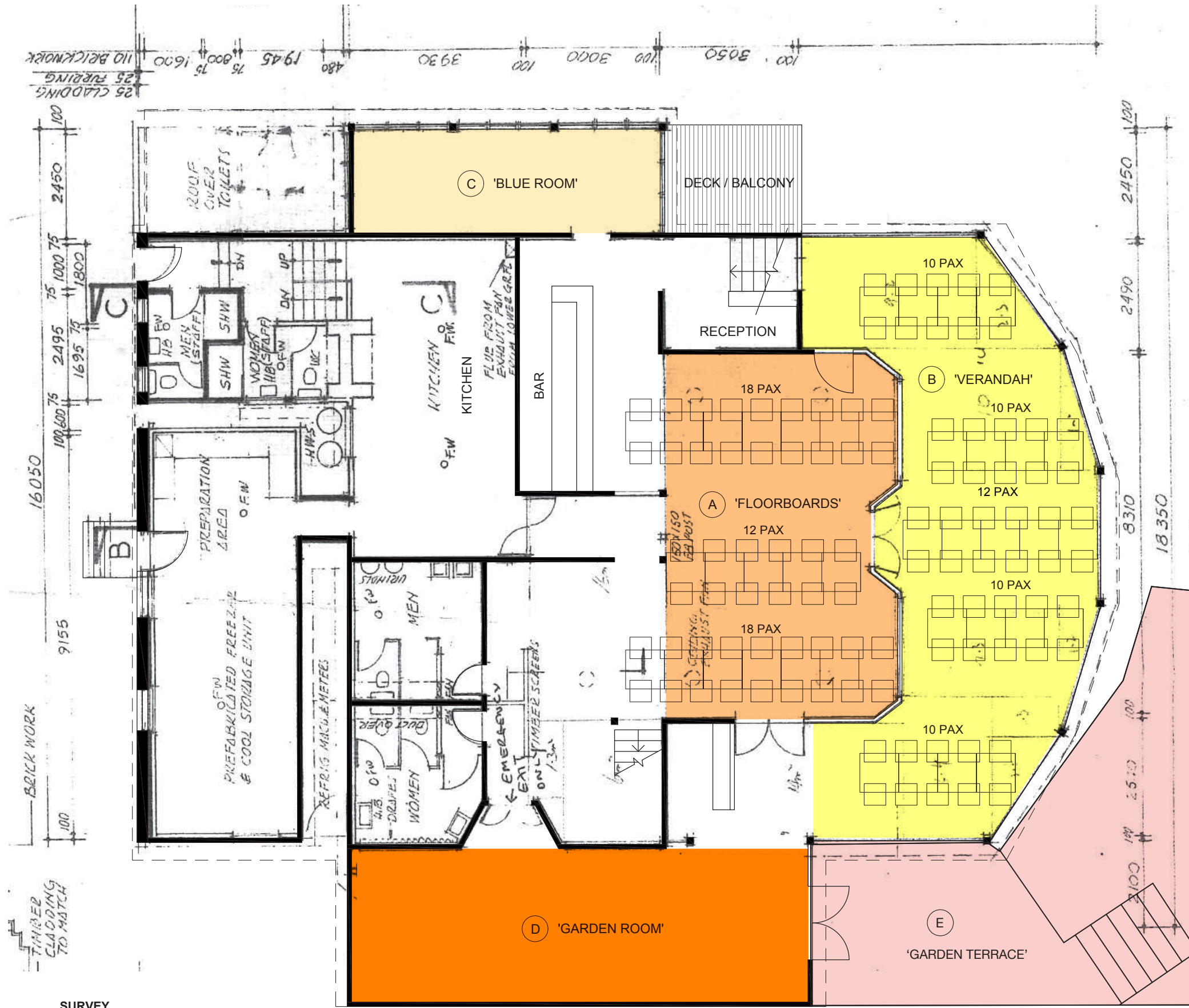

northern beaches council

THIS PLAN IS TO BE READ IN CONJUNCTION WITH THE CONDITIONS OF DEVELOPMENT CONSENT

DA2025/222645

NOTES:

THIS SITE PLAN HAS BEEN DRAWN BY THE REFERENCING AND OVERLAY OF SITE SURVEY, AERIAL IMAGERY AND ORIGINAL DRAWINGS BY LOUIS D. MAURER (DEC. 1980) UPDATED WITH SITE MEASURE IN AUTOCAD.

SITE PLAN FOR INFORMATION. CONFIRM ALL BUILDINGS AND ELEMENTS WITH EXISTING AND NEW SITE SURVEY INFORMATION.

SURVEY

PLAN No. A1 - 11104D, ISSUE A, 18/10/20
"LEVEL & DETAIL OVER PART OF LOT B IN DP329073 & PART OF ADJOINING LANDS No. 80 UNDERCLIFF ROAD, FRESHWATER"

PLAN No. A1 - 10837D2, ISSUE B, 03/02/17
"LEVEL & DETAIL SURVEY OF SECTIONS 1, 2 & 3 FRESHWATER BEACH, FRESHWATER"

AERIAL

APPLE MAPS
AERIAL RETRIEVED 16/08/2022

| VENUE DINING ZONES | | |
|--------------------|------------------|------|
| KEY | DINING ZONE | PAX. |
| (A) | 'FLOOR BOARDS' | 20 |
| (B) | 'VERANDAH' | 30 |
| (C) | 'BLUE ROOM' | ~ |
| (D) | 'GARDEN ROOM' | ~ |
| (E) | 'GARDEN TERRACE' | ~ |

© This work is copyright. Apart from any use permitted under the copyright act 1986, no part may be reproduced by any process, nor may any other exclusive right be exercised, without the permission of McIntosh & Phelps Pty Ltd, Australia.

McINTOSH & PHELPS

ARCHITECTURE
LANDSCAPE ARCHITECTURE

Suite 311, 350 George Street
Sydney NSW 2000
02 9221 1401
info@mcintoshandphelps.com.au
ABN: 78 612 181 689
Registered Architect
William Phelps ARN 6675
www.mcintoshandphelps.com.au

CLIENT
PILU RESTAURANT

NORTH

PROJECT
PILU BARETTO
Moore Rd, Freshwater
NSW 2096

DRAWING TITLE
UPPER GROUND FLOOR PLAN 2
VENUE HIRE SEATING

SCALE @ A1
1:50

SCALE @ A2
1:25

CONTRACT NUMBER
00000000

SHEET NO
L03

ISSUE
B

REVISION

| ISS | DATE | COMMENT |
|-----|------------|---|
| A | 19/02/2023 | UPPER GROUND FLOOR PLAN |
| B | 12/03/2024 | UPPER GROUND FLOOR PLAN, 'GARDEN TERRACE' |

LANDSCAPE ARCHITECT
McINTOSH & PHELPS
02 9221 1401

DRAWN
GM

VERIFIED
GM

APPROVED TO ISSUE
GLEN MUNTOSH AILA

LEGEND KEY PLAN

USE DIMENSIONS IN PREFERENCE TO SCALING

200MM

300MM ON ORIGINAL