

WYUNA AVENUE

23.35
23.38
23.77
24.00

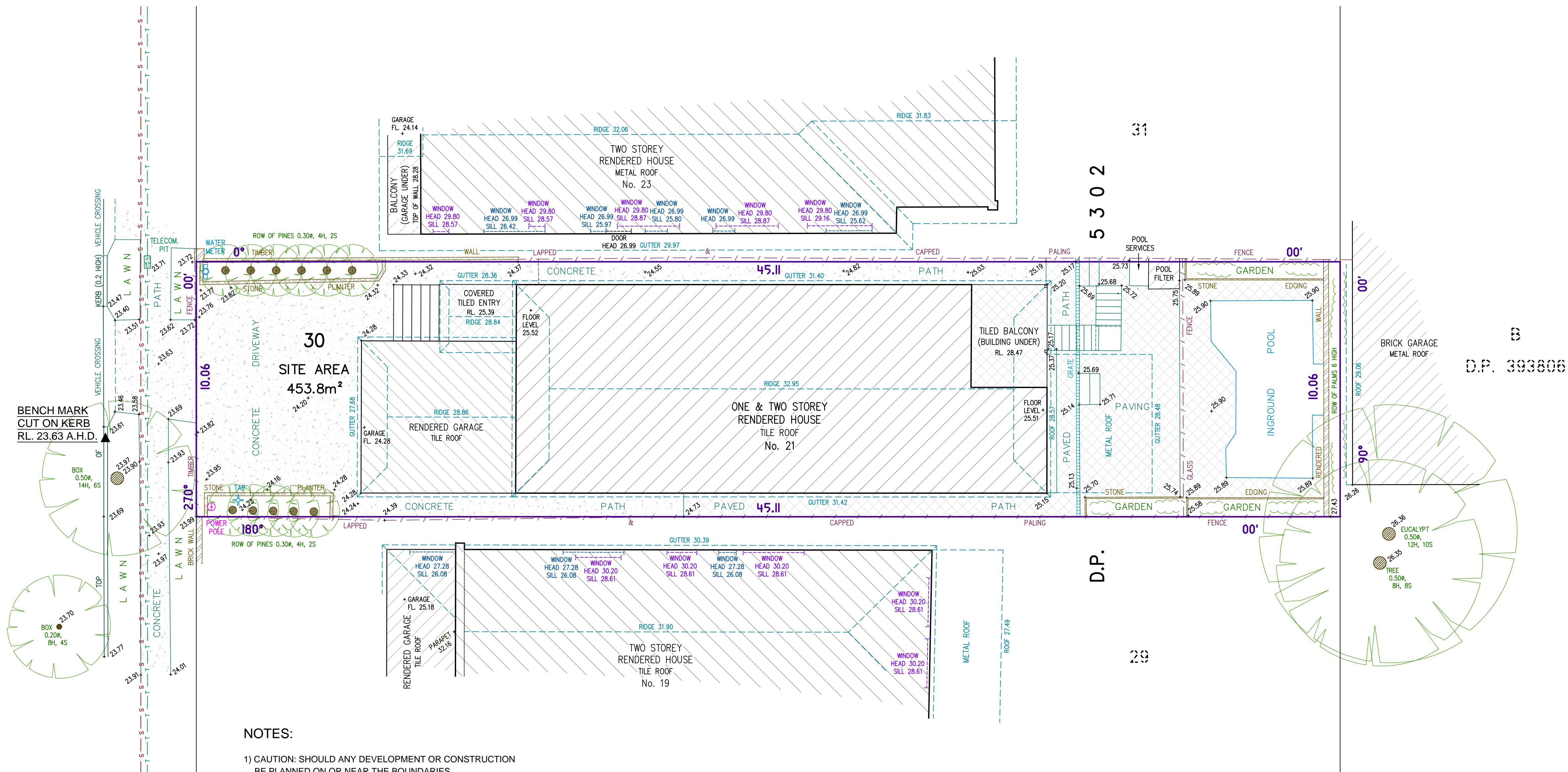

NOTES:

- CAUTION: SHOULD ANY DEVELOPMENT OR CONSTRUCTION BE PLANNED ON OR NEAR THE BOUNDARIES, THE BOUNDARIES SHOULD BE CLEARLY MARKED ON SITE.
- AREA AND DIMENSIONS HAVE BEEN SURVEYED FROM PLANS MADE AVAILABLE AT LAND REGISTRY SERVICES.
- ORIGIN OF LEVELS ON A.H.D. IS TAKEN FROM P.M. 2230 RL 20.79 A.H.D.
- TREE SPREADS ARE DIAGRAMMATIC ONLY AND ARE NOT SYMMETRICAL.
- UNDERGROUND (NON VISIBLE) SERVICE LINES HAVE BEEN SHOWN FROM "DIAL BEFORE YOU DIG" SERVICE AUTHORITY RECORDS & ARE DIAGRAMMATIC ONLY IN REGARD TO THEIR POSITION & WIDTH UNLESS STATED OTHERWISE.
- SPOT LEVELS ARE ACCURATE.
- BEARINGS SHOWN ARE ON MAGNETIC MERIDIAN.

INVESTIGATION OF "DIAL BEFORE YOU DIG" UNDERGROUND SERVICES HAS BEEN MADE. DETECTION OF UNDERGROUND SERVICES IS NOT AN INTEGRAL PART OF THIS SURVEY. ALL RELEVANT AUTHORITIES SHOULD BE NOTIFIED PRIOR TO ANY EXCAVATION ON OR NEAR THE SITE

DEVELOPERS & EXCAVATORS MAY BE HELD FINANCIALLY RESPONSIBLE BY THE ASSET OWNER SHOULD THEY DAMAGE UNDERGROUND NETWORKS.

CARELESS DIGGING CAN:
- CAUSE DEATH OR SERIOUS INJURY TO WORKERS AND THE GENERAL PUBLIC
- INCONVENIENCE USERS OF ELECTRICITY, GAS, WATER AND COMMUNICATIONS
- LEAD TO CRIMINAL PROSECUTION AND DAMAGES CLAIMS
- CAUSE EXPENSIVE FINANCIAL LOSSES TO BUSINESS
- CUT OFF EMERGENCY SERVICES
- DELAY PROJECT COMPLETION TIMES WHILE THE DAMAGE IS REPAIRED

MINIMISE YOUR RISK AND DIAL BEFORE YOU DIG.
TEL. 1100

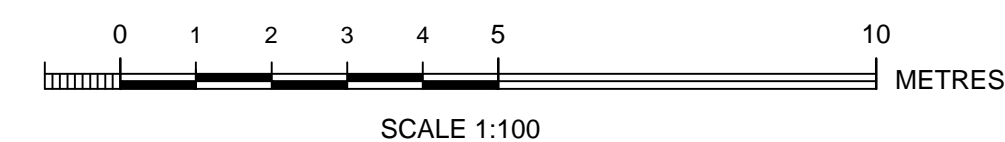

Bee & Lethbridge Pty Ltd
Suite 2, 14 Starkey Street,
PO Box 330, Forestville, NSW 2087
Phone: 9451 6757 Fax: 9975 3535
Email: survey@beeleth.com.au
ABN: 13 003 194 447
www.beeleth.com.au

LEGEND



TREE
0.10m,
5H, 4S
DENOTES APPROX. 0.10m DIAMETER OF TREE
DENOTES APPROX. 5m HEIGHT OF TREE
DENOTES APPROX. 4m SPREAD OF TREE

BOARDS SEWER
S S S S S S S S
TELECOMMUNICATION LINES
T T T T T T T T

Q
GUTTER
DENOTES CENTRE LINE OF ROAD
DENOTES TOP OF GUTTER

PLAN SHOWING BOUNDARIES, RELATIVE HEIGHTS & PHYSICAL FEATURES OVER LOT 30 IN D.P. 5302 KNOWN AS No. 21 WYUNA AVENUE, FRESHWATER.

L.G.A.: NORTHERN BEACHES

CLIENT	Ms T. MOORE & Mr M. SZYMANSKI			REF No.
PROPERTY	No. 21 WYUNA AVENUE, FRESHWATER			16078
DATUM	A.H.D.	SCALE	1:100 @ A1	DATE
SURVEYED	S.F./S.P.	DRAWN	J.M./S.C.	15/08/2019
		DWG No.	16078A	SHEET No. 1 of 1
		REV No.	00	