



LEGEND

-  SITE ENTRY POINT
-  SOLAR ACCESS

Site Analysis Plan

SEDIMENT CONTROL:

INSTALL SEDIMENT CONTROL STRUCTURES IN LOCATIONS INDICATED ON DRAWINGS AND AS OTHERWISE REQUIRED TO CONTROL SEDIMENT DURING ALL EXCAVATIONS AND WHILST AREAS OF THE SITE ARE EXPOSED TO EROSION.

CONTROL STRUCTURES TO BE AS DETAILED OR AS OTHERWISE REQUIRED.

VIEW CONTROL MEASURES AND MAINTAIN STRUCTURES DURING CONSTRUCTION.

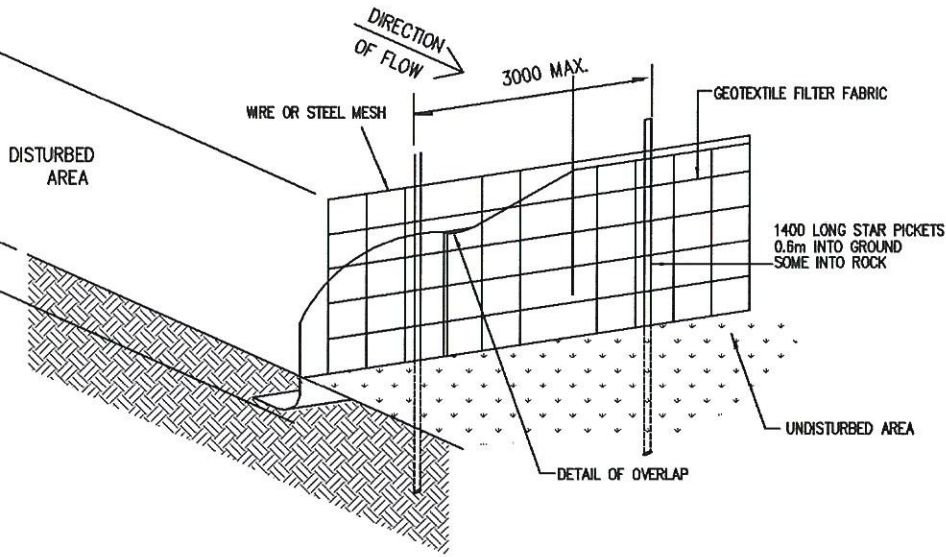

SILT FENCE DETAIL

SCALE = N.T.S.

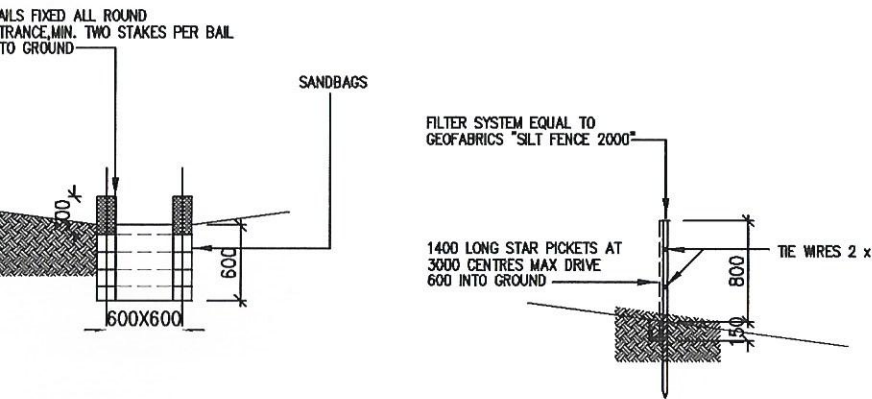

SEDIMENTATION PIT (ALTERNATIVE TO SETTLEMENT POND)

SCHEDULE OF WORKS:

1. SILT FENCE AND ASSOCIATED WORKS INCLUDING INTERCEPTOR DRAIN IS TO BE INSTALLED BEFORE THE COMMENCEMENT OF ANY EXCAVATION.
2. CUTS TO BE EXECUTED TO THE REQUIRED LEVEL USING CONVENTIONAL EXCAVATION MACHINERY. INITIALLY THE DEPTH OF FILL/CLAY IS TO BE ESTABLISHED TO ENSURE NEIGHBOURING PROPERTIES ARE NOT ADVERSELY AFFECTED. EARTH BATTERS TO BE A MAXIMUM SLOPE OF 1.0 m VERT. TO 1.7 m HORIZ. (OR AS PER GEOTECHNICAL REPORT). ANY BATTERS GREATER THAN 1.0 m VERT. TO 1.7 m HORIZ. ARE TO BE ADEQUATELY SHORED IN ACCORDANCE WITH THE ENGINEERS DETAILS AND INSTRUCTIONS.
3. ANY PERMANENT RETAINING STRUCTURE IS TO BE CONSTRUCTED IN ACCORDANCE WITH THE ENGINEERS DETAILS AND INSTRUCTIONS.
4. ALL PERMANENT RETAINING STRUCTURES ARE TO BE COMPLETED WITH MINIMUM DELAY FOLLOWING EXCAVATION.

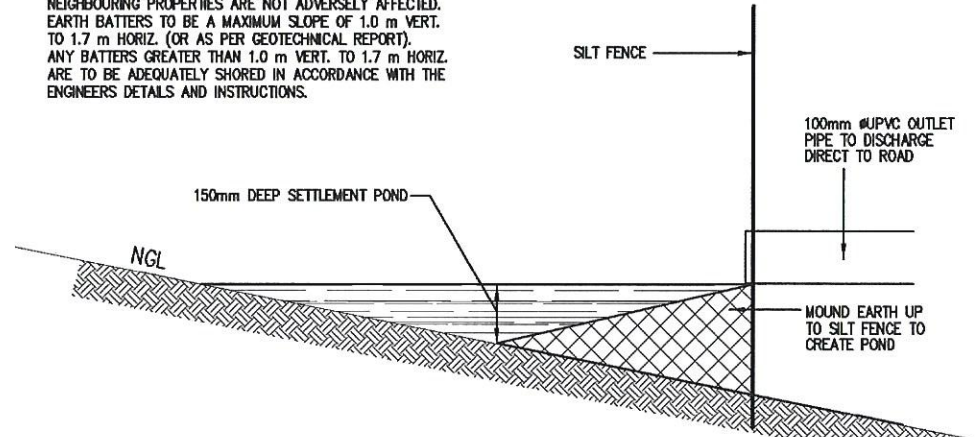

TYPICAL SECTION THROUGH SETTLEMENT POND

SCALE = N.T.S.

IF ADDITIONAL MEASURES ARE REQUIRED FOR EROSION CONTROL OR BY COUNCIL REQUIREMENTS REFER TO "URBAN EROSION AND SEDIMENT CONTROL" GUIDELINES PREPARED BY THE DEPARTMENT OF CONSERVATION AND LAND MANAGEMENT.

SILT FENCE DETAIL 1

CONTRACTOR TO MAINTAIN SILT FENCE IN GOOD WORKING ORDER SECURED WITH PEGS

FILTER SYSTEM EQUAL TO GEOFABRICS "SILT FENCE 2000" SECURED WITH PEGS

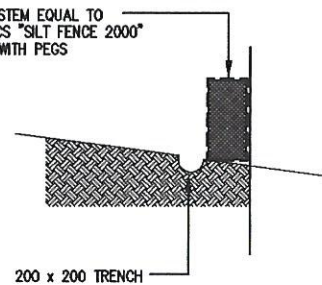

SILT FENCE DETAIL (ALTERNATIVE)

project.
New Residence
for
Mr. & Mrs. Lester
34 Plateau Road
Bilgola Plateau NSW 2107

drawing title.
SEDIMENTATION DRAWING

scale. NTS date. AUG 2021

Draft/person.
ANNA HENRY
AH DESIGN
59 DRESS CIRCLE ROAD, AVALON BEACH NSW 2107
T. 0415 559 737
E. ahdesign@email.com

© COPYRIGHT:
Information contained on this drawing is the copyright of AH DESIGN. Copying of this drawing or part without written permission infringes copyright.

project no.
SED-133

6500

PROPOSED NEW DRIVEWAY

REMOVE PART OF EX. GARAGE, BUILD NEW ENTRY DECK

PROPOSED NEW PARKING BAY

APPROXIMATE LINE OF NEW STORM WATER CONNECTION FROM OSD/WATER TANKS 491

D.P.16902 (BETSY WALLIS RESERVE)

PROPOSED NEW DWELLING

APPROXIMATE LINE OF SILT FENCE, FOR MORE INFORMATION SEE SEP. DRAWING

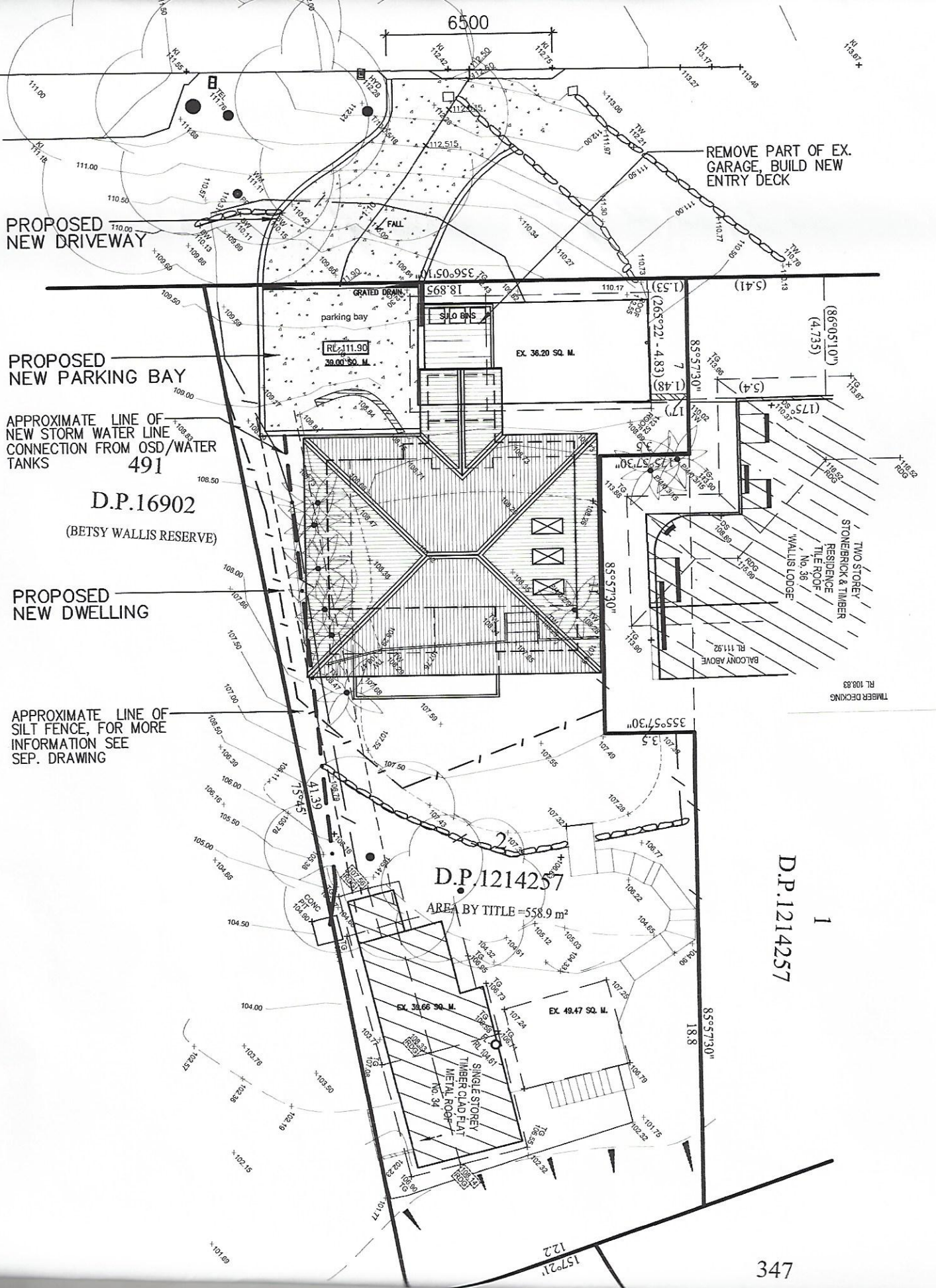

D.P.1214257
1