



NO INVESTIGATION OF UNDERGROUND SERVICES HAS BEEN MADE. ALL RELEVANT AUTHORITIES SHOULD BE NOTIFIED PRIOR TO ANY EXCAVATION ON OR NEAR THE SITE

DEVELOPERS & EXCAVATORS MAY BE HELD FINANCIALLY RESPONSIBLE BY THE ASSET OWNER SHOULD THEY DAMAGE UNDERGROUND NETWORKS.

CARELESS DIGGING CAN:

- CAUSE DEATH OR SERIOUS INJURY TO WORKERS AND THE GENERAL PUBLIC,
- INCONVENIENCE USERS OF ELECTRICITY, GAS, WATER AND COMMUNICATIONS
- LEAD TO CRIMINAL PROSECUTION AND DAMAGES CLAIMS
- CAUSE EXTENSIVE FINANCIAL LOSSES TO BUSINESSES
- CUT OFF EMERGENCY SERVICES
- DELAY PROJECT COMPLETION TIMES WHILE THE DAMAGE IS REPAIRED

MINIMISE YOUR RISK AND DIAL BEFORE YOU DIG. – TEL. 1100

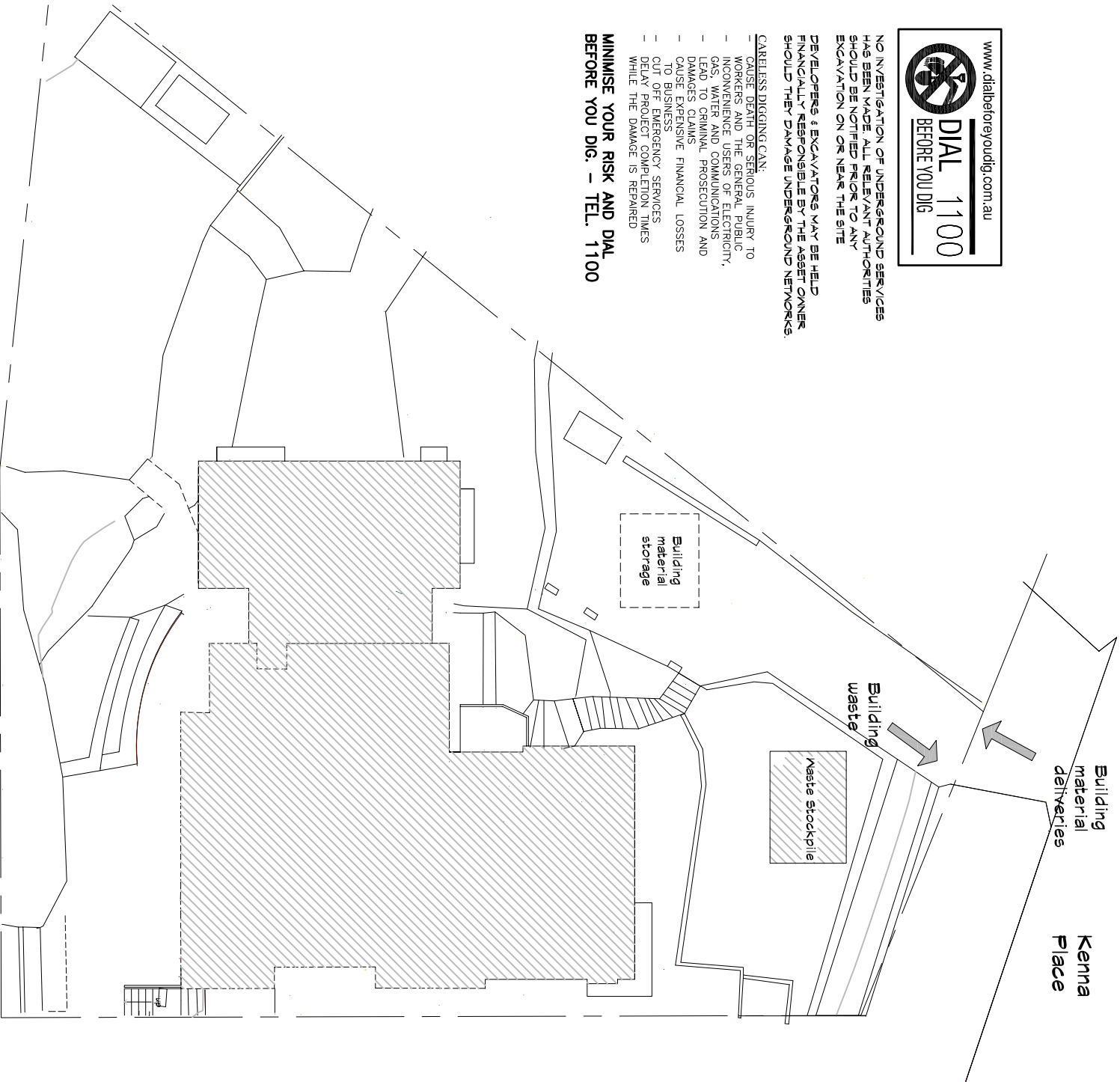

Waste Management Plan

1:200

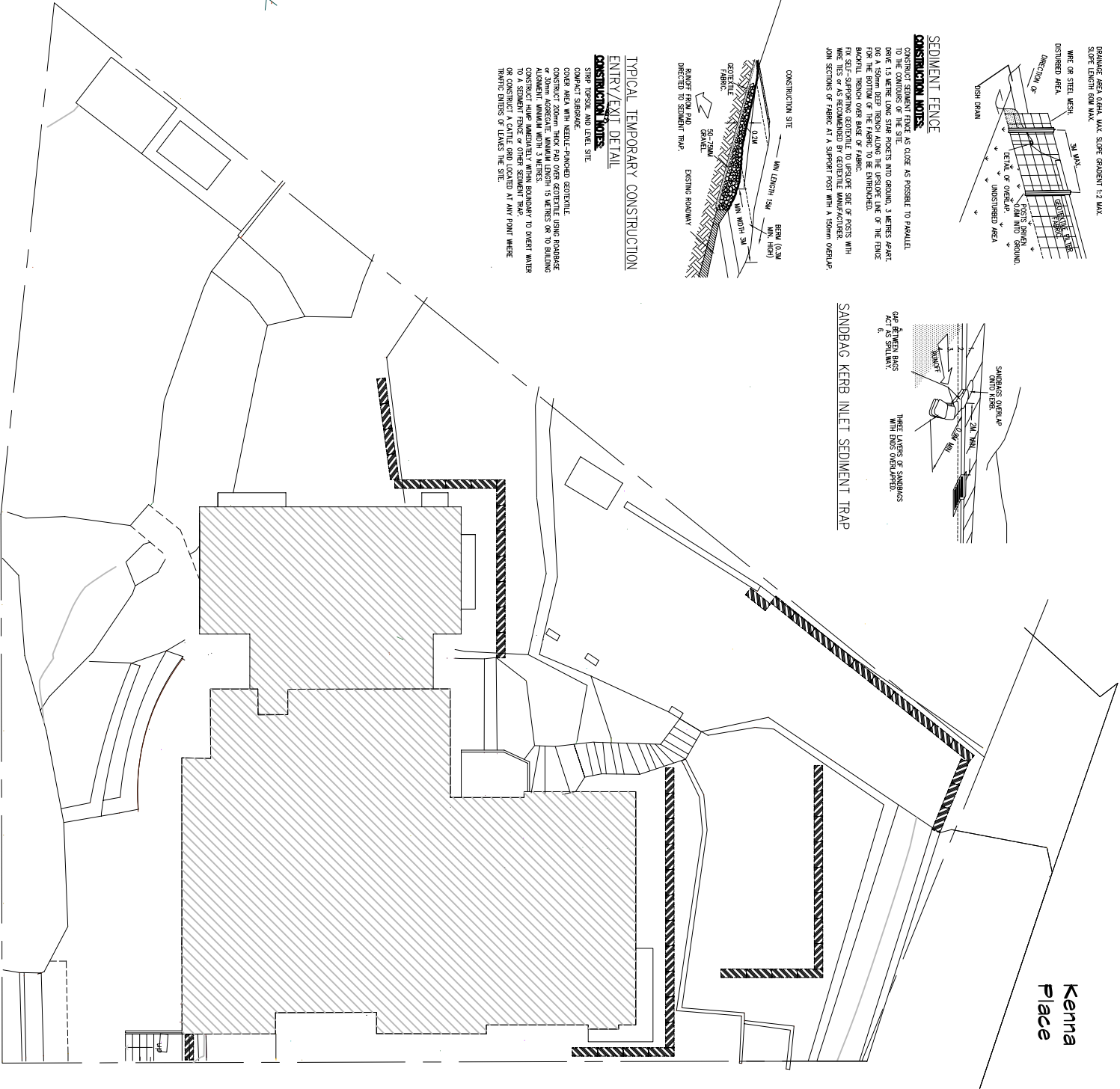

Sediment Control Plan

1:200

All dimensions & setbacks to be checked on site prior to commencement of works & or fabrication of any components. DO NOT scale from drawings. This drawing is subject to copyright			SEAN GILMOUR ARCHITECT (r/n 7973)		PROJECT Devries Residence Lot 17 in DP237862 6 Kenna Place Cromer, NSW, 2099	
Amendments : Issue      Description      By      Date a      DA issue      sg      Jan.2019			ABN 40 824 597 954 54 Smith Avenue Allambi Heights NSW 2100		TEL: (02) 9905 8332 Mobile: 0406 995401 Email: sgkgilmour@optus.net.com.au	
Drawing : Sediment Control Plan & Waste Mangement Plan			Scale : 1:100 @ A3		Dwg : DA-09/a	
			Date : Jan. 2019			