

THIS PLAN IS TO BE READ IN CONJUNCTION WITH THE CONDITIONS OF DEVELOPMENT CONSENT

DA2019/0851

SITE ANALYSIS PLAN

LOT 58 - DP 6167

SITE AREA: 560.8m²

FLOOR AREA CALCULATION:	
SITE AREA:	560.8m ²
EXISTING FLOOR AREA TOTAL	189.5m ²
PROPOSED NEW FLOOR AREA	189.5m ²
TOTAL NEW FLOOR AREA	189.5m ²

TRUE NORTH:

NOTES:

- All structures including stormwater & drainage to engineer's details.
- Do not obtain dimensions by scaling drawings.
- All dimensions are to be checked on site prior to starting work.
- These drawings are to be read in conjunction with all other consultant's drawings and specifications.
- All workmanship & materials shall be in accordance with the requirements of current editions including amendments of the relevant SAA Codes of Practice, the Building Code of Australia and local council requirements.
- New materials are to be used throughout unless otherwise noted.
- Concrete footings, slab, structural beams or any other structural members are to be designed by a practicing engineer.

JJ Drafting

174 Garden St, North Narrabeen, NSW, 2101
PO Box 687, Dee Why, NSW, 2099
Mob. 0414 717 541
Email. jjdraft@tpg.com.au
www.jjdrafting.com.au

REV:	DATE:	DESCRIPTION:

PROJECT DETAILS:

PROPOSED ALTERATIONS AND ADDITIONS
54 MONASH PARADE, DEE WHY

DRAWING TITLE:

SITE ANALYSIS PLAN

DATE: 16/07/2019	DRAWN BY: DB	SCALE: 1:200 @ A3
JOB No: 716/19	CHECKED BY: JJ	DRAWING No: DA.01

NORTH ELEVATION

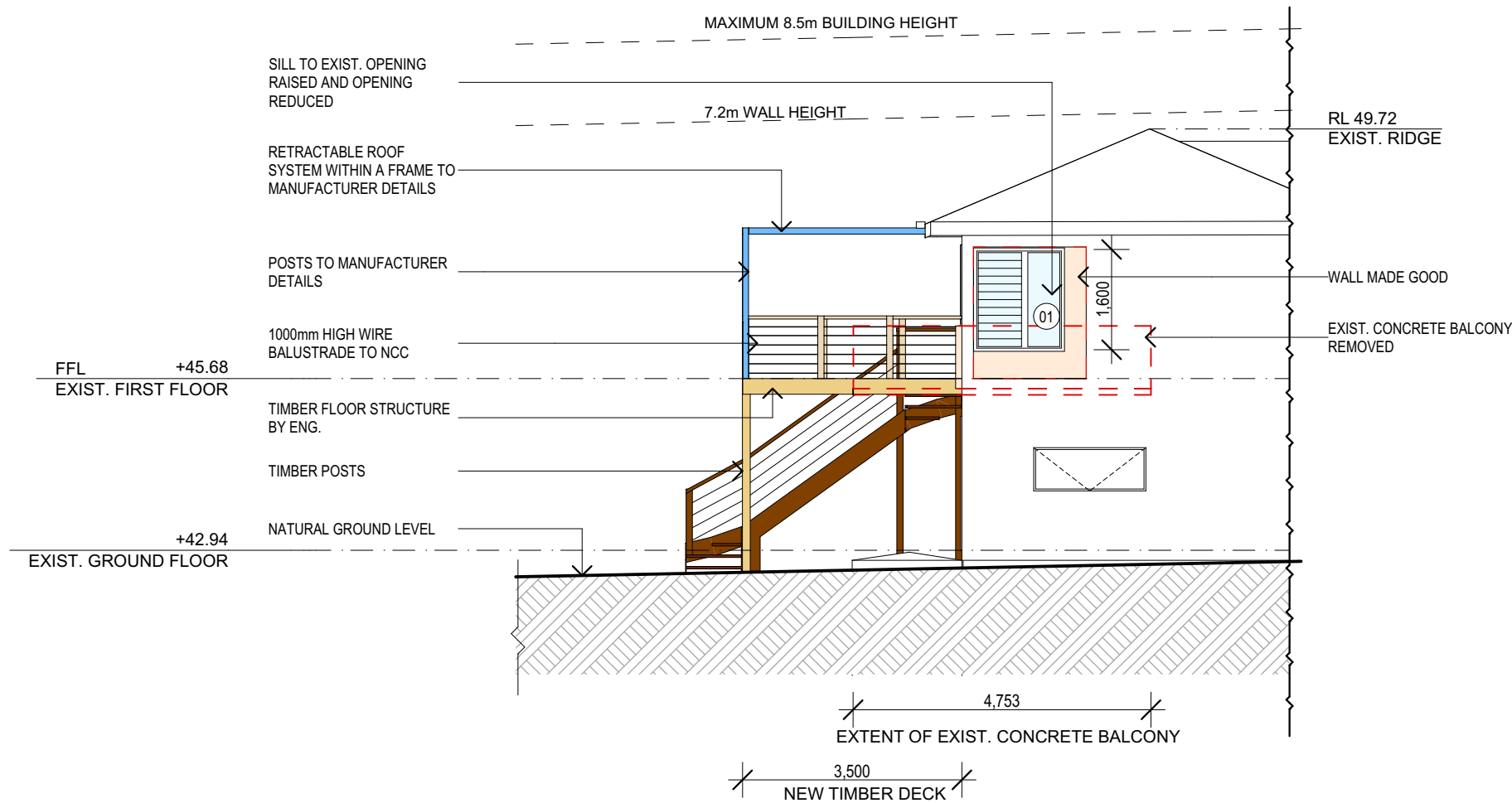

EAST ELEVATION

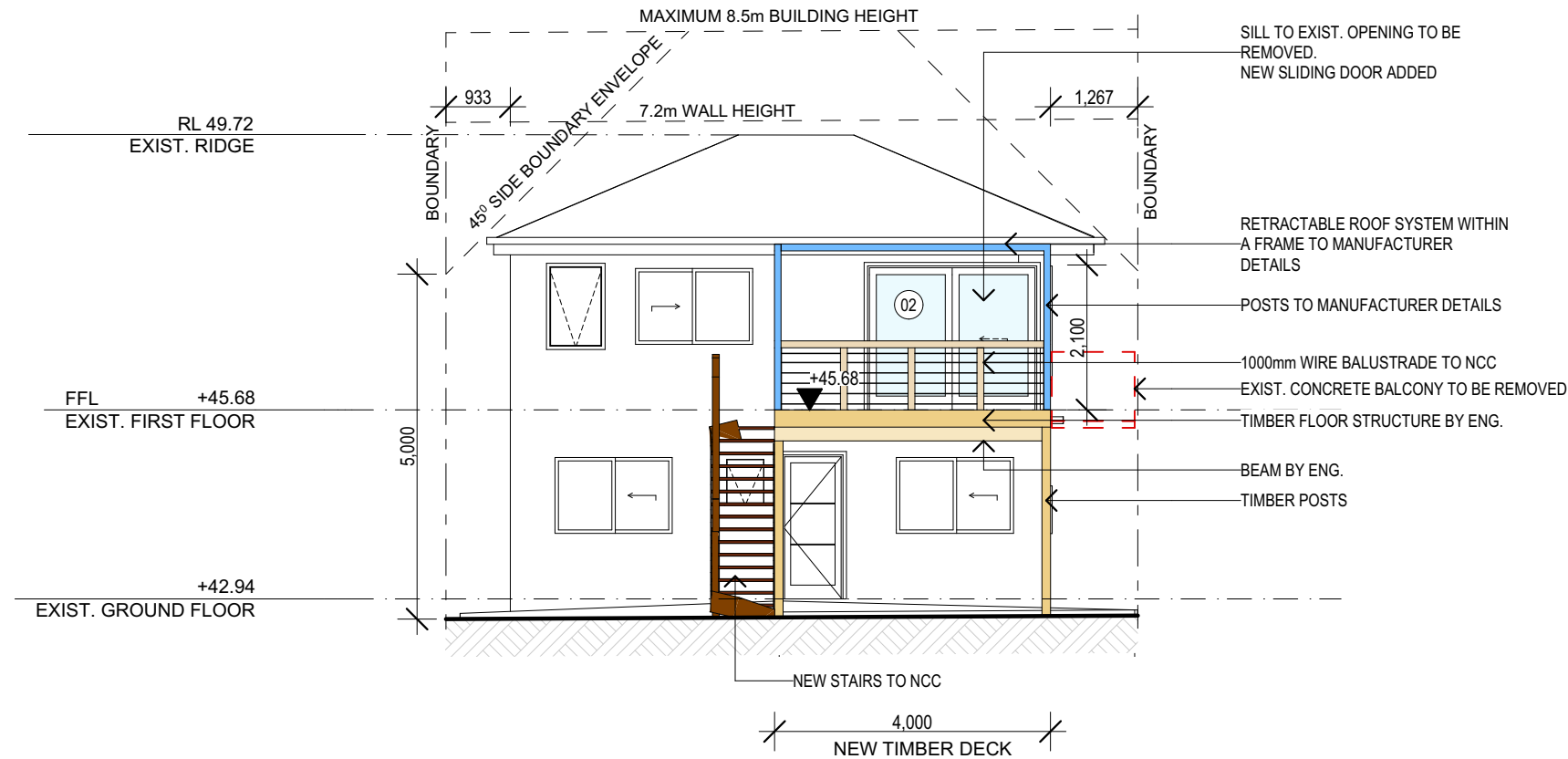

 northern
beaches
council

**THIS PLAN IS TO BE READ IN
CONJUNCTION WITH
THE CONDITIONS OF DEVELOPMENT
CONSENT**

DA2019/0851

TRUE NORTH:	<div>NOTES:</div> <ul style="list-style-type: none">• All structures including stormwater & drainage to engineer's details.• Do not obtain dimensions by scaling drawings.• All dimensions are to be checked on site prior to starting work.• These drawings are to be read in conjunction with all other consultant's drawings and specifications.• All workmanship & materials shall be in accordance with the requirements of current editions including amendments of the relevant SAA Codes of Practice, the Building Code of Australia and local council requirements.• New materials are to be used throughout unless otherwise noted.• Concrete footings, slab, structural beams or any other structural members are to be designed by a practicing engineer.	<div>JJ Drafting</div> <div>174 Garden St, North Narrabeen, NSW, 2101</div> <div>PO Box 687, Dee Why, NSW, 2099</div> <div>Mob. 0414 717 541</div> <div>Email. jjdraft@tpg.com.au</div> <div>www.jjdrafting.com.au</div>	REV:	DATE:	DESCRIPTION:	PROJECT DETAILS:		DATE:	DRAWN BY:	SCALE:
						PROPOSED ALTERATIONS AND ADDITIONS		16/07/2019	DB	1:100 @ A3
						54 MONASH PARADE, DEE WHY				
						DRAWING TITLE:		JOB No:	CHECKED BY:	DRAWING No:
						NORTH & EAST ELEVATION		716/19	JJ	DA.05