

THIS DOCUMENT AND DESIGN REMAIN THE COPYRIGHT AND PROPERTY OF VOORDEKHAAR PARTNERSHIP PTY LTD AND CANNOT BE REPRODUCED IN ANY MANNER WITHOUT PRIOR WRITTEN CONSENT.
 THE CONTRACTOR SHALL VERIFY ALL DIMENSIONS AND LEVELS ON SITE AS THIS IS NOT A WORKSHOP DRAWING.
 SHOULD ANY DISCREPANCY OR OMISSION BE FOUND INCLUDING DISCREPANCIES IN OR DISCREPANCIES BETWEEN THE DRAWINGS AND IN SPECIFICATION, THE CONTRACTOR SHALL BE NOTIFIED IMMEDIATELY SO THAT AN INSTRUCTION MAY BE ISSUED.

REV	DATE	AMENDMENT	APPROVED
A	22-06-00	NEW DWG	HG
B	09-01-01	PRELIMINARY CONSTRUCTION CERTIFICATE	HG
C	04-09-01	ISSUED TO CONSULTANTS	FE
D	03-09-01	ISSUED FOR CONSTRUCTION CERTIFICATE	FE
E	16-01-01	PRELIMINARY CONTRACT SIGN	FE
F	16-01-01	FINAL TENDER SIGN	FE
G	19-01-02	ISSUED FOR CONSTRUCTION	FE

LEGEND

- Potential storage areas for waste and for materials

THE CRESCENT

COMMONWEALTH PARADE

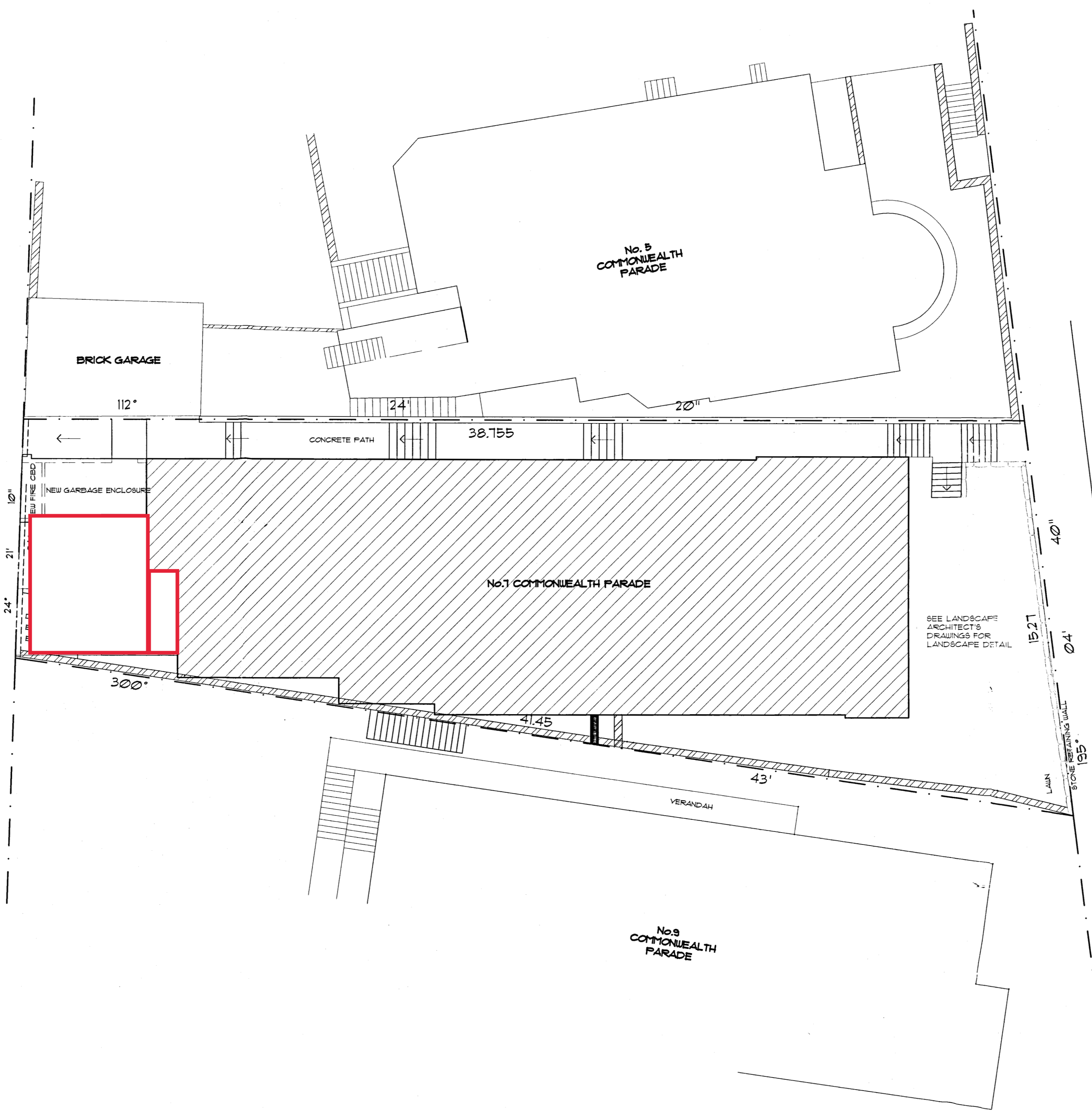

SITEPLAN
SCALE 1:100

CC plans

ARCHITECTURE - INTERIOR DESIGN
 RETAIL DESIGN - CONSTRUCTION
 MANAGEMENT - PROJECT MANAGEMENT
VOORDEKHAAR PARTNERSHIP
 2 / 39 Liverpool Street
 Sydney NSW 2000
 Australia
 Telephone (02) 9264 4888
 Facsimile (02) 9264 4440

CLIENT:
TIPDELL Pty Limited

PROJECT:
MONTREUX APARTMENTS
No. 7 COMMONWEALTH PARADE
MANLY

TITLE:
SITE PLAN

DRWN: HG	DESIGN: GW, BY, DV	DATE: 16 - 6 -
CHKD: 10157-AG-UG	SCALE: 1/100	

DRG No: 10157 - 00	ISSUE: G
--------------------	----------

STATUS: FOR CONSTRUCTION

This document is approved and forms part of Construction Certificate Number
 CR21123 dated 23/07/2002
[Signature]
 Approved Certifier