

REQUIREMENTS FOR SIZE AND ALLOWABLE DISCHARGE FROM ON-SITE DETENTION SYSTEMS

Additional Hard (Impervious) Surface Area (square metres)	Minimum Capacity of On-Site Detention Tank (Litres)	Discharge Rate Litres/Sec
0-50	NI	NI
>50-75	4,500	2
>75-100	6,000	3
>100-150	9,000	4
>150-200	12,000	6
>200-250	15,000	7
>250-300	18,000	9
>300-400	24,000	12
>400-500	30,000	15
>500-600	36,000	18
>600-700	42,000	21
>700-800	48,000	24
>800-900	54,000	27
>900-1,000	60,000	30
>1,000*	A minimum storage capacity of 60 litres per m <sup>2</sup> of additional hard/impervious surface area, and a discharge rate which replicates the discharge from the site were it to be undeveloped.	

STORMWATER OSD DESIGN SUMMARY

SITE AREA = 870 m<sup>2</sup>  
 PROPOSED IMPERVIOUS AREA = 140.4 m<sup>2</sup> ( ROOF + STAIRS + DECK )  
 VOLUME OF OSD AS PER SECTION 5.7 OF PITWATER 21 DCP  
 VOLUME REQUIRED = 9.0 m<sup>3</sup>  
 MAXIMUM DISCHARGE RATE = 4 L/S  
 VOLUME PROVIDED = 9.0 m<sup>3</sup> IN ABOVE GROUND RAINWATER TANKS  
 ORIFICE DIAMETER  
 H = 2.4 m  
 Q = 4 L/S  
 Ø = 35mm

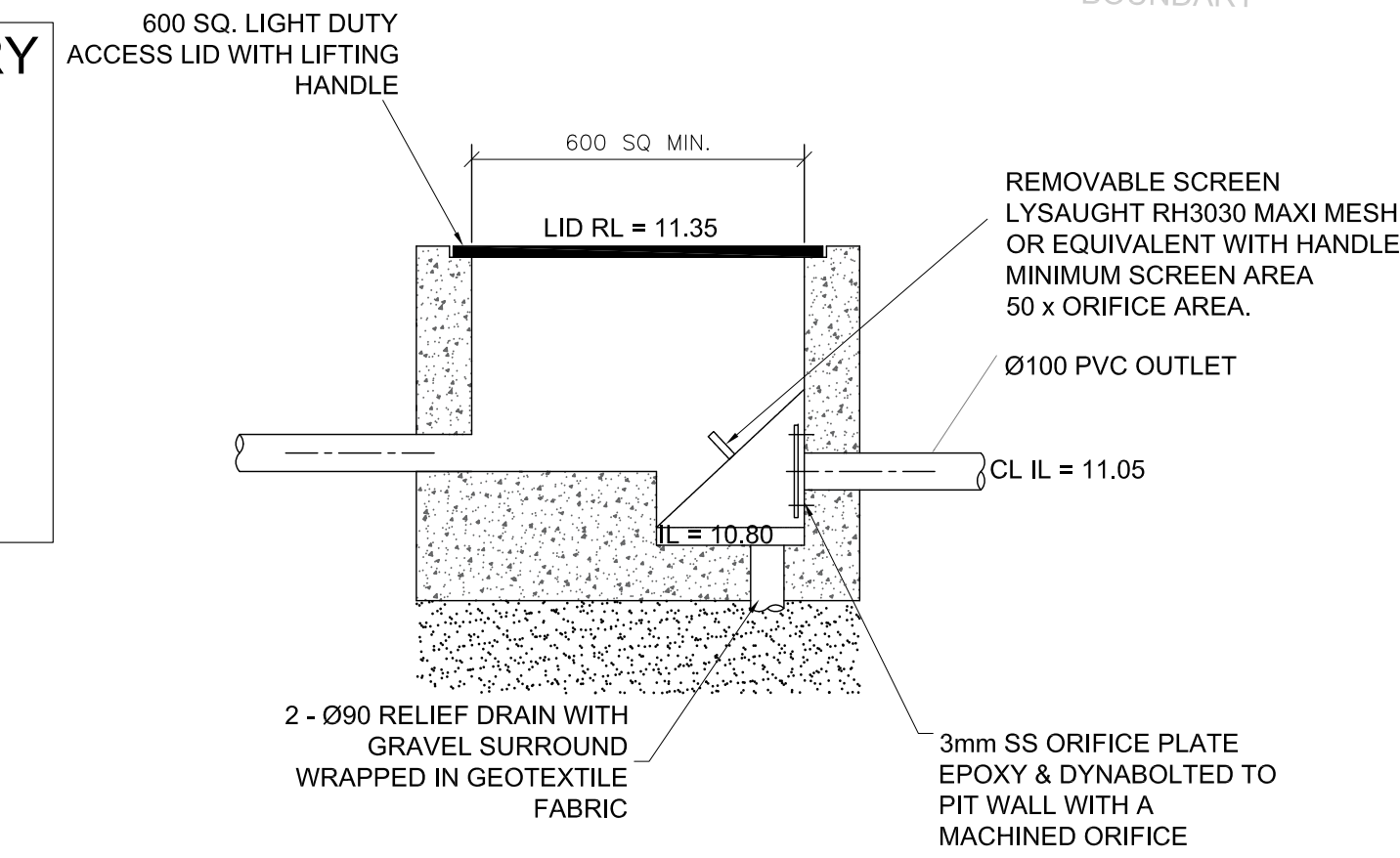
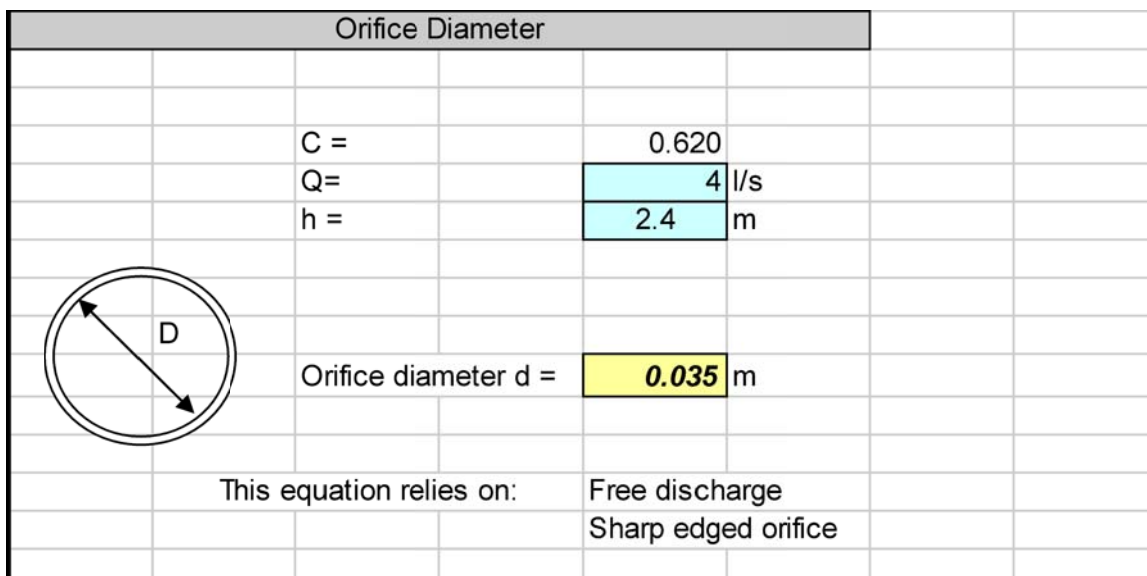

JP SECTION AT OUTLET NTS

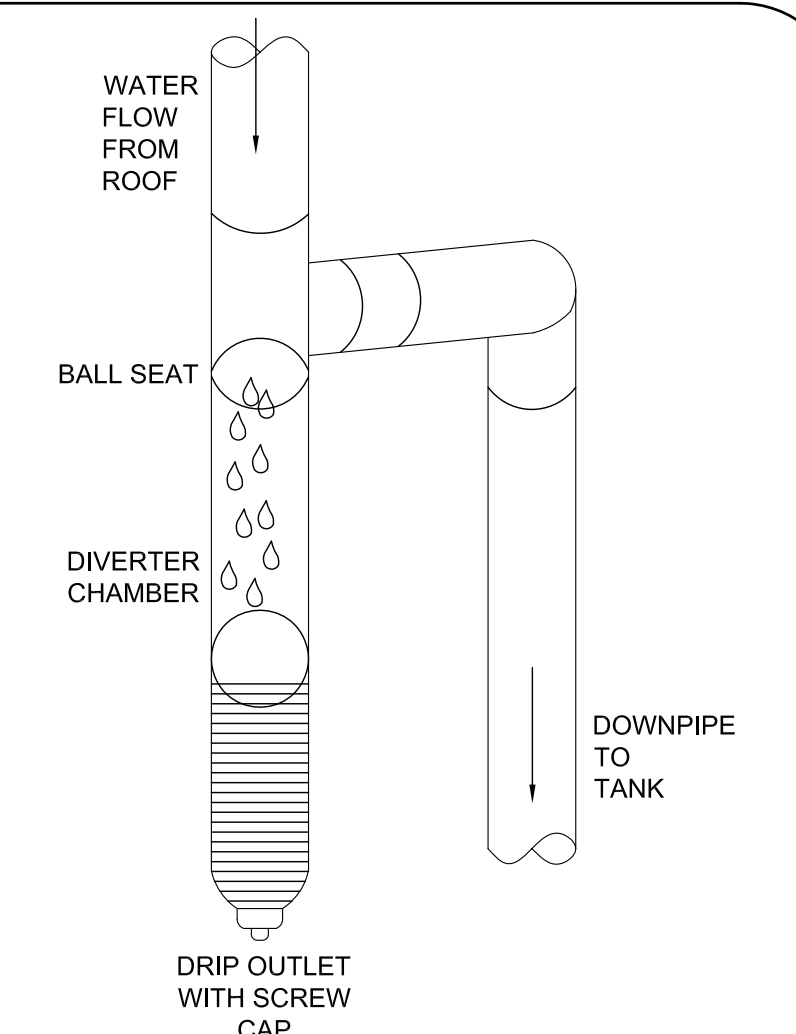
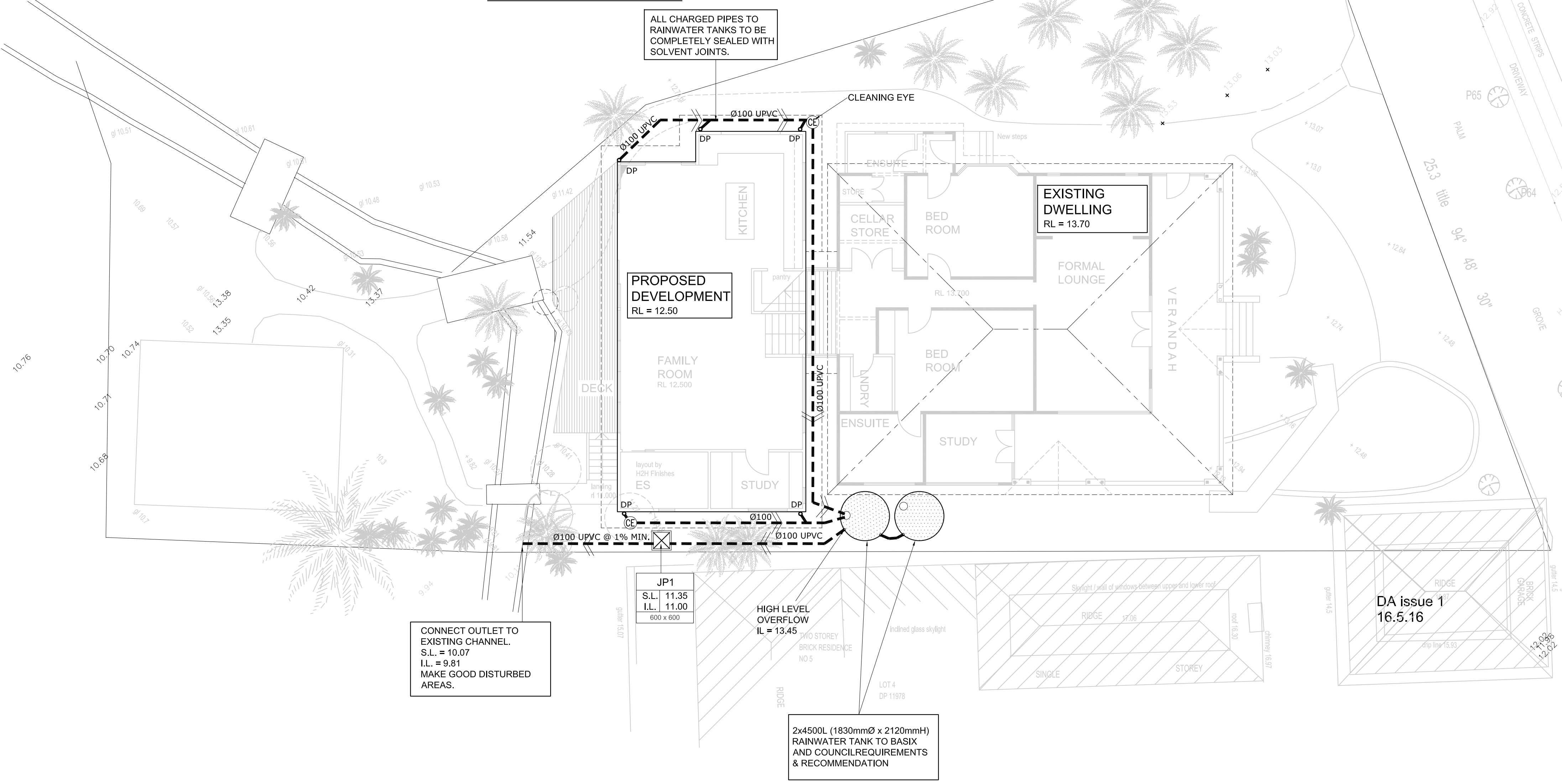

FIRST FLUSH OF CONTAMINATED WATER IS DIVERTED INTO CHAMBER. DIVERTER DESIGNED TO CAUSE MINIMUM OF 1mm OF INITIAL RUNOFF FROM ROOF AREA TO BYPASS RAINWATER TANK(S)  
**PROPRIETARY FIRST FLUSH DIVERTER**  
 SCALE N.T.S.

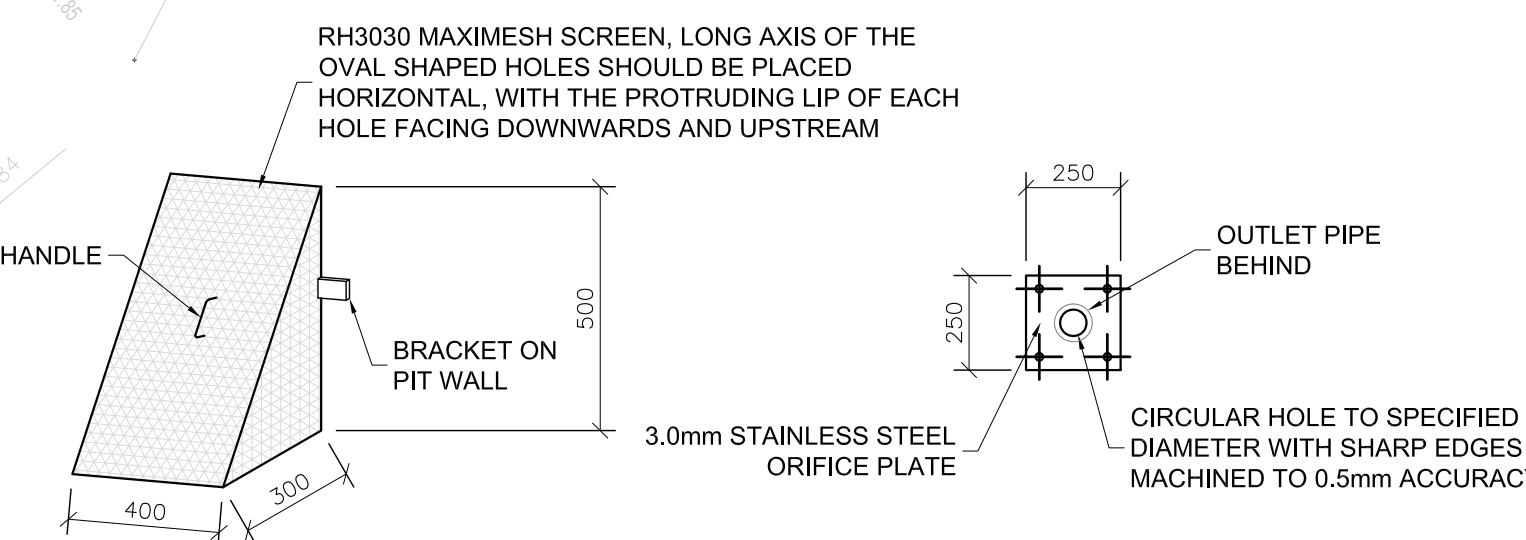
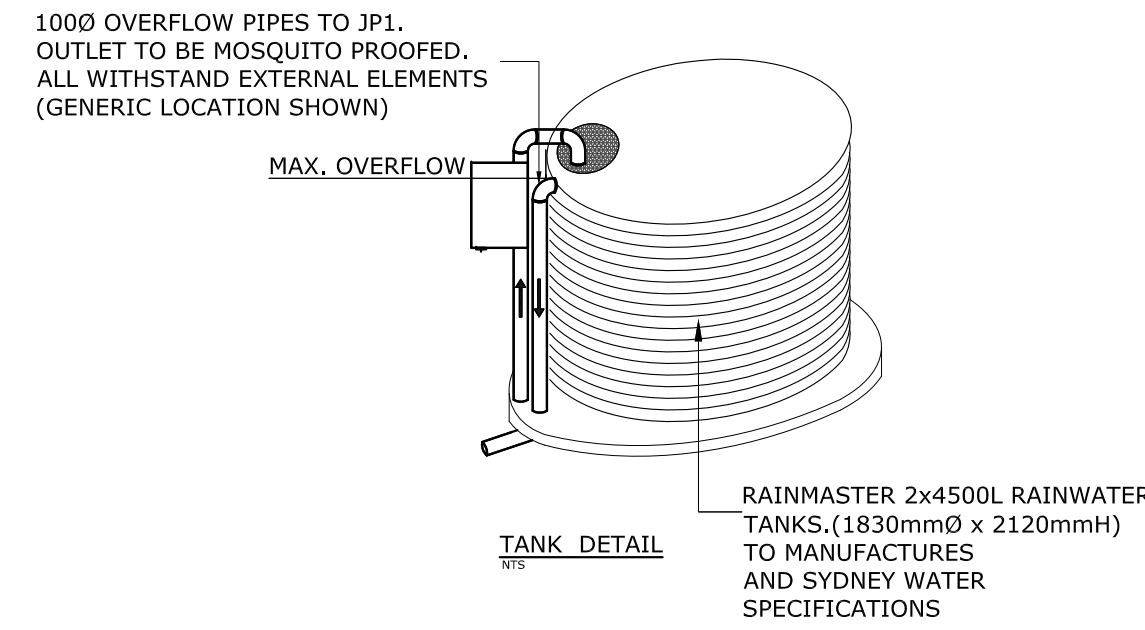

STANDARD TRASH SCREEN NTS

ORIFICE PLATE DETAIL 1:20

NOTE:  
 © Copyright. This plan and design is the property of HYTEN ENGINEERING, and must not be used, reproduced or copied wholly or in part without written permission from the company.  
 Do not scale drawings, use figured dimensions only.  
 WHEN IN DOUBT, ASK. It is your responsibility.  
 If HYTEN Engineering has not been engaged to carry out structural inspections, no certificate will be issued.

Rev.	Description	By.	App.	Date
B	ISSUED FOR D.A	L.T.	M.A.	20.06.2016
A	ISSUED FOR COORDINATION	M.A.	M.A.	31.05.2016

**HYTEN ENGINEERING**  
 STRUCTURAL | STORMWATER | GLASS ENGINEERING  
 0413 863 363 michael@hyten.com.au www.hyten.com.au

Client **SITE FOREMAN**  
 Project **PROPOSED DEVELOPMENT  
 3 BILGOLA RD, BILGOLA BEACH**

Title **STORMWATER PLAN & SECTION DETAILS**  
 ISSUED FOR **D.A APPROVAL**

Design **Z.K.** Drawn **M.K.**  
 Project Number **16 H 4021** Drawing Number **S01**

