



# NEWPORT MARINA AND RESIDENTIAL DEVELOPMENT

20220005  
MARINA LANDSCAPE DA

LANDSCAPE DRAWING REGISTER		
SHEET	SHEET NAME	REVISION
LD-DA600	COVER SHEET	4
LD-DA605	DEMOLITION PLAN – MARINA	3
LD-DA610	MARINA LANDSCAPE PLAN	4
LD-DA611	MARINA DETAIL PLAN 1	4
LD-DA612	MARINA DETAIL PLAN 2	4
LD-DA620	LANDSCAPE SECTION	3

## GENERAL NOTES

1. THIS DRAWING MUST BE READ IN CONJUNCTION WITH THE MARINA SUBDIVISION DOCUMENTS, INCLUDING DRAWINGS AND REPORTS OF ALL OTHER CONSULTANTS.
2. ALL EXISTING TREES TO BE RETAINED ARE SUBJECT TO TREE PROTECTION AND MANAGEMENT IN ACCORDANCE WITH ARBORIST RECOMMENDATION AND AUSTRALIAN STANDARDS.
3. ALL WORK TO COMPLY WITH THE NATIONAL CONSTRUCTION CODE INCLUDING RELEVANT AUSTRALIAN STANDARDS AND REQUIREMENTS OF THE BUILDING CODE OF AUSTRALIA AND AUSTRALIAN WORK HEALTH AND SAFETY LEGISLATION.
4. DESIGN DRAWINGS ARE BASED ON SURVEY INFORMATION. SCOTT CARVER DO NOT WARRANT THE ACCURACY OF SURVEY INFORMATION.
5. EXISTING SERVICES MUST BE CONFIRMED BY THE CONTRACTOR PRIOR TO EXCAVATION. DO NOT EXCAVATE BY MACHINE WITHIN 1M OF EXISTING UNDERGROUND SERVICES WITHOUT PRIOR APPROVAL OR IDENTIFICATION OF SERVICE LOCATION.
6. THIS DRAWING IS COPYRIGHT AND IS THE PROPERTY OF SCOTT CARVER AND MUST NOT BE USED WITHOUT PERMISSION.

20220005 Newport Marina Landscape						
PLANTING SCHEDULE						
CODE	SPECIES	COMMON NAME	POT SIZE	EST. MATURE SIZE (H x W)	SPACING	QUANTITY
<b>Trees</b>						
ANG cos	<i>Angophora costata</i>	Sydney red gum	100L	20m x 10m	as shown	1
<b>Shrubs</b>						
COR alb	<i>Correa alba</i>	White Correa	140mm	1m x 1m	as shown	6
LEP lae	<i>Leptospermum laevigatum</i> 'Shore Tuff'	Coastal Tea Tree	140mm	0.5m x 1m	as shown	12
WES fru	<i>Westringia fruticosa</i>	Coast Rosemary	140mm	1m x 1.5m	as shown	18
<b>Grasses and Groundcovers</b>						
CAR gla	<i>Carpobrotus glaucescens</i>	Pig Face	140mm	0.2m spreads	4 per m2	28
DIA cae	<i>Dianella caerulea</i>	Blue Flax Lily	140mm	1m x 1m	4 per m2	68
FIC nod	<i>Ficinia nodosa</i>	Knobby Club Rush	140mm	1m x 1m	5 per m2	56
HIB sca	<i>Hibbertia scandens</i>	Golden Guinea Flower	140mm	0.2m spreads	4 per m2	56
LOM lon	<i>Lomandra longifolia</i>	Spiny-headed Mat-rush	140mm	1m x 1m	4 per m2	44
LOM tan	<i>Lomandra tanika</i>	Lomandra tanika	140mm	0.6m x 0.6m	4 per m2	32
TOTAL						321

[Status] FOR DA

[Nom. Architect] EDWARD SALIB / 9469

[File] 20220005-LD-DA610 - [4].DWG

[Print Date] 04 Oct 2024

History

[Rev#]	[Description]	[Date]
1	FOR DA	21.10.2022
2	FOR DA	09.04.2024
3	FOR DA	11.04.2024
4	FOR DA	04.10.2024

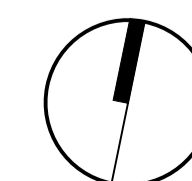

[Status] FOR DA

[Nom. Architect] EDWARD SALIB / 9469







[File] 20220005-LD-DA610-[4].DWG

[Print Date] 04 Oct 2024

History

[Rev#]	[Description]	[Date]
1	FOR DA	21.10.2022
2	FOR DA	09.04.2024
3	FOR DA	04.10.2024

LEGEND

-  SITE BOUNDARY
-  EXISTING TREES TO BE RETAINED
-  EXISTING TREES TO BE REMOVED
-  T00 TREE NUMBER
-  EXISTING ELEMENTS
-  DEMOLITION

BASED ON SURVEY BY BOXALL DATED 05.05.2022 - DRAWING NO. 11369-001-A

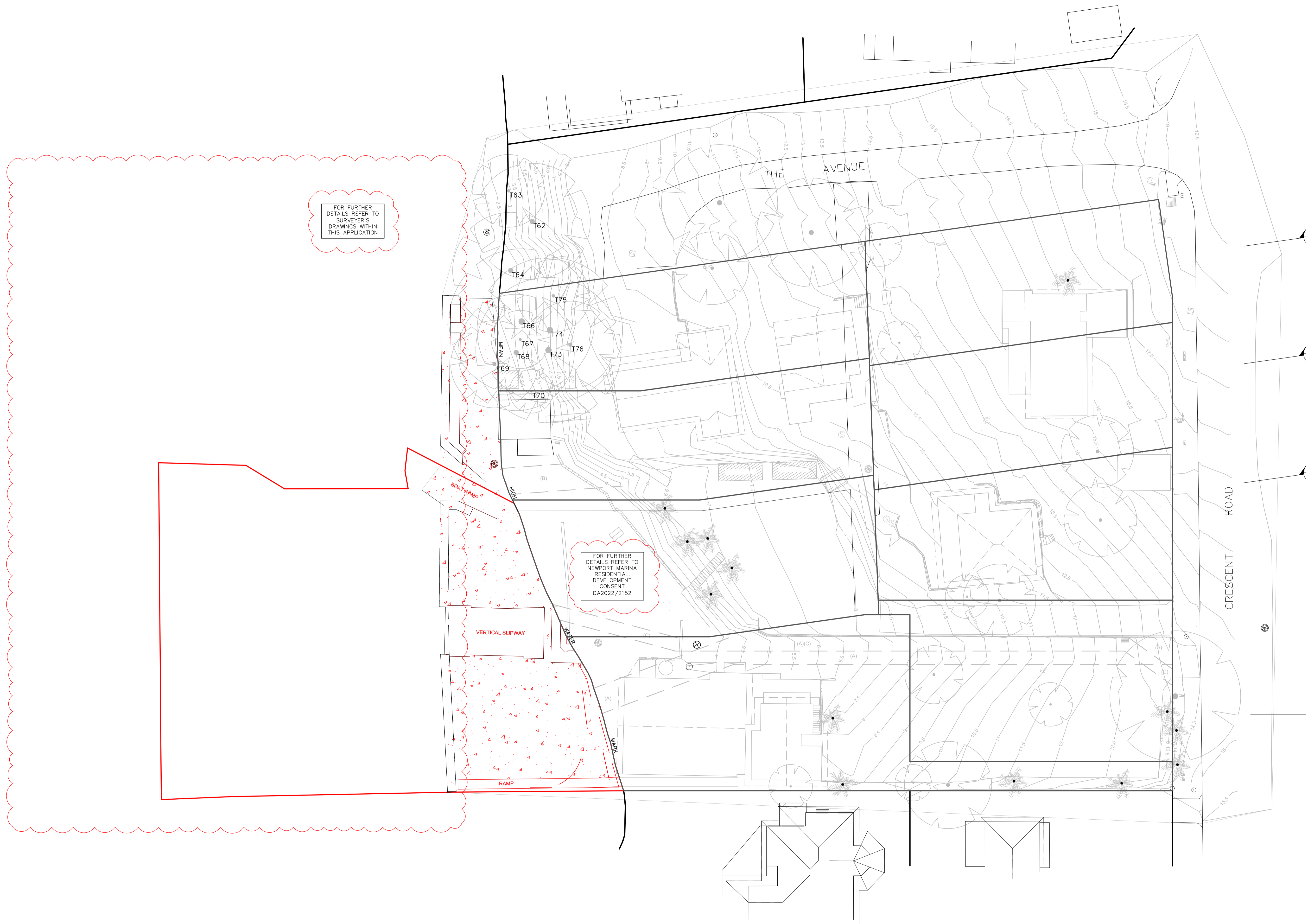

FOR FURTHER DETAILS REFER TO SURVEYER'S DRAWINGS WITHIN THIS APPLICATION

FOR FURTHER DETAILS REFER TO NEWPORT MARINA RESIDENTIAL DEVELOPMENT CONSENT DA2022/2152



Level One, One Chifley Square Sydney NSW 2000 Australia  
www.scottcarver.com.au +61 2 9957 3988

[Project] NEWPORT MARINA AND RESIDENTIAL DEVELOPMENT

[Client] ESSEX DEVELOPMENT

0 2.5 5 7.5 10 12.5

[Scale] 1 : 250 @ A1

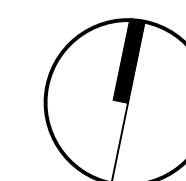

MARINA DEMOLITION PLAN

[Ref] 20220005

[Dwg No] LD-DA605

[Rev] [3]

[Status] FOR DA

[Nom. Architect] EDWARD SALIB / 9469

[File] 20220005-LD-DA610 - [4]DWG

[Print Date] 04 Oct 2024

History

[Rev#]	[Description]	[Date]
1	FOR DA	21.10.2022
2	FOR DA	09.04.2024
3	FOR DA	11.04.2024
4	FOR DA	04.10.2024

LEGEND

- SITE BOUNDARY
- EXISTING TREES TO BE RETAINED
- EXISTING TREES TO BE REMOVED
- TOO TREE NUMBER
- EXISTING ELEMENTS
- PROPOSED TREES
- +EX EXISTING LEVELS: REF SURVEY
- +RL PROPOSED NOMINAL DESIGN LEVEL
- PA PLANTING AREA
- TU TURF
- P1 PAVEMENT TYPE 1: CONCRETE ACCESS PATH
- W1 500H RETAINING WALL
- S1 500H BENCH WALL

BASED ON SURVEY BY BOXALL DATED 05.05.2022 - DRAWING NO. 11369-001-A

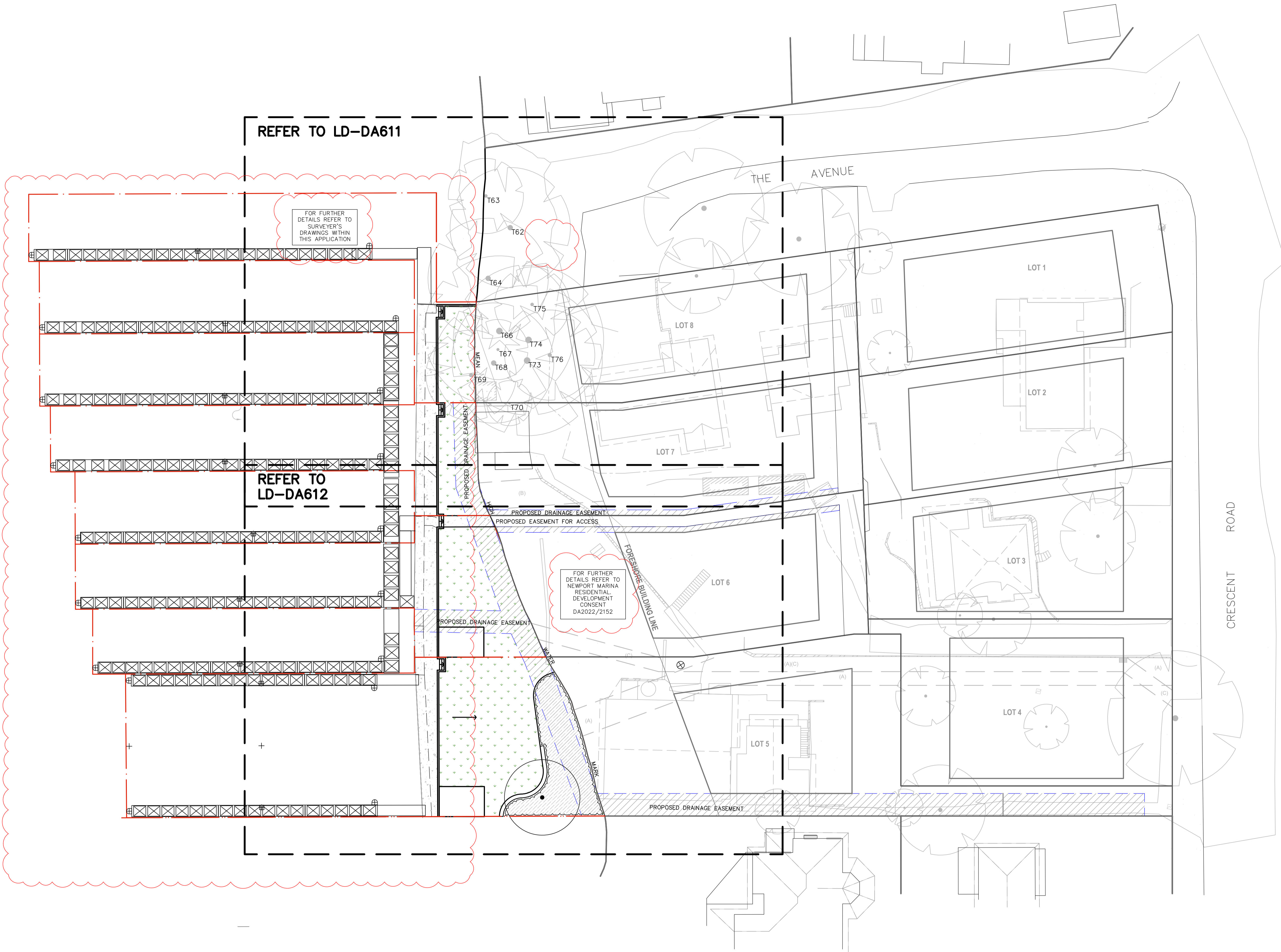

Level One, One Chifley Square Sydney NSW 2000 Australia  
www.scottcarver.com.au +61 2 9957 3988

[Project] NEWPORT MARINA AND RESIDENTIAL DEVELOPMENT

[Client] ESSEX DEVELOPMENT

0 2.5 5 7.5 10 12.5

[Scale] 1 : 250 @ A1

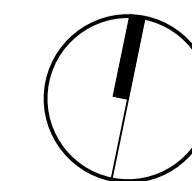

MARINA LANDSCAPE PLAN

[Ref] 20220005

[Dwg No] LD-DA610

[Rev] [4]

[Status]	FOR DA	
[Nom. Architect]	EDWARD SALIB / 9469	
[File]	20220005-LD-DA610-[4].DWG	
[Print Date]	04 Oct 2024	
History		
[Rev#]	[Description]	[Date]
1	FOR DA	21.10.2022
2	FOR DA	09.04.2024
3	FOR DA	11.04.2024
4	FOR DA	04.10.2024

- LEGEND
- SITE BOUNDARY
  - EXISTING TREES TO BE RETAINED
  - EXISTING TREES TO BE REMOVED
  - T00 TREE NUMBER
  - EXISTING ELEMENTS
  - PROPOSED TREES
  - +EX EXISTING LEVELS: REF SURVEY
  - +RL PROPOSED NOMINAL DESIGN LEVEL
  - PA PLANTING AREA
  - TU TURF
  - P1 PAVEMENT TYPE 1: CONCRETE ACCESS PATH
  - W1 500H RETAINING WALL
  - S1 500H BENCH WALL

BASED ON SURVEY BY BOXALL DATED 05.05.2022 - DRAWING NO. 11369-001-A

FOR FURTHER DETAILS REFER TO SURVEYER'S DRAWINGS WITHIN THIS APPLICATION

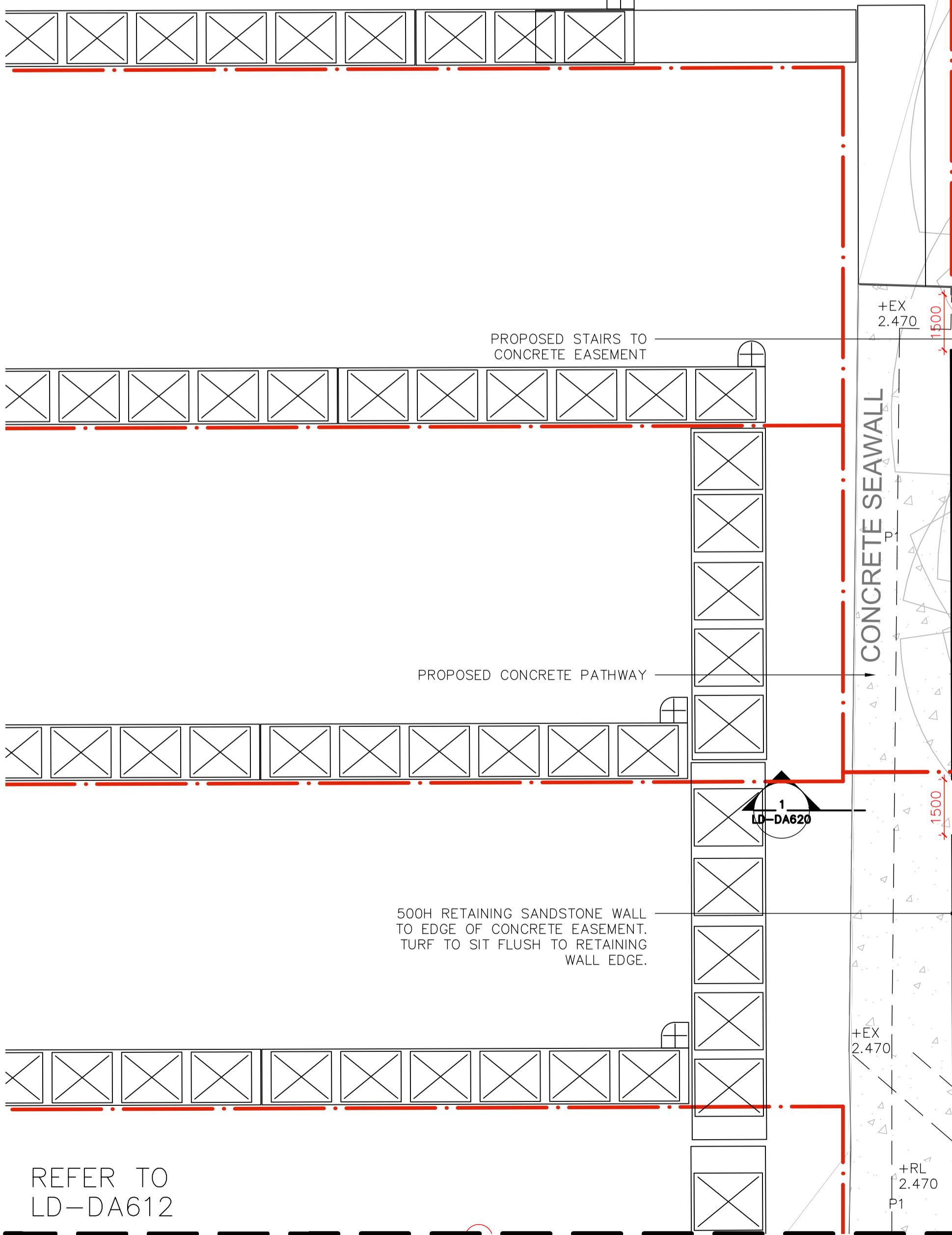

REFER TO LD-DA612

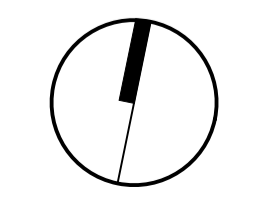

REFER TO  
LD-DA611

[Status]	FOR DA	
[Nom. Architect]	EDWARD SALIB / 9469	
[File]	20220005-LD-DA610-[4].DWG	
[Print Date]	04 Oct 2024	
<b>History</b>		
[Rev#]	[Description]	[Date]
1	FOR DA	21.10.2022
2	FOR DA	10.11.2022
3	FOR DA	09.04.2024
4	FOR DA	04.10.2024

**LEGEND**

- SITE BOUNDARY
- EXISTING TREES TO BE RETAINED
- EXISTING TREES TO BE REMOVED
- T00 TREE NUMBER
- EXISTING ELEMENTS
- PROPOSED TREES
- +EX EXISTING LEVELS: REF SURVEY
- +RL PROPOSED NOMINAL DESIGN LEVEL
- PA PLANTING AREA
- TU TURF
- P1 PAVEMENT TYPE 1: CONCRETE ACCESS PATH
- W1 500H RETAINING WALL
- S1 500H BENCH WALL

BASED ON SURVEY BY BOXALL DATED 05.05.2022 - DRAWING NO. 11369-001-A

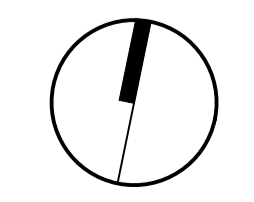
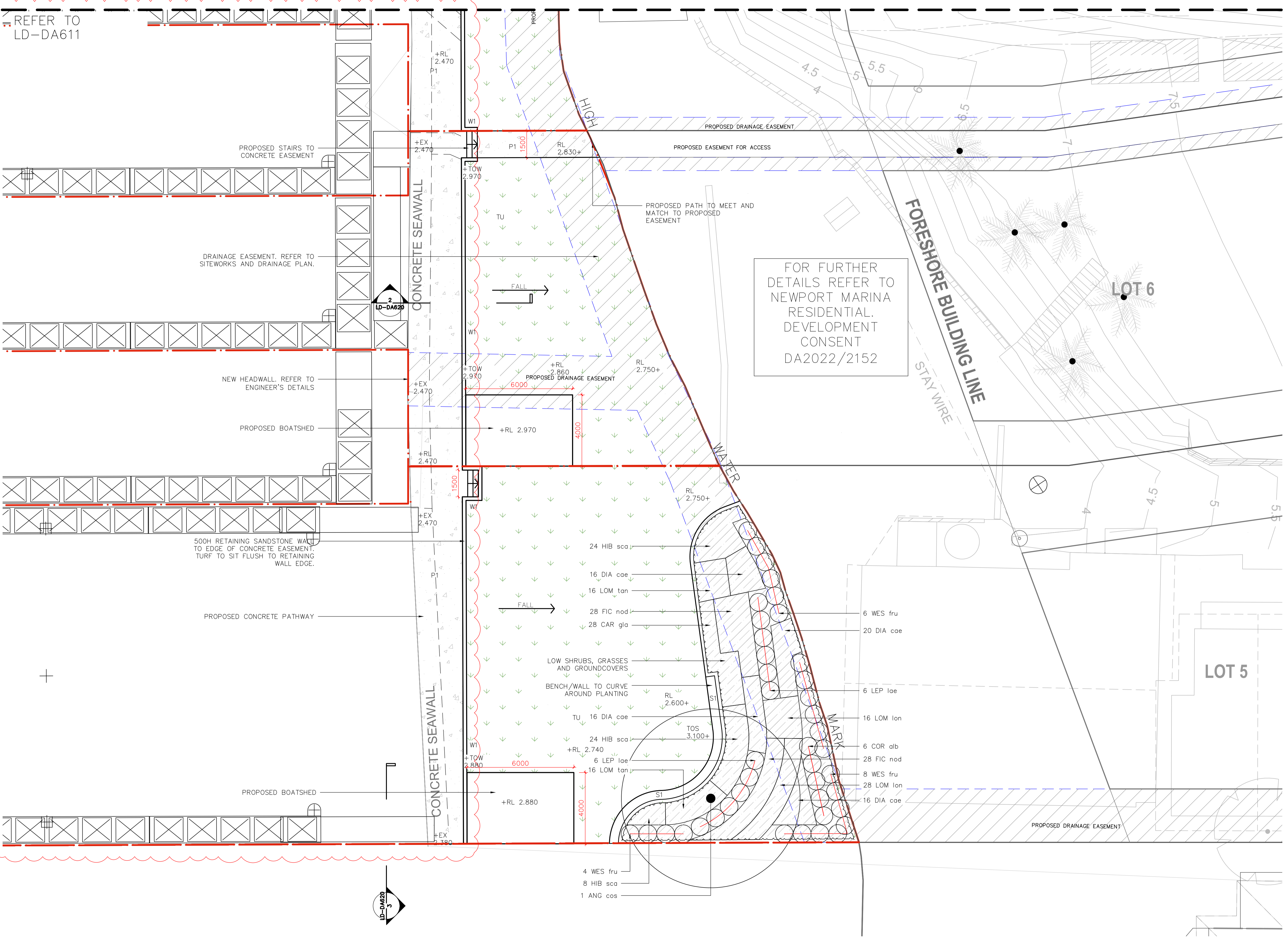

History

[Rev#]	[Description]	[Date]
1	FOR DA	21.10.2022
2	FOR DA	09.04.2024
3	FOR DA	11.04.2024

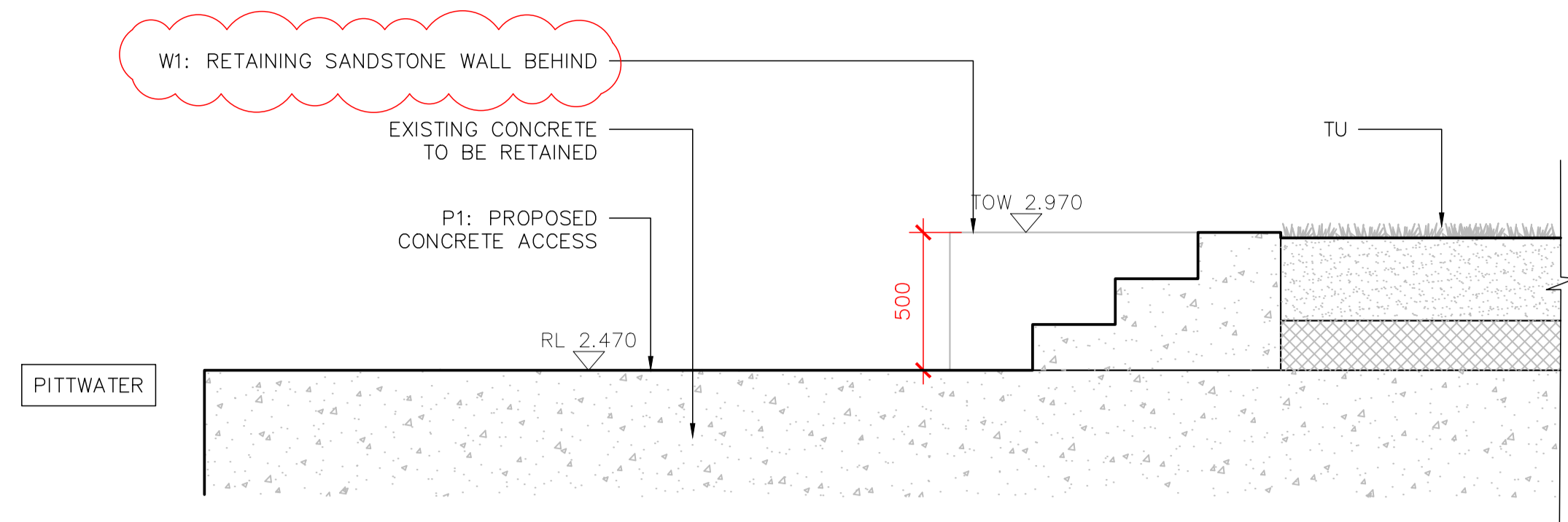

1 DETAIL SECTION: STAIRS DOWN TO CONCRETE ACCESS  
1:20

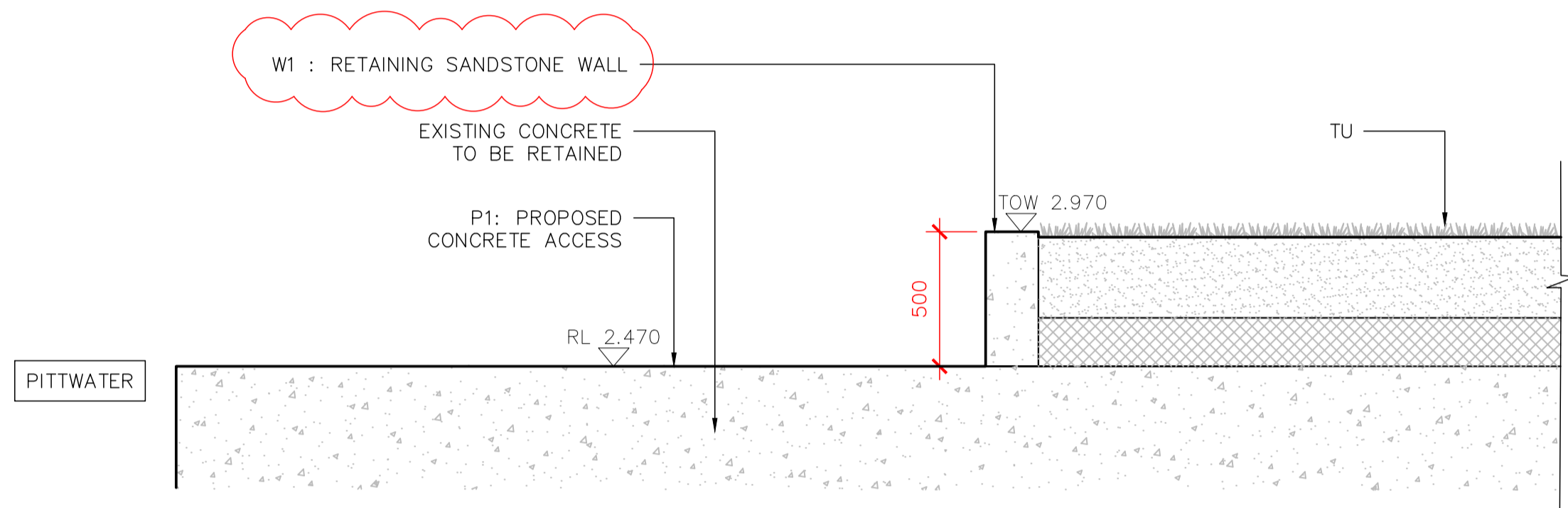

2 DETAIL SECTION: RETAINING WALL TO CONCRETE ACCESS  
1:20

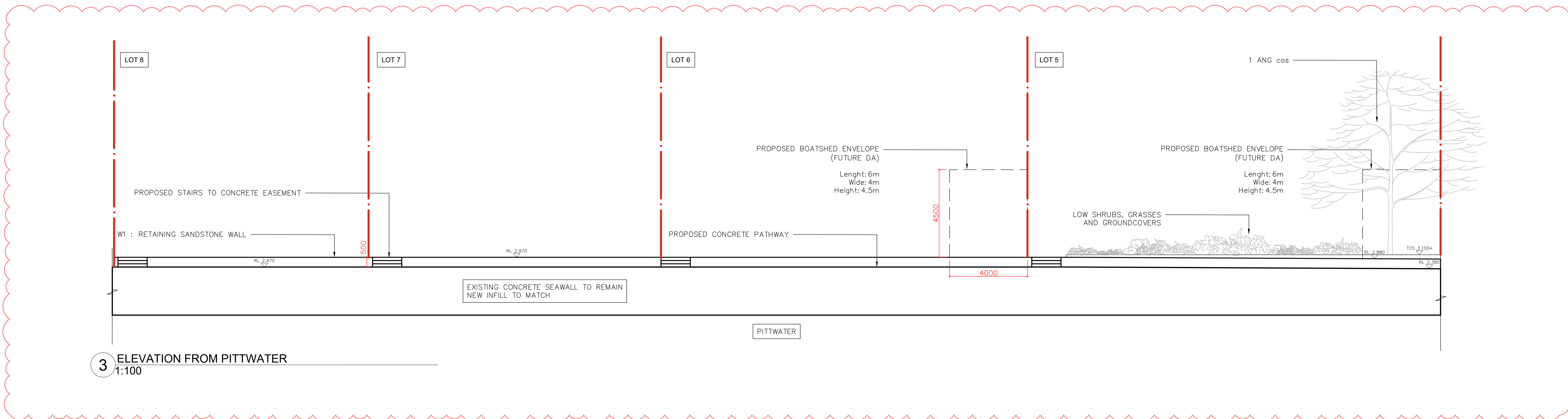

3 ELEVATION FROM PITWATER  
1:100