

Contact Us		Office Use Only			
The General Manager, 725 Pittwater Road, Dee Why NSW 2099 or Customer Service Centre, Northern Beaches Council DX9118 Dee Why					
Email	council@warringah.nsw.gov.au				
Fax	9942 2606				
If you need help logging your application call Customer Service on 021 9942 2111 or come in and talk to us at the Civic Centre, Dee Why.					

Part 1: Declaration

1. DECLARATION	
I hereby certify that the shadow diagrams submitted with the proposal at	
Address	Lot 9, 41 Warriewood Road, Warriewood.
For the erection of <i>Description of development</i>	construction of a double storey dwelling
<ul style="list-style-type: none"> In accordance with the survey (prepared by a registered surveyor) which is required to be submitted with the application Drawn to true north Indicate shadow cast by the proposal at 9am, noon, 3pm, 21 June To indicate the shadow cast by existing buildings and structures on the site and in the surrounding area 	

Part 2: Certification

2. CERTIFIER	
Title	<input checked="" type="radio"/> Mr <input type="radio"/> Mrs <input type="radio"/> Ms <input type="radio"/> Other
Full family name <i>(no initials for Company)</i>	Brkic
Full given names <i>(no initials for A.C.N.)</i>	Sulejman
Phone	9895 1633
Mobile	0422 461 767
Qualification <i>(i.e. Architect, Planner, Carpenter, Technician, Surveyor)</i>	Drafting & design manager
	Alternate
	Fax

Part 3: Signature

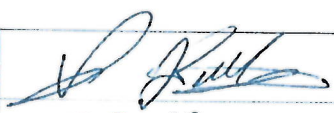
3. APPLICANT(S) SIGNATURE	
Signature	
Date	29.19

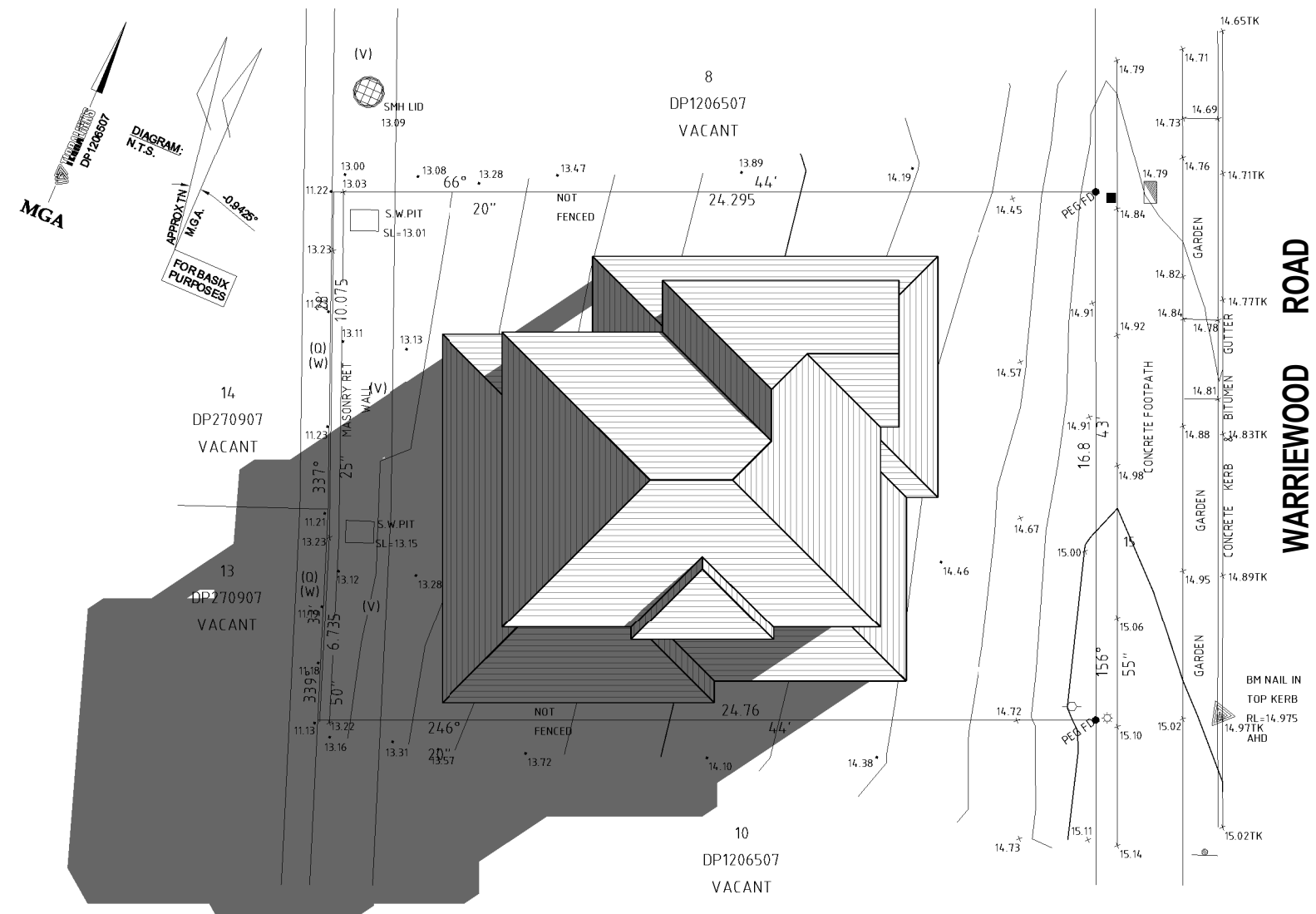

SHADOW DIAGRAM JUNE 21st 9AM

ISSUE	AMENDMENT	DATE	<p>Copyright reserved. No part of these plans may be reproduced or transmitted in any form without the written permission of Wincrest Group Pty Ltd.</p>	 <p>BESPOKE Wincrest Group Pty Ltd. ACN 135 562 873 Builders License No. 213 442C 18 Pitt St, Paramatta NSW 2150 Ph:(02) 9635 1644 Fax:(02) 9633 4806</p>	PROPOSED RESIDENCE FOR:	CASA BELA INCLUSIONS	
A	PFD & SV1 (EB)	14.08.19			CLIENT: MR CATLIN & MRS KALOUS	JOB NO: 17398	DATE: 26.09.19
B	VARY B (EC)	29.08.19			ADDRESS: LOT 9, No 41 WARRIEWOOD ROAD WARRIEWOOD NORTHERN BEACHES COUNCIL	DRAWN: EB	CHECKED: Checker
C	VARY C (EC)	02.09.19				SCALE: 1 : 200	SHEET NO: 12
D	VARY D (EC)	25.09.19				PLEASE DISCARD ALL OTHER PLANS	
E	POOL AMENDED (EC)	26.09.19				DO NOT SCALE DRAWING	
F	FFD (EB)	30.09.19					

LOCATION: T:\First draft\17398_CATLIN & KALOUSD\Drawings\17398_CATLIN.rvt

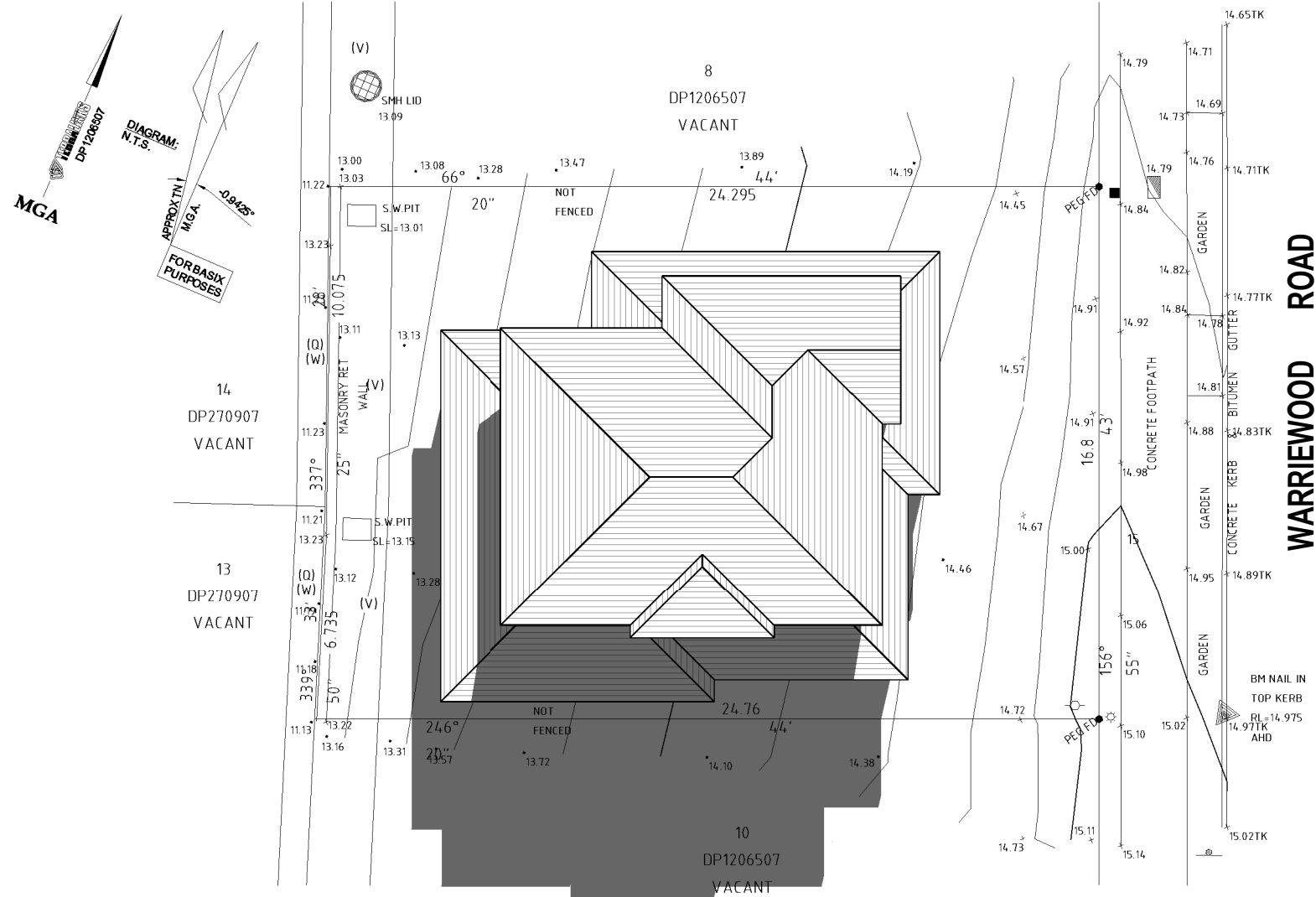

SHADOW DIAGRAM JUNE 21st 12PM

ISSUE	AMENDMENT	DATE	<p>Copyright reserved. No part of these plans may be reproduced or transmitted in any form without the written permission of Wincrest Group Pty Ltd.</p>	 <p>BESPOKE Wincrest Group Pty Ltd. ACN 135 562 873 Builders License No. 213 442C 18 Pitt St, Paramatta NSW 2150 Ph:(02) 9635 1644 Fax:(02) 9633 4806</p>	PROPOSED RESIDENCE FOR:	CASA BELA INCLUSIONS	
A	PFD & SV1 (EB)	14.08.19			CLIENT: MR CATLIN & MRS KALOUS	JOB NO: 17398	DATE: 26.09.19
B	VARY B (EC)	29.08.19			ADDRESS: LOT 9, No 41 WARRIEWOOD ROAD WARRIEWOOD NORTHERN BEACHES COUNCIL	DRAWN: EB	CHECKED: Checker
C	VARY C (EC)	02.09.19				SCALE: 1 : 200	SHEET NO: 13
D	VARY D (EC)	25.09.19				PLEASE DISCARD ALL OTHER PLANS	
E	POOL AMENDED (EC)	26.09.19				DO NOT SCALE DRAWING	
F	FFD (EB)	30.09.19					

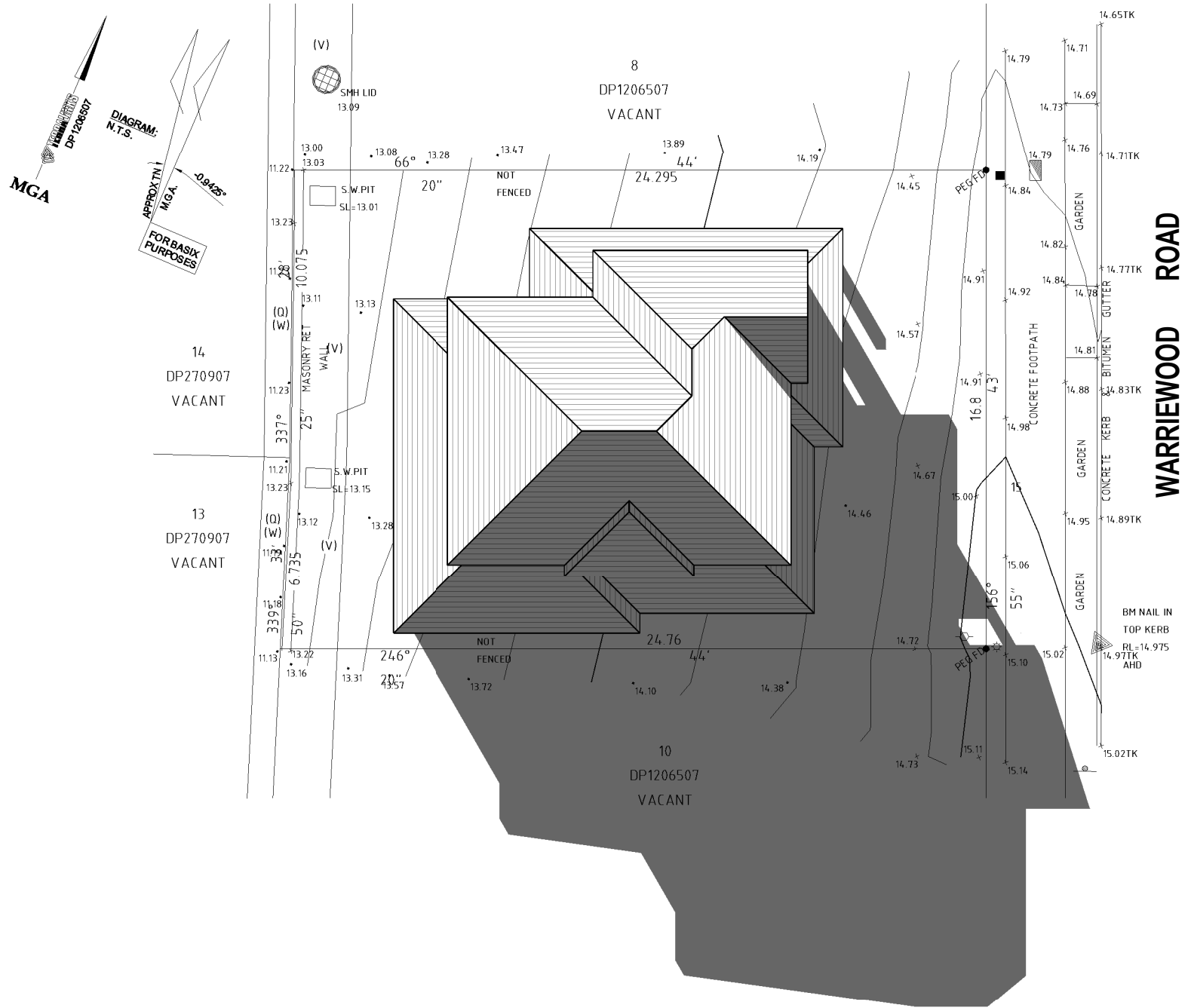

SHADOW DIAGRAM JUNE 21st 3PM

ISSUE	AMENDMENT	DATE	<p>Copyright reserved. No part of these plans may be reproduced or transmitted in any form without the written permission of Wincrest Group Pty Ltd.</p>	 BESPOKE Wincrest Group Pty Ltd. ACN 135 562 873 Builders License No. 213 442C 18 Pitt St, Paramatta NSW 2150 Ph:(02) 9635 1644 Fax:(02) 9633 4806	PROPOSED RESIDENCE FOR:	CASA BELA INCLUSIONS	
	A	PFD & SV1 (EB)			14.08.19	CLIENT: MR CATLIN & MRS KALOUS	JOB NO: 17398
B	VARY B (EC)	29.08.19		ADDRESS: LOT 9, No 41 WARRIEWOOD ROAD WARRIEWOOD NORTHERN BEACHES COUNCIL	DRAWN: EB	CHECKED: Checker	
C	VARY C (EC)	02.09.19			SCALE: 1 : 200	SHEET NO: 14	
D	VARY D (EC)	25.09.19		PLEASE DISCARD ALL OTHER PLANS			
E	POOL AMENDED (EC)	26.09.19		DO NOT SCALE DRAWING			
F	FFD (EB)	30.09.19					

LOCATION: T:\First draft\17398_CATLIN & KALOUSD\Drawings\17398_CATLIN.rvt