

Shadow Diagram - June 21st

LEGEND:

- Existing Shadow Cast by Existing Residence
- 9am Additional Shadow cast by proposed Vergola
- 12pm Additional Shadow cast by proposed Vergola
- 3pm Additional Shadow cast by proposed Vergola

9AM

NOT TO SCALE

NO ADDITIONAL SHADOW CREATED



**ALL MEASUREMENTS TO
BE VERIFIED AT C/M**

GENERAL NOTES

All work to be carried out in accordance with the Building Code of Australia, all Local and State Government Ordinances, relevant Australian Standards, Local Electricity and Water Authorities Regulations and all other relevant Authorities concerned.
All timbers to be in accordance with SAA Timber Structure Code AS1720 and SAA Timber Framing Code AS 1684.
All work to be carried out in a professional and workmanshiplike manner according to the plans and specification.
Do not scale off the drawings unless otherwise stated and use figured dimensions in preference.
All dimensions are to be checked and verified on site before the commencement of any work.
Locate and protect all services prior to construction.



(NSW) PTY. LTD.

7 TEPKO ROAD TERREY HILLS NSW 2084
TEL: (02) 9450 3300
FAX: (02) 9450 3333

Project:

**PROPOSED VERGOLA
LOUVERED ROOF SYSTEM
AT EXISTING RESIDENCE**

Client:

ELIZA SUSANNE SMITH

Address:

**6 LEWIS STEET
BALGOWLAH HEIGHTS - NSW - 2093**

DATE DRAFTED 03-05-24	AMENDED DATE A - 28-03-24
SALES REP. J.P.	B - 02-04-24 C - 03-05-24
DRAWN JGW/GR	SHEET No. 1 OF 3
DRAWING No. 19726	DATE SIGNED
SCALE AS NOTED @ A3	CLIENTS SIGNATURE

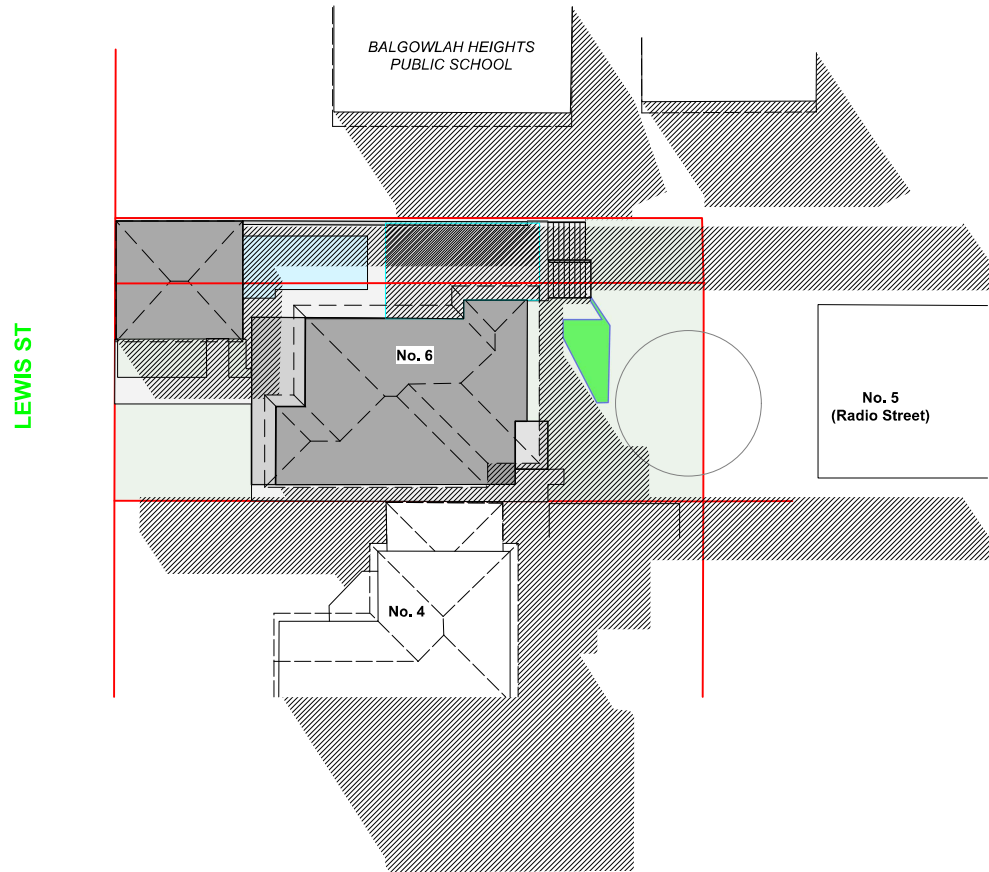

Shadow Diagram - June 21st

LEGEND:



Existing Shadow Cast by Existing Residence



9am Additional Shadow cast by proposed Vergola



12pm Additional Shadow cast by proposed Vergola



3pm Additional Shadow cast by proposed Vergola

12PM

NOT TO SCALE



ALL MEASUREMENTS TO BE VERIFIED AT C/M

GENERAL NOTES

All work to be carried out in accordance with the Building Code of Australia, all Local and State Government Ordinances, relevant Australian Standards, Local Electricity and Water Authorities Regulations and all other relevant Authorities concerned.

All timbers to be in accordance with SAA Timber Structure Code AS1720 and SAA Timber Framing Code AS 1684.

All work to be carried out in a professional and workmanshiplike manner according to the plans and specification.

Do not scale off the drawings unless otherwise stated and use figured dimensions in preference.

All dimensions are to be checked and verified on site before the commencement of any work. Locate and protect all services prior to construction.



7 TEPKO ROAD TERREY HILLS NSW 2084
TEL: (02) 9450 3300
FAX: (02) 9450 3333

Project:

PROPOSED VERGOLA LOUVERED ROOF SYSTEM AT EXISTING RESIDENCE

Client:

ELIZA SUSANNE SMITH

Address:

**6 LEWIS STEET
BALGOWLAH HEIGHTS - NSW - 2093**

DATE DRAFTED 03-05-24	AMENDED DATE A - 28-03-24
SALES REP. J.P.	B - 02-04-24 C - 03-05-24
DRAWN JGW/GR	SHEET No. 2 OF 3
DRAWING No. 19726	DATE SIGNED
SCALE AS NOTED @ A3	CLIENTS SIGNATURE

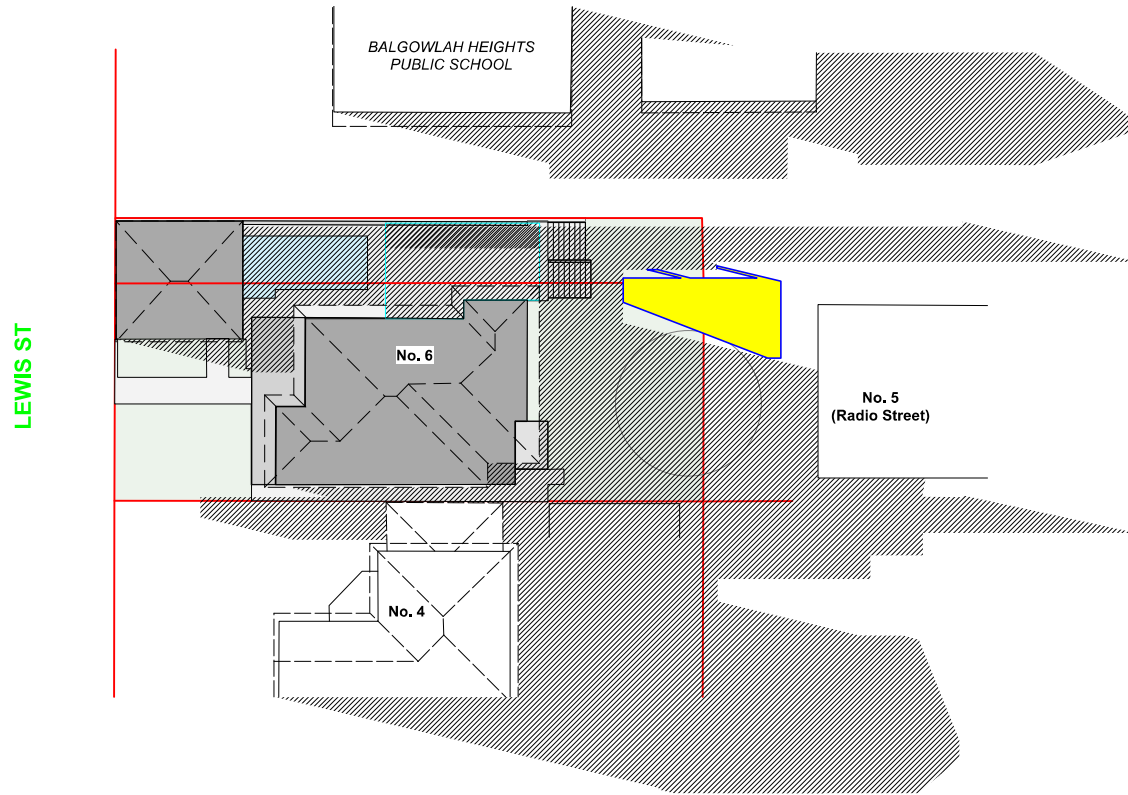

Shadow Diagram - June 21st

LEGEND:



Existing Shadow Cast by Existing Residence



9am Additional Shadow cast by proposed Vergola



12pm Additional Shadow cast by proposed Vergola



3pm Additional Shadow cast by proposed Vergola



ALL MEASUREMENTS TO BE VERIFIED AT C/M

3PM

NOT TO SCALE

GENERAL NOTES

All work to be carried out in accordance with the Building Code of Australia, all Local and State Government Ordinances, relevant Australian Standards, Local Electricity and Water Authorities Regulations and all other relevant Authorities concerned.

All timbers to be in accordance with SAA Timber Structure Code AS1720 and SAA Timber Framing Code AS 1684.

All work to be carried out in a professional and workmanshiplike manner according to the plans and specification.

Do not scale off the drawings unless otherwise stated and use figured dimensions in preference.

All dimensions are to be checked and verified on site before the commencement of any work. Locate and protect all services prior to construction.



7 TEPKO ROAD TERREY HILLS NSW 2084
TEL: (02) 9450 3300
FAX: (02) 9450 3333

Project:

PROPOSED VERGOLA LOUVERED ROOF SYSTEM AT EXISTING RESIDENCE

Client:

ELIZA SUSANNE SMITH

Address:

**6 LEWIS STEET
BALGOWLAH HEIGHTS - NSW - 2093**

DATE DRAFTED 03-05-24	AMENDED DATE A - 28-03-24
SALES REP. J.P.	B - 02-04-24 C - 03-05-24
DRAWN JGW/GR	SHEET No. 3 OF 3
DRAWING No. 19726	DATE SIGNED
SCALE AS NOTED @ A3	CLIENTS SIGNATURE