

# GLADYS AVENUE

## SYMBOLS

- EXISTING LEVELS
- SILT FENCE
- DUST PROOF FENCE
- SITE FENCE
- STABILISED SITE ACCESS
- Ø50 PUMP LINE
- EXISTING STRUCTURE TO BE DEMOLISHED
- SANDBAG SEDIMENT TRAP
- DISCHARGE WATER THROUGH HAY BALES TO PREVENT EROSION
- PUMP LINE
- HOLDING TANK
- FILTRATION UNIT
- MANUALLY ACTIVATED SUBMERSIBLE PUMP TO BE PLACED ON PLINTH AT MIN 600mm FROM INVERT OF STILLING POND. CONTRACTOR IS TO ENSURE SEDIMENT HAS SETTLED PRIOR TO PUMP OPERATION. SEDIMENT MATERIAL IS TO BE CLEARED REGULARLY AND SHALL NOT AT ANY TIME REACH THE LEVEL OF THE PUMP INTAKE.

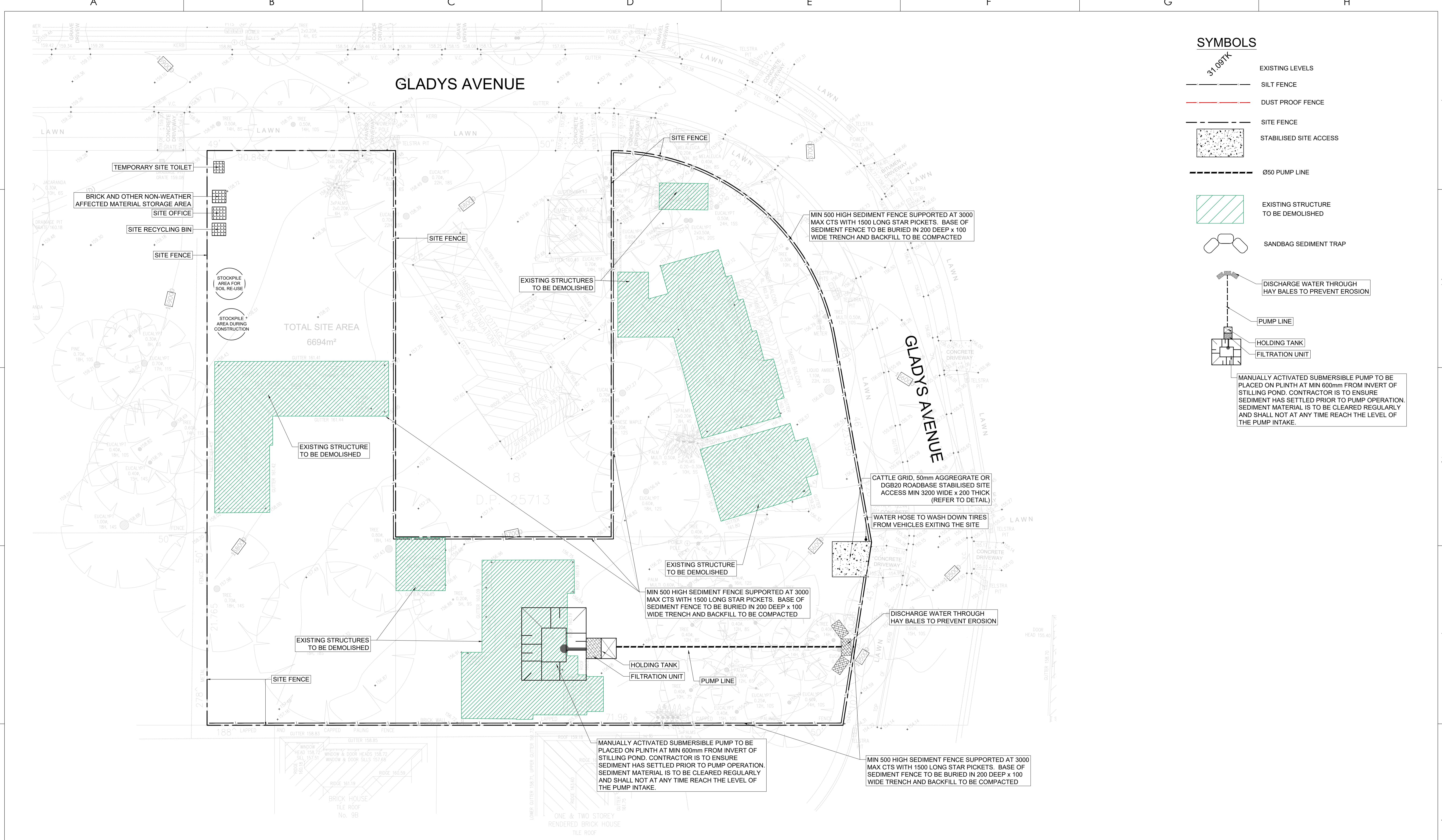

**EROSION AND SEDIMENT CONTROL PLAN**  
SCALE 1:200

No.	Description	Date	Issued by	Checked by
A	ISSUED FOR D.A.	10.02.23	N.E.	K.E.

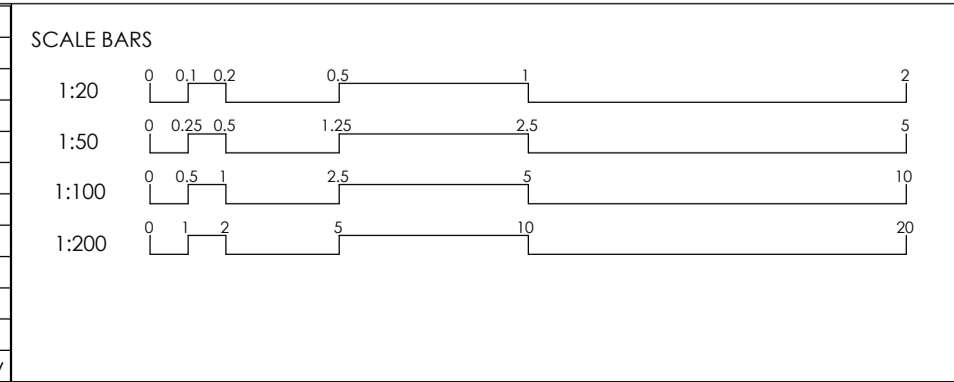

CLIENT: -  
ARCHITECT: WALSH ARCHITECTS

**SMART STRUCTURES AUSTRALIA**  
SUIT 2.04, L2, BLDG 3,  
35 WATERLOO RD., MACQUARIE PARK, NSW, 2113  
info@smartstrucs.com.au | www.smartstrucs.com.au

DRAWING TITLE <b>EROSION AND SEDIMENT CONTROL PLAN AND DETAILS SHEET 1</b>			PROJECT 1, 5 & 7 GLADYS AVENUE, FRENCHS FOREST NSW 2086	
SHEET NO. <b>D25</b>	REV. <b>A</b>	SCALE @ A1 <b>AS SHOWN</b>	PROJECT NO. <b>230023</b>	
DESIGNED: K.E.	DRAWN: N.E.	AUTHORISED: K.E.	PROJECT START DATE: <b>JANUARY 2023</b>	

