

- MARCH SUN SHADOW
- JUNE SUN SHADOW

revision			
issue	ID	date	description

Check all dimensions on site. Report any discrepancies to the designer for clarification before commencing work. Do not scale the drawings. Use figured dimensions only. Drawings shall not be used for construction purposes until status shows FOR CONSTRUCTION.

status: **DA**

All works are to comply with the National Construction Code Series - Building Code of Australia (NCCS - BCA) and Australian Standards; in accordance with councils (or certifying authority) development/construction consent. This drawing is copyright and remains the property of JAL ARCHITECTURAL and must not be used, copied or reproduced in whole or part except by agreement.

JAL architectural
draft+design

ABN 88 170 264 245
domestic-industrial-commercial
p 02 6554 5451
m 0428 54 8451
e angus.laurie@bigpond.com

client

Alison & Ben Clinch

project name

PROPOSED ALT'S & ADD'S

3 Orlando Road Cromer NSW LOT 5 DP 26699

SUNSTUDY 0900	
project no:	drawing (issue) no:
2101	1.2.1(01)
checked by: JAL	plot date: 2/06/2022

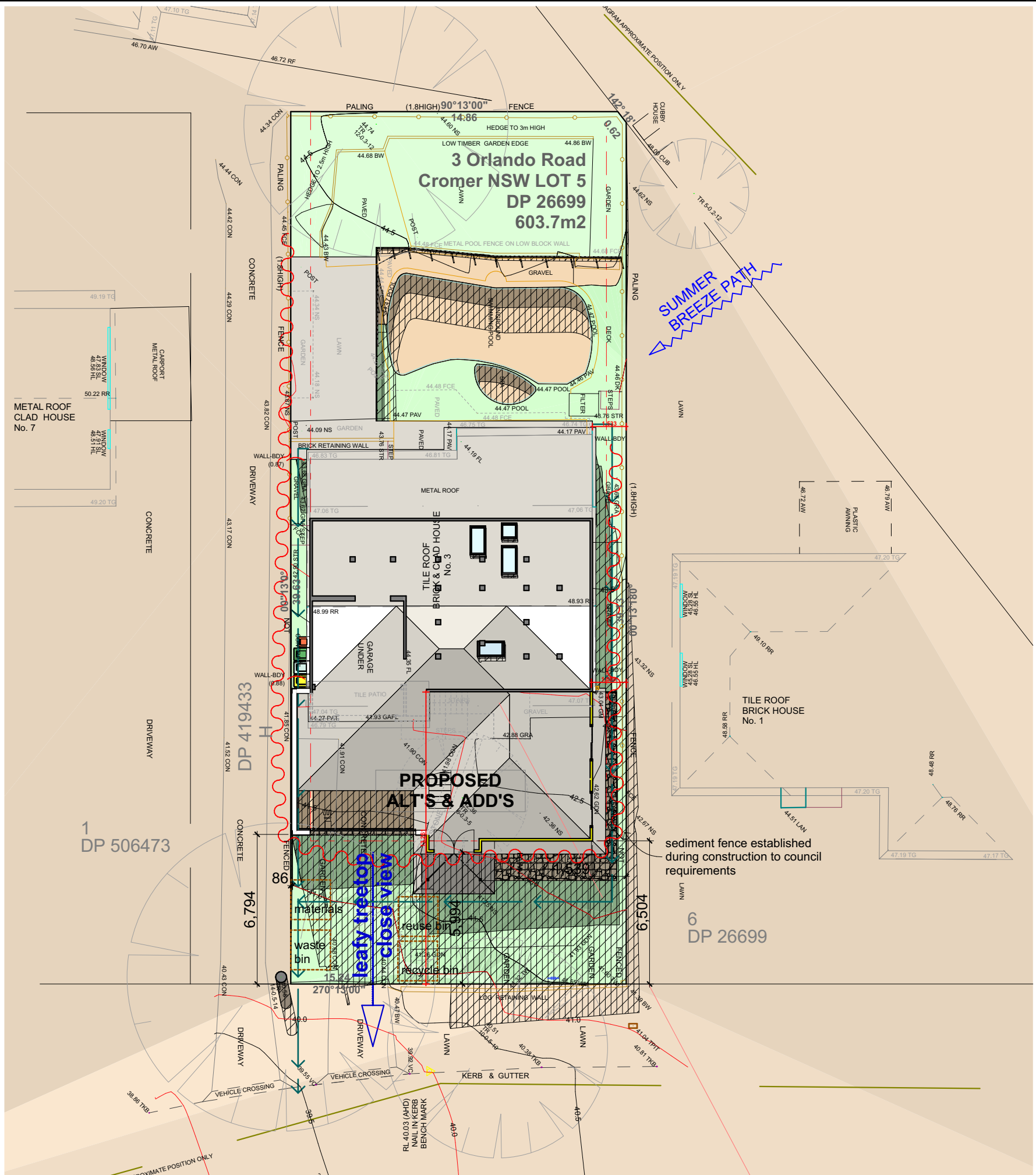

revision			
issue	ID	date	description

Check all dimensions on site. Report any discrepancies to the designer for clarification before commencing work. Do not scale the drawings. Use figured dimensions only. Drawings shall not be used for construction purposes until status shows FOR CONSTRUCTION.

status: **DA**

All works are to comply with the National Construction Code Series - Building Code of Australia (NCCS - BCA) and Australian Standards; in accordance with councils (or certifying authority) development/construction consent. This drawing is copyright and remains the property of JAL ARCHITECTURAL and must not be used, copied or reproduced in whole or part except by agreement.

JAL architectural
draft+design
ABN 88 170 264 245
domestic-industrial-commercial
p 02 6554 5451
m 0428 54 8451
e angus.laurie@bigpond.com

client

Alison & Ben Clinch

project name
PROPOSED ALT'S & ADD'S

3 Orlando Road Cromer NSW LOT 5 DP 26699

SUNSTUDY 1200	
project no:	drawing (issue) no:
2101	1.2.2(01)
checked by: JAL	plot date: 2/06/2022

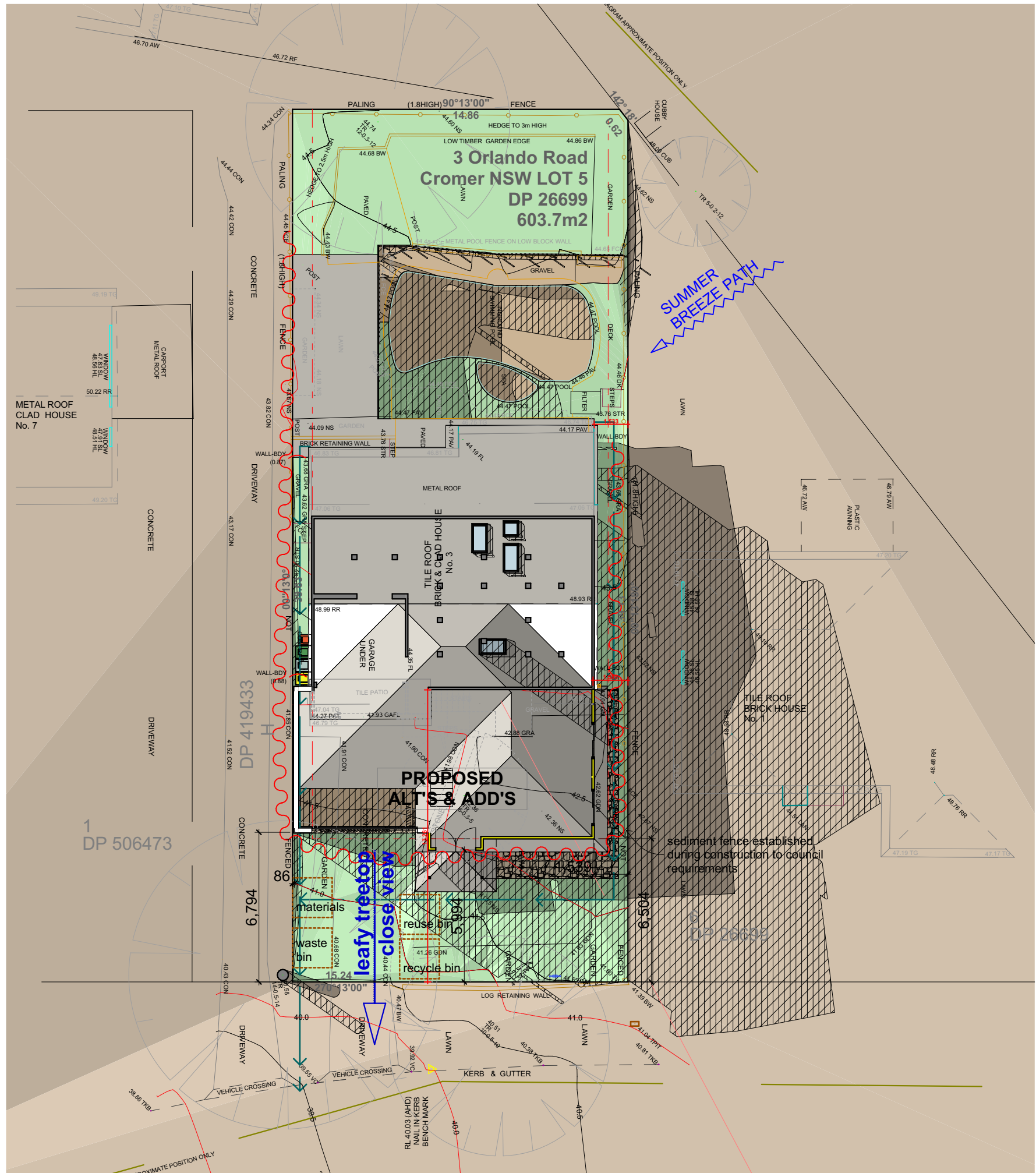

NOTE THAT THIS SURROUNDING TERRAIN IS MODELLED ON THE EXISTING SLOPING SITE AS OBSERVED

revision			
issue	ID	date	description

Check all dimensions on site. Report any discrepancies to the designer for clarification before commencing work. Do not scale the drawings. Use figured dimensions only. Drawings shall not be used for construction purposes until status shows FOR CONSTRUCTION.

status: **DA**

All works are to comply with the National Construction Code Series - Building Code of Australia (NCCS - BCA) and Australian Standards; in accordance with councils (or certifying authority) development/construction consent. This drawing is copyright and remains the property of JAL ARCHITECTURAL and must not be used, copied or reproduced in whole or part except by agreement.

JAL architectural
draft+design
ABN 88 170 264 245
domestic-industrial-commercial
p 02 6554 5451
m 0428 54 8451
e angus.laurie@bigpond.com

client

Alison & Ben Clinch

project name
PROPOSED ALT'S & ADD'S

3 Orlando Road Cromer NSW LOT 5 DP 26699

SUNSTUDY 1500	
project no:	drawing (issue) no:
2101	1.2.3(01)
checked by: JAL	plot date: 2/06/2022