

LOT 132
DP 17189

LOT 131
DP 17189

LOT 130
DP 17189

LOT 6
DP 22275

LOT 5
DP 22275

LOT 4
DP 22275

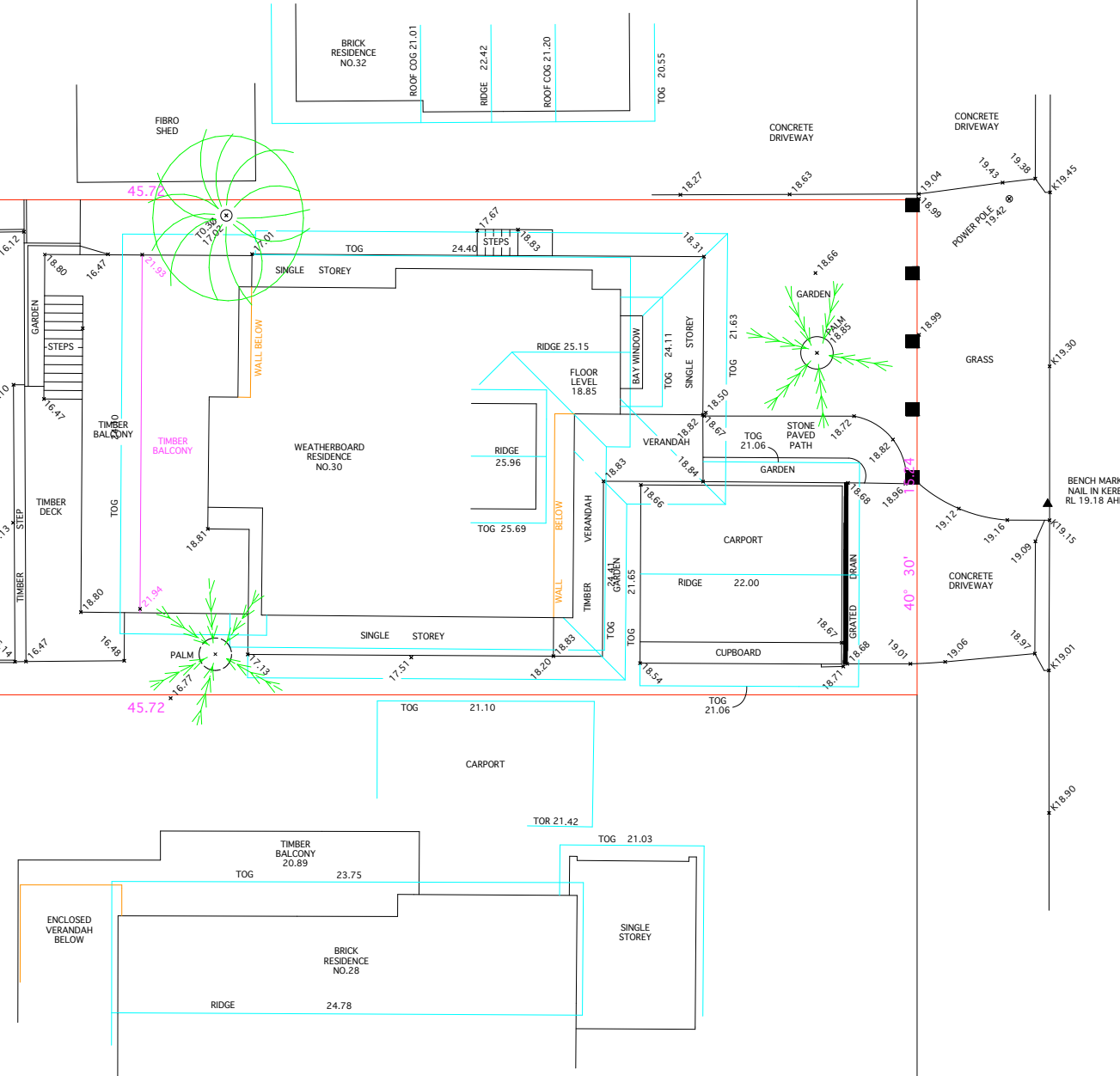

AVENUE

BINBURRA

NOTES:

1. CAUTION: SHOULD ANY DEVELOPMENT OR CONSTRUCTION BE PLANNED ON OR NEAR THE BOUNDARIES, THE BOUNDARIES SHOULD BE CLEARLY MARKED ON SITE.
2. SERVICES SHOWN HEREON HAVE BEEN DETERMINED FROM VISUAL EVIDENCE ONLY. PRIOR TO ANY DEMOLITION, EXCAVATION OR CONSTRUCTION ON THE SITE THE RELEVANT AUTHORITY SHOULD BE CONTACTED TO ESTABLISH DETAILED LOCATION AND DEPTH. MINIMISE YOUR RISK AND DIAL 1100 BEFORE YOU DIG.
3. THE BEARINGS ON THESE PLAN BOUNDARIES ARE FROM LAND TITLES OFFICE PLANS AND ARE SUBJECT TO FINAL SURVEY. BEARINGS SHOWN ARE BASED ON A TRUE MERIDIAN.
4. W DENOTES WINDOW. D DENOTES DOOR. WINDOW AND DOOR DEPTHS SHOWN ARE INDICATIVE ONLY.
5. ALL NEW WORKS MUST REFER TO THE BENCHMARK FOR LEVEL CONTROL.
6. TREE SPREADS ARE DIAGRAMMATIC ONLY AND MAY NOT BE SYMMETRICAL.
7. SRW, BRW, BLKRW, LRW, SLRW DENOTE STONE, BRICK, BLOCK, LOG OR SLEEPER RETAINING WALL.
8. TOG, TOR DENOTE TOP OF GUTTER OR ROOF, K DENOTES TOP OF KERB, G DENOTES ROAD GUTTER.
9. SUBJECT LAND IS AFFECTED BY A COVENANT NO. F487810 & POSITIVE COVENANT NO. AH214351 WHICH HAVE NOT BEEN INVESTIGATED.

PLAN OF

LOT 5 IN D.P. 22275
AT No.30 BINBURRA AVE., AVALON.

SCALE 1:100@A1 DATUM A.H.D.

SITE AREA = 696.8 M SQ.

DP SURVEYING

LAND & ENGINEERING SURVEYORS
46 JOHN ST, AVALON 2107
PHONE : 9918-3359
FAX NO : 9918-3360
EMAIL : david@dpsurveying.com.au
DATE : 9 JANUARY, 2013
MY REF : 2437