

northern  
beaches  
council

THIS PLAN IS TO BE READ IN  
CONJUNCTION WITH  
THE CONDITIONS OF DEVELOPMENT  
CONSENT

DA2019/0123

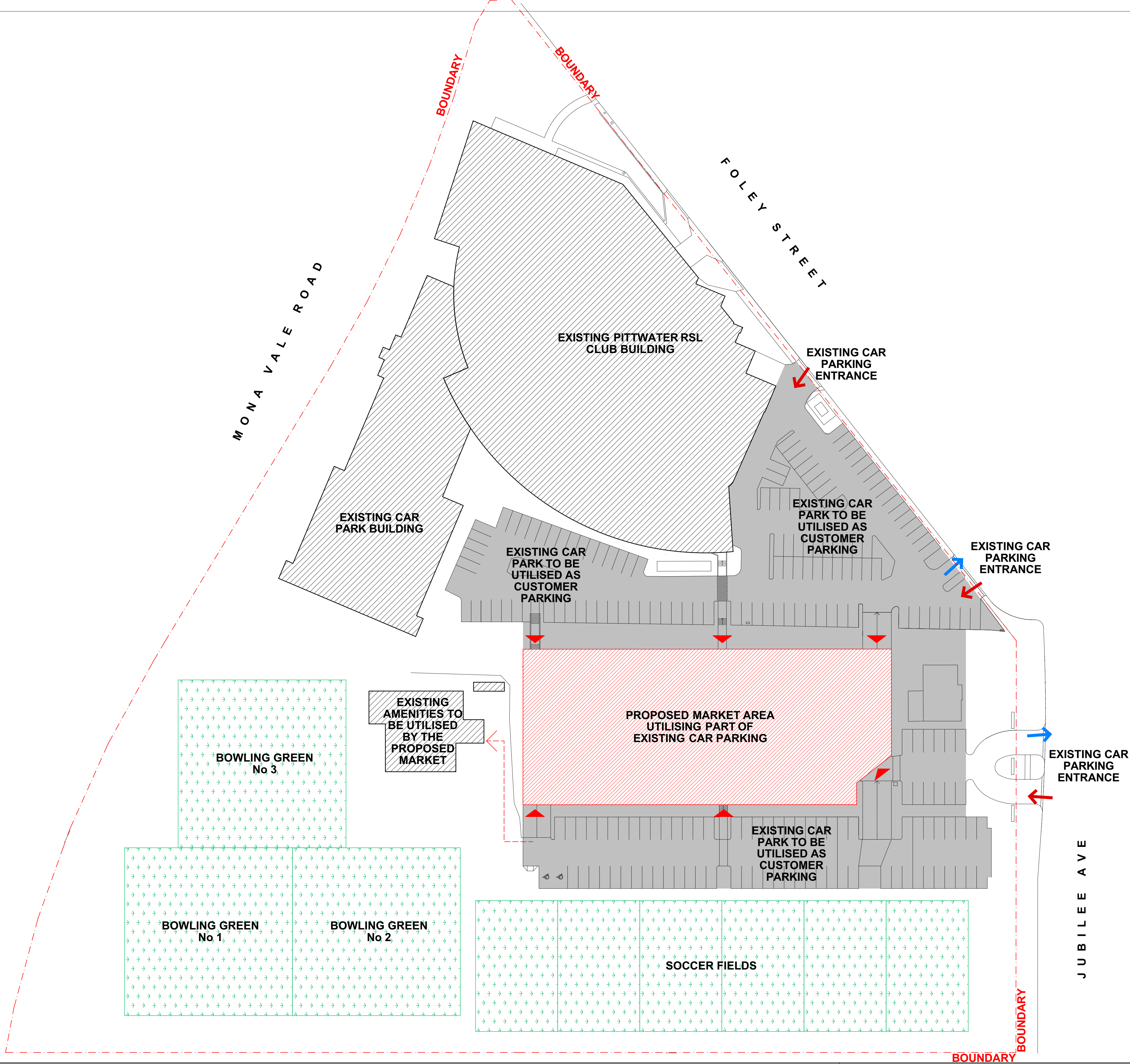

**BUREAU SRH | architecture** STUDIO 3 | 2 VERONA STREET | PADDINGTON | NSW | 2021 | AUSTRALIA |  
ABN: 94 115 880 834 | TEL: +61 2 9380 4666 | admin@bureau.srh.com

NOMINATED ARCHITECT: SIMON HANSON # 6739  
THIS DRAWING SHALL BE READ IN CONJUNCTION WITH ALL OTHER ARCHITECTURAL & CONSULTANT DRAWINGS & SPECIFICATIONS & WITH SUCH OTHER WRITTEN INSTRUCTIONS OR SKETCHES AS MAY BE ISSUED DURING THE COURSE OF THE CONTRACT. NOTIFY ARCHITECT OF ANY DISCREPANCIES BEFORE PROCEEDING WITH WORK. MATERIALS & WORKMANSHIP SHALL BE IN ACCORDANCE WITH THE SPECIFICATION, CURRENT SAA CODES, BUILDING REGULATIONS & THE REQUIREMENTS OF ANY OTHER RELEVANT STATUTORY AUTHORITIES. CONTRACTORS SHALL VERIFY ALL DIMENSIONS ON SITE AND NOTIFY ARCHITECT OF ANY DISCREPANCIES. USE FIGURED DIMENSIONS ONLY. COPYRIGHT, ALL RIGHT RESERVED. THIS DRAWING IS COPYRIGHT AND CONFIDENTIAL APART FROM ANY FAIR DEALINGS AS PERMITTED UNDER COPYRIGHT & MAY NOT BE REPRODUCED BY ANY PERSON WITHOUT WRITTEN PERMISSION OF THE ABOVE COMPANY & IS NOT TO BE USED IN ANY MANNER PREJUDICIAL TO THE INTERESTS OF THAT COMPANY. THIS DRAWING AND ATTACHED SHEET REMAIN THE PROPERTY OF BUREAU SRH PTY LTD

- LEGEND:
- CAR ENTRY
  - CAR EXIT
  - PEDESTRIAN ACCESS POINT
  - PROPOSED MARKET AREA
  - EXISTING CAR PARKING
  - EXISTING BUILDING

**PITTSWATER MARKET**

REV	DATE	NAME
01	13/02/2019	

**ORGANIC FOOD MARKET** PROJECT No: 19012

STAGE: <b>DA</b>	DRAWING TITLE: <b>SITE PLAN</b>	DRAWING No: <b>DA1000</b>
SCALE @ A1: <b>1:500</b>	CLIENT: #Client Company DRAWN: LY	REVISION: <b>01</b>
	CHECKED: HHH APPROVED: SRH	

13/02/2019 5:29 PM I:\Year17\20000 PROJECTS\19012 Pittwater RSL market\B - WORKINGS\B.01 - DRAWINGS\B.01 - CURRENT DRAWING FILES\19012\_Pittwater\_RSL\_Site\_Plan.dwg

northern beaches council  
 THIS PLAN IS TO BE READ IN CONJUNCTION WITH THE CONDITIONS OF DEVELOPMENT CONSENT  
 DA2019/0123

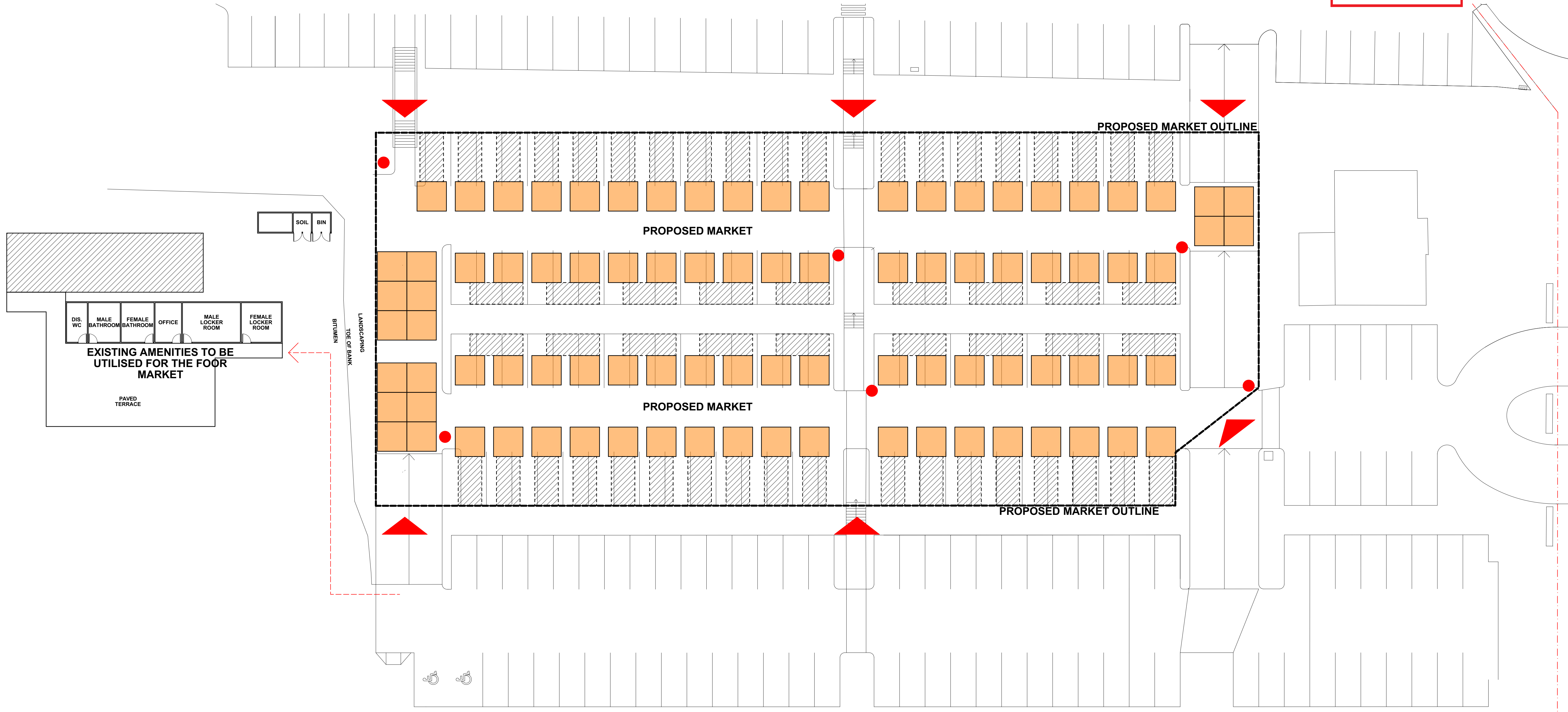

**BUREAU SRH | architecture** STUDIO 3 | 2 VERONA STREET | PADDINGTON | NSW | 2021 | AUSTRALIA |  
 ABN: 94 115 880 834 | TEL: +61 2 9380 4666 | admin@bureau.srh.com

NOMINATED ARCHITECT: SIMON HANSON # 6739  
 THIS DRAWING SHALL BE READ IN CONJUNCTION WITH ALL OTHER ARCHITECTURAL & CONSULTANT DRAWINGS & SPECIFICATIONS & WITH SUCH OTHER WRITTEN INSTRUCTIONS OR SKETCHES AS MAY BE ISSUED DURING THE COURSE OF THE CONTRACT. | NOTIFY ARCHITECT OF ANY DISCREPANCIES BEFORE PROCEEDING WITH WORK | MATERIALS & WORKMANSHIP SHALL BE IN ACCORDANCE WITH THE SPECIFICATION, CURRENT SAA CODES, BUILDING REGULATIONS & THE REQUIREMENTS OF ANY OTHER RELEVANT STATUTORY AUTHORITIES | CONTRACTORS SHALL VERIFY ALL DIMENSIONS ON SITE AND NOTIFY ARCHITECT OF ANY DISCREPANCIES | USE FIGURED DIMENSIONS ONLY | COPYRIGHT, ALL RIGHT RESERVED | THIS DRAWING IS COPYRIGHT AND CONFIDENTIAL APART FROM ANY FAIR DEALINGS AS PERMITTED UNDER COPYRIGHT & MAY NOT BE REPRODUCED BY ANY PERSON WITHOUT WRITTEN PERMISSION OF THE ABOVE COMPANY & IS NOT TO BE USED IN ANY MANNER PREJUDICIAL TO THE INTERESTS OF THAT COMPANY | THIS DRAWING AND ATTACHED SHEET REMAIN THE PROPERTY OF BUREAU SRH PTY LTD

- LEGEND:
- MARKET STALL GAZEBOS
  - STALL HOLDER CAR SPACE
  - PEDESTRIAN ACCESS POINT
  - WASTE & RECYCLING POINT
  - PEDESTRIAN ACCESS TO EXISTING AMENITIES
  - PROPOSED MARKET OUTLINE

**PITTWATER MARKET**

REV	DATE	NAME
01	13/02/2019	

**ORGANIC FOOD MARKET**

STAGE: <b>DA</b>	DRAWING TITLE: <b>INDICATIVE MARKET LAYOUT</b>
SCALE @ A1: <b>1:200</b>	CLIENT: <b>#Client Company</b> DRAWN: <b>LY</b>
	CHECKED: <b>HHH</b> APPROVED: <b>SRH</b>

PROJECT No: **19012**  
 DRAWING No: **DA1001**  
 REVISION: **01**

NOT FOR CONSTRUCTION

13/02/2019 5:29 PM I:\01917\2\0000\PROJECTS\19012\Pittwater\SRH\market\DRAWINGS\01\01 - CURRENT DRAWING FILES\19012\_Pittwater\RSK\_SKV\_DAP.dwg