

barrenjoey road

PODIUM LANDSCAPE:
 • BRACHYOTON POPULINEUS
 • DORNYANTHES EXCELSA
 • CYCAS REVOLUTA
 • NATIVE GRASSES

STREET PLANTING:
 • DORNYANTHES EXCELSA
 • CYCAS REVOLUTA
 • NATIVE GRASSES

BOUNDARY LANDSCAPE:
 • EUCALYPTUS GUMMIFERA
 • DORNYANTHES EXCELSA
 • CYCAS REVOLUTA
 • NATIVE GRASSES

RAISED PLANTER BED:
 • DORNYANTHES EXCELSA
 • CYCAS REVOLUTA
 • NATIVE GRASSES
 • BOUGANVILLEA SPP

DEEP SOIL:
 • EUCALYPTUS GUMMIFERA
 • DORNYANTHES EXCELSA
 • CYCAS REVOLUTA
 • NATIVE GRASSES

REAR LANDSCAPING:
 • EUCALYPTUS GUMMIFERA
 • DORNYANTHES EXCELSA
 • LIVISTONIA AUSTRALIS
 • CYCAS REVOLUTA
 • NATIVE GRASSES

REAR LANDSCAPING:
 • EUCALYPTUS GUMMIFERA
 • DORNYANTHES EXCELSA
 • LIVISTONIA AUSTRALIS
 • CYCAS REVOLUTA
 • NATIVE GRASSES

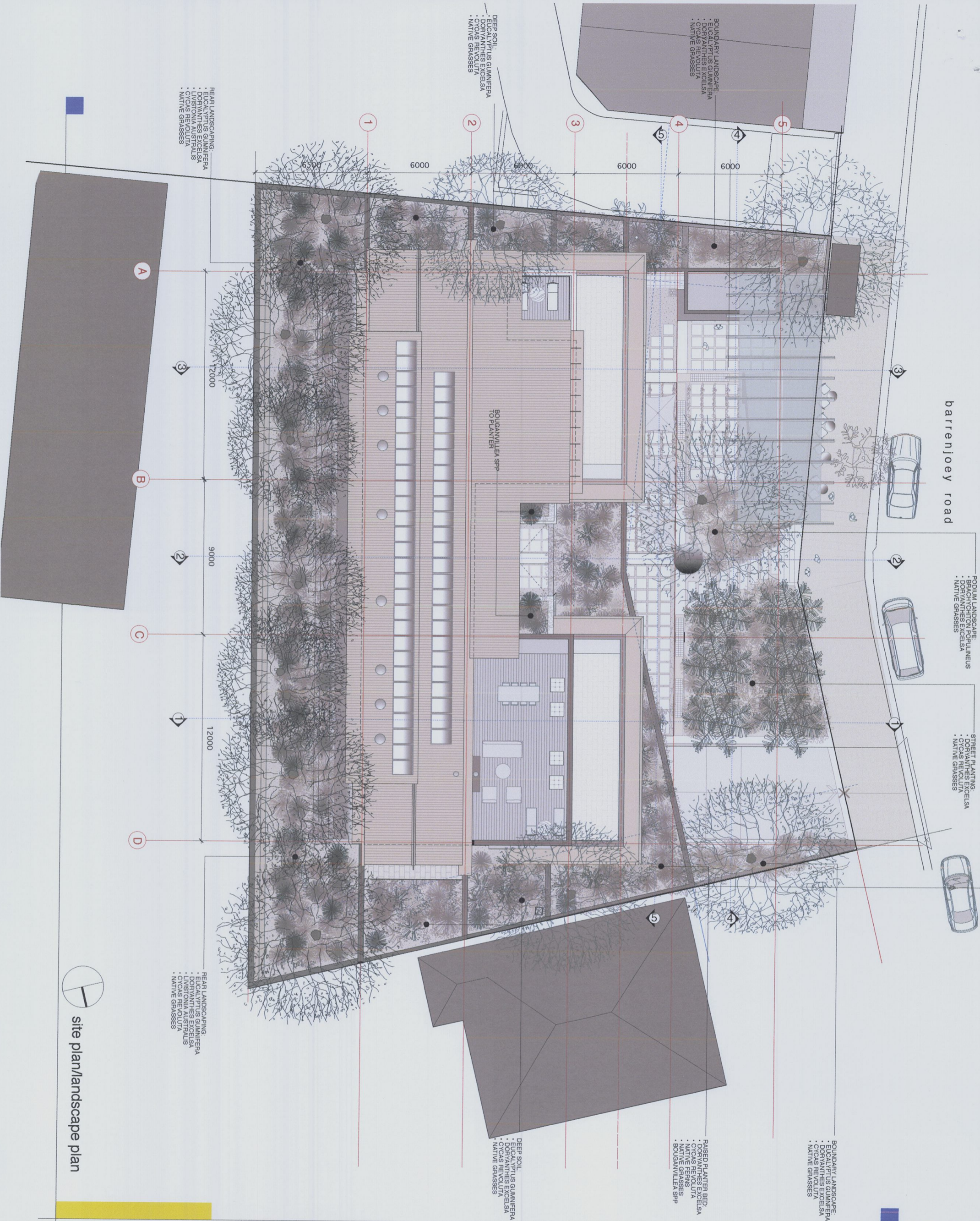

notes

To be read in conjunction with hydraulic engineer drawings.

Legend

- rs corrugated copper sheeting, capripts, etc
- g copper gutters
- dp round copper down pipes

- fc set hole cement
- sl plywood soffit lining

Solar Panels:

- ta Solar hot water panels with remote storage
- tb Photovoltaic cells

Walls:

- External:
 - tr(c) Fine cement render to concrete. (Colour: Buff (timber) or similar)
 - s Coursed sandstone

Internal:

- rm Rendered masonry
- tm Tiles on masonry

Floors:

- st Stone tiling
- sp Stone paving
- hd Hardwood decking

Ceilings:

- pb set plaster board

Windows:

- stw Sliding timber windows
- fg fixed glass

Doors:

- std Sliding timber framed doors
- gd panel lift garage door

Louvers/Screens:

- hss Hardwood timber slatted screen
- fm Fixed metal louvers



Thermal Specifications		
Roof roof	R1.5 insulation blanket	
Roof ceiling	Mixed SA 14.473 x 0.70	
External cavity block walls	R1.0 insulation	
External wall colour	Dark SA 13.70	
Total Insulation System value to air services	U=1.66 SHPC=0.2	
Window/doors to doors and windows	NFRC values	Yes

date	issue
OCT 09	A DEVELOPMENT APP

amendments
 drawing : site plan/landscape plan
 dng no. : DA 10
 scale : 1:100@A1 / 1:200@A3
 date : OCT 09
 drawn :
 checked :

1112-1118 Barrenjoey Road
 Palm Beach

site plan/landscape plan

LESJUK ARCHITECTS PTY LTD
 the studio, 1118 barrenjoey road palm beach nsw
 po box 30 palm beach nsw 2108
 telephone 612 9974 1010 fax/tnle 612 9974 8502
 email lesjukarchitects@bigpond.com



1. *glochidion terndrandii*
- 2.
- 3.
4. *caessalia kongiifolia*
5. rock orchid dendrobium
6. *achimaea fasciata* bromeliad
7. *asplenium thalicti* liliolum
8. *dieckmann*
9. bromeliad
10. *bankesia spinulosa*
11. bromeliad
12. *gymea lily* *doryanthes excelsa*
13. bromeliad spp
14. *buckinghamiaceae* *sessima*
15. *doodia aspera*
16. *cyathea australis*
17. *eupomatia laurina*
18. bleeding heart *orna* *lantinus*
19. *lystionia australis*
20. *gathia sieberiana*
21. *tema aspera*
22. *matrozamia communis*
23. *grevillia linearifolia*
24. rock orchid
25. *jacksonia scoparia*
26. *grevillia linearifolia*
27. *all tonulosa*
28. *umbrella fern*
29. *allicosaurina littoralis*
30. *grevillia sericea*

landscape planting

issue date
A sept. 09 da + sepp 05 review

palm beach village

1112 - 1116 barrerroy road, palm beach nsw

LESUIK ARCHITECTS PTY LTD

the studio, 1118 barrerroy road palm beach nsw
po box 30 palm beach nsw 2108
telephone 612 9974 1010 fax 612 9974 5502
email lesuikarchitects@bigpond.com



sept. 09 A da + ssgo 65 review
 date issue

amendments

palm beach village

1112 - 1116 barrackpoy road, palm beach nsw

LESUIK ARCHITECTS PTY LTD

the studio, 1116 barrackpoy road palm beach nsw
 telephone 612 8974 1010 local 02 9274 5502
 email lesuikarchitects@bigpond.com
 nsw board of architects registration number 6593