

LEGEND:

BAL = BALCONY
BOR = BOTTOM OF ROCK
CL = CENTRELINE
COL = COLUMN
CON = CONCRETE
DK = DECK
DRN = DRAIN
FCE = FENCE
FL = FLOOR LEVEL
GAFL = GARAGE FLOOR LEVEL
GDN = GARDEN
GRT = GRATE
GTE = GATE
HL = HEAD LEVEL
IL = INVERT LEVEL
LAN = LANDING
NS = NATURAL SURFACE
PAV = PAVING
PP = POWER POLE
RF = TOP OF ROOF
RK = ROCK
SCN = TOP OF SCREEN
SIP = SEWER INSPECTION PIT
SL = SILL LEVEL
STR = STAIRS
TG = TOP OF GUTTER
TKB = TOP OF KERB
TPIT = TELSTRA PIT
TR = TREE
TW = TOP OF WALL
UPIT = UNKNOWN PIT
VC = VEHICLE CROSSING

EO = ELECTRICITY OVERHEAD
S = SEWER UNDERGROUND

TREE
SPREAD-DIAMETER-HEIGHT

TITLE INDICATES THAT LOT 1 IN D.P.241941 IS SUBJECT TO:

- LAND EXCLUDES MINERALS AND IS SUBJECT TO RESERVATIONS AND CONDITIONS IN FAVOUR OF THE CROWN - SEE CROWN GRANT(S)
- EXCEPTING THE LAND BELOW A DEPTH FROM THE SURFACE OF 15.24 METRES BY THE CROWN GRANT

- (A) PROPOSED DRAINAGE EASEMENT 1.83m WIDE (DP241941) NOT SHOWN ON TITLE
- (B) PROPOSED DRAINAGE EASEMENT 2.44m WIDE (DP241941) NOT SHOWN ON TITLE

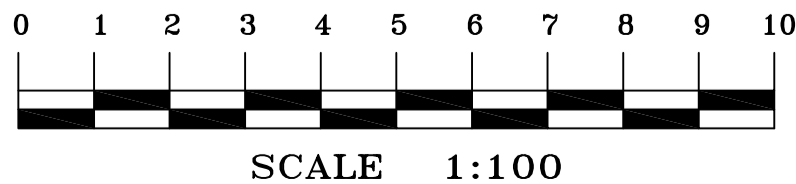
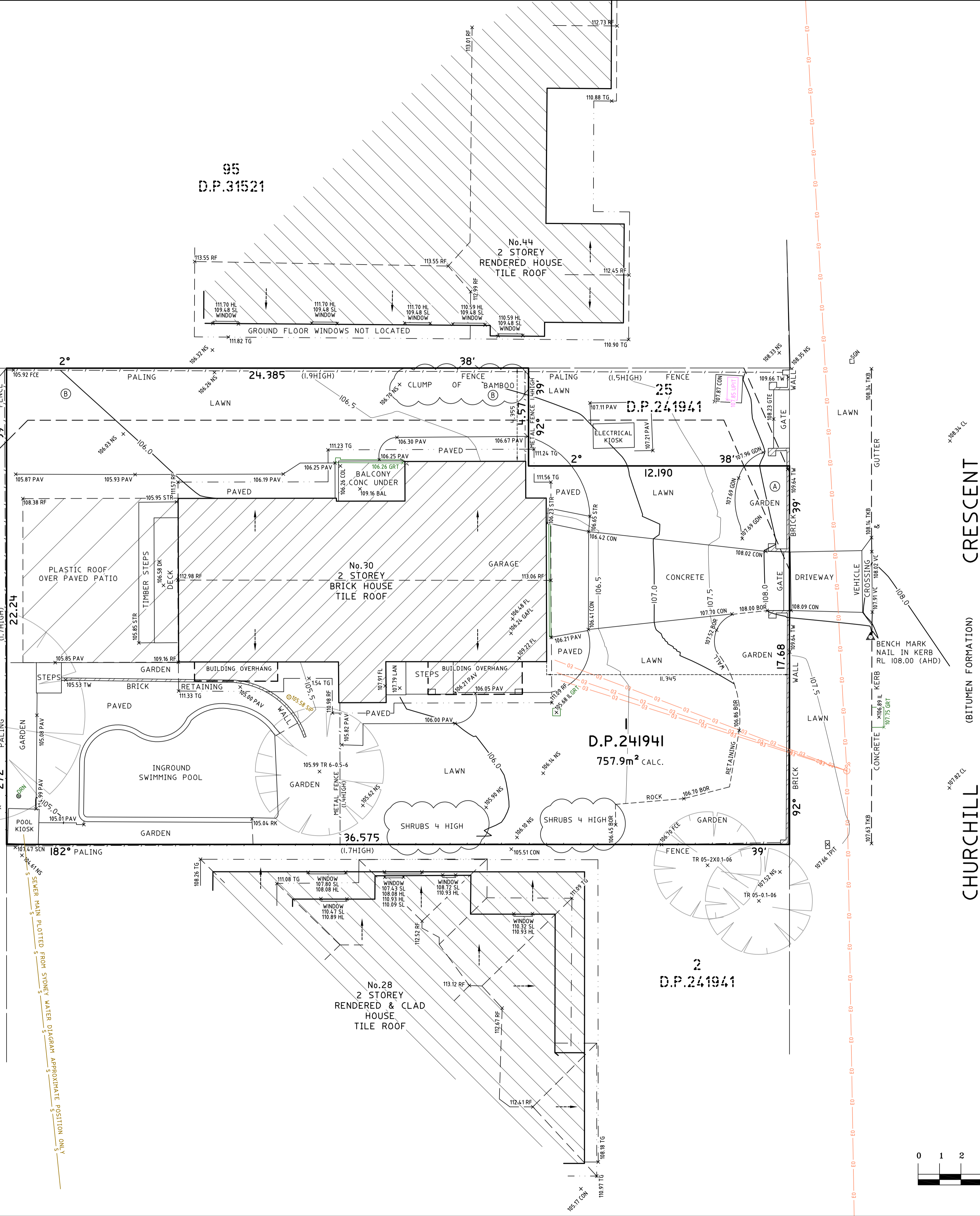

NOTES

- A BOUNDARY SURVEY HAS BEEN UNDERTAKEN.
- WALL TO BOUNDARY DIMENSIONS SHOWN HEREON MUST NOT BE USED FOR CONSTRUCTION.
- IF CONSTRUCTION IS INTENDED TO BE UNDERTAKEN ON OR ADJACENT TO PROPERTY BOUNDARIES THE BOUNDARIES OF THE LAND MUST BE MARKED OR THE BUILDING SETOUT.
- THIS SURVEY IS FOR DESIGN PURPOSES OF THE SUBJECT LAND ONLY. THIS PLAN MUST NOT BE USED FOR ANY OTHER MATTER, PURPOSE OR CONSTRUCTION SETOUT.
- TREE SIZES ARE ESTIMATES ONLY.
- THIS PLAN HAS BEEN PREPARED FOR THE EXCLUSIVE USE OF D & D HARDWOOD FLOORING
- RELATIONSHIP OF IMPROVEMENTS TO BOUNDARIES IS DIAGRAMMATIC ONLY. WHERE OFFSETS ARE CRITICAL THEY SHOULD BE CONFIRMED BY FURTHER SURVEY.
- EXCEPT WHERE SHOWN BY DIMENSION LOCATION OF DETAIL WITH RESPECT TO BOUNDARIES IS INDICATIVE ONLY.
- ONLY VISIBLE SERVICES HAVE BEEN LOCATED. UNDERGROUND SERVICES HAVE NOT BEEN LOCATED. DIAL BEFORE YOU DIG SERVICES (db 1100) SHOULD BE USED AND A FULL UTILITY INVESTIGATION, INCLUDING A UTILITY LOCATION SURVEY, SHOULD BE UNDERTAKEN BEFORE CARRYING OUT ANY CONSTRUCTION ACTIVITY IN OR NEAR THE SURVEYED AREA.
- SEWER MAIN PLOTTED FROM SYDNEY WATER SEWER DIAGRAM. LOCATION SHOULD BE MARKED ON SITE IF CRITICAL.
- CRITICAL SPOT LEVELS SHOULD BE CONFIRMED WITH SURVEYOR.
- CONTOURS SHOWN DEPICT THE TOPOGRAPHY. THEY DO NOT REPRESENT THE EXACT LEVEL AT ANY PARTICULAR POINT. ONLY SPOT LEVELS SHOULD BE USED FOR CALCULATIONS OF QUANTITIES WITH CAUTION.
- CONTOUR INTERVAL - 0.5 metre. - SPOT LEVELS SHOULD BE ADOPTED.
- POSITION OF RIDGE LINES ARE DIAGRAMMATIC ONLY (NOT TO SCALE).
- THE INFORMATION IS ONLY TO BE USED AT A SCALE ACCURACY OF 1:100.
- DO NOT SCALE OFF THIS PLAN / FIGURED DIMENSIONS TO BE TAKEN IN PREFERENCE TO SCALED READINGS.
- COPYRIGHT © CMS SURVEYORS 2020.
- NO PART OF THIS SURVEY MAY BE REPRODUCED, STORED IN A RETRIEVAL SYSTEM OR TRANSMITTED IN ANY FORM, WITHOUT THE WRITTEN PERMISSION OF THE COPYRIGHT OWNER EXCEPT AS PERMITTED BY THE COPYRIGHT ACT 1968.
- ANY PERMITTED DOWNLOADING, ELECTRONIC STORAGE, DISPLAY, PRINT, COPY OR REPRODUCTION OF THIS SURVEY SHOULD CONTAIN NO ALTERATION OR ADDITION TO THE ORIGINAL SURVEY.
- THIS NOTICE MUST NOT BE ERASED.

Stuart Mevov

REGISTERED SURVEYOR BOSSI NUMBER 265

HORIZONTAL DATUM:
CO-ORDINATE SYSTEM: ASSUMED
MARKS ADOPTED: N/A

VERTICAL DATUM:
DATUM: AUSTRALIAN HEIGHT DATUM (AHD)
B.M. ADOPTED: SSM 11978
R.L. 107.7 (CLASS D)
SOURCE: S.C.I.M.S. (02/06/2020)

1 FIRST ISSUE 16/06/2020

CLIENT:
D & D HARDWOOD FLOORING
30 CHURCHILL CRESCENT
ALLAMBIE HEIGHTS, NSW, 2100

SURVEY PLAN
SHOWING DETAIL & LEVEL
OVER LOT 1 IN DP241941
30 CHURCHILL CRESCENT
ALLAMBIE HEIGHTS, NSW, 2100

C.M.S. Surveyors
Pty Limited

ACN: 096 240 201

PO Box 463 Dee Why
NSW 2099
2/80A South Creek Road,
Dee Why NSW 2099
Telephone: (02) 9971 4802
Facsimile: (02) 9971 4822
E-mail: info@cmsurveyors.com.au

LGA: NORTHERN BEACHES SHEET 1 OF 1

SURVEYED NS	DRAWN ABS	CHECKED NS	APPROVED AF
SURVEY INSTRUCTION 19407	SCALE 1:100 1:200 A3	DATE OF SURVEY 03/06/2020	ISSUE 1
DRAWING NAME 19407detail			
CAD FILE 19407detail 1.dwg			