

**Tree Impact and Protection Plan Legend**

- Existing Tree Retained (Extent of canopy as verified by site measure and aerial photos)
- Existing Tree Removed (Note: no TPZ's shown for these trees)
- Tree Identification Number
- Construction Period Tree Protection Zone - consolidated area
- Tree Protection Zone temporary fencing
- Trunk Protection Battens to be installed
- Loss of roots due to excavation or trenching
- Surface impact to be managed - minimal root loss expected
- Nominal Tree Protection Zone Radius (TPZ)
- Proposed Future Building Outline
- Existing buildings and structures to be demolished
- Extent of ground modification and disturbance

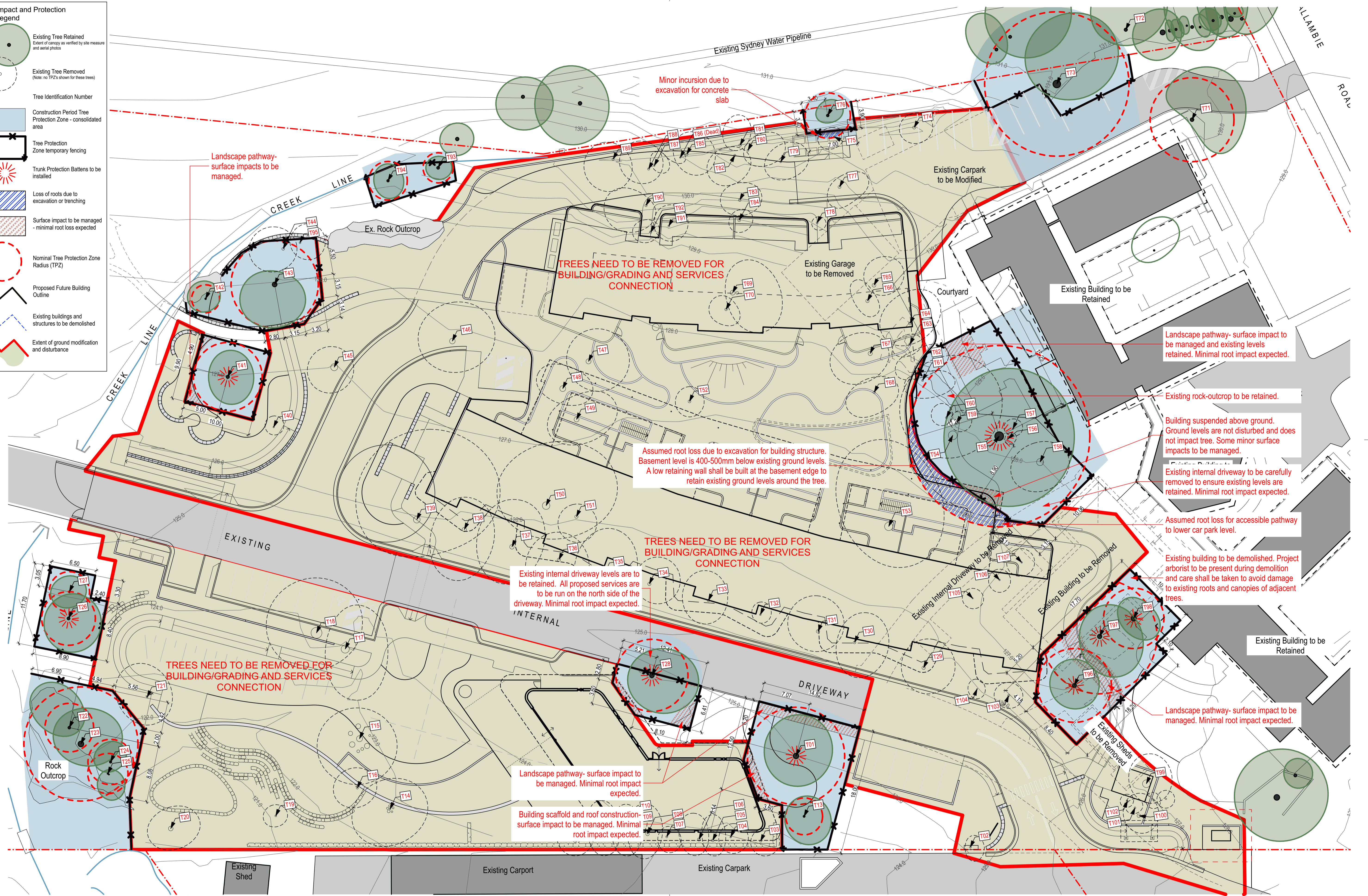

Minor incursion due to excavation for concrete slab

Landscape pathway- surface impacts to be managed.

**TREES NEED TO BE REMOVED FOR BUILDING/GRADING AND SERVICES CONNECTION**

Assumed root loss due to excavation for building structure. Basement level is 400-500mm below existing ground levels. A low retaining wall shall be built at the basement edge to retain existing ground levels around the tree.

Landscape pathway- surface impact to be managed and existing levels retained. Minimal root impact expected.

Existing rock-outcrop to be retained.

Building suspended above ground. Ground levels are not disturbed and does not impact tree. Some minor surface impacts to be managed.

Existing internal driveway to be carefully removed to ensure existing levels are retained. Minimal root impact expected.

Assumed root loss for accessible pathway to lower car park level.

Existing building to be demolished. Project arborist to be present during demolition and care shall be taken to avoid damage to existing roots and canopies of adjacent trees.

Existing internal driveway levels are to be retained. All proposed services are to be run on the north side of the driveway. Minimal root impact expected.

**TREES NEED TO BE REMOVED FOR BUILDING/GRADING AND SERVICES CONNECTION**

**TREES NEED TO BE REMOVED FOR BUILDING/GRADING AND SERVICES CONNECTION**

Landscape pathway- surface impact to be managed. Minimal root impact expected.

Building scaffold and roof construction- surface impact to be managed. Minimal root impact expected.

Landscape pathway- surface impact to be managed. Minimal root impact expected.

**NOTE**  
Refer to the accompanying Arboricultural Impact Assessment Report for full description of trees, measurements and methods used to assess the trees, and proposed tree protection measures. Refer to T-02 for tree protection specifications and schedule.



ARTERRA DESIGN PTY LTD ABN 40 069 552 610  
SUITE 602 / 51 RAWSON STREET, EPPING, NSW 2121  
P 02 9957 2466 F 02 9957 3977 W ARTERRA.COM.AU



REVISION	DESCRIPTION	CHKD	DATE
A	For Authority Approval/DA	RWS	15/11/19

PROJECT & CLIENT  
**Allambie Heights Village - Project 2**

Allambie Heights Village Ltd.  
DRAWING TITLE  
**Tree Protection & Removal Plan**

Project No : 18.11  
Designed : CLB  
Drawn : CLB  
Scale : 1:250@A1/1:500@A3  
DRAWING NUMBER  
**T-03**  
REVISION  
**A**