

# STORMWATER MANAGEMENT PLAN

## PROPOSED DEVELOPMENT

### No. WHALE BEACH ROAD WHALE BEACH

#### GENERAL NOTES

- FINAL LOCATION OF NEW DOWNPIPES TO BE DETERMINED BY BUILDER/ARCHITECT AT TIME OF CONSTRUCTION.
- THESE DRAWINGS TO BE READ IN CONJUNCTION WITH ARCHITECTS AND OTHER CONSULTANTS DRAWINGS. ANY DISCREPANCIES TO BE REFERRED TO THE ENGINEER BEFORE PROCEEDING WITH WORK.
- ALL MATERIALS AND WORKMANSHIP TO BE IN ACCORDANCE WITH AS/NZS 3500.3:2003 STORMWATER DRAINAGE, BCA AND LOCAL COUNCIL POLICY/CONSENT/REQUIREMENTS.
- ALL DIMENSIONS AND LEVELS TO BE VERIFIED BY BUILDER ON-SITE PRIOR TO COMMENCEMENT OF WORKS. THESE DRAWINGS ARE NOT TO BE SCALED FOR DIMENSIONS NOR TO BE USED FOR SETOUT PURPOSES.
- ALL SURVEY INFORMATION AND PROPOSED BUILDING AND FINISHED SURFACE LEVELS SHOWN IN THESE DRAWINGS ARE BASED ON LEVELS OBTAINED FROM DRAWINGS BY OTHERS.
- ALL STORMWATER DRAINAGE PIPES ARE TO BE uPVC AT MINIMUM 1% GRADE UNLESS NOTED OTHERWISE.
- IT IS THE CONTRACTORS RESPONSIBILITY TO LOCATE AND LEVEL ALL EXISTING SERVICES OR OTHER STRUCTURES WHICH MAY AFFECT/BE AFFECTED BY THIS DESIGN PRIOR TO COMMENCEMENT OF WORKS.
- ALL PITS WITHIN DRIVEWAYS TO BE 150mm THICK CONCRETE OR EQUAL.
- THIS PLAN IS THE PROPERTY OF RESOLUTE STORMWATER AND MAY NOT BE USED OR REPRODUCED WITHOUT WRITTEN PERMISSION FROM RESOLUTE STORMWATER.

#### PLAN SPECIFIC NOTES

- ROOF DRAINAGE NOTE:** TO BE ISSUED AT CC STAGE - AS 3500 ROOF DRAINAGE REQUIRES EAVES GUTTERS TO BE SIZED FOR 20-YEAR 5-MIN. STORM = 205mm/hr. FOR EAVES GUTTERS, AS 3500.3:2003 THEN HAS THE FOLLOWING REQUIREMENTS:
  - i) FOR TYPICAL STANDARD QUAD GUTTER WITH  $A_e = 8000\text{mm}^2$  AND GUTTER SLOPE 1:500 AND STEEPER, THIS REQUIRES ONE DOWNPIPE PER  $30\text{m}^2$  ROOF AREA.
  - ii) DOWNPIPES TO BE MINIMUM 90mm DIA. OR 100 x 50mm FOR GUTTERS SLOPE 1:500 AND STEEPER.
  - iii) OVERFLOW METHOD TO FIGURE G1 OF AS 3500.3:2003
 IT IS THE RESPONSIBILITY OF THE PLUMBER AND/OR BUILDER TO COMPLY WITH THIS. THIS DRAWING SHOWS PRELIMINARY LOCATIONS / NUMBERS OF DOWNPIPES ONLY WHICH ARE TO BE VERIFIED BY BUILDER / PLUMBER
- TREE PRESERVATION:** IT IS THE RESPONSIBILITY OF THE CONTRACTOR TO OBTAIN ANY PRIOR APPROVAL REQUIRED FROM COUNCIL WITH RESPECT TO POTENTIAL IMPACT ON TREES FOR ANY WORKS SHOWN ON THIS DRAWING PRIOR TO THE COMMENCEMENT OF THOSE WORKS
- ALL ROOF GUTTERS TO HAVE OVERFLOW PROVISION IN ACCORDANCE WITH AS 3500.3:2003 AND SECTIONS 3.5.3, 3.7.5 AND APPENDIX G OF AS 3500.3:2003
- THIS DRAWING IS NOT TO BE USED FOR SET-OUT PURPOSES - REFER TO ARCHITECTURAL DRAWINGS
- LOCATION OF SURFACE STORMWATER GRATED INLET PITS MAY BE VARIED OR NEW PITS INSTALLED AT THE CONSTRUCTION STAGE PROVIDED DESIGN INTENT OF THIS DRAWING IS MAINTAINED

#### DRAINAGE NOTES

##### PIPE SIZE:

THE MINIMUM PIPE SIZE SHALL BE:

- 90mm DIA WHERE THE LINE ONLY RECEIVES ROOFWATER RUNOFF; OR
- 100mm DIA WHERE THE LINE RECEIVES RUNOFF FROM PAVED OR UNPAVED AREAS ON THE PROPERTY

THE MINIMUM PIPE VELOCITY SHOULD BE 0.6 m/s AND A MAXIMUM PIPE VELOCITY OF 6.0 m/s DURING THE DESIGN STORM.

##### PIPE GRADE:

THE MINIMUM PIPE GRADE SHALL BE:

- 1.0% FOR PIPES LESS THAN 225mm DIA (UNO)
- 0.5% FOR ALL LARGER PIPES (UNO)

PIPES WITH A GRADIENT GREATER THAN 20% WILL REQUIRE ANCHOR BLOCKS AT THE TOP AND BOTTOM OF THE INCLINED SECTION; AND AT INTERVALS NOT EXCEEDING 3.0m

ANCHOR BLOCKS ARE DESIGNED ACCORDING TO CLAUSE 3.5.3 OF AS3500.3-1990

##### DEPTH OF COVER FOR PVC PIPES:

MINIMUM PIPE COVER SHALL BE AS FOLLOWS:

LOCATION	MINIMUM COVER
NOT SUBJECT TO VEHICLE LOADING	100mm SINGLE RESIDENTIAL 300mm ALL OTHER DEVELOPMENTS
SUBJECT TO VEHICLE LOADING UNDER A SEALED ROAD	450mm WHERE NOT IN A ROAD 600mm
UNSEALED ROAD	750mm
PAVED DRIVEWAY	100mm PLUS DEPTH OF CONCRETE

SEE AS2032 INSTALLATION OF UPVC PIPES FOR FURTHER INFORMATION.

CONCRETE PIPE COVER SHALL BE IN ACCORDANCE WITH AS3725-1989 LOADS ON BURIED CONCRETE PIPES, HOWEVER A MINIMUM COVER OF 450mm WILL APPLY.

WHERE INSUFFICIENT COVER IS PROVIDED, THE PIPE SHALL BE COVERED AT LEAST 50mm THICK OVERLAY AND SHALL THEN BE PAVED WITH AT LEAST:

- 150mm REINFORCED CONCRETE WHERE SUBJECT TO HEAVY VEHICLE TRAFFIC;
- 75mm THICKNESS OF BRICK OR 100mm OF CONCRETE PAVING WHERE SUBJECT TO LIGHT VEHICLE TRAFFIC; OR
- 50mm THICK BRICK OR CONCRETE PAVING WHERE NOT SUBJECT TO VEHICLE TRAFFIC.

##### CONNECTIONS TO STORMWATER DRAINS UNDER BUILDINGS:

SHALL BE CARRIED OUT IN ACCORDANCE WITH SECTION 3.10 OF AS3500.3-1990

##### CONNECTIONS TO COUNCIL SYSTEM:

IF PROPOSED DRAINAGE SYSTEM IS DESIGNED TO CONNECT TO COUNCIL'S DRAINAGE SYSTEM, IT IS ADVISED THAT A 'WORKS PERMIT' IS OBTAINED FROM THE RESPECTIVE COUNCIL PRIOR TO COMMENCEMENT OF WORKS

##### ABOVE GROUND PIPEWORK:

SHALL BE CARRIED OUT IN ACCORDANCE WITH SECTION 6 OF AS3500.3-1990

##### PIT SIZES AND DESIGN:

DEPTH (mm)	MINIMUM PIT SIZE (mm)
UP TO 600mm	450 x 450
600mm TO 900mm	600 x 600
900mm TO 1200mm	600 x 900
OVER 1200mm	900 x 900 (WITH STEP IRONS)

ALL PIPES SHOULD BE CUT FLUSH WITH THE WALL OF THE PIT.

PITS GREATER THAN 600mm DEEP SHALL HAVE A MINIMUM ACCESS OPENING OF 600 x 600mm

THE GRATED COVERS OF PITS LARGER THAN 600 x 600mm ARE TO BE HINGED TO PREVENT THE GRATE FROM FALLING INTO THE PIT.

THE BASE OF THE DRAINAGE PITS SHOULD BE AT THE SAME LEVEL AS THE INVERT OF THE OUTLET PIPE. RAINWATER SHOULD NOT BE PERMITTED TO POND WITHIN THE STORMWATER SYSTEM

- TRENCH DRAINS:** CONTINUOUS TRENCH DRAINS ARE TO BE OF WIDTH NOT LESS THAN 150mm AND DEPTH NOT LESS THAN 100mm. THE BARS OF THE GRATING ARE TO BE PARALLEL TO THE DIRECTION OF SURFACE FLOW.
- STEP IRONS:** PITS BETWEEN 1.2m AND 6m ARE TO HAVE STEP IRONS IN ACCORDANCE WITH AS1657. FOR PITS GREATER THAN 6m OTHER MEANS OF ACCESS MUST BE PROVIDED.
- PVC PITS:** PVC PITS WILL ONLY BE PERMITTED IF THEY ARE NOT A GREATER SIZE THAN 450 x 450mm (MAXIMUM DEPTH 450mm) AND ARE HEAVY DUTY
- IN-SITU PITS:** IN-SITU PITS ARE TO BE CONSTRUCTED ON A CONCRETE BED OF AT LEAST 150mm THICK. THE WALLS ARE TO BE DESIGNED TO MEET THE MINIMUM REQUIREMENTS OF CLAUSE 4.6.3 OF AS3500.4-1990. PITS DEEPER THAN 1.8m SHALL BE CONSTRUCTED WITH REINFORCED CONCRETE.
- GRATES:** GRATES ARE TO BE GALVANISED STEEL GRID TYPE. GRATES ARE TO BE OF HEAVY-DUTY TYPE IN AREAS WHERE THEY MAY BE SUBJECT TO VEHICLE LOADING.

#### LEGEND

SURFACE INLET PIT		GRADED TRENCH DRAIN	
SURFACE INLET PIT (WITH ENVIROPOD 200 MICRON)		ABSORPTION TRENCH	
ACCESS GRATE (WITH ENVIROPOD 200 MICRON)		PROPOSED ROOF GUTTER FALL	
450 SQUARE INTERVAL	450 X 450	PROPOSED DOWNPIPE SPREADER	
GRATE LEVEL = 75.50	SL 75.50	STORMWATER PIPE 100mm DIA. MIN. UNO	
INVERT LEVEL = RL 75.20	IL 75.20	SUBSOIL PIPE	
PROPOSED DOWNPIPE 90mm DIA. OR 100mm x 50mm MIN.		EXISTING STORMWATER PIPE	
NATURAL GROUND FINISHED DESIGN LEVEL		INSPECTION RISER	
		RAINWATER HEAD	



DRAWING TITLE:  
**DETAILS, NOTES & LEGEND**

COPYRIGHT - THIS DRAWING REMAINS THE PROPERTY OF RESOLUTE SW AND MAY NOT BE ALTERED IN ANY WAY WITHOUT RESOLUTE STORMWATER WRITTEN CONSENT.

DRAWN	DATE	DESCRIPTION	ISSUE	FOR
MT	23/11/24	ISSUED FOR DA	A	WOODWARD ARCHITECTS
				SITE ADDRESS:
				146
				WHALE BEACH ROAD
				WHALE BEACH
PROJECT		ALTS & ADDS		

APPROVED BY:  
**NOT FOR CONSTRUCTION**

DESIGNED BY:	MT	ISSUE
CHECKED BY:	AR	<b>A</b>
SCALE	-	SHEET No.
SHEET SIZE	A3	
CLIENT REF.	DRAWING No.	
	24-0118	<b>D1</b>

**NOTE:** ENSURE ANY PROPOSED PAVING IS GRADED SO THAT IT IS NOT IMPACTING ADJOINING PROPERTIES.

**NOTE:** ENSURE SURFACE FLOWS CAN BE ACHIEVED AROUND THE DWELLINGS AND DOWN THE SIDE PASSAGEWAYS IN THE EVENT OF PIT AND PIPE FAILURE.

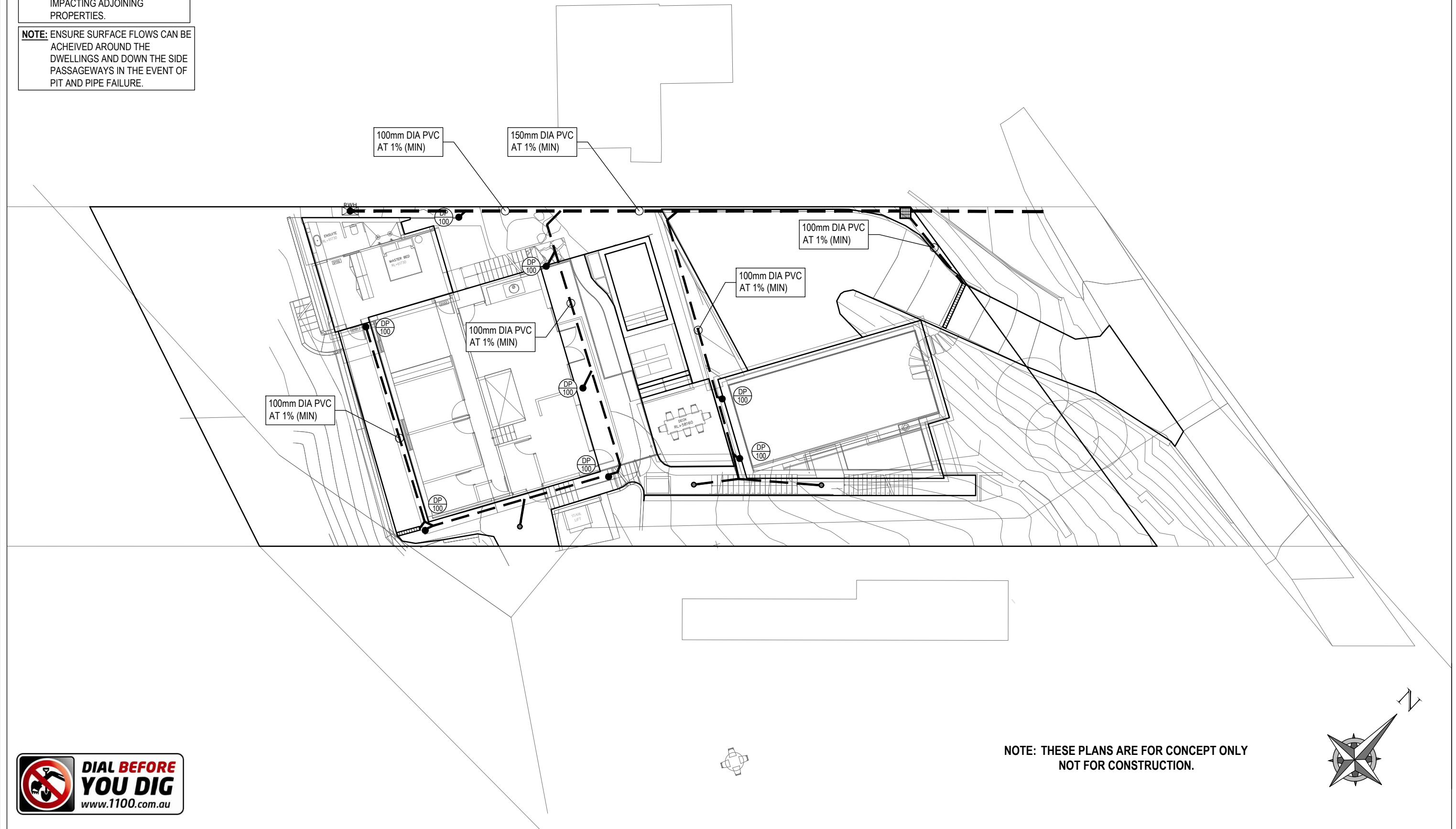

**NOTE: THESE PLANS ARE FOR CONCEPT ONLY  
NOT FOR CONSTRUCTION.**

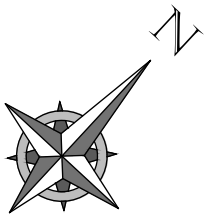

DRAWING TITLE:  
**STORMWATER  
MANAGEMENT PLAN**

COPYRIGHT - THIS DRAWING REMAINS THE PROPERTY OF RESOLUTE SW AND MAY NOT BE ALTERED IN ANY WAY WITHOUT RESOLUTE STORMWATER WRITTEN CONSENT.

DRAWN	DATE	DESCRIPTION	ISSUE	FOR
MT	23/11/24	ISSUED FOR DA	A	WOODWARD ARCHITECTS
				SITE ADDRESS: 146 WHALE BEACH ROAD WHALE BEACH
PROJECT		ALTS & ADDS		

APPROVED BY:
<b>NOT FOR CONSTRUCTION</b>

DESIGNED BY:	MT	ISSUE
CHECKED BY:	AR	<b>A</b>
SCALE	1:200	
SHEET SIZE	A3	SHEET No.
CLIENT REF.	DRAWING No.	<b>D2</b>
	<b>24-0118</b>	

**NOTE:** ENSURE ANY PROPOSED PAVING IS GRADED SO THAT IT IS NOT IMPACTING ADJOINING PROPERTIES.

**NOTE:** ENSURE SURFACE FLOWS CAN BE ACHIEVED AROUND THE DWELLINGS AND DOWN THE SIDE PASSAGEWAYS IN THE EVENT OF PIT AND PIPE FAILURE.

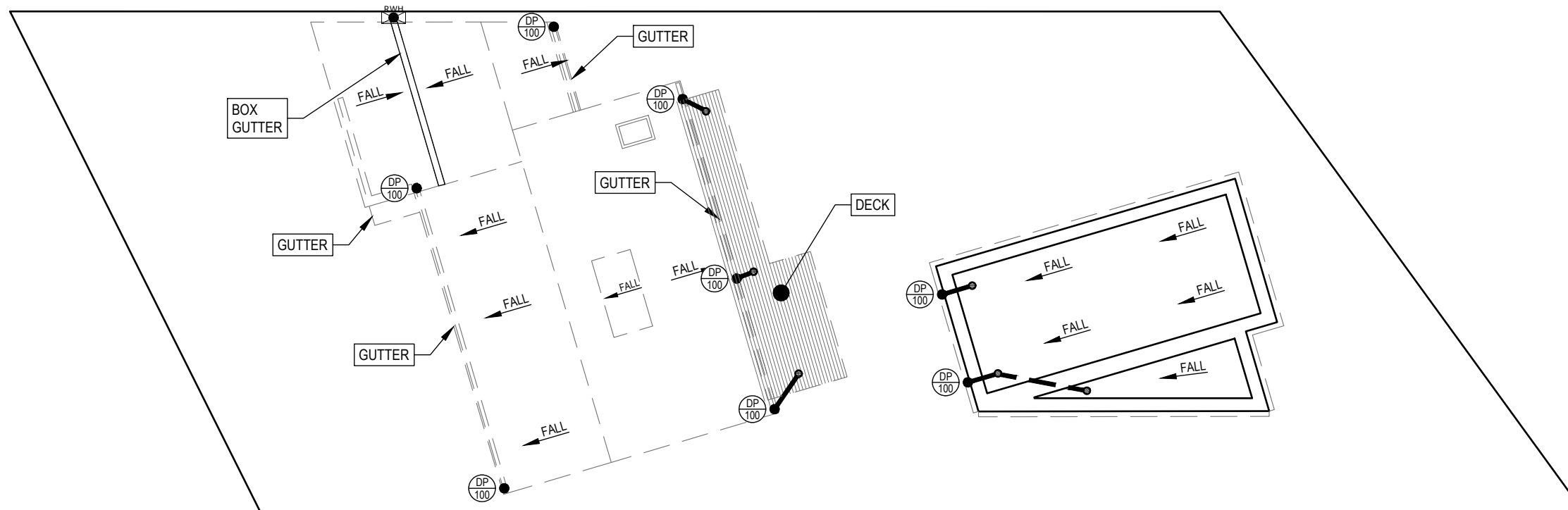

**NOTE:** THESE PLANS ARE FOR CONCEPT ONLY  
NOT FOR CONSTRUCTION.

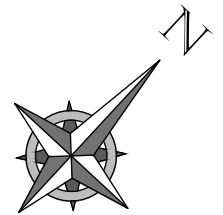

DRAWING TITLE:  
**ROOF STORMWATER PLAN**

COPYRIGHT - THIS DRAWING REMAINS THE PROPERTY OF RESOLUTE SW AND MAY NOT BE ALTERED IN ANY WAY WITHOUT RESOLUTE STORMWATER WRITTEN CONSENT.

DRAWN	DATE	DESCRIPTION	ISSUE	FOR
MT	23/11/24	ISSUED FOR DA	A	WOODWARD ARCHITECTS
				SITE ADDRESS: 146 WHALE BEACH ROAD WHALE BEACH
PROJECT		ALTS & ADDS		

APPROVED BY:  
**NOT FOR CONSTRUCTION**

DESIGNED BY:	MT	ISSUE
CHECKED BY:	AR	<b>A</b>
SCALE	1:200	
SHEET SIZE	A3	SHEET No.
CLIENT REF.	DRAWING No.	<b>D3</b>
	24-0118	

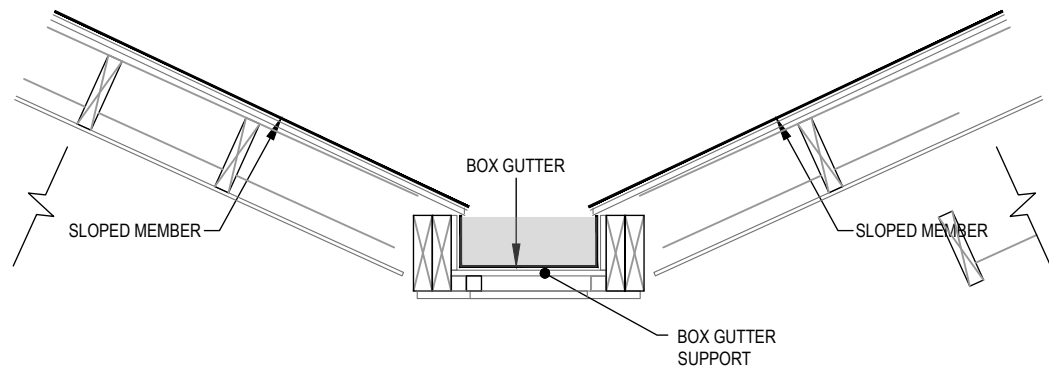

**BOX GUTTER**  
1:20

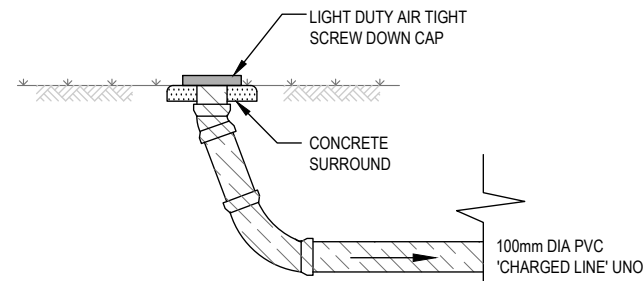

**INSPECTION RISER - IR**  
NTS

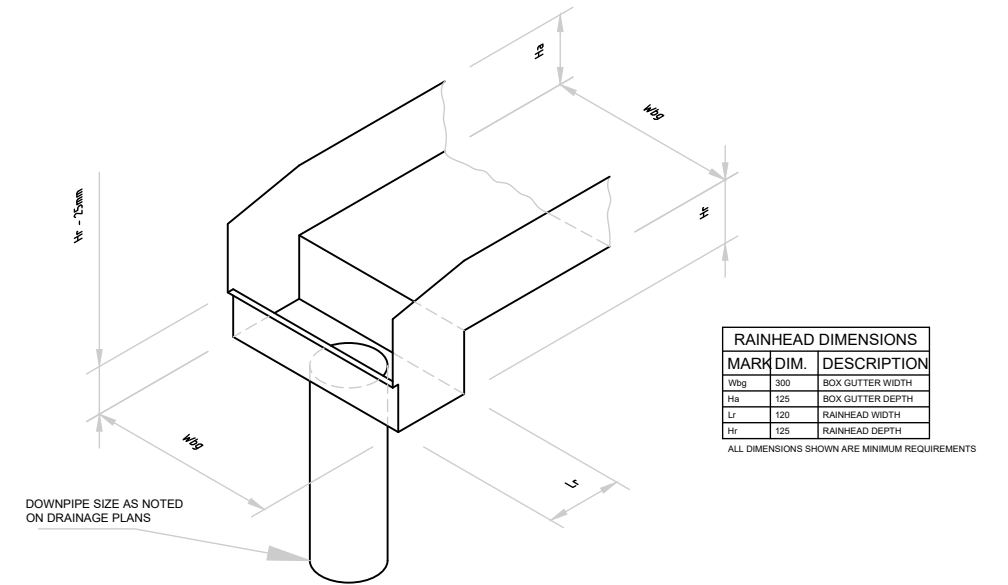

RAINHEAD DIMENSIONS		
MARK	DIM.	DESCRIPTION
Wbg	300	BOX GUTTER WIDTH
Ha	125	BOX GUTTER DEPTH
Lr	120	RAINHEAD WIDTH
Hf	125	RAINHEAD DEPTH

ALL DIMENSIONS SHOWN ARE MINIMUM REQUIREMENTS

**RAINWATER HEAD DIMENSIONS**

NOT TO SCALE

1. THE RAINHEAD SHALL BE FULLY SEALED TO THE BOX GUTTER AND THE FRONT OF THE RAINHEAD LEFT OPEN ABOVE THE OVERFLOW WEIR
2. MINIMUM FALL ALONG BOX GUTTER SHALL BE 1:100

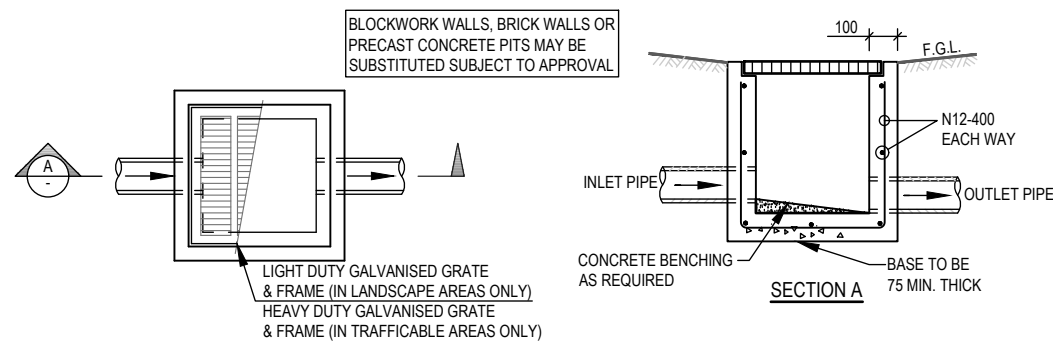

**TYPICAL PIT (SIP)**  
NTS

NOTE:  
ALL PROPOSED SITE PITS ARE TO BE CONSTRUCTED IN CONCRETE CAST IN SITU. PLASTIC OR BRICK PITS ARE NOT ACCEPTABLE. HOWEVER, 'COUNCIL MAY CONSIDER PRE-CAST UNITS IF THE UNITS ARE PLACED ON A SOLID BASE OF GRAVEL OR CONCRETE OF 75mm THICK AND BACKFILL UP TO HALF THE DEPTH OF THE PIT SURROUND WITH CONCRETE.

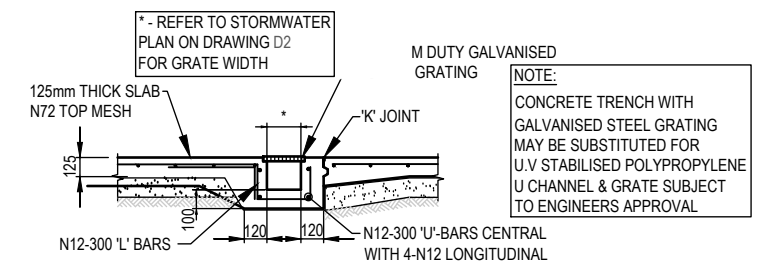

**GRATED DRAIN**  
NTS



<b>RESOLUTE</b> STORMWATER	DRAWING TITLE:	DRAWN	DATE	DESCRIPTION	ISSUE	FOR	APPROVED BY:	DESIGNED BY:	MT	ISSUE	
	<b>STORMWATER</b> DETAILS	MT	23/11/24	ISSUED FOR DA	A	WOODWARD ARCHITECTS	<b>NOT FOR</b> <b>CONSTRUCTION</b>	CHECKED BY:	AR	<b>A</b>	
		SCALE			AS NOTED			SHEET SIZE	A3		SHEET No.
		SHEET SIZE			A3			CLIENT REF.	DRAWING No.		<b>D4</b>
		PROJECT	ALTS & ADDS						24-0118		
COPYRIGHT - THIS DRAWING REMAINS THE PROPERTY OF RESOLUTE SW AND MAY NOT BE ALTERED IN ANY WAY WITHOUT RESOLUTE STORMWATER WRITTEN CONSENT.						146					

SITE ADDRESS:  
146  
WHALE BEACH ROAD  
WHALE BEACH

**DUST CONTROL:**

• NOTE: DURING EXCAVATION, DEMOLITION AND CONSTRUCTION, ADEQUATE MEASURES SHALL BE TAKEN TO PREVENT DUST FROM AFFECTING THE AMENITY OF THE NEIGHBORHOOD.

THE FOLLOWING MEASURES MUST BE ADOPTED:

1. PHYSICAL BARRIERS SHALL BE ERECTED AT RIGHT ANGLES TO PREVENT WIND DIRECTION OR SHALL BE PLACED AROUND OR OVER DUST SOURCES TO PREVENT WIND OR ACTIVITY FROM GENERATING DUST.
2. EARTHWORKS AND SCHEDULING ACTIVITIES SHALL BE MANAGED TO COINCIDE WITH THE NEXT STAGE OF DEVELOPMENT TO MINIMISE THE AMOUNT OF TIME THE SITE IS LEFT TO CUT OR EXPOSED.
3. ALL MATERIALS SHALL BE STORED OR STOCKPILED AT THE BEST LOCATIONS.
4. THE GROUND SURFACE SHOULD BE DAMPENED SLIGHTLY TO PREVENT DUST FROM BECOMING AIRBORNE BUT SHOULD NOT BE WET TO THE EXTENT THAT RUN-OFF OCCURS.
5. ALL VEHICLES CARRYING SOIL OR RUBBLE TO OR FROM THE SITE SHALL AT ALL TIMES BE COVERED TO PREVENT THE ESCAPE OF DUST.
6. ALL EQUIPMENT WHEELS SHALL BE WASHED BEFORE EXISTING THE SITE USING MANUAL OR AUTOMATED SPRAYERS AND DRIVE - THROUGH WASHING BAYS.
7. GATES SHALL BE CLOSED BETWEEN VEHICLE MOVEMENTS SHALL BE FITTED WITH SHADE CLOTH.
8. CLEANING OF FOOTPATHS AND ROADWAYS SHALL CARRIED OUT DAILY.
9. ALL BUILDERS REFUSE, SPOIL AND/OR MATERIAL UNSUITABLE FOR USE IN LANDSCAPE AREAS SHALL BE REMOVED FROM SITE ON COMPLETION OF THE BUILDING WORKS.

**NOTES:**

1. ALL EROSION AND SEDIMENT CONTROL MEASURES TO BE INSPECTED AND MAINTAINED DAILY BY SITE MANAGER IN ACCORDANCE WITH COUNCIL REQUIREMENTS.
2. ALL STOCKPILES TO BE CLEAR FROM DRAINS, GUTTERS AND FOOTPATHS.
3. DRAINAGE IS TO BE CONNECTED TO STORMWATER SYSTEM AS SOON AS POSSIBLE.
4. ROADS AND FOOTPATH TO BE SWEEPED DAILY AS REQUIRED BY COUNCIL.
5. IF YOU DO NOT COMPLY WITH COUNCIL REQUIREMENTS & DOCUMENTATION, YOU MAY BE LIABLE TO PROSECUTION FROM GOVERNMENT AUTHORITIES .

**LEGEND:**

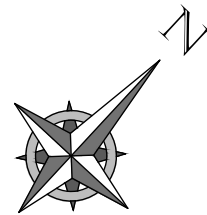
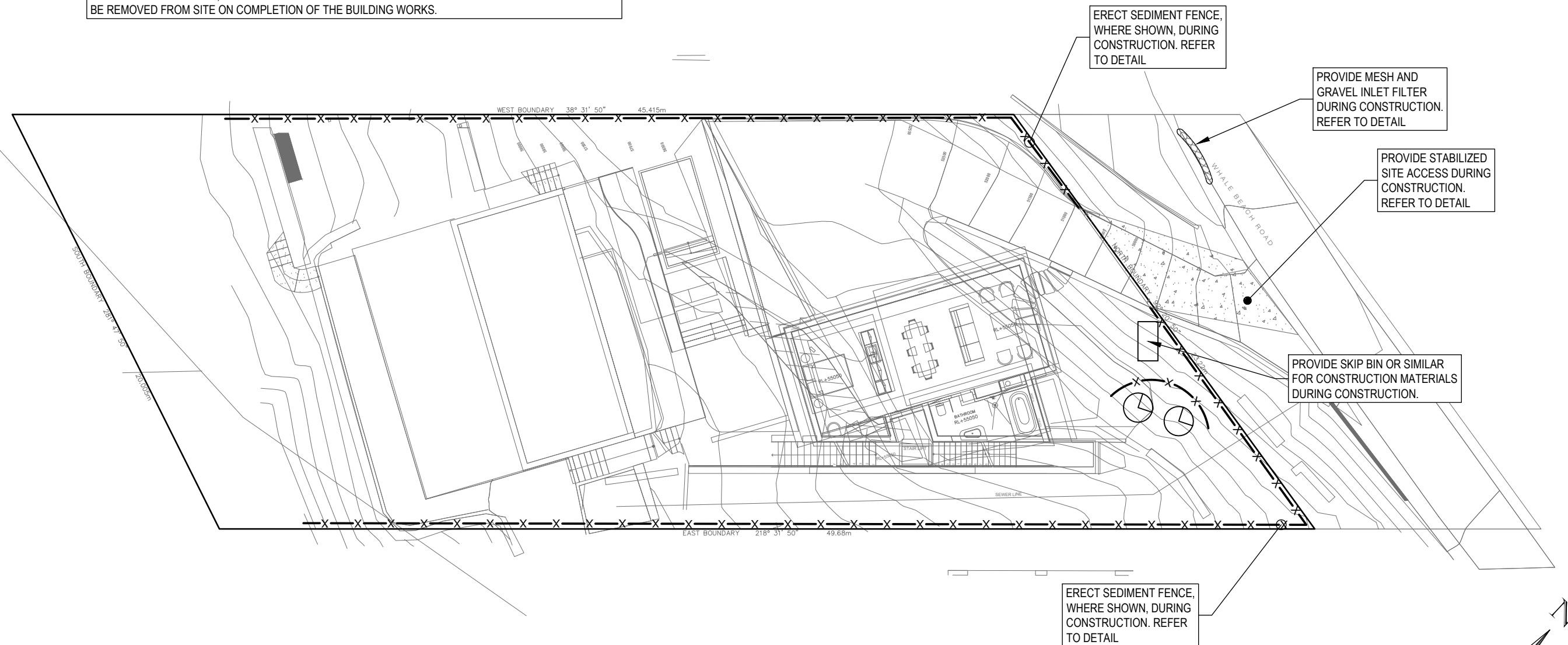
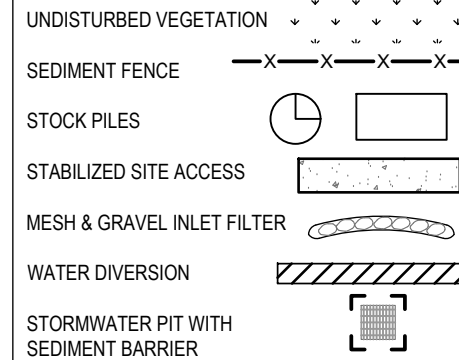

DRAWING TITLE:  
**SEDIMENT CONTROL PLAN**

COPYRIGHT - THIS DRAWING REMAINS THE PROPERTY OF RESOLUTE SW AND MAY NOT BE ALTERED IN ANY WAY WITHOUT RESOLUTE STORMWATER WRITTEN CONSENT.

DRAWN	DATE	DESCRIPTION	ISSUE	FOR
MT	23/11/24	ISSUED FOR DA	A	WOODWARD ARCHITECTS
				SITE ADDRESS: 146 WHALE BEACH ROAD WHALE BEACH
PROJECT		ALTS & ADDS		

APPROVED BY:  
**NOT FOR CONSTRUCTION**

DESIGNED BY: MT  
CHECKED BY: AR  
SCALE: 1:200  
SHEET SIZE: A3  
CLIENT REF. DRAWING No. 24-0118

ISSUE: A  
SHEET No. D5

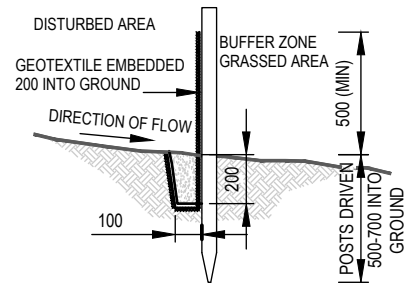
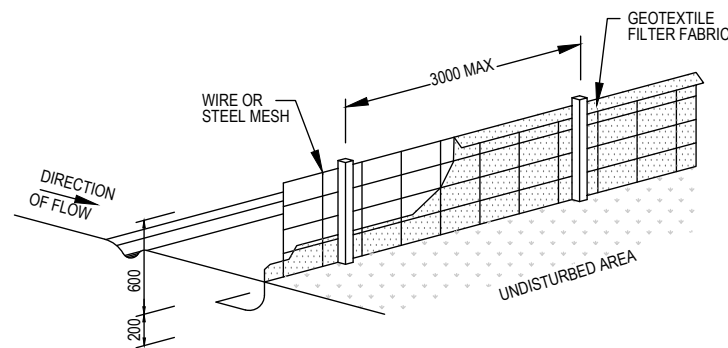

### SEDIMENT FENCE DETAIL

NTS

#### CONSTRUCTION NOTES:

1. CONSTRUCT SEDIMENT FENCES AS CLOSE AS POSSIBLE TO BEING PARALLEL TO THE CONTOURS OF THE SITE, BUT WITH SMALL RETURNS AS SHOWN IN THE DRAWING TO LIMIT THE CATCHMENTS AREA OF ANY ONE SECTION. THE CATCHMENTS AREA SHOULD BE SMALL ENOUGH TO LIMIT WATER FLOW IF CONCENTRATED AT ONE POINT TO 50 LITRES PER SECOND IN THE DESIGN STORM EVENT, USUALLY THE 10 YEAR EVENT.
2. CUT A 150mm DEEP TRENCH ALONG THE UPSLOPE LINE OF THE FENCE FOR THE BOTTOM OF THE FABRIC TO BE ENTRENCHED.
3. DRIVE 1.5m LONG STAR PICKETS INTO GROUND AT 2.5m INTERVALS (MAX) AT THE DOWNSLOPE EDGE OF THE TRENCH. ENSURE ANY STAR PICKETS ARE FITTED WITH SAFETY CAPS.
4. FIX SELF-SUPPORTING GEOTEXTILE TO THE UPSLOPE SIDE OF THE POSTS ENSURING IT GOES TO THE BASE OF THE TRENCH. FIX THE GEOTEXTILE WITH WIRE TIES OR AS RECOMMENDED BY THE MANUFACTURER. ONLY USE GEOTEXTILE SPECIFICALLY PRODUCED FOR SEDIMENT FENCING. THE USE OF SHADE CLOTH FOR THIS PURPOSE IS NOT SATISFACTORY.
5. JOIN SECTIONS OF FABRIC AT A SUPPORT POST WITH 150mm OVERLAP.
6. BACKFILL THE TRENCH OVER THE BASE OF THE FABRIC AND COMPACT IT THOROUGHLY OVER THE GEOTEXTILE.

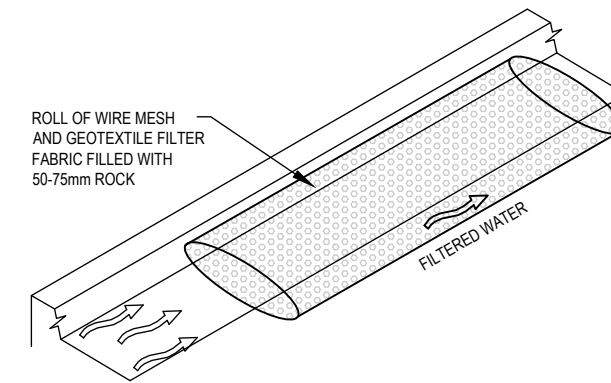

### MESH AND GRAVEL FILTER

NTS

#### CONSTRUCTION NOTES:

1. INSTALL FILTERS TO KERB INLETS ONLY AT SAG POINTS
2. FABRICATE A SLEEVE MADE FROM GEOTEXTILE OR WIRE MESH LONGER THAN THE LENGTH OF THE INLET PIT AND FILL IT WITH 25mm TO 50mm GRAVEL.
3. FORM AN ELLIPTICAL CROSS-SECTION ABOUT 150mm(h) x 400mm(w).
4. PLACE THE FILTER AT THE OPENING LEAVING AT LEAST 100mm SPACE BETWEEN IT AND THE KERB INLET. MAINTAIN THE OPENING WITH SPACER BLOCKS.
5. FORM A SEAL WITH THE KERB TO PREVENT SEDIMENT BYPASSING THE FILTER.
6. SANDBAGS FILLED WITH GRAVEL CAN SUBSTITUTE FOR THE MESH OR GEOTEXTILE PROVIDING THEY ARE PLACED SO THAT THEY FIRMLY ABUT EACH OTHER AND SEDIMENT-LADEN WATERS CANNOT PASS BETWEEN.

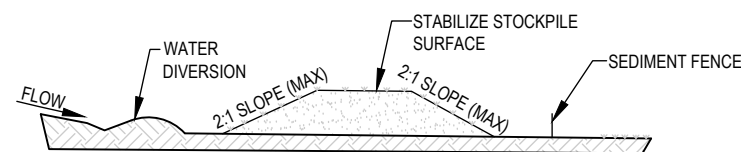

### STOCKPILE

NTS

#### NOTE:

1. PLACE STOCKPILES MORE THAN 2 (PREFERABLY 5) METRES FROM EXISTING VEGETATION, CONCENTRATED WATER FLOW, ROADS AND HAZARD AREAS.
2. CONSTRUCT ON THE CONTOUR AS LOW, FLAT, ELONGATED MOUNDS.
3. WHERE THERE IS SUFFICIENT AREA, TOPSOIL STOCKPILES SHALL BE LESS THAN 2 METRES IN HEIGHT.
4. WHERE THEY ARE TO BE IN PLACE FOR MORE THAN 10 DAYS, STABILIZE FOLLOWING THE APPROVED ESCP OR SWMP TO REDUCE THE C-FACTOR TO LESS THAN 0.10.
5. CONSTRUCT EARTH BANKS (LOW FLOW) ON THE UPSLOPE SIDE TO DIVERT WATER AROUND STOCKPILES AND SEDIMENT FENCES 1 TO 2 METRES ON THE DOWNSLOPE.

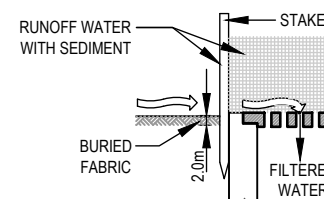

### SEDIMENT BARRIER AROUND PIT

NTS

#### CONSTRUCTION NOTES:

1. FABRICATE A SEDIMENT BARRIER MADE FROM GEOTEXTILE OR STRAW BALES.
2. FOLLOW STRAW FILTER AND SEDIMENT FENCE FOR INSTALLATION PROCEDURES FOR THE STRAW BALES OR GEOFABRIC. REDUCE THE PICKET SPACING TO 1 METRE CENTRES.
3. IN WATERWAYS, ARTIFICIAL SAG POINTS CAN BE CREATED WITH SANDBAGS OR EARTH BANKS AS SHOWN IN THE DRAWING.
4. DO NOT COVER THE INLET WITH GEOTEXTILE UNLESS THE DESIGN IS ADEQUATE TO ALLOW FOR ALL WATERS TO BYPASS IT.

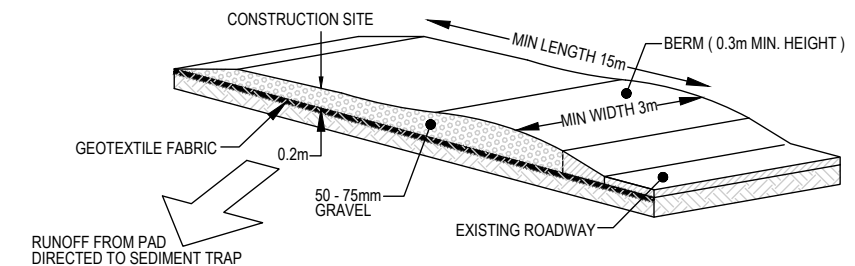

### STABILIZED SITE ACCESS

NTS

#### CONSTRUCTION NOTES:

1. STRIP THE TOPSOIL, LEVEL THE SITE AND COMPACT THE SUBGRADE
2. COVER THE AREA WITH NEEDLE-PUNCHED GEOTEXTILE
3. CONSTRUCT A 200mm THICK PAD OVER THE GEOTEXTILE USING ROAD BASED OR 30mm AGGREGATE
4. ENSURE THE STRUCTURE IS AT LEAST 15m LONG OR TO BUILD ALIGNMENT AND AT LEAST 3 METRES WIDE.
5. WHERE A SEDIMENT FENCE JOINS ONTO THE STABILIZED ACCESS, CONSTRUCT A HUMP IN THE STABILIZED ACCESS TO DIVERT WATER TO THE SEDIMENT FENCE.



DRAWING TITLE:  
**SEDIMENT CONTROL DETAILS**

COPYRIGHT - THIS DRAWING REMAINS THE PROPERTY OF RESOLUTE SW AND MAY NOT BE ALTERED IN ANY WAY WITHOUT RESOLUTE STORMWATER WRITTEN CONSENT.

DRAWN	DATE	DESCRIPTION	ISSUE	FOR
MT	23/11/24	ISSUED FOR DA	A	WOODWARD ARCHITECTS
				SITE ADDRESS: 146 WHALE BEACH ROAD WHALE BEACH
PROJECT		ALTS & ADDS		

APPROVED BY:  
**NOT FOR CONSTRUCTION**

DESIGNED BY: MT  
CHECKED BY: AR  
SCALE: AS NOTED  
SHEET SIZE: A3  
CLIENT REF.:  
DRAWING No.: 24-0118

ISSUE: A  
SHEET No.: D6