

OXFORD FALLS ROAD

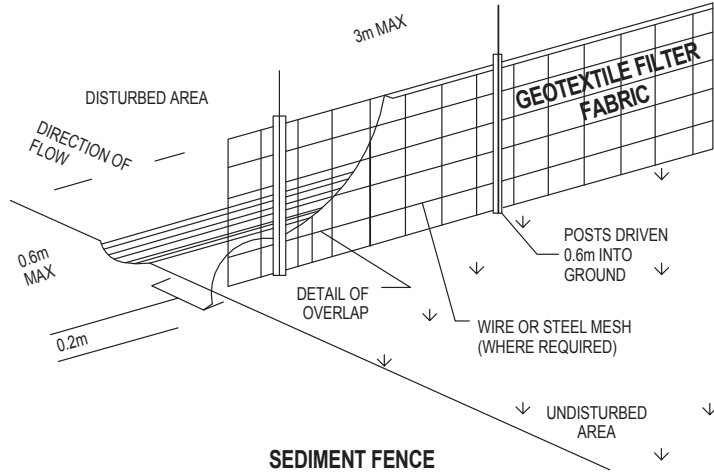
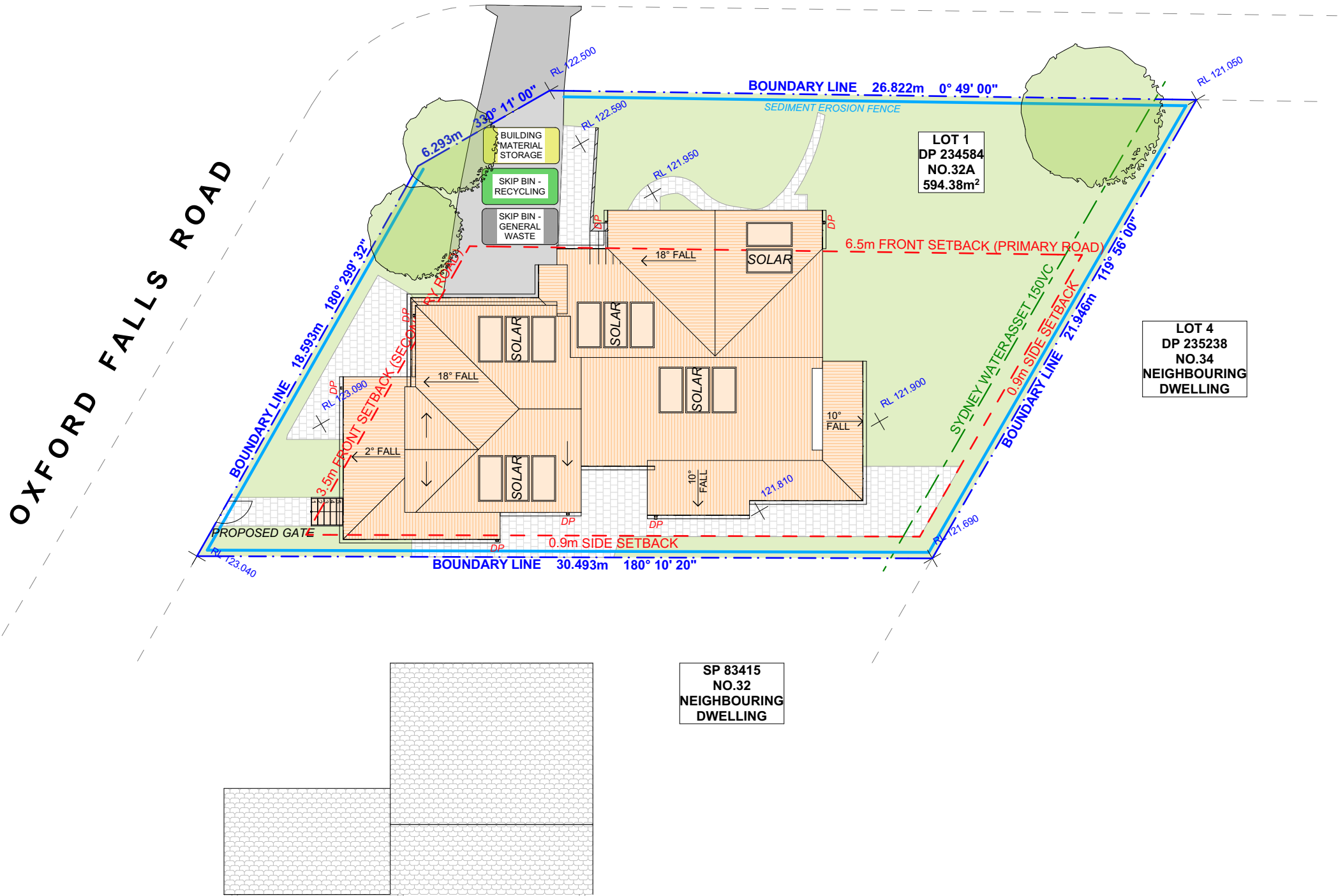

DUST CONTROL :
TO REDUCE DUST GENERATED BY WIND ACTION, THE REMOVAL OF THE TOP SOIL IS TO BE MINIMISED. TO PREVENT DUST GENERATION, WATERING DOWN OF THE SITE, ESPECIALLY DURING THE MOVEMENT OF MACHINERY IS REQUIRED. WHERE EXCAVATING INTO ROCK, KEEP THE SURFACE MOIST TO MINIMISE DUST. CONSTRUCT A GRAVEL ENTRY/EXIT POINT USING BLUE METAL AND RESTRICT ALL VEHICLE MOVEMENTS WITHIN THE SITE TO A MINIMUM. ENSURE WIND BREAKS, SUCH AS EXISTING FENCES ARE MAINTAINED DURING THE CONSTRUCTION PHASE UNTIL NEW LANDSCAPING IS PROVIDED OR REINSTATED. PREVENT DUST BY COVERING STOCKPILES

SEDIMENT NOTE :
1. ALL EROSION AND SEDIMENT CONTROL MEASURES TO BE INSPECTED AND MAINTAINED DAILY BY THE SITE MANAGER.
2. MINIMISE DISTURBED AREAS, REMOVE EXCESS SOIL FROM EXCAVATED AREA AS SOON AS POSSIBLE.
3. ALL MATERIAL STOCKPILE TO BE CLEAR FROM DRAINS, GUTTERS AND FOOTPATHS, OR WITHIN SEDIMENT FENCE AREA.
4. DRAINAGE TO BE CONNECTED TO STORMWATER AS SOON AS POSSIBLE. IF STORED ON SITE, IT MUST BE FILTERED BEFORE RELEASING INTO STORMWATER SYSTEM OR WATERWAYS.
5. ROADS AND FOOTPATHS TO BE SWEEPED DAILY.

STOCKPILES :
ALL STOCKPILES ARE TO BE KEPT ON-SITE WHERE POSSIBLE. ANY MATERIALS PLACED ON THE FOOTPATHS OR NATURE STRIPS REQUIRE COUNCIL'S PERMISSION.
ALL STOCKPILES ARE TO BE PLACED AWAY FROM THE DRAINAGE LINES AND STREET GUTTERS. IT IS BEST TO LOCATE THESE ON THE HIGHEST PART OF THE SITE IF POSSIBLE. PLACE WATERPROOF COVERING OVER STOCKPILES.
IF REQUIRED PROVIDE DIVERSION DRAIN & BANK AROUND STOCKPILES.

GUTTER PROTECTION :
PROVIDE PROTECTION TO DOWNHILL GRATE IN GUTTER BY MEANS OF SAND BAGS OR BLUE METAL WRAPPED IN GEOTEXTILE FABRIC. WHEN SOIL OR SAND BUILDS UP AROUND THIS SEDIMENT BARRIER, THE MATERIAL SHOULD BE RELOCATED BACK TO THE SITE FOR DISPOSAL.

NOTE: ALL PROPOSED STORMWATER TO CONNECT WITH EXISTING

1 SITE / ROOF / SEDIMENT EROSION / WASTE MANAGEMENT PLAN 1:200