



ZONE A PROPOSED PLANT SCHEDULE					
KEY	BOTANICAL NAME	COMMON NAME	QTY	MATURE HEIGHT	POT SIZE
BR' WF' XA'	<b>SHRUBS</b>				
	BANKSIA SPINULOSA	HAIRPIN BANKSIA	2	2m	200mm
	WESTRINGIA FRUTICOSA	COASTAL ROSEMARY	7	1.5m	200mm
	XANTHORRHOEA ARBOREA	GRASS TREE	3	3m	45Ltr
CC" DC' FN' SH"	<b>GRASSES / GROUND COVERS</b>				
	CASUARINA GLAUCA 'COUSIN IT'	COUSIN IT	15	0.5m	140mm
	DIANELLA CAERULEA	BLUE FLAX LILY	8	0.6m	140mm
	FICINIA NODOSA	KNOBBY CLUBRUSH	20	0.6m	140mm
	SCAEVOLA HUMILIS 'PURPLE FUSION'	PURPLE FUSION	12	0.2m	140mm

- ' Denotes species selected from Sandstone Crests plant community as found within 'Native plants for your garden' publication.
- " Denotes native species.



Refer to L-01  
for details.

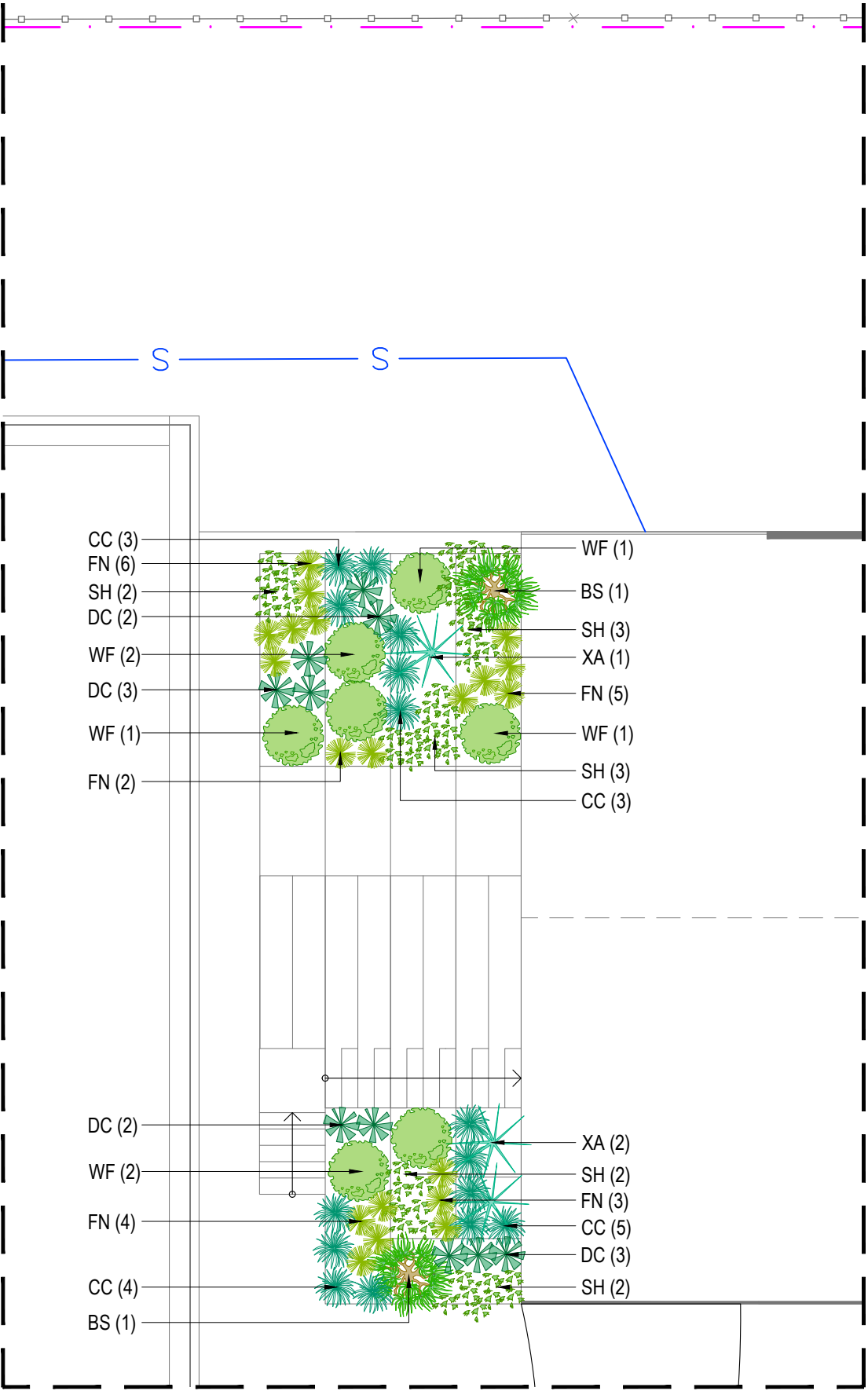

Note:  
- Contractors to check and verify all dimensions and all levels on site prior to any works.  
- Any discrepancies should be immediately referred to Serenescapes Landscape Designs.  
- All work to comply with B.C.A. Statutory Authorities and relevant Australian Standards.  
- Dimensions recognised over scaling. All measurements are in millimetres.  
- Copyright Serenescapes Landscape Designs 2019.



Serenescapes Landscape Designs  
ABN 71 611 726 222

Suite 54, 14 Narabang Way  
Belrose NSW 2085  
Tel: 02 9986 2157  
info@serenescapes.com.au  
www.serenescapes.com.au

Client:	Carey Lee	Drawing Title:	Detail Planting Plan	Rev:	Date:	Issue:	Checked:
Site Address:	13 Minkara Road Bayview	Drawn by:	Project Number:	Scale:	Sheet Number:		
		Eduardo Casellato TLA Member	19613	1:100 @ A3	L-02 of 3		



## SITE PREPARATION

### PROTECTION OF EXISTING TREES:

The fence shall be constructed of star pickets at 2.4m spacings and connected by three strands of 2mm wire at 300mm spacings to a minimum height of 1500mm.

Tree protection measures shall remain intact until the completion of all construction works.

### Prohibited Works within the CRZ:

- entry of machinery or storage of building materials
- parking of any kind of vehicle
- erection or placement of site facilities
- removal or stockpiling of soil or site debris
- disposal of liquid waste including paint & concrete wash
- excavation or trenching of any kind (including irrigation or electrical connections).
- attaching any signs or any other objects to the tree
- placement of waste disposal or skip bins
- pruning and removal of branches, other than those by a qualified Arborist

Compacted Ground/Coring: Avoid compaction of the ground under trees. If compaction nevertheless occurs loosen the soil by Coring. Coring to be carried out by a qualified Arborist.

## REMOVAL OF EXISTING TREES

All trees to be removed shall be carried out by a qualified arborist and work shall conform to the provisions of AS4373-2007 Australian Standards for The Pruning of Amenity Trees.

## ELIMINATE WEEDS

Remove all existing weeds by hand, wiping or spraying with a glyphosate based herbicide. Weed control shall never be performed by mechanical cultivation or by scraping. Herbicide spraying is to be used to eliminate all existing weeds 30 days prior to planting.

## EXCAVATION & SUB SOIL PREPARATION

Excavate garden beds to the depth required and rip or scarify base & sides of pit to a minimum depth of 150mm.

## SUB SOIL DRAINAGE

Install drainage layer where there is surface water runoff draining into garden bed areas & where the existing sub-soil has more than 50% clay composition & there is a risk of subsurface water ponding. Install perforated corrugated ag. line 75-100mm Dia. with geotextile filter sock & backfill to a minimum 200mm using free draining material, reclaimed/recycled where available. Direct flows at a minimum 0.5% fall to sw system. In areas isolated from stormwater system excavate & backfill an appropriate water dispersion pit.

## REUSE EXISTING TOPSOIL

Existing site topsoil should be salvaged & appropriately stockpiled where possible.

## IMPORTED TOPSOIL

Quality System: AS 4419 or as specified below.

Turf Areas: 'Turf Underlay' as supplied by, ANL p: 02 9450 1444 or approved alternative.

Tree Pit and Shrub Planting: 'Premium Garden Mix' as supplied by, ANL p: 02 9450 1444 or approved alternative.

## PLANTING

Health & Vigour: Supply plants with foliage size, texture & colour consistent with that shown in healthy specimens of the species.

Balance of Crown: Supply plants with max. variation in crown bulk on opposite sides of stem axis, +/- 20%.

Stock selection should be based on NATSPEC Guide *Specifying Trees: a Guide to Assessment of Tree Quality*.

## STAKING

Install 2 x 1800mm 40x40 hardwood timber stakes with hessian ties to all trees. Provide appropriate support considering exposure to prevailing winds. Stakes and hessian ties to be removed as soon as the tree is self supporting.

## IRRIGATION SYSTEM

New dripline irrigation system to be installed with backflow preventer and with timers. Irrigation system to be designed and installed to local codes.

The entire irrigation system shall be fully automated and provide drip irrigation to all tree, shrub and ground cover zones. It is the Contractor's responsibility to verify water pressure available and determine all design-built parameters prior to any installation and sizing of irrigation components. Irrigation system to be connected to water tank to supplement water from mains.

## MULCHING

Quality system: AS 4454

All planting area impacted by building works to receive 50-75mm of garden Mulch, Hort-Bark, ANL p: 02 9450 1444 or approved alternative. Keep mulch 100mm away from plant stem & form a well to stop excessive water runoff. Finish flush with adjacent surfaces.

## TURFING

New turf- Sir Walter Soft Leafed Buffalo.

Excavate / grade all areas to be turfed to 120mm below finished levels. Ensure that all surface runoff is directed away from buildings. Ensure that no pooling or ponding will occur. Further rip the sub-grade to 150mm. Install 100mm of imported turf underlay. Rolls to be closely butted and laid in a brickwork pattern. Fill any small gaps with topsoil and water thoroughly.

## WATERING

Water in immediately after plant installation & allow for soil settlement. For the first 2 to 4 weeks after planting, the root zone & immediate surrounds must be kept moist. Continue watering until plants have established.

## RETAINING WALLS & PLANTER BOXES

All retaining walls & planter boxes to be constructed to Engineer's details. Ensure all internal surfaces are waterproofed. Geotextile wrapped ag. drainage line backfilled with aggregate is to be installed behind all retaining walls & connected to stormwater in accordance with Sydney Water regulations. All planter boxes are to have Atlantis drainage cell (or approved alternative) installed & connected to stormwater in accordance with Sydney Water regulations.

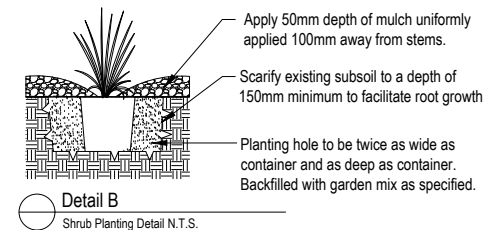
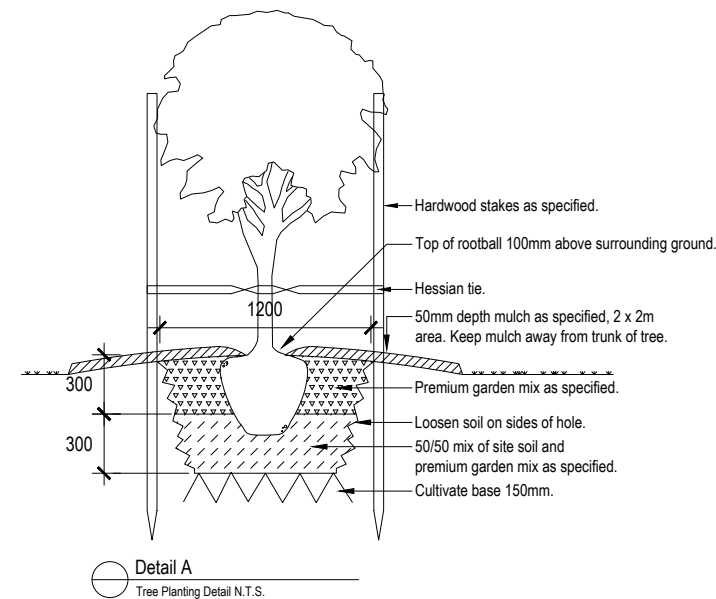

**Note:**

- Contractors to check and verify all dimensions and all levels on site prior to any works.
- Any discrepancies should be immediately referred to Serenescapes Landscape Designs.
- All work to comply with B.C.A. Statutory Authorities and relevant Australian Standards.
- Dimensions recognised over scaling. All measurements are in millimetres.
- Copyright Serenescapes Landscape Designs 2019.



Serenscapes Landscape Designs  
ABN 71 611 726 222

Suite 54, 14 Narabang Way  
Belrose NSW 2085  
Tel: 02 9986 2157  
info@serenescares.com.au  
www.serenescapes.com.au

Client:	Carey Lee	Drawing Title: Landscape Specification & Details				Rev:	Date:	Issue:	Checked:
						A	16/12/19	DA Issue	BF
Site Address:	13 Minkara Road Bayview	Drawn by: Eduardo Casellato TLA Member	Project Number: 19613	Scale: 1:100 @ A3	Sheet Number: L-03 of 3				

