

DRAFT PLAN ONLY
 PLANS & AREAS ARE
 SUBJECT TO FINAL DESIGN & SURVEY
 PLAN NOT TO BE REGISTERED
 WITH L.R.S.

 northern beaches council
THIS PLAN IS TO BE READ IN CONJUNCTION WITH THE CONDITIONS OF DEVELOPMENT CONSENT
 MOD2020/0164

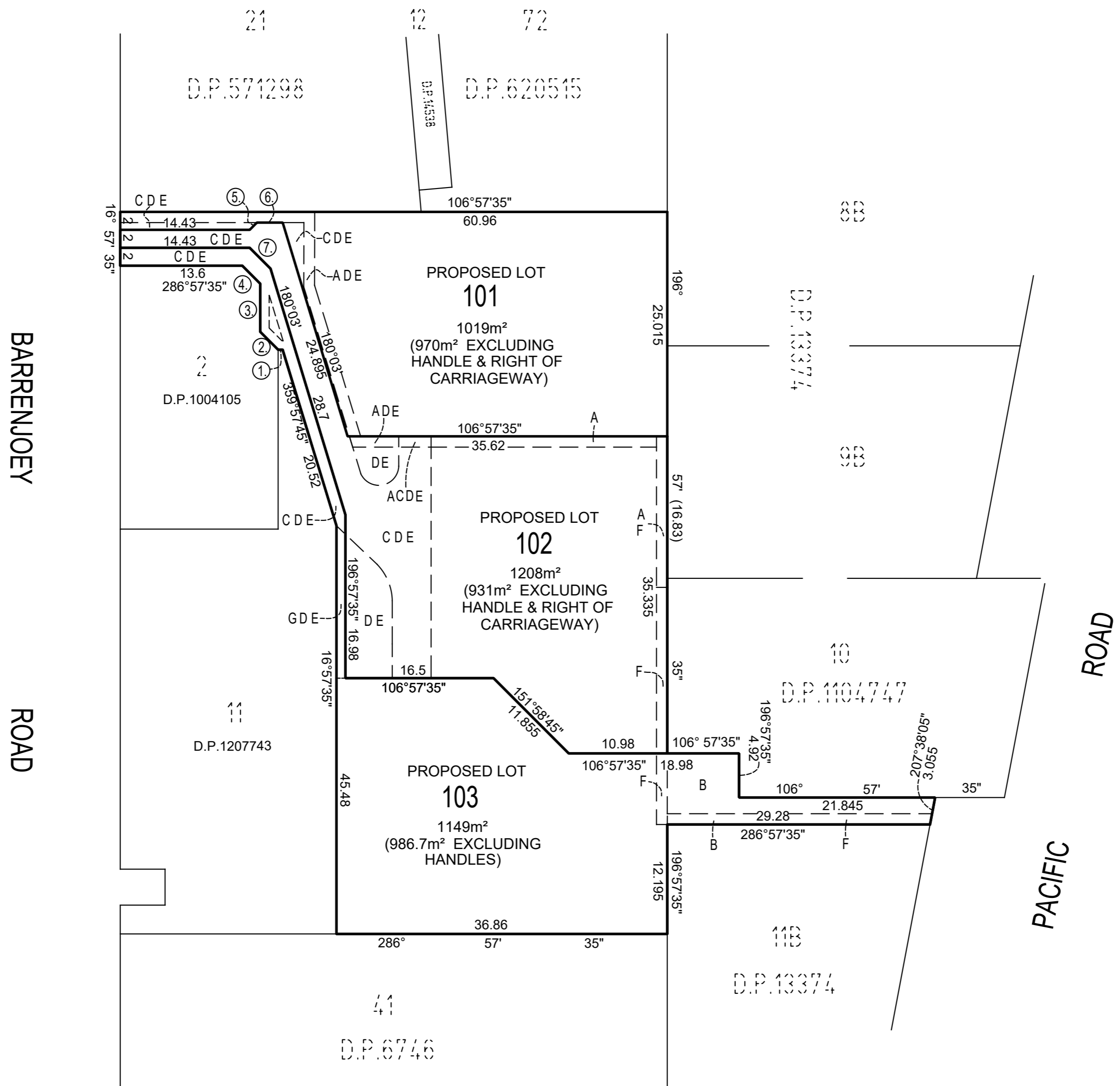

No.	BEARING	DISTANCE
1	286°57'35"	0.50
2	331°57'35"	2.83
3	16°57'35"	5.36
4	331°57'35"	2.83
5	61°57'35"	1.13
6	106°57'35"	2.875
7	151°57'35"	3.29

NOTES
 A ... EASEMENT TO DRAIN WATER 1.2 WIDE (D.P. 1201336).
 B ... COVENANT C114410
 C ... RIGHT OF CARRIAGEWAY 6 & VARIABLE WIDTH
 D ... EASEMENT FOR SERVICES 6 & VARIABLE WIDTH
 E ... EASEMENT TO DRAIN WATER 6 & VARIABLE WIDTH
 F ... RIGHT OF FOOTWAY 1.2 WIDE
 G ... RIGHT OF ACCESS 1 WIDE

Surveyor : Adam Clerke Date : 16/06/2020 Surveyor's Ref : 20688DP_D_5	PLAN OF PROPOSED SUBDIVISION OF LOTS 10 IN D.P.1207743	LGA: NORTHERN BEACHES Locality : PALM BEACH Lengths are in metres. Reduction Ratio 1:600
---	---	--