

DRAFT PLAN ONLY
21/09/2015
SUBJECT TO FINAL DESIGN & SURVEY
PROPOSED SUBDIVISION

NOTE: (A) ... PROPOSED RIGHT OF CARRIAGEWAY OR
PROPOSED EASEMENT FOR SERVICES OR
PROPOSED EASEMENT FOR DRAINAGE
4 WIDE & VARIABLE WIDTH
(B) ... PROPOSED BUILDING ENVELOPE
D ... PROPOSED DRIVEWAY IS DESIGNED IN ACCORDANCE
WITH SECTION 4.1.3(2) (PROPERTY ACCESS) OF
THE PLANNING FOR BUSH FIRE PROTECTION.

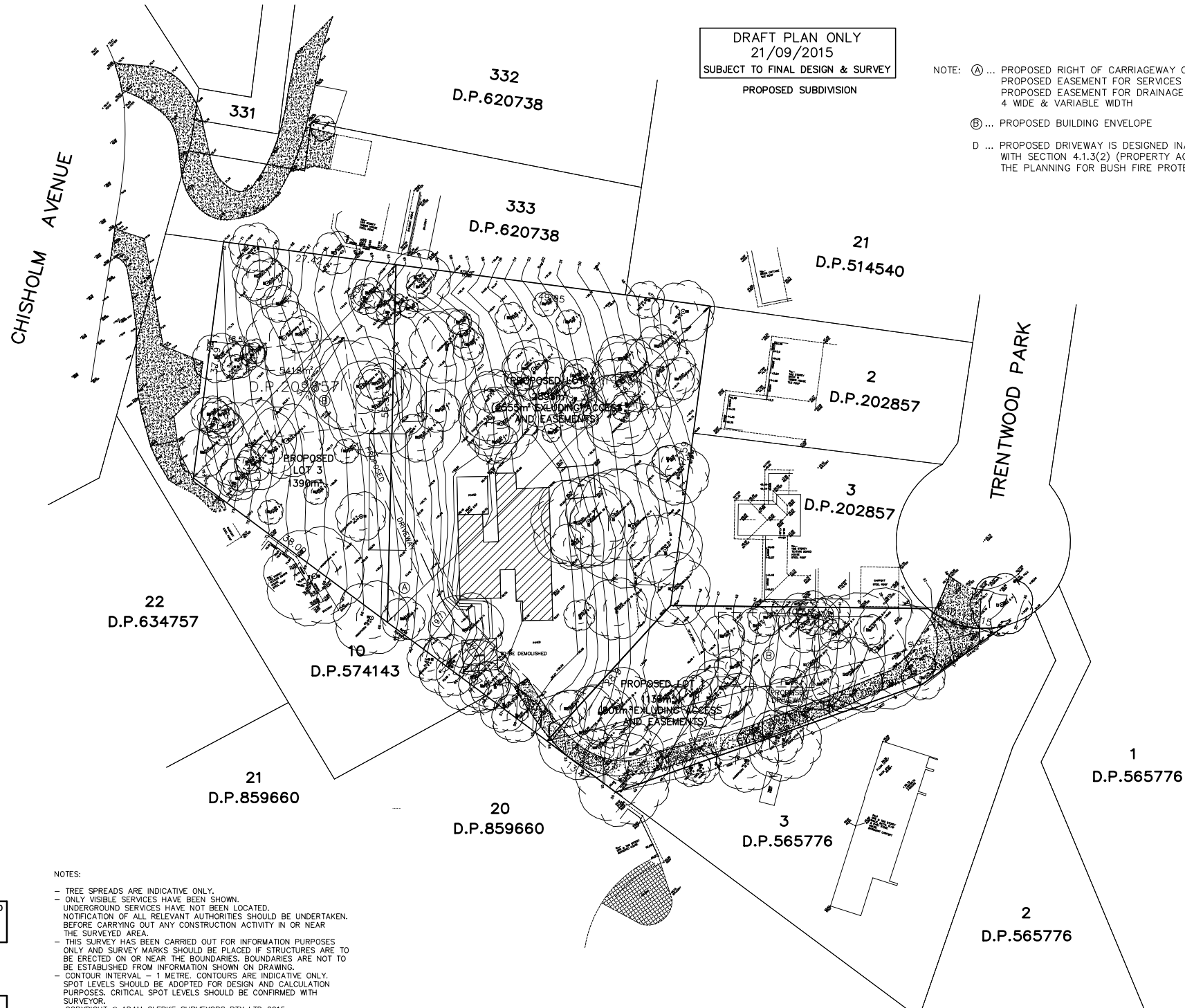

NOTES:

- TREE SPREADS ARE INDICATIVE ONLY.
- ONLY VISIBLE SERVICES HAVE BEEN SHOWN.
- UNDERGROUND SERVICES HAVE NOT BEEN LOCATED.
- NOTIFICATION OF ALL RELEVANT AUTHORITIES SHOULD BE UNDERTAKEN.
- BEFORE CARRYING OUT ANY CONSTRUCTION ACTIVITY IN OR NEAR THE SURVEYED AREA.
- THIS SURVEY HAS BEEN CARRIED OUT FOR INFORMATION PURPOSES ONLY AND SURVEY MARKS SHOULD BE PLACED IF STRUCTURES ARE TO BE ERRECTED ON OR NEAR THE BOUNDARIES. BOUNDARIES ARE NOT TO BE ESTABLISHED FROM INFORMATION SHOWN ON DRAWING.
- CONTOUR INTERVAL - 1 METRE. CONTOURS ARE INDICATIVE ONLY.
- SPOT LEVELS SHOULD BE ADOPTED FOR DESIGN AND CALCULATION PURPOSES. CRITICAL SPOT LEVELS SHOULD BE CONFIRMED WITH SURVEYOR.

COPYRIGHT © ADAM CLERKE SURVEYORS PTY LTD 2015

ADAM CLERKE SURVEYORS PTY LTD
LAND & ENGINEERING SURVEYORS
38 KEVIN AVENUE, AVALON 2107
TEL...9918 4111

DETAILS AND LEVELS OVER
LOT 1 IN D.P.202857

7 TRENTWOOD PARK, AVALON

DATE... 18/05/15 REF... 11713A_5
SCALE...1:200(AO) DATUM...A.H.D.