



BALGOWLAH BRANCH

WESTPAC BANK
 SHOP 012
 STOCKLAND BALGOWLAH
 197-215 CONDRAMINE STREET
 BALGOWLAH, NSW

ARCHITECTURAL DOCUMENTATION

DRAWING LIST

- A00 TITLE SHEET
- A01 SITE PLAN
- A02 FLOOR PLAN
- A03 REFLECTED CEILING PLAN
- A04 FURNITURE PLAN
- A05 FINISHES PLAN
- A06 SECURITY PLAN
- A07 SECTIONS AA, BB, CC
- A08 SECTION DD AND SHOPFRONT ELEVATION

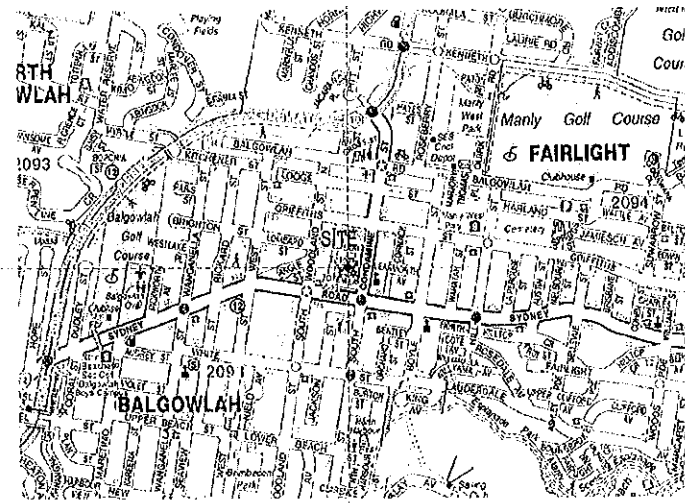

LOCATION PLAN

N.T.S

DOCUMENTATION PACKAGES

- PT PARTITION WALL TYPES
- PD PARTITION DETAILS
- FD FLOOR DETAILS
- CD CEILING DETAILS
- DD DOOR DETAILS
- IR INTERVIEW ROOM DETAILS
- TD WC DETAILS
- AT ATM DETAILS
- FJ FOH JOINERY DETAILS
- BJ BOH JOINERY DETAILS
- BD BED JOINERY DETAILS
- VS SAFE DETAILS
- TL TELLER DETAILS
- SO SIGNAGE DETAILS

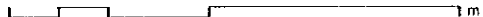
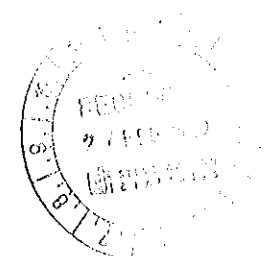

© 2006 ANZBANKS PTY LTD
 www.westpac.com.au
 Note:
 The information contained in this document is copyright and may not be used or reproduced for any other project or purpose without the prior written consent of Westpac.
 The information contained in this document is for the use of the recipient only. It is not to be used for any other purpose.
 The information contained in this document is for the use of the recipient only. It is not to be used for any other purpose.
 The information contained in this document is for the use of the recipient only. It is not to be used for any other purpose.



REVISIONS		DATE	BY
1	ISSUE		
2	REVISED		

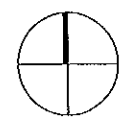

suters

Project	WESTPAC BALGOWLAH CONDAMINE STREET BALGOWLAH, NSW
Client	WESTPAC

TITLE SHEET & DRAWING LIST		
Scale	A00	Sheet
File No	13066	61
Project No	13066	61
Drawing No	A00	A

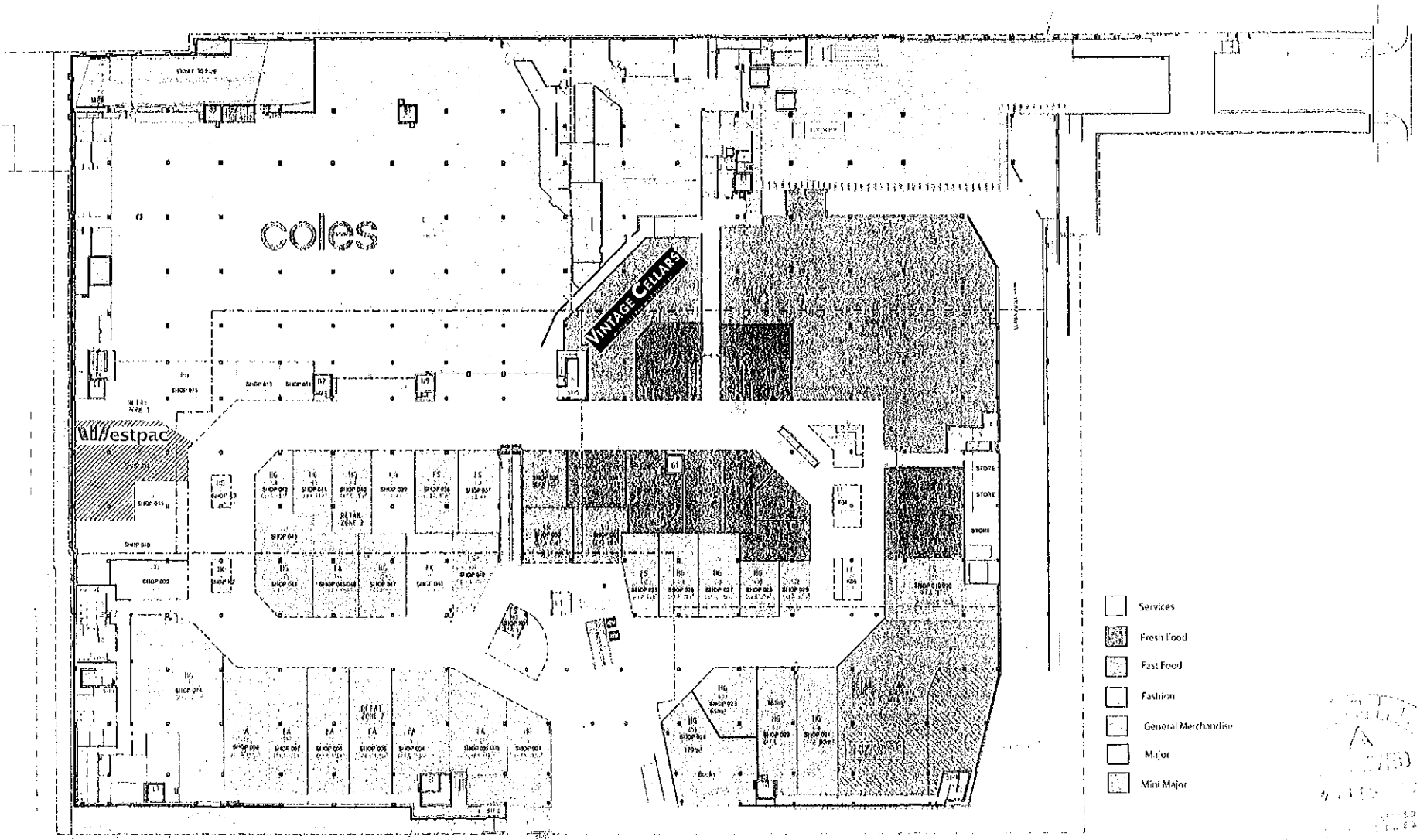

- Services
- Fresh Food
- Fast Food
- Fashion
- General Merchandise
- Major
- Mini Major



1:100000 1:100000

WESTPAC ARCHITECTS PTY LTD
 100 Macquarie Street
 Sydney NSW 2000
 Phone: (02) 9233 3333
 Fax: (02) 9233 3334
 Email: westpac@westpac.com.au



REVISIONS		DATE	BY	CHKD
1	ISSUE FOR PERMIT			
2	ISSUE FOR CONSTRUCTION			

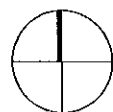

suters

Project		SITE PLAN	
WESTPAC BALGOWLAH CONDAMINE STREET BALGOWLAH, NSW		Scale	1:1000
Client		Project No.	13066
WESTPAC		Sheet No.	A01
Project Name		Drawn By	...
13066		Checked By	...
A01		Scale	A

CHECK EXACT LOCATION OF ALL SERVICES ON SITE. RELOCATION TO BE CONFIRMED BY THE SERVICE ENGINEERS

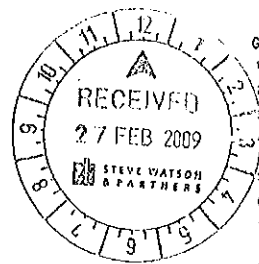

- GENERAL NOTES:**
- REFER TO WESTPAC DESIGN STANDARDS AND DRAWINGS P701-P112 FOR DETAILS OF PARTITION TYPES.
 - ENSURE ALL DIMENSIONS ARE TAKEN FROM FINISHED FACE UNLESS NOTED OTHERWISE.
 - ENSURE ALL NOMINATED DOORS TO HAVE ADEQUATE CIRCULATION SPACE TO COMPLY WITH DISABLED CODE AS1428.1.
 - POSTIONING OF ATM TO BE CHECKED ON SITE. PROVIDE SUFFICIENT SPACE FOR SERVICE INDICATED BY DOTTED LINES. REFER TO GENERAL CONSTRUCTION DRAWING A01-1 FOR MORE DETAILS OF ATM.
 - ALL EXISTING PERIMETER WALLS TO HAVE PLASTERBOARD OR FIBROUS CEMENT LINING TO ENSURE A SMOOTH & EVEN FINISH THROUGHOUT.
 - NO SURFACE MOUNTED CONDUITS FOR SERVICES. BUILDER TO ALLOW FOR BOXING OUT ALL ELECTRICAL, FIRE, HYDRAULIC & SECURITY SERVICES.
 - ALLOW ADEQUATE TIMBER STIFFENERS OR SUPPORTS IN PARTITION WALL FOR OVERHEAD SHELVES OR SLAT WALLS, SHOWN AS WALL TYPE 'U'. REFER TO MERCHANDISING PLAN FOR EXACT LOCATION OF SHELVES / SLAT WALLS.
 - DIGITAL CCTV TO BE INSTALLED TO THE BRANCH BY WESTPAC NOMINATED SECURITY CONTRACTORS.
 - ENSURE ALL INTER-TENANCY WALL TO BE ANTI-DAMPIT RATED WITH STEEL SHEETING AND F72 MESH FROM GFL TO UNDERSIDE OF STRUCTURE ABOVE.
 - ENSURE ALL F72 MESH TO BE SECURELY TIED ABOVE / INSIDE WALLS TO PREVENT INTERNAL MOVEMENT.
 - STRUCTURAL ENGINEER TO CONFIRM SLAB STRUCTURAL INTEGRITY TO ACCOMMODATE FLY-UP SCREENS IMPACT LOADS & SAFES LOADING.
 - PROVIDE TOPPING & SELF-LEVELLING COMPOUND TO CONCRETE SLAB AS REQUIRED.
 - MAIN CONTRACTOR TO PROVIDE STRUCTURAL ENGINEER CERTIFICATION FOR ALL STRUCTURAL SUSPENDED CEILING & BULKHEADS AND ALL OTHER STRUCTURAL INSTALLATION AS REQUIRED.

WALL LEGEND:
NOTE: ALL PARTITION TYPE DESCRIPTIONS BELOW ARE INDICATIVE ONLY. REFER TO WESTPAC DESIGN STANDARD (ISSUE 3 AUGUST 2007) FOR FULL PARTITION DRAWINGS & CONSTRUCTION DETAILS.

- 1 FLOOR TO CEILING SOLID PLASTERBOARD PARTITION WITH 100mm POWDERCOATED SKIRTING - PREVIOUS NICKEL PEARL
- 2 FLOOR TO CEILING SOLID PLASTERBOARD PARTITION WITH ACOUSTIC INSULATION IN CAVITY WITH 100mm POWDERCOATED SKIRTING - PREVIOUS NICKEL PEARL
- 3 GLASS PARTITION WITH ALUMINIUM FRAMES, WITH TYPE 1 PARTITION OVER
- 4 TYPE 1 WITH BR SECURITY REINFORCEMENT WITH 2x 6MM BALLISTIC ALLY RATED STEEL SHEETS TO ACHIEVE BALLISTIC RATING OF R151 TO HEIGHT OF 2100MM AFL + SECURITY MESH FROM 2100 AFL TO UNDERSIDE OF SLAB OR STRUCTURE ABOVE. ALLOW BRACING/ADDITIONAL SUPPORT WHERE REQUIRED TO ENSURE NO INTERNAL MOVEMENT.
- 5 TYPE 1 PARTITION REINFORCED WITH F72 MESH TO U/S STRUCTURE ABOVE.
- 6 FLOOR TO CEILING INSULATED STEEL STUD & PLASTERBOARD WALL. WATERPROOF FC SHEET TO TOILET SIDE WITH TILE SKIRTING. PLASTERBOARD SHEETING TO NON-TOILET SIDE.
- 04A SET PLASTERBOARD LINING OVER 35mm BATTERIES FIXED TO EXISTING WALL / COLUMN.
- 04B SET PLASTERBOARD LINING OVER EXISTING WALL / COLUMN. F72 MESH FROM GFL TO U/SIDE OF SLAB ABOVE IS REQUIRED.
- 04C FC LINING OVER EXISTING WALL / COLUMN.
- 11C 32mm MDF BOARD BEHIND ATM WALL TO WESTPAC SECURITY DESIGN STANDARDS
- 12 GLAZED SHOPFRONT WALL
- M ALLOW ADEQUATE TIMBER STIFFENERS OR SUPPORTS IN PARTITION WALL FOR OVERHEAD SHELVES OR SLAT WALL. REFER TO MERCHANDISING PLAN FOR EXACT LOCATION OF SHELVES/SLAT WALLS

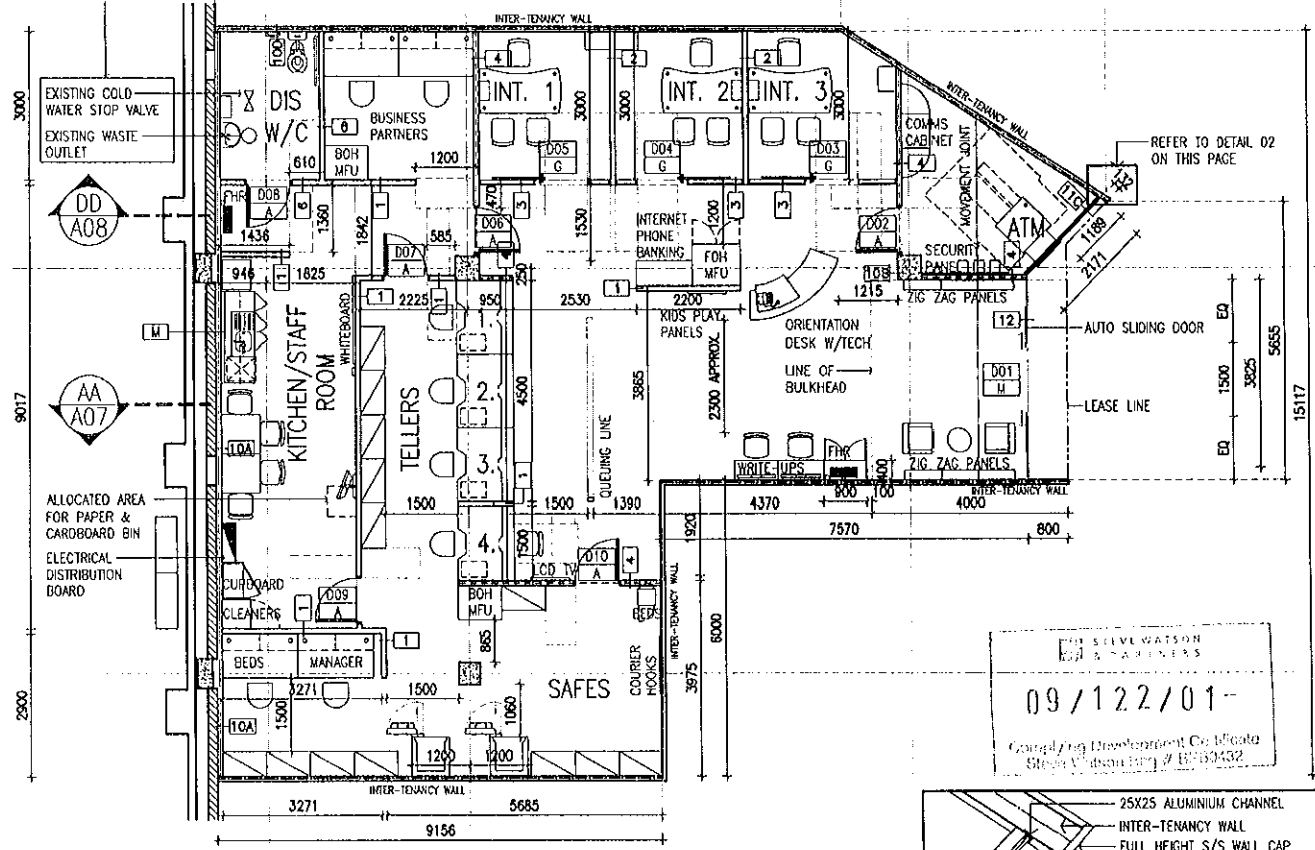

STEVE WATSON & PARTNERS
09/12.2/01-
Commercial Development Co. (Qld)
Brisbane Queensland # 07553432

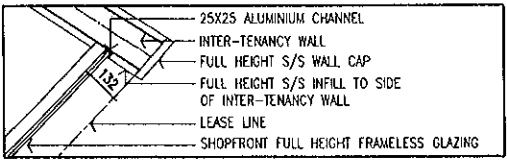

01 FLOOR PLAN
Scale:1:100

02 DETAIL
Scale:1:20



WESTPAC DESIGN STANDARD P701-P112
This information is provided for the recipient's approval and may not be used or modified for any other project or purpose. Any use of drawings and/or information for any other project or purpose is the responsibility of the user.
Drawings are to be read in conjunction with all related documents and the latest revision only. Do not make any assumptions.
Users are advised to check the accuracy of all material and to ensure that the drawings are correct before construction.
The responsibility of the final design and construction shall remain with the client. The drawings are not to be used for construction unless approved by the architect and/or engineer.



NO.	DATE	BY	CHKD	REVISIONS
1	09/12/01	SW	SW	ISSUE FOR PERMIT
2	10/01/02	SW	SW	REVISED TO REFLECT PERMIT CONDITIONS
3	10/01/02	SW	SW	REVISED TO REFLECT PERMIT CONDITIONS
4	10/01/02	SW	SW	REVISED TO REFLECT PERMIT CONDITIONS
5	10/01/02	SW	SW	REVISED TO REFLECT PERMIT CONDITIONS

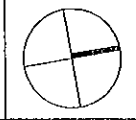

suters

WESTPAC BALGOYLAI CONDAINE STREET BALGOYLAI, NSW		FLOOR PLAN	
Project Number	13066	Sheet	A02
Drawing Number	A02	Date	03
Issue	E	Scale	1:100

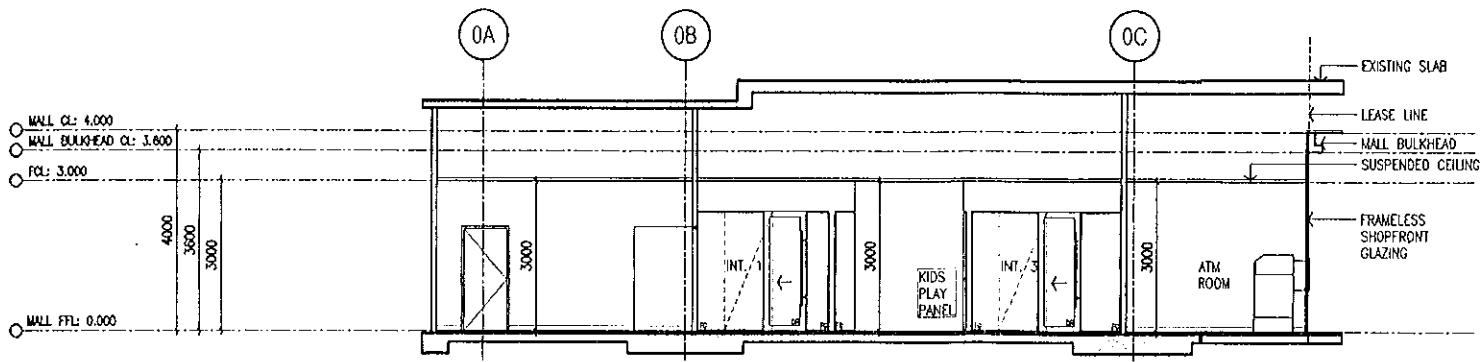

01 SECTION DD
Scale:1:100

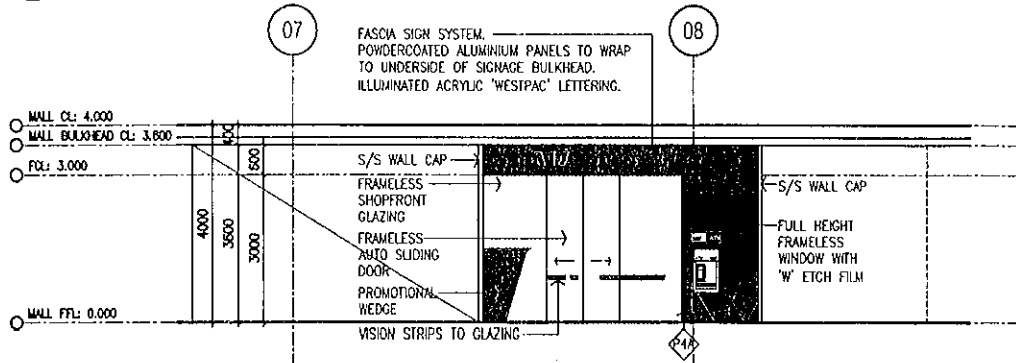

02 SHOPFRONT ELEVATION
Scale:1:100

WESTPAC
09/122/01--
Consulting Architectural Practice
Sydney, Australia Ph: (02) 9550 3322



© 2008 WESTPAC BANKING CORPORATION
All rights reserved. This document is confidential and its use is restricted to the purposes for which it was prepared. It is not to be distributed to any other person or entity without the prior written consent of Westpac Banking Corporation. If you are not an intended recipient, you should not disseminate, distribute or copy this document. If you have received this document by mistake, please notify the sender immediately by e-mail. This document is intended for the use of the individual named herein. If you are not the named individual you should not disseminate, distribute or copy this document. The content of this document is confidential and its use is restricted to the purposes for which it was prepared. It is not to be distributed to any other person or entity without the prior written consent of Westpac Banking Corporation.



NO.	DESCRIPTION	DATE	BY
1	ISSUE FOR PERMIT	19/02/08	AD
2	ISSUE FOR PERMIT	19/02/08	AD
3	ISSUE FOR PERMIT	19/02/08	AD
4	ISSUE FOR PERMIT	19/02/08	AD
5	ISSUE FOR PERMIT	19/02/08	AD

suters

Project	WESTPAC BALGOWLAH CONDAMINE STREET BALGOWLAH, NSW	Sheet	SECTION DD AND SHOPFRONT ELEVATION
Client	WESTPAC	Date	19/02/08
Project number	13066	Sheet number	A08
			D

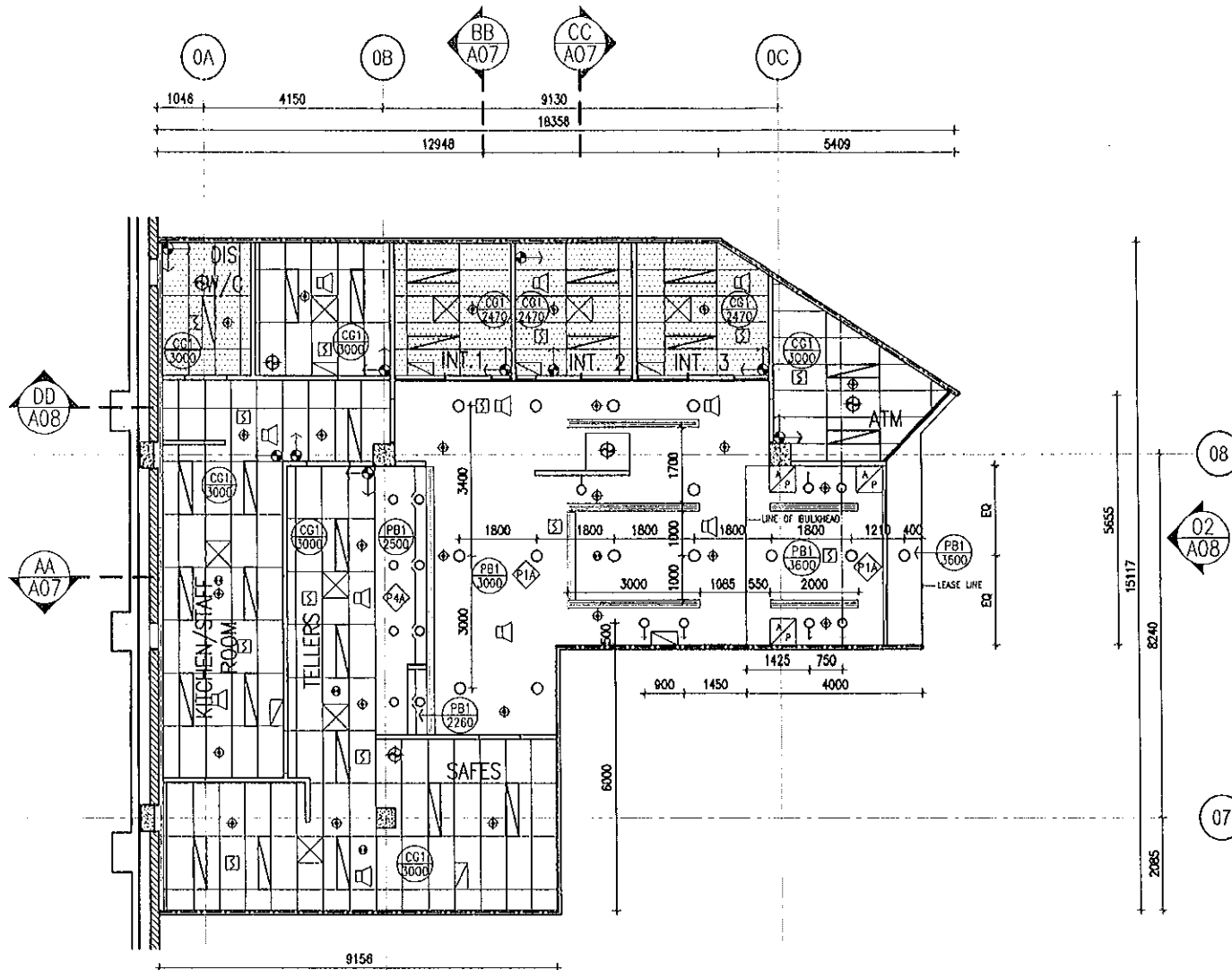

LEGEND

- CEILING TYPE
CEILING HEIGHT FROM FFL
- CEILING FINISH
- CHANGE IN CEILING/BULKHEAD HEIGHT
- LINE OF F72 MESH ABOVE CEILING
- CEILING TILE GRID SETOUT
- FLUORESCENT LIGHT
- RECESSED DOWNLIGHT
- CEILING MOUNTED WALL WASHER
- EXTERIOR WALL MOUNTED LUMINAIRE
- EMERGENCY LIGHT
- NEW SPEAKER
- SPRINKLER
- NEW CEILING MOUNTED EXHAUST FAN / DUCT
- NEW SUPPLY AIR GRILLE
- NEW SUPPLY AIR GRILLE (LINEAR)
- NEW RETURN AIR GRILLE
- NEW ACCESS PANEL
- SMOKE DETECTOR BELOW CEILING

CEILING TYPES

- PB1 - SET PLASTERBOARD CEILING
- CG1 - 1200x600x10mm GPO 24mm ARBUSTRONS ANKLED REGULAR WHITE FINE FISSURED PANELS, WHITE
- ACOUSTIC INSULATION OVER CEILING AS PER SPECIFICATION

GENERAL NOTES

1. ELECTRICAL CONTRACTOR TO ENSURE WESTPAC LIGHTING REQUIREMENTS ARE MET.
2. MARY CONTRACTOR TO PROVIDE STRUCTURAL ENGINEER CERTIFICATION FOR ALL STRUCTURAL SUSPENDED CEILINGS & BULKHEADS AND ALL OTHER STRUCTURAL INSTALLATION AS REQUIRED.
3. WHERE EVER NOTED INSTALL F72 MESH TO THE UNDERSIDE OF FLOOR SLAB ABOVE TO WESTPAC STANDARDS.
4. REFER TO WESTPAC STANDARD FINISHES, FITTING & EQUIPMENT SCHEDULE FOR FINISHES DETAILS.
5. SKYFRONT LIGHTING MUST BE SEPARATELY SWITCHED TO A TIMER + PROGRAMMED TO CENTRE TRADING HOURS.

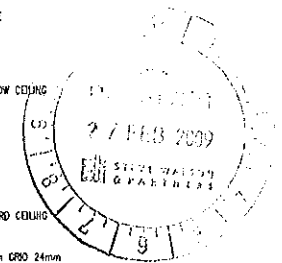

01 FLOOR PLAN
Scale: 1:100



© 2008 WESTPAC FIN LTD. All rights reserved.
The information contained in this document is confidential and may not be used or reproduced for any other project or purpose. Notify all stakeholders and ensure they are aware and accept any discrepancies prior to the commencement of work.
Contractors are to be used in conjunction with all standard documents. The signed documents are to be used for all drawings. Unless otherwise noted, approval for copying, printing and reuse is granted for the use of the information contained in this document. The completion of this document is subject to the terms and conditions of the contract. The drawings shall not be used for construction unless authorized by the Designer and approved by the client.



REV	DATE	BY	CHKD	DESCRIPTION
1	15/02/09	MM	MM	ISSUE FOR PERMIT
2	15/02/09	MM	MM	ISSUE FOR PERMIT
3	15/02/09	MM	MM	ISSUE FOR PERMIT
4	15/02/09	MM	MM	ISSUE FOR PERMIT
5	15/02/09	MM	MM	ISSUE FOR PERMIT
6	15/02/09	MM	MM	ISSUE FOR PERMIT
7	15/02/09	MM	MM	ISSUE FOR PERMIT
8	15/02/09	MM	MM	ISSUE FOR PERMIT
9	15/02/09	MM	MM	ISSUE FOR PERMIT
10	15/02/09	MM	MM	ISSUE FOR PERMIT

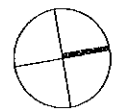

suters

Project	WESTPAC BALGOWLAH CONDOMINIUM STREET BALGOWLAH, NSW
Client	WESTPAC

Project	13066	Drawn by	A03	Scale	G
Date	15/02/09	Checked by		Sheet No.	04
Project number		Drawn by		Date	

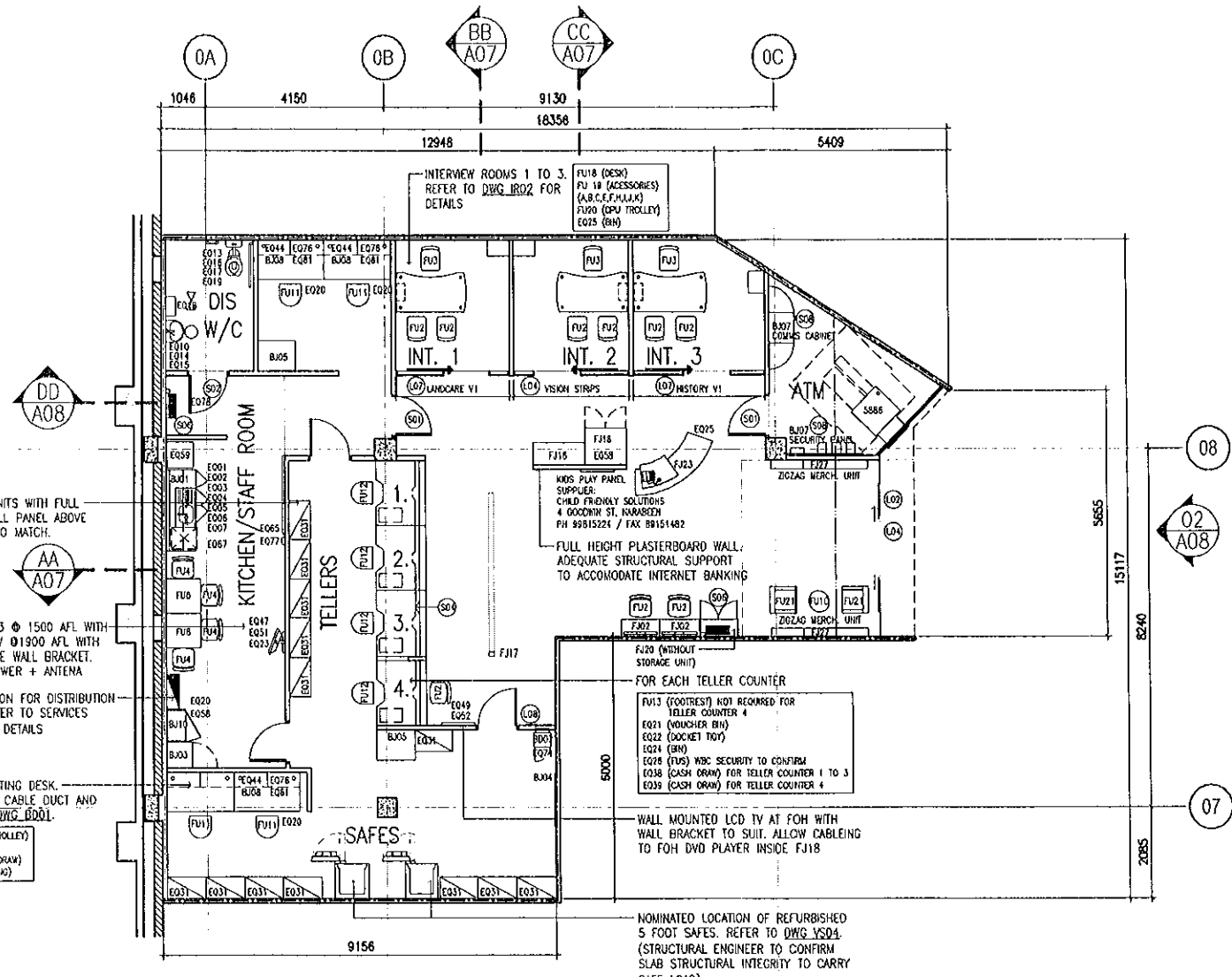

- GENERAL NOTES:**
- REFER TO WESTPAC STANDARDS MASTER SCHEDULE FOR DETAILS OF EACH CODE.
 - FUNCTIONAL SIGNAGE TO BE WHITE LETTERING ON 'WESTPAC GREY' BACKGROUND TO WESTPAC DESIGN STANDARDS. ALL STATUTORY SIGNAGE TO COMPLY WITH BCA.

- FUNCTION & STATUTORY SIGNAGE:**
- S01 - 'STAFF ONLY' W/ML DOOR SIGNAGE
 - S02 - TOILET SIGNAGE (CLEAR + LEGIBLE BRAILLE + TOILET SIGNAGE [AS PER BCA SPEC. D3.6] + INCORPORATING THE INTERNATIONAL SYMBOL OF ACCESS [AS PER AS1428.1])
 - S04 - TELLER NUMBERING SYSTEM
 - S06 - 'FIRE HOSE REEL' W/ML SIGNAGE
 - S08 - ELECTRICAL CABINET SIGNAGE

- SIGNAGE:**
- L02 - DOOR DECALS
 - L03 - GRAPHIC WALL W/ML
 - L04 - VISION STRIP TO WESTPAC STANDARDS
 - L05 - MEDIA LOG WALL RED 'W' ETCHING W/ML TO SUIT WALL LENGTH
 - L06 - 3D WHITE ACRYLIC MERCHANDISING WALL LETTERING
 - L07 - INTERVIEW ROOM GLASS WINDOW COMMUNITY GRAPHICS
 - L08 - BED PLATE SIGNAGE

STORAGE UNITS WITH FULL HEIGHT INFILL PANEL ABOVE Ø2200MM TO MATCH.

CLOCK EQ23 Ø 1500 AFL WITH BOH LCD TV Ø1300 AFL WITH APPROPRIATE WALL BRACKET. PROVIDE POWER + ANTENNA

NEW LOCATION FOR DISTRIBUTION BOARD. REFER TO SERVICES ENGINEER'S DETAILS

BEDS COUNTING DESK. ALLOW FOR CABLE DUCT AND REFER TO DWG_B001.

- FU20 (CPU TROLLEY)
- EQ20 (BIN)
- EQ29 (CASH DRAW)
- EQ76 (SHELVING)

FOR EACH TELLER COUNTER

- FU13 (FOOTREST) NOT REQUIRED FOR TELLER COUNTER 4
- EQ21 (VENDING BIN)
- EQ22 (DOCKET TOTE)
- EQ24 (BIN)
- EQ26 (FUS) W/BC SECURITY TO CONFIRM
- EQ38 (CASH DRAW) FOR TELLER COUNTER 1 TO 3
- EQ39 (CASH DRAW) FOR TELLER COUNTER 4

WALL MOUNTED LCD TV AT FOH WITH WALL BRACKET TO SUIT. ALLOW CABLING TO FOH DVD PLAYER INSIDE FJ18

NOMINATED LOCATION OF REFURBISHED 5 FOOT SAFES. REFER TO DWG_YSD4. (STRUCTURAL ENGINEER TO CONFIRM SLAB STRUCTURAL INTEGRITY TO CARRY SAFE LOAD)

01 FLOOR PLAN
Scale:1:100

© 2008 Westpac Finance Ltd. All rights reserved. This document is confidential. It is intended for the use of the recipient only. It is not to be distributed, copied, or otherwise used without the prior written consent of Westpac Finance Ltd. The recipient of this document is advised that it is not to be used for any other purpose. The recipient of this document is advised that it is not to be used for any other purpose. The recipient of this document is advised that it is not to be used for any other purpose.



REVISIONS	DATE	BY	CHKD
1. INITIAL DESIGN	01/02/08	SP	SP
2. REVISED DESIGN	01/02/08	SP	SP
3. FINAL DESIGN	01/02/08	SP	SP
4. REVISED DESIGN	01/02/08	SP	SP
5. FINAL DESIGN	01/02/08	SP	SP

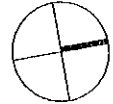

suters

Project: WESTPAC BALGOOLAH CONDAMINE STREET BAL GOOLAH, NSW	Drawn: [Name]	Scale: 1:100
Client: WESTPAC	Project No: 13066	Drawn No: A04
	Check No: [Name]	Scale: E

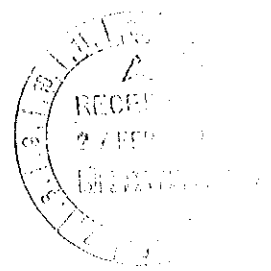

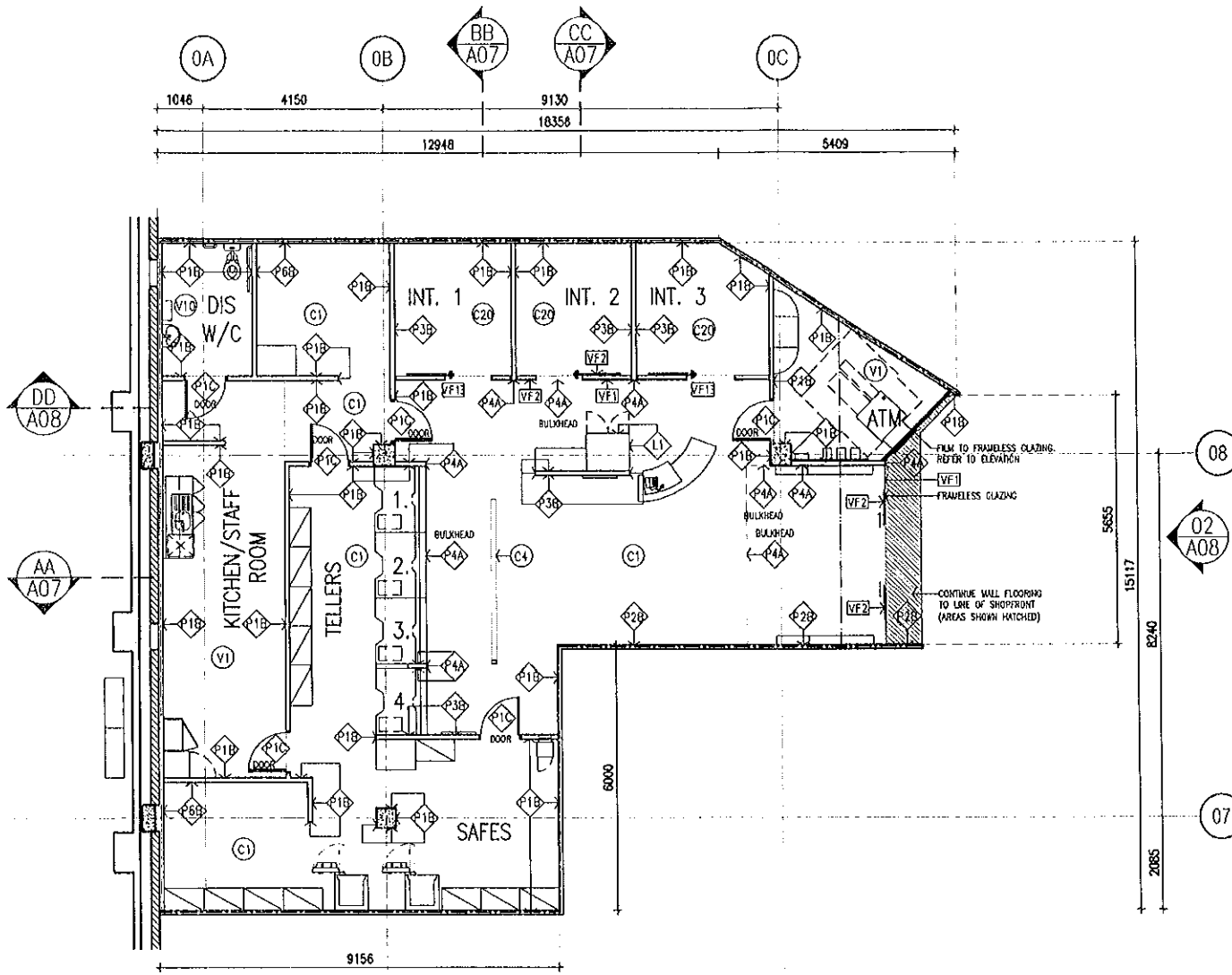

- GENERAL NOTES:**
- REFER TO WESTPAC STANDARD MASTER SCHEDULE FOR DETAILS OF FINISHES CODES
 - ALL WALLS TO BE FINISHED WITH DULUX VINYL WHITE (P1B) PAINT FINISH UNLESS NOTED OTHERWISE
 - PLASTERBOARD & FIBER CEMENT CEILINGS TO BE PAINTED WITH DULUX PAINT FINISH - CEILING WHITE (P1A) UNLESS NOTED OTHERWISE
 - ALL INTERNAL SKRINTINGS AND DOOR FRAMES TO MATCH PC1 UNLESS NOTED OTHERWISE
 - ALL WINDOW/GLASS FRAMES ON EXTERNAL FACADES TO MATCH PC2

- PAINT COLOURS:**
- ◆ P1B DULUX VINYL WHITE, ACRYLIC LOW SHEEN FINISH
 - ◆ P1C DULUX VINYL WHITE, ENAMEL SEMI GLOSS FINISH
 - ◆ P2B DULUX RED CROWN, ACRYLIC LOW SHEEN FINISH
 - ◆ P3B DULUX TICKLING, ACRYLIC LOW SHEEN FINISH
 - ◆ P4A DULUX DEEP GARNET, ACRYLIC FLAT FINISH
 - ◆ P6B DULUX LIMESEED, ACRYLIC LOW SHEEN FINISH

- CARPET:**
- C1 ONTEKA CARPET TILE, 609-81220
 - C20 ONTEKA CARPET TILE, 609-91588
 - C4 ONTEKA DIMENSIONS QUEUING STRIP CARPET, RED CENTRE - 390

- VINYL FLOOR:**
- V1 TARKETT GRANITE AMT STATIC VINYL - 790 MCS S 2005-740R
 - V10 FORBO SMAPRAC CLASSIC VINYL - 6198

- FLOOR TILES:**
- T2 COLOR TILE, WARM GREY OPT6801 (25)

- VINYL FILM/SIGNAGE:**
- ◆ VF1 VISION STRIPPING, BOURBOUDY 923
 - ◆ VF2 VISION STRIPPING, CARVINE RED 950
 - ◆ VF13 COMMUNITY GRAPHIC INTERIUM ROOM 1; LANDSCAPE V1 INTERIUM ROOM 3; HISTORY V1

- LAMINATE FINISH:**
- ◆ L1 LAMINEX WHITE 200 - FLUT FINISH

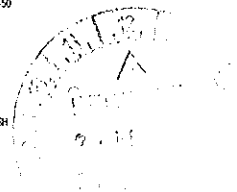

01 FLOOR PLAN
Scale: 1:100

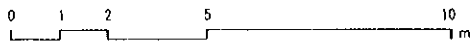

© BUNGE AND PARTNERS PTY LTD. All rights reserved.
The information contained in this document is copyright and may not be used or reproduced for any other project or purpose. Any party who wishes to copy or use any part of this document must first obtain the written consent of the copyright owner.
Bunge and Partners Pty Ltd. is not liable for any loss or damage arising from the use of this document.
The copyright in this document is owned by Bunge and Partners Pty Ltd. and is not to be used for any other project or purpose without the written consent of Bunge and Partners Pty Ltd.



NO.	DATE	BY	CHKD	REV
1	2018/02/28	ADAM	ADAM	1
2	2018/03/01	ADAM	ADAM	2
3	2018/03/01	ADAM	ADAM	3
4	2018/03/01	ADAM	ADAM	4

NO.	DATE	BY	CHKD	REV
1	2018/02/28	ADAM	ADAM	1
2	2018/03/01	ADAM	ADAM	2
3	2018/03/01	ADAM	ADAM	3
4	2018/03/01	ADAM	ADAM	4

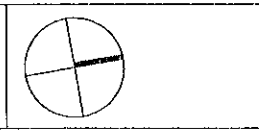

suters

WESTPAC BALGOWLAH
CONDAMINE STREET
BALGOWLAH, NSW
WESTPAC

FINISHES PLAN			
NO.	DATE	BY	CHKD
13066	2018/02/28	ADAM	ADAM
A05			
E			