

GENERAL PLANTING NOTES:

NOTE: Plants shall be vigorous, well established, of good form consistent with species or variety, not soft or forced, free from disease and insect pests, with large healthy root systems and no evidence of having been restricted in growth or damaged. Root system shall be well balanced in relation to the size of the plant.

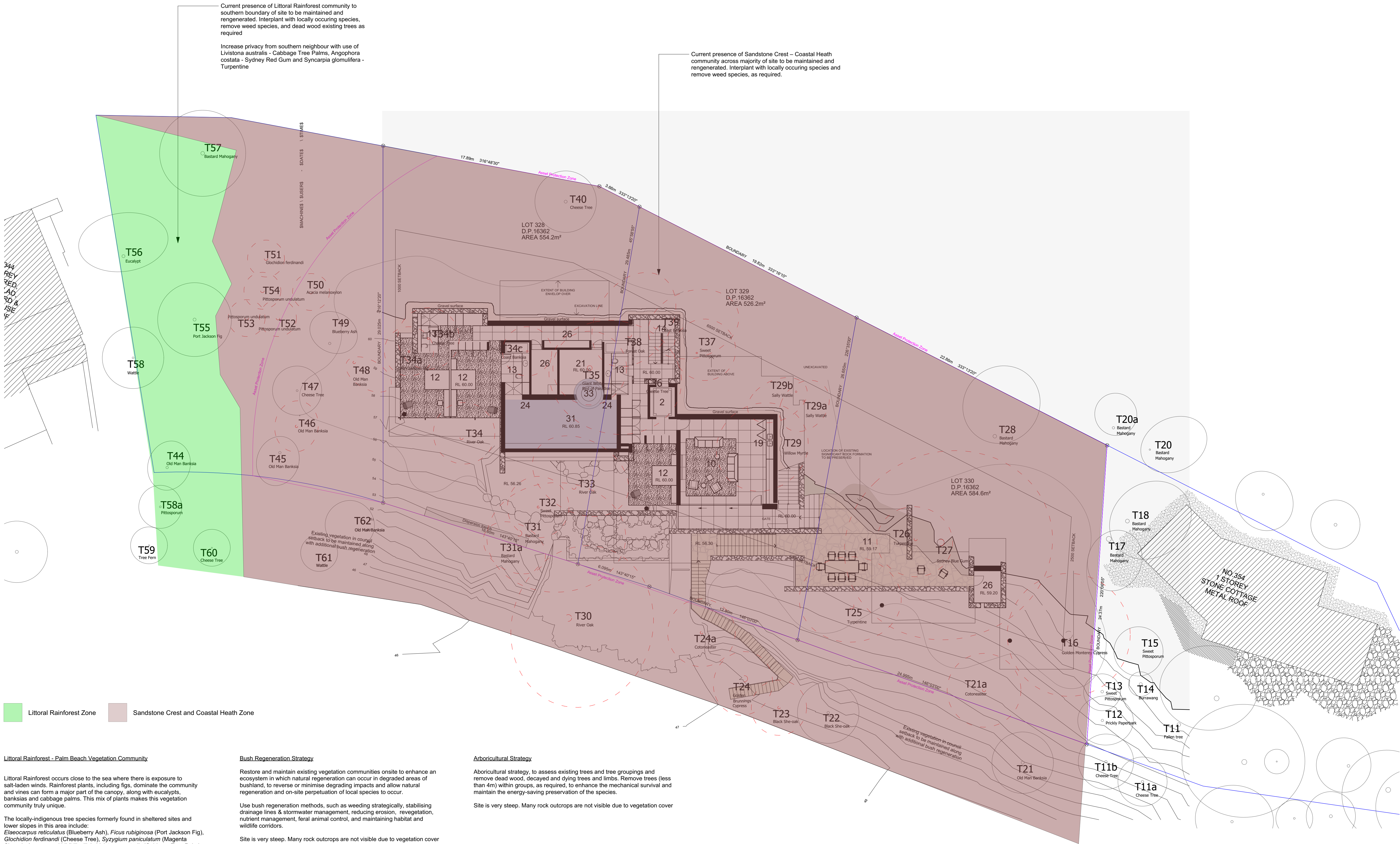

Littoral Rainforest - Palm Beach Vegetation Community

Littoral Rainforest occurs close to the sea where there is exposure to salt-laden winds. Rainforest plants, including figs, dominate the community and vines can form a major part of the canopy, along with eucalypts, banksias and cabbage palms. This mix of plants makes this vegetation community truly unique.

The locally-indigenous tree species formerly found in sheltered sites and lower slopes in this area include:
Elaeocarpus reticulatus (Blueberry Ash), *Ficus rubiginosa* (Port Jackson Fig), *Glochidion ferdinandi* (Cheese Tree), *Syzygium paniculatum* (Magenta Cherry), *Acmena smithii* (Lillypilly), *Livistona australis* (Cabbage Tree Palm) and *Ficus coronata* (Sandpaper Fig)

Sandstone Crest and Coastal Heaths - Palm Beach Vegetation Community

The original vegetation of this area consisted of coastal heath and woodland typical of the "Sandstone Crest - Coastal Heaths", subject to some coastal exposure. Exposed coastal sandstone plateaus with infertile, shallow, moderately damp soil.

The dominant locally-indigenous tree species formerly found on these site areas include: include *Angophora costata* (Sydney Red Gum), *Eucalyptus umbra* (Bastard Mahogany) and *Eucalyptus racemosa* (Scribbly Gum). Other species found in this vegetation community may include *Allocasuarina torulosa* (Forest Oak), *Syncarpia glomulifera* (Turpentine), *Banksia integrifolia* (Coast Banksia), *Banksia serrata* (Old Man Banksia) and *Eucalyptus botryoides* (Bangalay).

Bush Regeneration Strategy

Restore and maintain existing vegetation communities onsite to enhance an ecosystem in which natural regeneration can occur in degraded areas of bushland, to reverse or minimise degrading impacts and allow natural regeneration and on-site perpetuation of local species to occur.

Use bush regeneration methods, such as weeding strategically, stabilising drainage lines & stormwater management, reducing erosion, revegetation, nutrient management, feral animal control, and maintaining habitat and wildlife corridors.

Site is very steep. Many rock outcrops are not visible due to vegetation cover

Bush Regeneration Strategy within Asset Protection Zone - APZ

No trees or shrubs are to form part of the bush regeneration within the APZ - ground-covers only. Bush regeneration is to observe the conditions of Inner Protection Zone Condition as per the Rural Fire Service document - *Standards for Asset Protection Zones*. Refer to report and concept landscape plan from Abel Ecology

Arboricultural Strategy

Arboricultural strategy, to assess existing trees and tree groupings and remove dead wood, decayed and dying trees and limbs. Remove trees (less than 4m) within groups, as required, to enhance the mechanical survival and maintain the energy-saving preservation of the species.

Site is very steep. Many rock outcrops are not visible due to vegetation cover

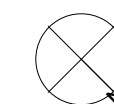

Project:
Lots 327-330, DP 16362
346-352 Whale Beach Rd
Palm Beach, NSW 2108

Dwg no:
DA02-D0821
Title:
Landscape Strategies

Drawn by: SH
Checked: WD
Scale: 1:150 @ A1
Issue: 01
Revision: B
Date: 10.03.2021

Landscape Design Sydney
53 Cranbrook St
Botany NSW 2019
Tel: (02) 9316 9044
Fax: (02) 9316 9055
Figure dimensions and site presentation over scale. Contractors must verify all dimensions in situ before commencing any work or making their design. This drawing is protected by copyright.

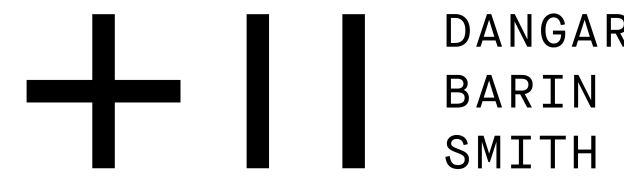

0 1 2 3 5

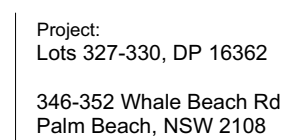
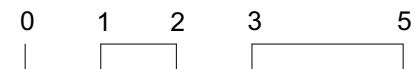

Dwg no:
DA03-D0821

Title:
Landscape Plan
Level 0 - 4

Drawn by: SH Checked: WD Scale: 1:100 @ A1

Issue: 01 Revision: B Date: 10.02.2021

Landscape Design Sydney Tel: (02) 9316 9044
53 Cranbrook St Fax: (02) 9316 9055
Botany NSW 2019



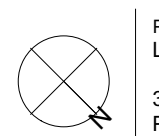

Landscape Design Sydney Tel: (02) 9316 9044
53 Cranbrook St Fax: (02) 9316 9055
Botany NSW 2019

Figure dimensions shall take precedence over scale. Contractors must verify all dimensions on job before commencing any work or making shop drawings. This drawing is not to be construed by contractor as a contract.

**+ I I DANGAR
BARIN
SMITH**

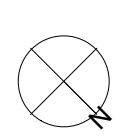
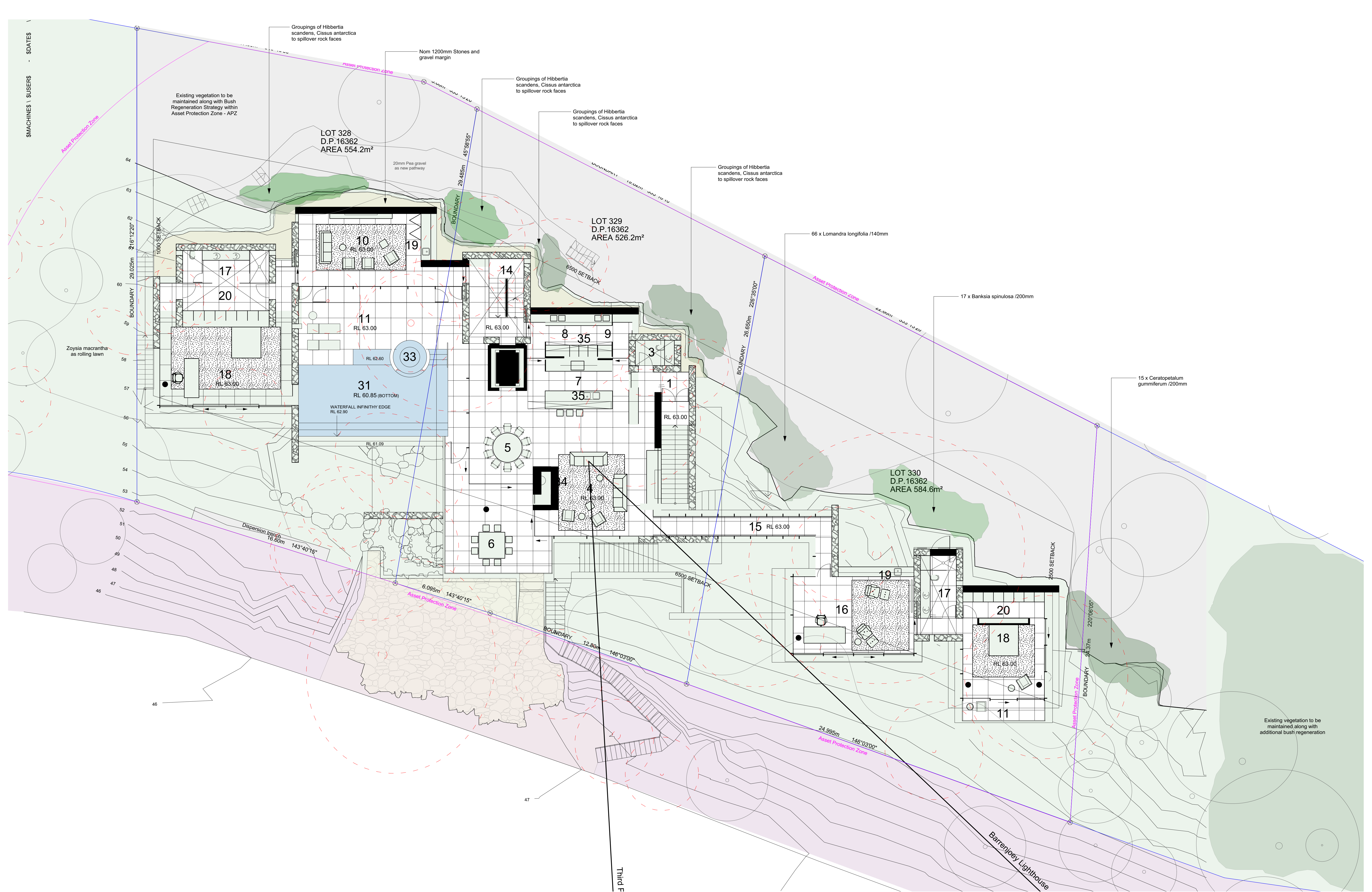

Project:
Lots 327-330, DP 16362
346-352 Whale Beach Rd
Palm Beach, NSW 2108

Dwg no:
DA05-D0821
Title:
Landscape Plan
Level 2

Drawn by: SH
Checked: WD
Scale: 1:100 @ A1
Issue: 01
Revision: B
Date: 10.03.2021

Landscape Design Sydney
53 Cranbrook St
Botany NSW 2019
Tel: (02) 9316 9044
Fax: (02) 9316 9055

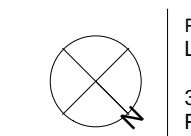
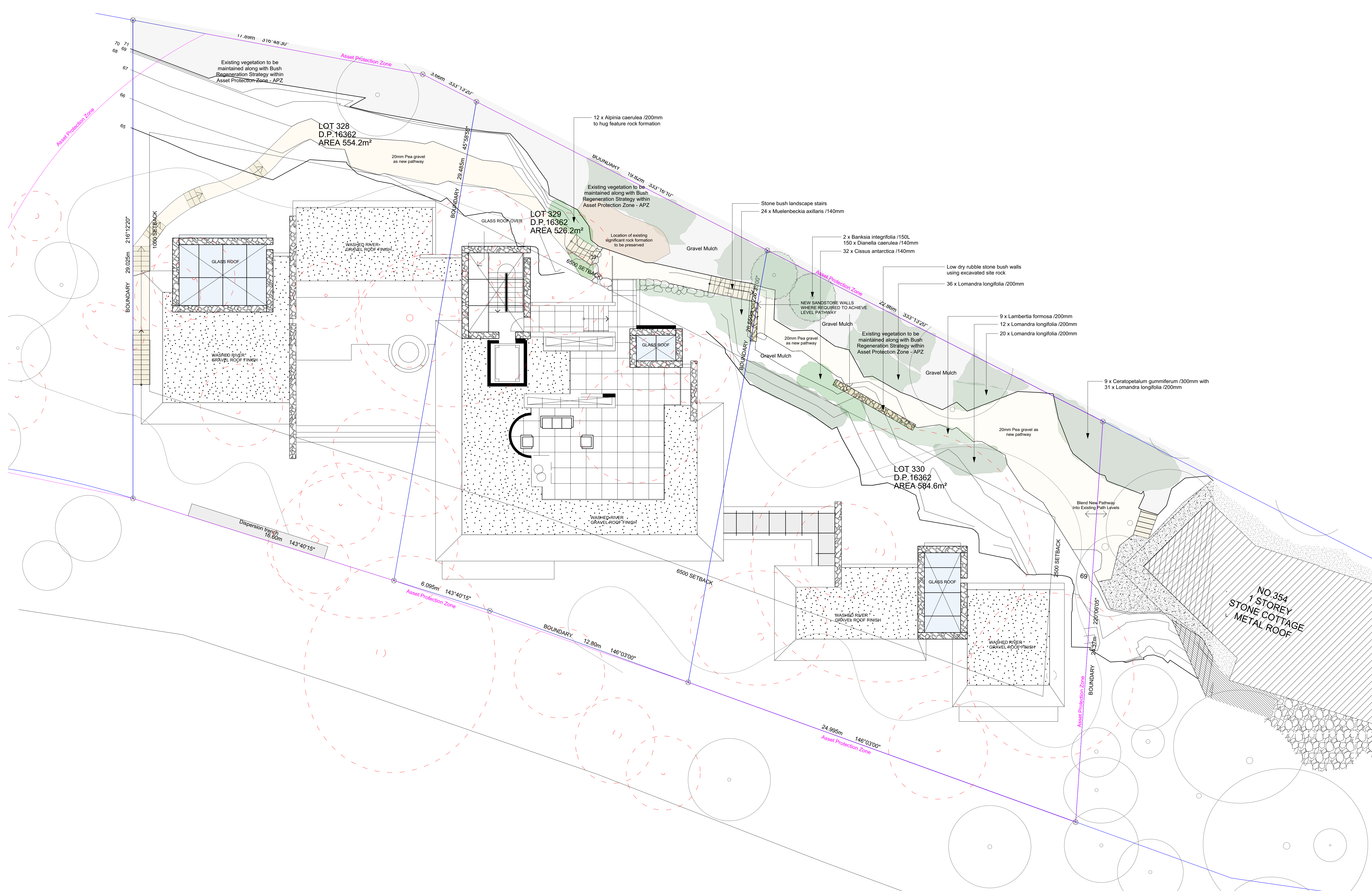

Project:
Lots 327-330, DP 16362
346-352 Whale Beach Rd
Palm Beach, NSW 2108

Dwg no:
DA06-D0821
Title:
Landscape Plan
Roof

Drawn by: Checked: Scale: 1:100 @ A1
SH WD
Issue: 01 Revision: B Date: 10.03.2021

Landscape Design Sydney Tel: (02) 9316 9044
53 Cranbrook St Fax: (02) 9316 9055
Botany NSW 2019
Figure dimensions shall take precedence over scale. Corrections must only be made on site before commencing any work or making site drawings. This drawing is protected by copyright.

