



northern
beaches

council

THIS PLAN IS TO BE READ IN
CONJUNCTION WITH
THE CONDITIONS OF DEVELOPMENT
CONSENT

MOD2024/0025

PART B DEMOLITION

	REUSED	RECYCLED	DISPOSED	
TYPE OF WASTE	ESTIMATE VOLUME	ESTIMATE VOLUME	ESTIMATE VOLUME	METHOD OF REUSE
EXCAVATION MATERIAL		30 CUBIC M	120 CUBIC M	RECYCLE AT POSSIBLE EXTERNAL SITE
TIMBER				
CONCRETE				NIL
BRICK/PAVERS				NIL
TILES				NIL
METAL (roof sheeting)				NIL
GLASS				NIL
FURNITURE				NIL
FIXTURE AND FITTINGS				NIL
FLOOR COVERING				NIL
PACKING		3.5 CUBIC M		KIMBRIKI RRC
GARDEN ORGANIC			5.5 CUBIC	RECYCLE / MULCH
CONTAINERS				NIL
PAPER				NIL
RESIDUAL WASTE			10 CUBIC M	COUNCIL HOUSEHOLD PICKUP
HAZARDOUS(asbestos waste)				NIL

PART D ONGOING WASTE MANAGEMENT

	RECYCLABLES	COMPOSTABLES	RESIDUAL WASTE	OTHERS
TYPE OF WASTE	ESTIMATE VOLUME	ESTIMATE VOLUME	ESTIMATE VOLUME	METHOD OF REUSE
AMOUNT GENERATED (DAY)	HOUSEHOLD WASTE	HOUSEHOLD WASTE	HOUSEHOLD WASTE	
AMOUNT GENERATED (WEEK)	HOUSEHOLD WASTE	HOUSEHOLD WASTE	HOUSEHOLD WASTE	
COMPACTION REDUCTION	NIL	NIL	NIL	
COLLECTION FREQUENCY	1	1	1	
NUMBER OF BINS, SIZE	2X 140L	1X 240L	1X 80L	
STORAGE AREA	1.5MSQ	1.0MSQ	0.7MSQ	
MANEUVERABLE REQUIRED	1.5MSQ	1.0MSQ	0.7MSQ	
FIXTURE AND FITTINGS				
HEIGHT IF REQUIRED	NIL	NIL	NIL	

WASTE MANAGEMENT PLAN

- 1 MINIMISE THE WASTE SENT FOR DISPOSAL.
- 2 MINIMISE THE IMPACT AND DISTURBANCE ON SURROUNDING AMENITY, PUBLIC SAFETY, ROADWAYS AND NATURAL AND BUILT ENVIRONMENT.
- 3 ADHERE TO ANY RELEVANT LEGISLATION NOT LIMITED TO HAZARDOUS WASTE, STORAGE AND TRANSPORTATION REGULATIONS.
- 4 SEND WASTE MATERIALS TO A SUITABLY LICENSED FACILITY.
- 5 IDENTIFY SUITABLE LOCATIONS ON THE SITE FOR SORTING AND STORING OF MATERIALS FOR RE-USE, RECYCLING AND DISPOSAL. FACTORS TO CONSIDER INCLUDE SLOPES, DRAINAGE AND PERSONNEL AND VEHICULAR ACCESS.
- 6 MAINTAIN VALID TIPPING DOCKETS AND RECEIPTS ON SITE FOR INSPECTION.

SITE PROTECTION

BUILDING CONTRACTOR WILL INSTALL AROUND THE DEVELOPMENT AREA TEMPORARY STRUCTURES TO PROTECT PERSONS AND PROPERTY AND TO PREVENT UNAUTHORISED ACCESS TO THE SITE

TREE PROTECTION

BUILDING CONTRACTOR WILL REFFER TO ARBORIST REPORT FOR TREE PRTECTION FENCING, GROUND PROTECTION AND TRUNK PROTECTION

BASIC REQUIREMENT

BUILDING CONTRACTOR TO ISSUE CERTIFICATE STATING COMPLIANCE WITH BASIC CERTIFICATE A401407-04 DATED 02 MARCH 2023

Applicant Declaration

I declare that:

- 1 This plan has been completed in accordance with the Waste Management Guidelines I understand that:
- 2 To the best of my knowledge, the details on this form are accurate and correct

I understand that:

- 1 All records demonstrating lawful disposal of waste will be retained and kept readily accessible for inspection by regulatory authorities such as Council, NSW Environment Protection Authority or WorkCover NSW.
- 2 A bond in accordance with Councils fees and charges may apply to this development and must be paid to Council prior to any works
- 3 The bond will only be refunded when Council is satisfied that all waste outlined in this plan has been managed as per the plan, and evidence such as photos, receipts and statutory declarations must be supplied where appropriate.

Applicate signature: Robert Jones

dated: 02. 03. 2023

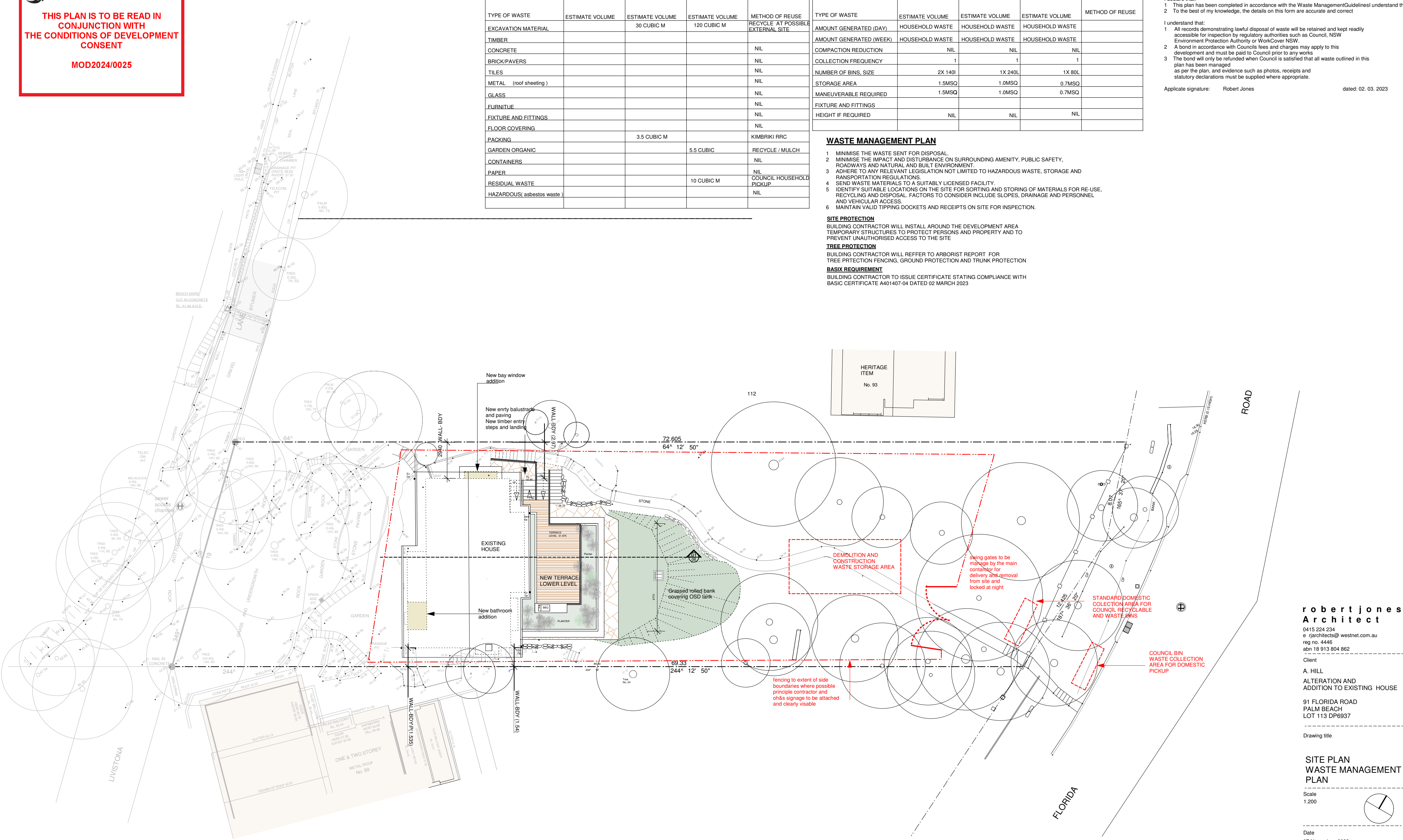

robert jones
Architect

0415 224 234
e rjarchitects@westnet.com.au
reg no. 4446
abn 18 913 804 862

Client

A. HILL
ALTERATION AND
ADDITION TO EXISTING HOUSE

91 FLORIDA ROAD
PALM BEACH
LOT 113 DP6937

Drawing title

SITE PLAN
WASTE MANAGEMENT
PLAN

Scale

1:200

Date

07 November 2023

DA01E

NOTES

All Building Construction works to comply with all relevant BCA and AS requirements Building Contractor to verify dimensions on site prior to fabrication