

SERVICE LEGEND	
DRAINAGE	
COMBO PIT	
GRATE	
SIDE ENTRY PIT	
STORM WATER MANHOLE	
ELECTRICITY	
CABLE DOME	
CABLE MANHOLE	
CABLE PIT	
CONSUMER POLE	
LIGHT POLE	
POWER POLE	
STAY POLE	
STAY WIRE ANCHOR	
OH POWER LINE	
GAS	
GAS MANHOLE	
GAS MARKER	
GAS METER	
GAS VALVE	
SEWERAGE	
SEWER MANHOLE	
PROPERTY CONNECTION	
SEWER LINE	
TELECOMMUNICATION	
TEL / COMMS MANHOLE	
TEL / COMMS MARKER	
TEL / COMMS PIT	
WATER	
FLUSH POINT	
HYDRANT	
STOP VALVE	
TAP	
WATER MARKER	
WATER METER	
WATER LINE	
SURVEY	
DATUM	
REG FOUND	
OTHER	
AWNING / EAVES	
ROOF RIDGE	
FLOOR RL	
WINDOW / DOOR	
WINDOW HEAD	
WINDOW SILL	
BANK - BOTTOM	
BANK - TOP	
SERVICE RECORD	
STATUS	
LOCATED	NO SERVICE
AVAILABLE	CONFIRMED
SERVICE	
WATER	<input type="checkbox"/>
SEWERAGE	<input type="checkbox"/>
GAS	<input type="checkbox"/>
TEL / COMM	<input type="checkbox"/>
POWER	<input type="checkbox"/>

SERVICES MARKED CONFIRM REQUIRE BUILDER / CLIENT TO CONFIRM POSITION AND / OR AVAILABILITY ON SITE		
WATER	<input type="checkbox"/>	CONFIRMED
SEWERAGE	<input type="checkbox"/>	CONFIRMED
GAS	<input type="checkbox"/>	CONFIRMED
TEL / COMM	<input type="checkbox"/>	CONFIRMED
POWER	<input type="checkbox"/>	CONFIRMED

UNDERGROUND SERVICE INFORMATION SOURCED FROM DIAL BEFORE YOU DIG[®] AND IS VALID FOR 14 DAYS FROM APPLICATION DATE. THIS INFORMATION IS FOR INDICATIVE PURPOSES ONLY. IT IS NOT AN ACCURATE DEPICTION OF SCALE, LOCATION OR ALIGNMENT. LIFTING OF COVERS AND EXCAVATION MUST BE DONE FOR ACCURATE IDENTIFICATION AND LOCATION OF SERVICES.

NOTES:

- ONLY A BASIC BOUNDARY SURVEY HAS BEEN CONDUCTED FOR IDENTIFICATION PURPOSES. ACCURATE BOUNDARIES HAVE TO BE ESTABLISHED BEFORE THE COMMENCEMENT OF ANY CONSTRUCTION WORK.
- CONTOURS ARE INDICATIVE AT GROUND FORM ONLY. SPOT LEVELS ONLY SHOULD BE USED FOR CALCULATIONS OF QUANTITIES WITH CAUTION.
- LEVELS ARE ON AUSTRALIAN HEIGHT DATUM (A.H.D.). LEVELS ARE DERIVED FROM HEIGHT ORIGIN PM 6873 20.683 AHD (SCIMS SEARCH DATE 15 JUN 2020).
- THE CONTOUR INTERVAL IS 0.5m
- ALL SETOUT LEVELS MUST BE REFERRED TO THE BENCH MARKS SHOWN ON THIS PLAN.
- THE MGA 2020 ORIENTATION OF THE SURVEY IS DERIVED FROM SSM 141974 AND SSM 123076 DATED 24 JUN 2019.
- THE POSITION OF THE SURVEY IS ON MGA 2020 ZONE 56 COORDINATES. THE COORDINATES OF THE SURVEY ARE ADOPTED FROM SSM 141974 DATED 24 JUN 2019.
- MGA 2020 IS A LIVE DATUM WITH COORDINATES CHANGING CONSTANTLY. MGA 2020 COORDINATES SHOULD BE REFERRED TO THE DATE WHEN THE COORDINATES ARE DERIVED FROM (24 JUN 2019).
- THE VARIATION FROM MGA NORTH TO TRUE NORTH IS APPROXIMATELY 1°06'.
- THE LAND IS AFFECTED BY
 - EASEMENT TO DRAIN WATER 3 WIDE (DP1019363)
 - EASEMENT TO DRAIN WATER 1 WIDE (DP1019363)
 - EASEMENT FOR SEWERAGE PURPOSES 4 WIDE (3951558)
- THE APPROXIMATE DIMENSIONS OF THE TREES ARE SHOWN IN SPREAD/TRUNK SIZE/HEIGHT IN METRES.
- THE SHAPE AND SIZE OF SPREAD OF THE TREE MAY VARY DUE TO THE LACK OF UNIFORMITY OF THE BRANCHES, TRUNK AND OTHER REASONS
- ALL FOOTPATHS ARE AGGREGATE CONCRETE
- UNDERGROUND SERVICES ARE PLOTTED FROM DBYD PLANS AND FOR INDICATIVE PURPOSES ONLY. ACCURATE LOCATIONS OF THE SERVICES NEED TO BE ESTABLISHED BEFORE COMMENCEMENT OF ANY WORKS.

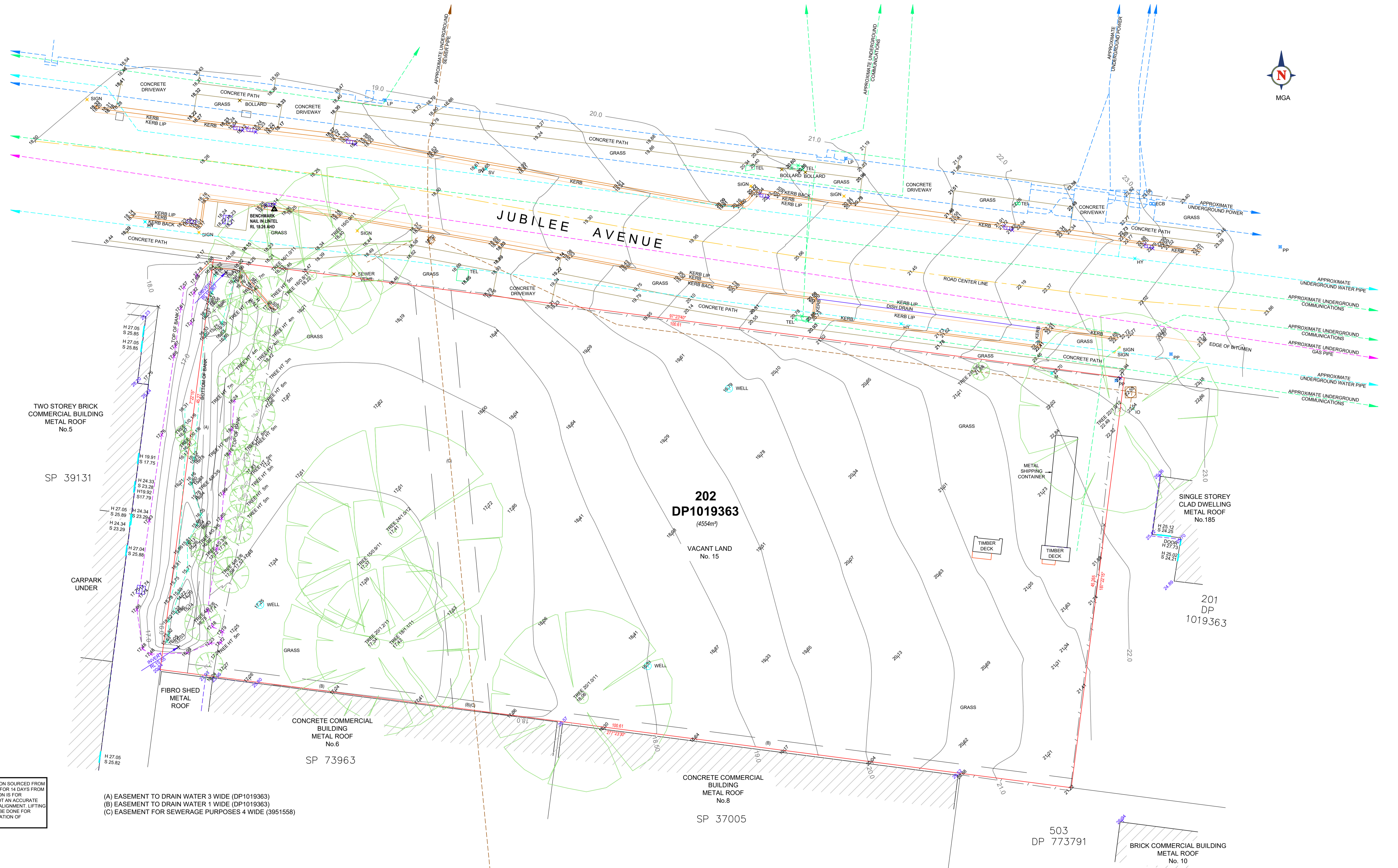

DETAIL AND LEVEL SURVEY				CLIENT : 15 Jubilee Pty Ltd	
SURVEYED ON : 17/06/2020, 22/04/2021				SURVEYOR : P.M. DRAFTER : B.W.	
ADDRESS : 15 JUBILEE AVENUE WARRIEWOOD				BEING : LOT 202 IN DP 1019363	
LGA : NORTHERN BEACHES COUNCIL				HEIGHT DATUM : AHD	
ORIGIN OF LEVELS : PM 6873				RL 20.683	
C	UPDATE NOTES TO REFLECT THE BASIC BOUNDARY SURVEY CONDUCTED	RL	19.05.21	RL	
B	ADDITIONAL VEGETATION FEATURES ADDED	BW	22.04.21	GW	
REV	DESCRIPTION	DRN	DATE	APP	
SCALE : 1:200				JOB No : 2103458	
@ A1 Landscape				PLAN : FS	
				DRG : 001	
				REV : C	
				SHEET 1 OF 1	
				LS F 220	