

NOTES:

All dimensions are in millimetres, unless otherwise noted.

Do not scale from this drawing.

Verify all dimensions on site prior to construction.

PROJECT

**SECTOR 5 WARRIEWOOD
VALLEY SUBDIVISION,
WARRIEWOOD**

CLIENT

JUBILEE DEVELOPMENTS

ARCHITECT

Denis Leech Associates

250 George Street, Sydney NSW 2000
Tel: (02) 9333 3881 Fax: (02) 9333 3889

MASTER PLANNING

Wolski, Lycencko & Brechnock

100-102 Macquarie Street, Sydney NSW 2000
Tel: (02) 9360 3477 Fax: (02) 9360 3557

ELECTRICAL

Barry Webb & Associates

27 Rouse Street, Sydney NSW 2000
Tel: (02) 9360 3477 Fax: (02) 9360 3557

ENVIRONMENTAL

WP Brown & Partners

Level 2, 28 Waterloo Street
Sydney NSW 2000
Tel: (02) 9360 3477 Fax: (02) 9360 3557

KEY PLAN

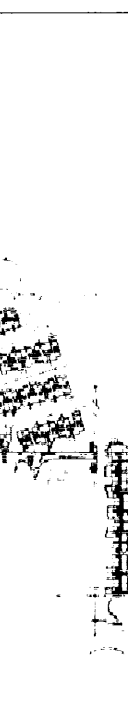

SCHEDULE OF TREES

No.	COMMON NAME	BOTANICAL NAME	STATISTIC	APPROX TRUNK Ø	APPROX SPREAD	APPROX HEIGHT
1	Cashwood	Ceratopetalum apetalum	TBR	0.2	9	7
2	Fernat Oak	Allocasuarina torulosa	TBR	0.3	8	8
3	Cashwood	Ceratopetalum apetalum	TBR	0.3	8	10
4	Cashwood	Ceratopetalum apetalum	TBR	0.3	6	10
5	Australian Christmas tree	Ceratopetalum gummifolium	TBR	0.2	8	7
6	Cashwood	Ceratopetalum apetalum	TBR	0.4	6	7
7	Cashwood	Ceratopetalum apetalum	TBR	0.9	6	5
8	Cashwood	Ceratopetalum apetalum	TBM	0.3	6	9
9	Cashwood	Ceratopetalum apetalum	TBR	0.7	10	10
10	Cashwood	Ceratopetalum apetalum	TBR	0.3	5	8
11	Cashwood	Ceratopetalum apetalum	TBR	0.6	5	4
12	Cashwood	Ceratopetalum apetalum	TBR	0.3	6	9
13	Hard Cashwood	Eucalyptus globulus	TBR	0.5	12	8
14	Turpentine	Syncarpha gummifera	TBR	0.3	0	2
15	Cabbage Palm	Listonia Australis	TBR	0.2	4	10
16	Turpentine	Syncarpha gummifera	TBR	0.3	6	10
17	Cabbage Palm	Listonia Australis	TBR	0.3	5	8
18	Cabbage Palm	Listonia Australis	TBR	0.4	5	11
19	Cabbage Palm	Listonia Australis	TBR	0.4	10	8
20	Cashwood	Ceratopetalum apetalum	TBR	0.4	5	3
21	Christmas Bush	Ceratopetalum gummifolium	TBR	0.4	7	4
22	Cabbage Palm	Listonia Australis	TBR	0.3	8	11
23	Red Bloodwood	Corymbia gummifera	TBR	0.4	2	7
24	Red Bloodwood	Corymbia gummifera	TBR	0.4	6	5
25	Turpentine	Syncarpha gummifera	TBR	1.3	8	10

No.	COMMON NAME	BOTANICAL NAME	STATISTIC	APPROX TRUNK Ø	APPROX SPREAD	APPROX HEIGHT
26	Angophora	Angophora forsteriana	TBM	0.4	10	12
27	Angophora	Angophora forsteriana	TBM	0.9	8	12
28	Angophora	Angophora forsteriana	TBR	0.8	6	9
29	Sydney peppermint	Eucalyptus piperata	TBM	0.5	6	8
30	Angophora	Angophora forsteriana	TBR	0.3	8	8
31	Red Bloodwood	Corymbia antoniana	TBR	0.6	10	14
32	Sydney peppermint	Eucalyptus piperata	TBR	0.3	8	12
33	Sydney peppermint	Eucalyptus piperata	TBR	0.6	6	9
34	Red Bloodwood	Corymbia antoniana	TBR	0.2	6	8
35	Sydney peppermint	Eucalyptus piperata	TBR	1.1	22	18
36	Sydney peppermint	Eucalyptus piperata	TBR	0.6	8	18
37	Cabbage Palm	Listonia Australis	TBR	0.9	14	16
38	Cabbage Palm	Listonia Australis	TBR	0.7	18	14
39	Cabbage Palm	Listonia Australis	TBR	0.3	5	10
40	Southern Mahogany	Eucalyptus boryoides	TBR	0.3	5	4
41	Sydney peppermint	Eucalyptus piperata	TBM	0.3	5	10
42	Sydney peppermint	Eucalyptus piperata	TBR	0.7	12	18
43	Sydney peppermint	Eucalyptus piperata	TBM	0.7	10	12
44	Sydney peppermint	Eucalyptus piperata	TBR	0.5	12	9
45	Pink Bloodwood	Eucalyptus intermedia	TBM	0.5	14	10
46	Pink Bloodwood	Eucalyptus intermedia	TBM	1.0	14	12
47	Sprited Gum	Corymbia maculata	TBM	0.4	5	10
48	Sprited Gum	Corymbia maculata	TBM	0.6	10	10
49	Sprited Gum	Corymbia maculata	TBM	0.5	8	10

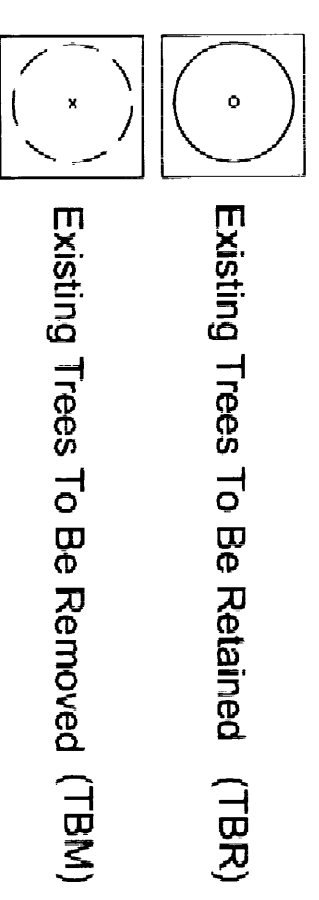

EXISTING TREE RETENTION/REMOVAL PLAN

Drawn : JH
Designed : DM
Project No. JUB 01
BAR SCALE 1:500@A0