



CONDAMINE

STREET

STREET

GRIFFITHS

SP82816

DOUBLE STOREY  
BRICK RESIDENCE  
TILE ROOF  
No.144

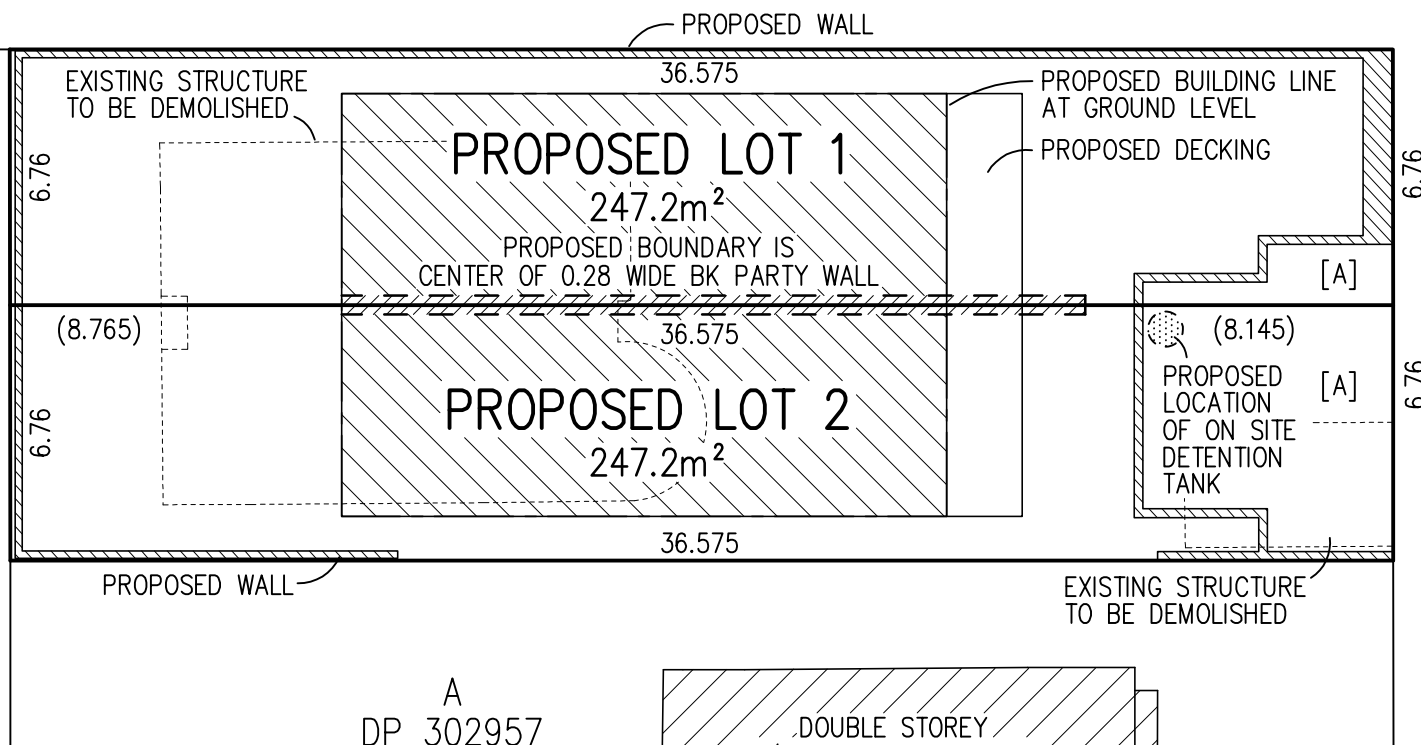

NOTE:  
AREAS & DIMENSIONS ARE SUBJECT TO FINAL SURVEY  
LOT DIMENSIONS ARE TITLE DIMENSIONS FROM DP302957  
EASEMENTS, RESTRICTIONS & COVENANTS MAY BE REQUIRED TO BE ADDED TO THE FINAL PLAN

[A] RIGHT OF CARRIAGEWAY VARIABLE WIDTH

----- LINE OF EXISTING STRUCTURE  
- - - - - LINE OF PROPOSED STRUCTURE



**TSS** TOTAL SURVEYING  
SOLUTIONS

ARTARMON | CAMDEN | MANLY VALE

### PLAN OF PROPOSED SUBDIVISION OF LOT C, DP302957

CLIENT: HARRINGTON INVESTMENT TRUST PTY

PROJECT: BALGOWLAH

ADDRESS: 107 GRIFFITHS STREET, BALGOWLAH

JOB No.: 182597

PLAN No.: 182597-2

DATE: 8/10/2019

DRAWN: RA

CHK: WH

LGA: NORTHERN BEACHES

DATUM: N/A

SCALE: 1:200@A4

CONT. INTERVAL: N/A

SHEET 1 OF 1