

NOTE:

BOUNDARIES HAVE BEEN DETERMINED BY SURVEY ON 20/09/2021.

PRIOR TO ANY CONSTRUCTION WORK, SURVEY MARKS SHOULD BE PLACED TO DEFINE THE PROPERTY BOUNDARIES.

SERVICES SHOWN ARE INDICATIVE ONLY. POSITIONS ARE BASED ON SURFACE INDICATOR(S) LOCATED DURING FIELD SURVEY. CONFIRMATION OF THE EXACT POSITION SHOULD BE MADE PRIOR TO ANY EXCAVATION WORK. OTHER SERVICES MAY EXIST WHICH ARE NOT SHOWN.

LEVELS ARE BASED ON AUSTRALIAN HEIGHT DATUM (AHD) USING SSM 14776 WITH RL 95.79 (AHD).

RIDGE & GUTTER HEIGHTS HAVE BEEN OBTAINED BY INDIRECT METHOD AND ARE ACCURATE TO ± 0.05m.

CONTOURS SHOWN DEPICT THE TOPOGRAPHY. EXCEPT AT SPOT LEVELS SHOWN THEY DO NOT REPRESENT THE EXACT LEVEL AT ANY PARTICULAR POINT. THE SPOT LEVELS ARE TRUE FOR THEIR POSITION, AND ARE INTENDED TO BE USEFUL TO REPRESENT THE GENERAL TERRAIN. CARE SHOULD BE TAKEN IF EXTRAPOLATING.

J96384 COVENANT RESERVATIONS AND CONDITIONS IN THE CROWN GRANT

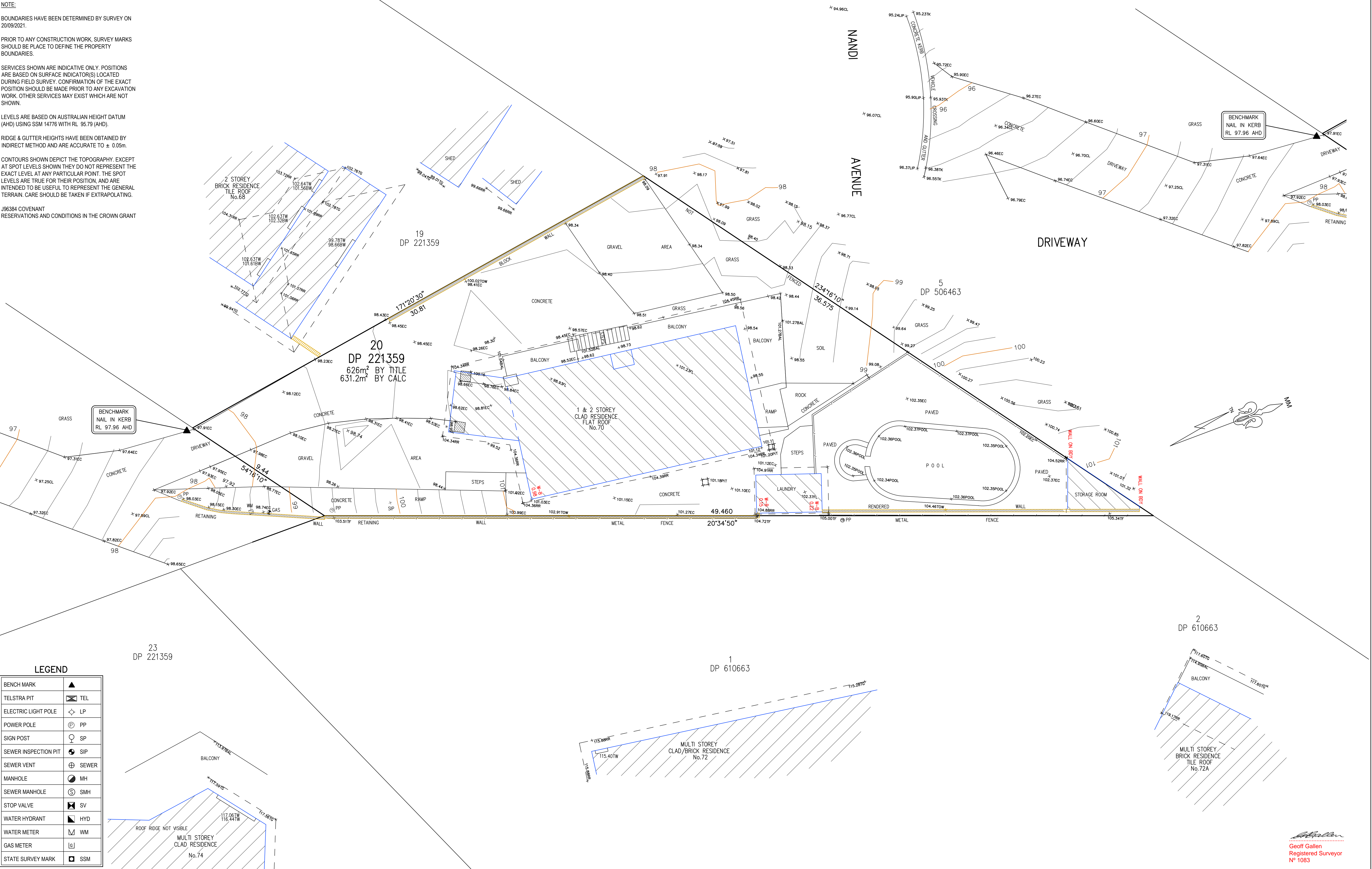

LEGEND	
BENCH MARK	▲
TELSTRA PIT	TEL
ELECTRIC LIGHT POLE	LP
POWER POLE	PP
SIGN POST	SP
SEWER INSPECTION PIT	SIP
SEWER VENT	SEWER
MANHOLE	MH
SEWER MANHOLE	SMH
STOP VALVE	SV
WATER HYDRANT	HYD
WATER METER	WM
GAS METER	GM
STATE SURVEY MARK	SSM

NOTE:

INFORMATION CONTAINED IN THIS PLAN IS THE COPYRIGHT OF TOTAL SURVEYING SOLUTIONS. THE USE OR DUPLICATION WITHOUT THE WRITTEN CONSENT OF TOTAL SURVEYING SOLUTIONS CONSTITUTES AN INFRINGEMENT OF COPYRIGHT.

REVISION No.	REVISION DATE:	COMMENT:
B	20/09/21	UPDATE DETAIL SURVEY

LEGEND:

EB - EDGE OF BITUMEN
EC - EDGE OF CONCRETE
TB - TOP OF BANK
BB - BOTTOM OF BANK
TW - TOP OF WINDOW
BW - BOTTOM OF WINDOW
TG - TOP OF GUTTER
RR - ROOF RIDGE
FL - FLOOR LEVEL
INV - INVERT LEVEL
ELEC - ELECTRICAL PIT
Ø.4/S10/H16 - DIAMETER/SPREAD/HEIGHT

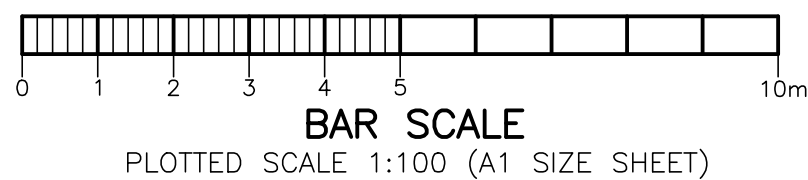

PLAN SHOWING DETAIL & LEVELS OVER LOT 20 IN DP 221359	
CLIENT: MICHAEL CIMINO	DATE: 20/09/2021
PROJECT: FRENCH FOREST	DRAWN: FS
ADDRESS: 70 NANDI AVENUE, FRENCH FOREST	CHK: DF

JOB No.: 191580	LGA-NORTHERN BEACHES
PLAN No.: 191580-C	DATUM: AHD
SCALE: 1:100@A1	CONT. INTERVAL: 0.20m
SHEET 1 OF 1	