



# Tree Removal and Tree Pruning Application

If you need help lodging your form, contact us	
<b>Email</b>	council@northernbeaches.nsw.gov.au
<b>Phone</b>	1300 434 434
<b>Customer Service Centres</b>	<b>Manly</b> Townhall, 1 Belgrave Street Manly NSW 2095
	<b>Dee Why</b> Civic Centre, 725 Pittwater Road Dee Why NSW 2099
	<b>Mona Vale</b> 1 Park Street Mona Vale NSW 2103
	<b>Avalon</b> 59A Old Barrenjoey Road Avalon Beach NSW 2107

Office use only	
<b>Form ID</b>	4000
<b>TRIM Ref</b>	C000902
<b>Last Updated</b>	24 November 2017
<b>Business Unit</b>	Parks and Recreation
<b>Application No.</b>	DA/2018/0341
<b>Receipt No.</b>	100340218

Privacy Protection Notice	
<b>Purpose of collection:</b>	For Council to provide services to the community
<b>Intended recipients:</b>	Northern Beaches Council staff
<b>Supply:</b>	If you choose not to supply your personal information, it may result in Council being unable to provide the services you seek
<b>Access/Correction:</b>	Please contact Customer Service on 1300 434 434 to access or correct your personal information

## Part 1: Applicant Details

<b>1.1 APPLICANT DETAILS</b>	
<b>Applicant name</b>	JULIE PAMELA DANKS
<b>Landowner(s) name</b>	JULIE PAMELA DANKS

<b>1.2 ADDRESS OF PROPERTY WHERE TREE(S) LOCATED</b>			
<b>Address</b>	4 KARA CRES		
<b>Suburb</b>	BAYVIEW	<b>Postcode</b>	2104
<b>Title details (Lot/DP as shown on rates notice)</b>	LOT 1 DP 237045		

<b>1.3 INSPECTION FEES (NON-REFUNDABLE)</b>			
<b>1 Tree</b>	<input checked="" type="checkbox"/>	\$150	
<b>Additional fee per tree for pruning/removal</b>	<input checked="" type="checkbox"/>	\$45 x number of additional trees =	\$45.00
<b>On site appointment</b>	<input type="checkbox"/>	\$85	<b>Total</b> \$195.00



## Part 2: Site Plan and Details

Please provide sufficient details to locate tree(s) including labeling the tree(s) numerically on the plan. It is recommended that you tie a marker to tree(s) once this application has been lodged.

Reason for application and outline of proposed work

LOOKING TOWARDS PITWATER

1) TREE ON THE LEFT HAND SIDE OF HOUSE MARKED WITH TAPE. LOOKING TO REMOVE SAME AS IT IS DEAD.

2) WATTLE TREE LOCATED ADJACENT TO THE TREE SET OUT ABOVE IN 1). SEEKING REMOVAL ON THE BASIS OF SAFETY. NOTE LARGE BRANCH OF SUCH TREE HAS PREVIOUSLY FALLEN THROUGH ROOF OF MY HOUSE. IN ADDITION MY NEIGHBOUR IS ALSO CONCERNED THAT THE TREE MAY FALL INTO HER HOUSE IN SEVERE WEATHER.

Sketch

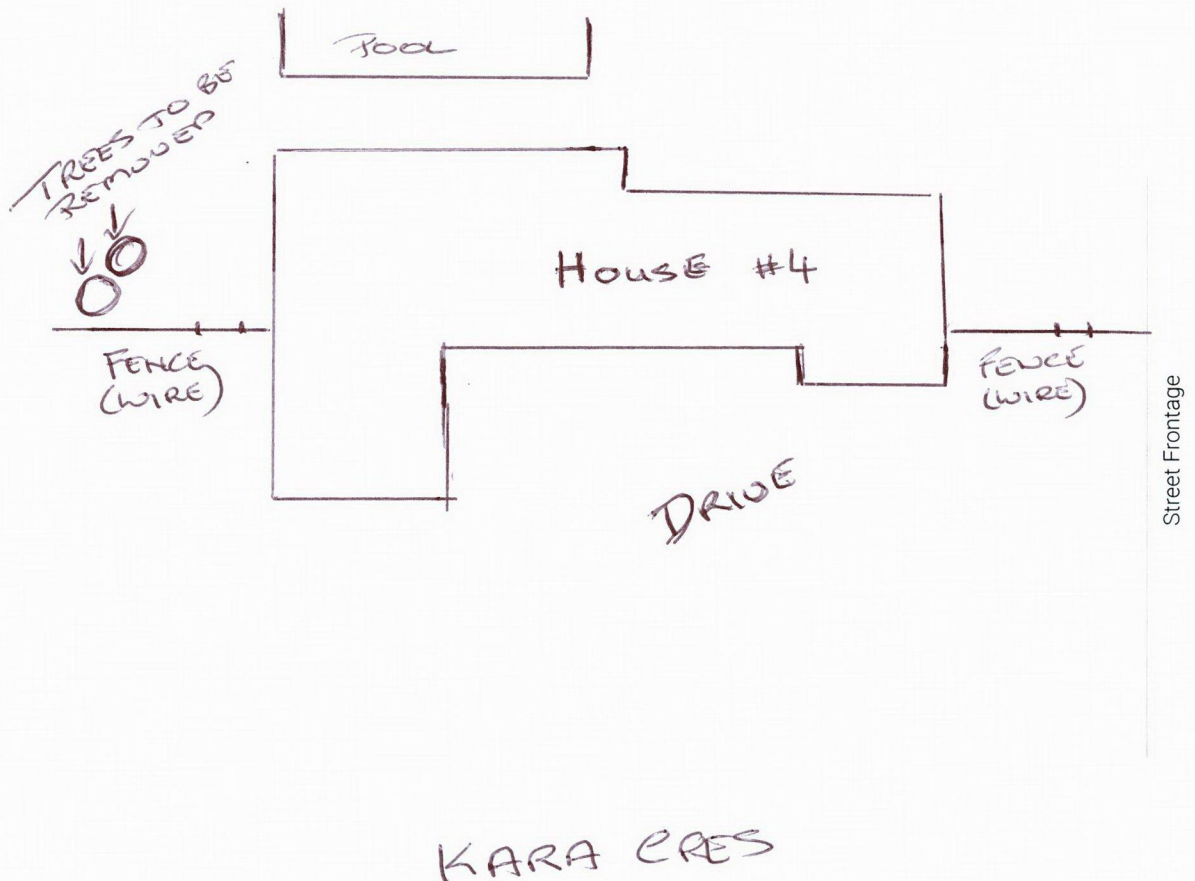

TREE AND SITE INFORMATION	
Is the tree(s) on private property? <i>(This application is only for trees on private property.)</i>	<input checked="" type="checkbox"/> Yes <input type="checkbox"/> No
Is there a dog on the property?	<input type="checkbox"/> Yes <input checked="" type="checkbox"/> No
Special arrangements required for site access	<input type="checkbox"/> Yes <input checked="" type="checkbox"/> No
If yes, please provide details	
Is there a current development application lodged for this property? <i>(Tree removal as part of a separate development application is assessed under that application and this application may not be required).</i>	<input type="checkbox"/> Yes <input checked="" type="checkbox"/> No
<ul style="list-style-type: none"> <li>• Please note trees will not be assessed under this application process for complying development.</li> <li>• Applications for removal of significant trees will require an arborist's report by an independent qualified arborist. Please attach to this application.</li> <li>• Significant trees include local endemic trees, habitat trees, heritage listed trees or trees of large amenity and visual significance.</li> <li>• Replacement trees may be a condition of approval of this application.</li> </ul>	
Please list any supporting documents attached to your application eg. engineer's report or arborist report.	