

C:\Transport_Strategies\Dropbox\view three kong\p3\Desktop\p3\PROJECT\2023\230719 - 29 Wandeen Road, Clareville\DRAWINGS\230719-05-SP.dwg
 Plotted by Meg Kong

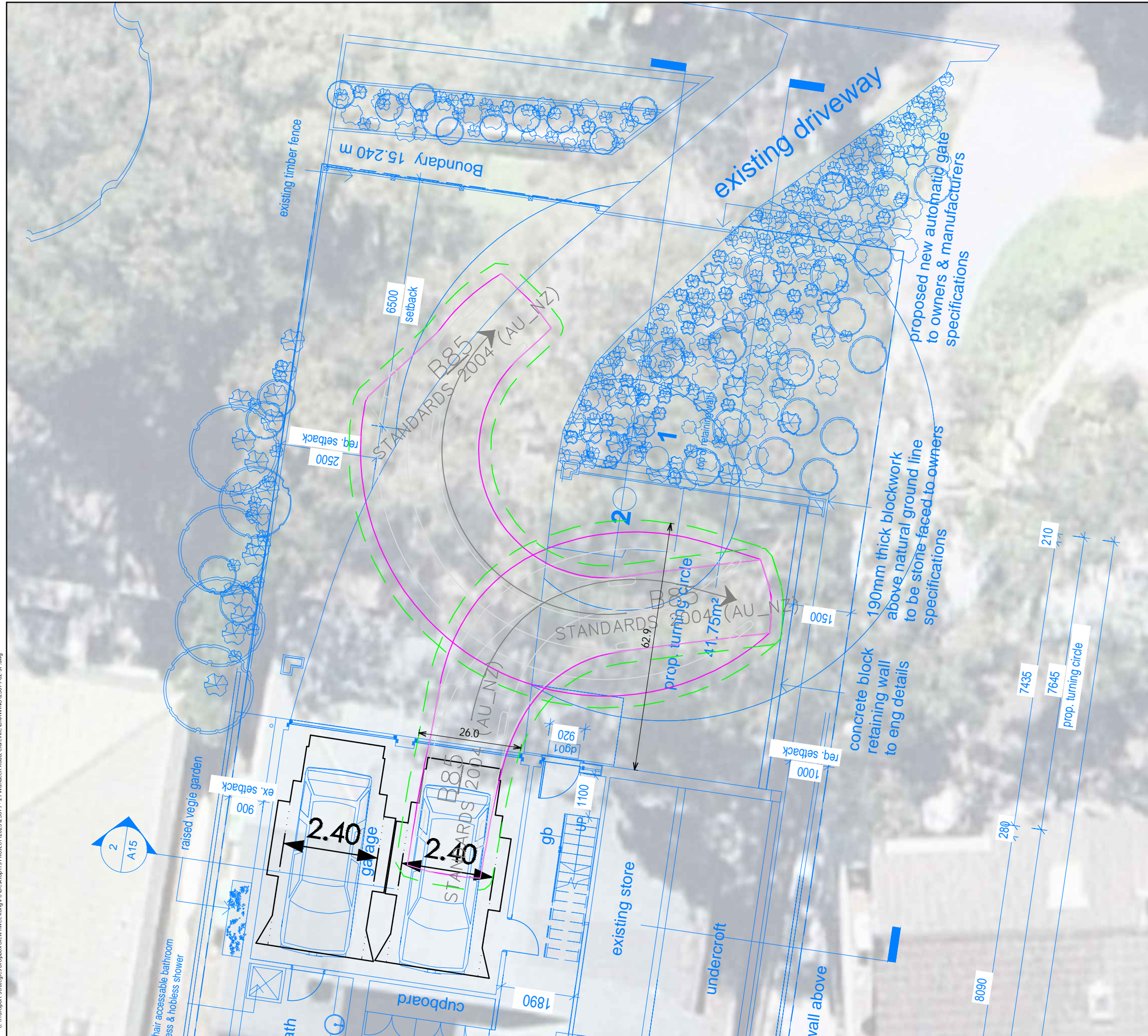

SWEPT PATH KEY:

- VEHICLE CENTRE LINE
- VEHICLE TYRE PATH
- VEHICLE BODY PATH
- - - 300mm CLEARANCE FROM VEHICLE BODY

B85

Width : 1.87 meters
 Track : 1.77
 Lock to Lock Time : 6.0
 Steering Angle : 34.1

29 WANDEEN ROAD, CLAREVILLE
 SWEPT PATH ASSESSMENT



207A/30 CAMPBELL STREET, BLACKTOWN NSW 2148
 ABN 13 254 028 433
 PHONE 0424 007 141

PRELIMINARY PLAN
 FOR DISCUSSION PURPOSES
 ONLY SUBJECT TO CHANGE
 WITHOUT NOTIFICATION

23079-02-SP
 01 OF 04
 11 May 2023

DESIGNED BY
 A.SYAFIQ

APPROVED BY
 M.KONG

SCALE
 A3 0 10 20 1:100