

northern beaches council

THIS PLAN IS TO BE READ IN CONJUNCTION WITH THE CONDITIONS OF DEVELOPMENT CONSENT

DA2023/1216

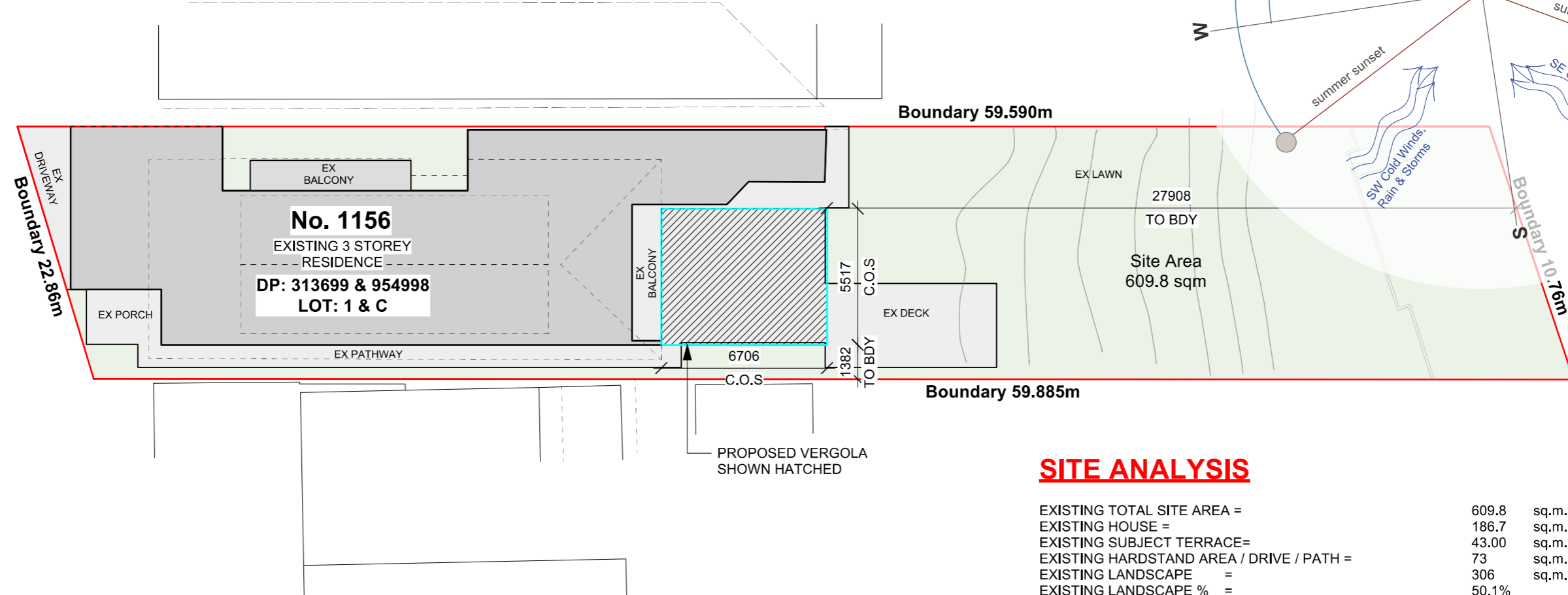
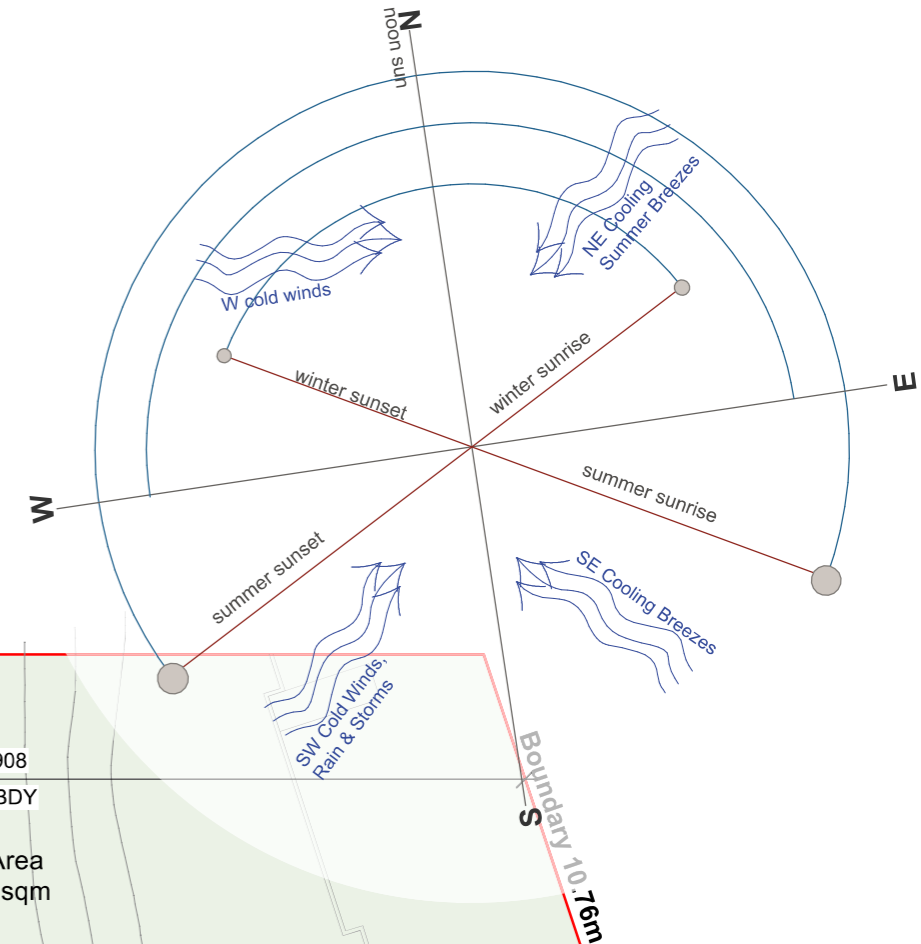

SITE ANALYSIS

| | | |
|--|-------|-------|
| EXISTING TOTAL SITE AREA = | 609.8 | sq.m. |
| EXISTING HOUSE = | 186.7 | sq.m. |
| EXISTING SUBJECT TERRACE= | 43.00 | sq.m. |
| EXISTING HARDSTAND AREA / DRIVE / PATH = | 73 | sq.m. |
| EXISTING LANDSCAPE = | 306 | sq.m. |
| EXISTING LANDSCAPE % = | 50.1% | |
| EXISTING PRIVATE SPACE = | >30 | sq.m. |

PROPOSED VERGOLA = 37.00 sq.m.

| | | |
|---------------------------------------|---|------------------|
| PROPOSED ADDITIONAL ROOF COVERAGE = | 0 | sq.m. |
| PROPOSED ADDITIONAL LANDSCAPE COVER = | 0 | sq.m.(NO CHANGE) |

NOTES:-
 AS THE PROPOSED VERGOLA IS TO BE BUILT OVER AN EXISTING HARDSTAND AREA, THERE WILL BE NO INCREASE IN THE EXISTING SITE COVERAGE.
 ALL DOWNPIPES TO BE DIRECTED INTO THE EXISTING STORMWATER DISPOSAL SYSTEM.
 ALL DIMENSIONS ARE TO BE CONFIRMED WITH A SITE MEASURE PRIOR TO MANUFACTURE.

EXISTING SITE PLAN

Scale 1:200

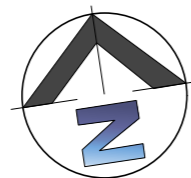

ALL MEASUREMENTS TO BE VERIFIED AT C/M

GENERAL NOTES
 All work to be carried out in accordance with the Building Code of Australia, all Local and State Government Ordinances, relevant Australian Standards, Local Electricity and Water Authorities Regulations and all other relevant Authorities concerned.
 All timbers to be in accordance with SAA Timber Structure Code AS1720 and SAA Timber Framing Code AS 1684.
 All work to be carried out in a professional and workmanlike manner according to the plans and specification.
 Do not scale off the drawings unless otherwise stated and use figured dimensions in preference.
 All dimensions are to be checked and verified on site before the commencement of any work.
 Locate and protect all services prior to construction.



VERGOLA
 (NSW) PTY. LTD.
 7 TEPKO ROAD TERREY HILLS NSW 2084
 TEL: (02) 9450 3300
 FAX: (02) 9450 3333

Project:
PROPOSED VERGOLA LOUVERED ROOF SYSTEM AT EXISTING RESIDENCE
 Client:
CHARLES & JOANNE HOATSON
 Address:
1156 PITWATER ROAD COLLAROY - NSW - 2097

| | | | |
|--------------------|---------------|--------------|--------|
| DATE DRAFTED | 15-08-23 | AMENDED DATE | A - |
| SALES REP. | B.P. | | B - |
| | | | C - |
| DRAWN | JGW/AC | SHEET No. | 1 OF 5 |
| DRAWING No. | 19528 | DATE SIGNED | |
| SCALE. | AS NOTED @ A3 | | |
| CLIENT'S SIGNATURE | | | |

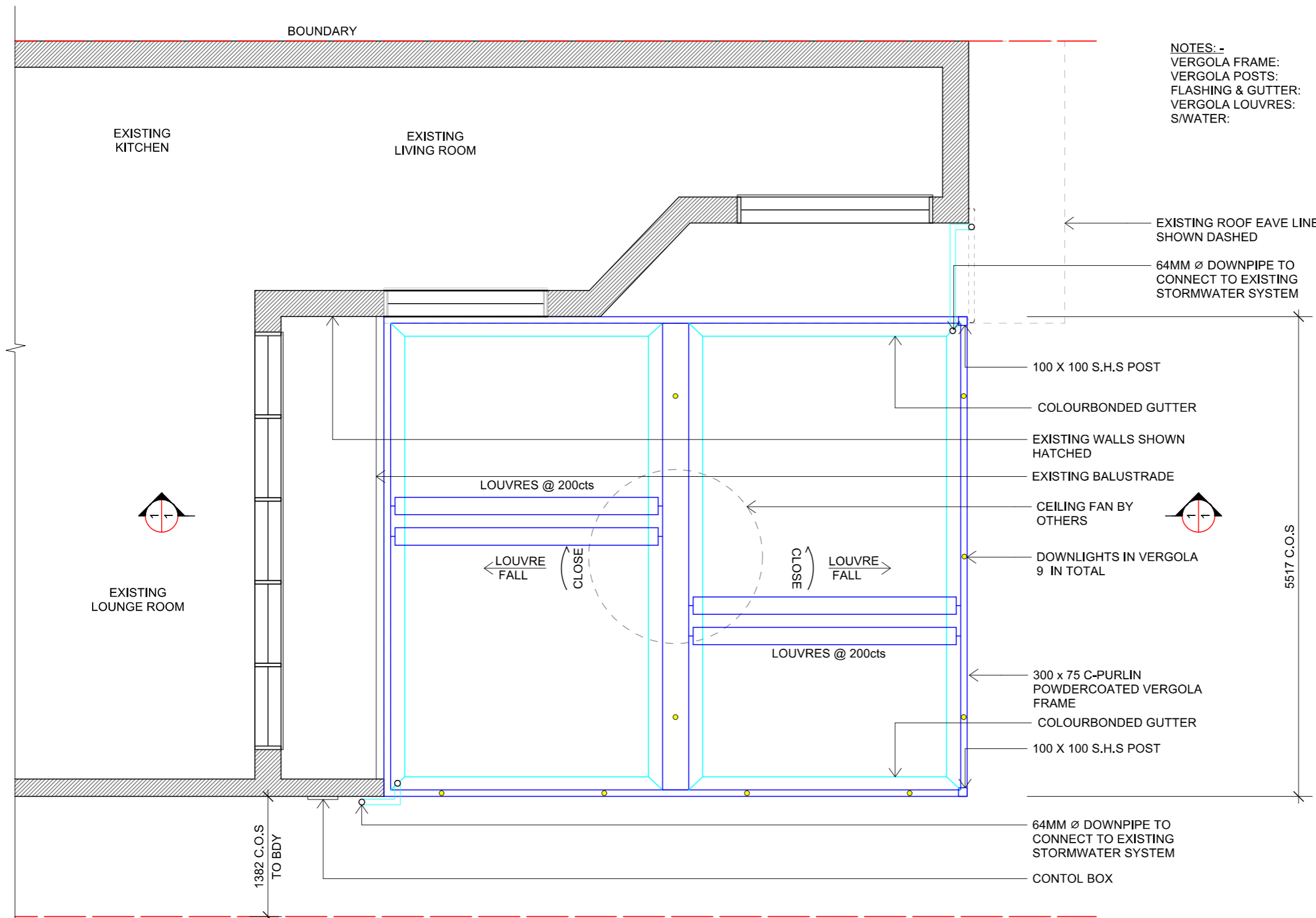

NOTES: -
 VERGOLA FRAME:
 VERGOLA POSTS:
 FLASHING & GUTTER:
 VERGOLA LOUVRES:
 S/WATER:

POWDERCOAT FRAME "SURFMIST" COLOUR FINISH
 POWDERCOAT "SURFMIST" COLOUR FINISH
 MADE IN COLORBOND COLOUR "SURFMIST"
 MADE IN COLORBOND COLOUR "MONUMENT"
 64mm PVC DOWNPIPE TO EXISTING GUTTER &
 STORMWATER SYSTEM WITH PAINT COLOUR "SURFMIST"

EXISTING ROOF EAVE LINE SHOWN DASHED
 64MM Ø DOWNPIPE TO CONNECT TO EXISTING STORMWATER SYSTEM

100 X 100 S.H.S POST
 COLOURBONDED GUTTER
 EXISTING WALLS SHOWN HATCHED
 EXISTING BALUSTRADE
 CEILING FAN BY OTHERS
 DOWNLIGHTS IN VERGOLA 9 IN TOTAL
 300 x 75 C-PURLIN POWDERCOATED VERGOLA FRAME
 COLOURBONDED GUTTER
 100 X 100 S.H.S POST

5517 C.O.S

1382 C.O.S TO BDY

BOUNDARY 6706 C.O.S 27908 C.O.S TO BDY

PLAN
 SCALE 1:50

northern beaches council
THIS PLAN IS TO BE READ IN CONJUNCTION WITH THE CONDITIONS OF DEVELOPMENT CONSENT
DA2023/1216

LEGEND:
 METAL-STEEL FRAME/ "VERGOLA" - PAINTED -
 METAL DOWNPIPE/ GUTTERS - PAINTED

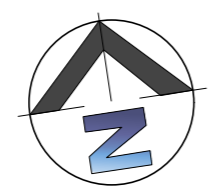

ALL MEASUREMENTS TO BE VERIFIED AT C/M

GENERAL NOTES
 All work to be carried out in accordance with the Building Code of Australia, all Local and State Government Ordinances, relevant Australian Standards, Local Electricity and Water Authorities Regulations and all other relevant Authorities concerned.
 All timbers to be in accordance with SAA Timber Structure Code AS1720 and SAA Timber Framing Code AS 1684.
 All work to be carried out in a professional and workmanlike manner according to the plans and specification.
 Do not scale off the drawings unless otherwise stated and use figured dimensions in preference.
 All dimensions are to be checked and verified on site before the commencement of any work.
 Locate and protect all services prior to construction.



7 TEPKO ROAD TERREY HILLS NSW 2084
 TEL: (02) 9450 3300
 FAX: (02) 9450 3333

Project:
PROPOSED VERGOLA LOUVERED ROOF SYSTEM AT EXISTING RESIDENCE
 Client:
CHARLES & JOANNE HOATSON
 Address:
1156 PITTWATER ROAD COLLARROY - NSW - 2097

| | | | |
|--------------------|---------------|--------------|--------|
| DATE DRAFTED | 15-08-23 | AMENDED DATE | A - |
| SALES REP. | B.P. | | B - |
| DRAWN | JGW/AC | SHEET No. | 2 OF 5 |
| DRAWING No. | 19528 | DATE SIGNED | |
| SCALE | AS NOTED @ A3 | | |
| CLIENT'S SIGNATURE | | | |



THIS PLAN IS TO BE READ IN CONJUNCTION WITH THE CONDITIONS OF DEVELOPMENT CONSENT

DA2023/1216

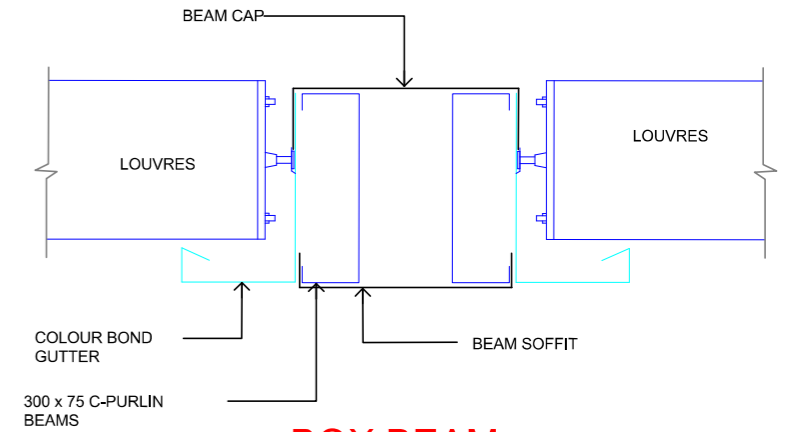
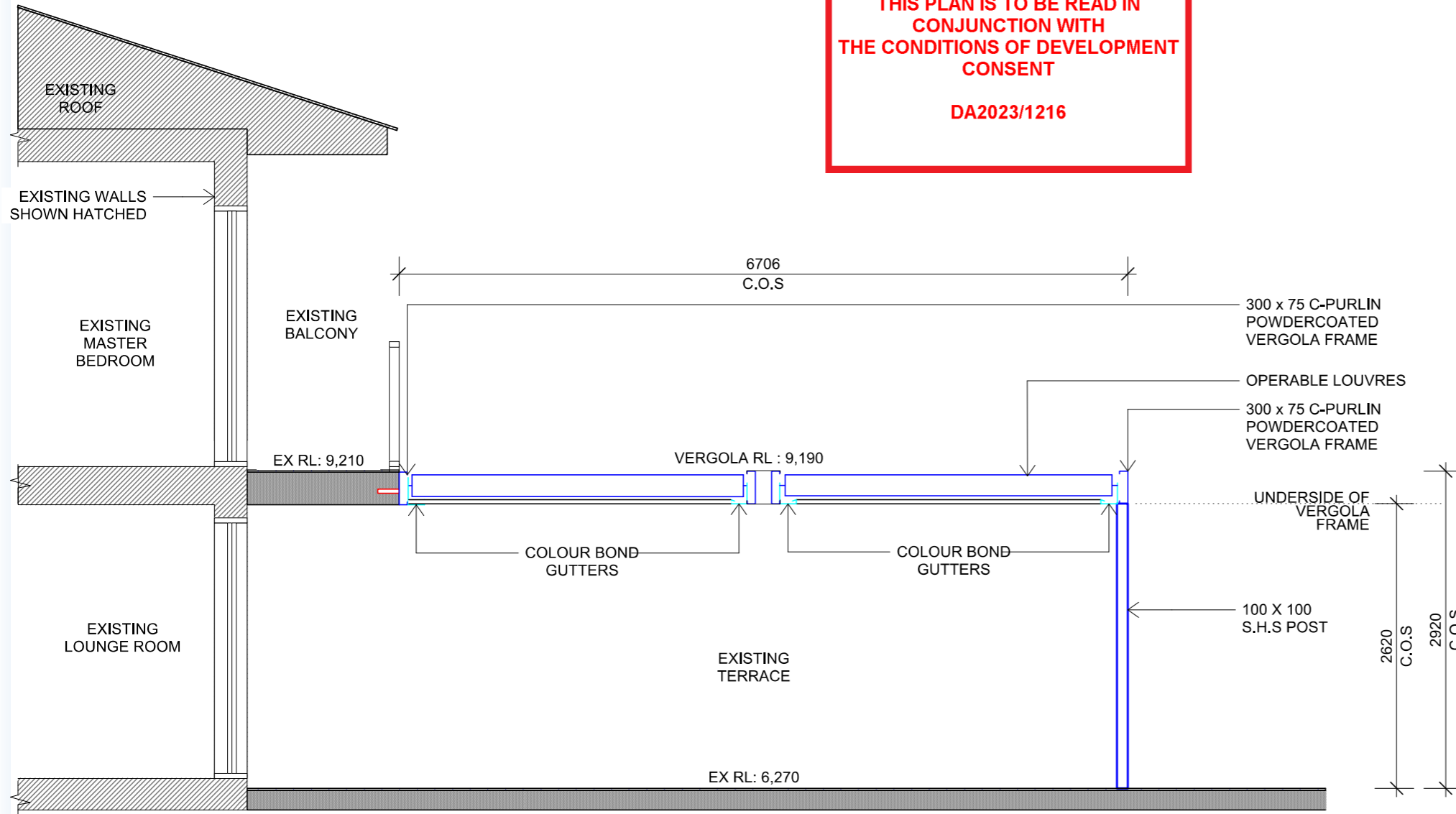

**BOX BEAM
DETAIL
SCALE 1:10**

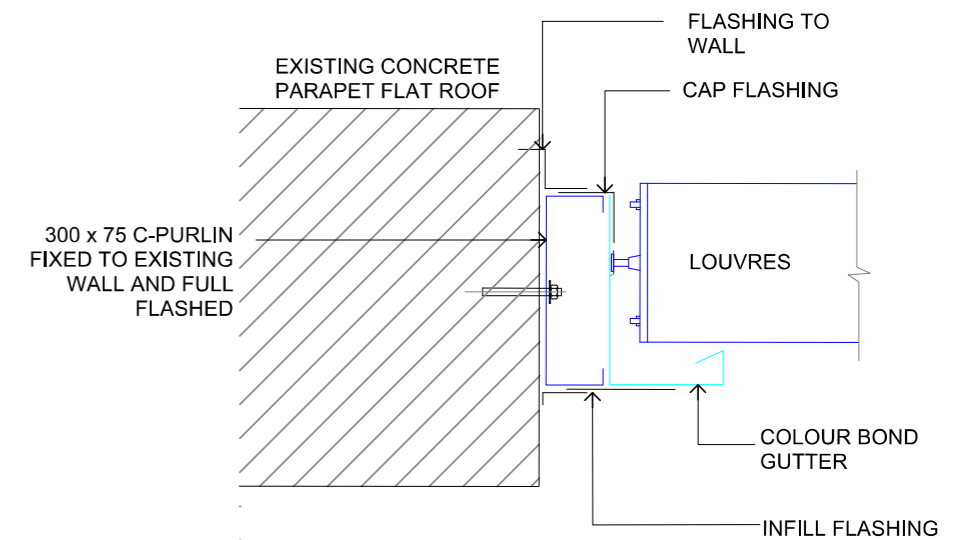

**FIXING DETAIL
SCALE 1:10**

**SECTION
SCALE 1:50**

LEGEND:

| | |
|--|--|
| | METAL-STEEL FRAME/ "VERGOLA" - PAINTED - |
| | METAL DOWNPIPE/ GUTTERS - PAINTED |

ALL MEASUREMENTS TO BE VERIFIED AT C/M

GENERAL NOTES
 All work to be carried out in accordance with the Building Code of Australia, all Local and State Government Ordinances, relevant Australian Standards, Local Electricity and Water Authorities Regulations and all other relevant Authorities concerned.
 All timbers to be in accordance with SAA Timber Structure Code AS1720 and SAA Timber Framing Code AS 1684.
 All work to be carried out in a professional and workmanlike manner according to the plans and specification.
 Do not scale off the drawings unless otherwise stated and use figured dimensions in preference.
 All dimensions are to be checked and verified on site before the commencement of any work.
 Locate and protect all services prior to construction.



7 TEPKO ROAD TERREY HILLS NSW 2084
 TEL: (02) 9450 3300
 FAX: (02) 9450 3333

Project:
PROPOSED VERGOLA LOUVERED ROOF SYSTEM AT EXISTING RESIDENCE
 Client:
CHARLES & JOANNE HOATSON
 Address:
1156 PITTWATER ROAD COLLARROY - NSW - 2097

| | | | |
|--------------------|---------------|--------------|--------|
| DATE DRAFTED | 15-08-23 | AMENDED DATE | A - |
| SALES REP. | B.P. | | B - |
| | | | C - |
| DRAWN | JGW/AC | SHEET No. | 3 OF 5 |
| DRAWING No. | 19528 | DATE SIGNED | |
| SCALE | AS NOTED @ A3 | | |
| CLIENT'S SIGNATURE | | | |



**THIS PLAN IS TO BE READ IN
CONJUNCTION WITH
THE CONDITIONS OF DEVELOPMENT
CONSENT**

DA2023/1216

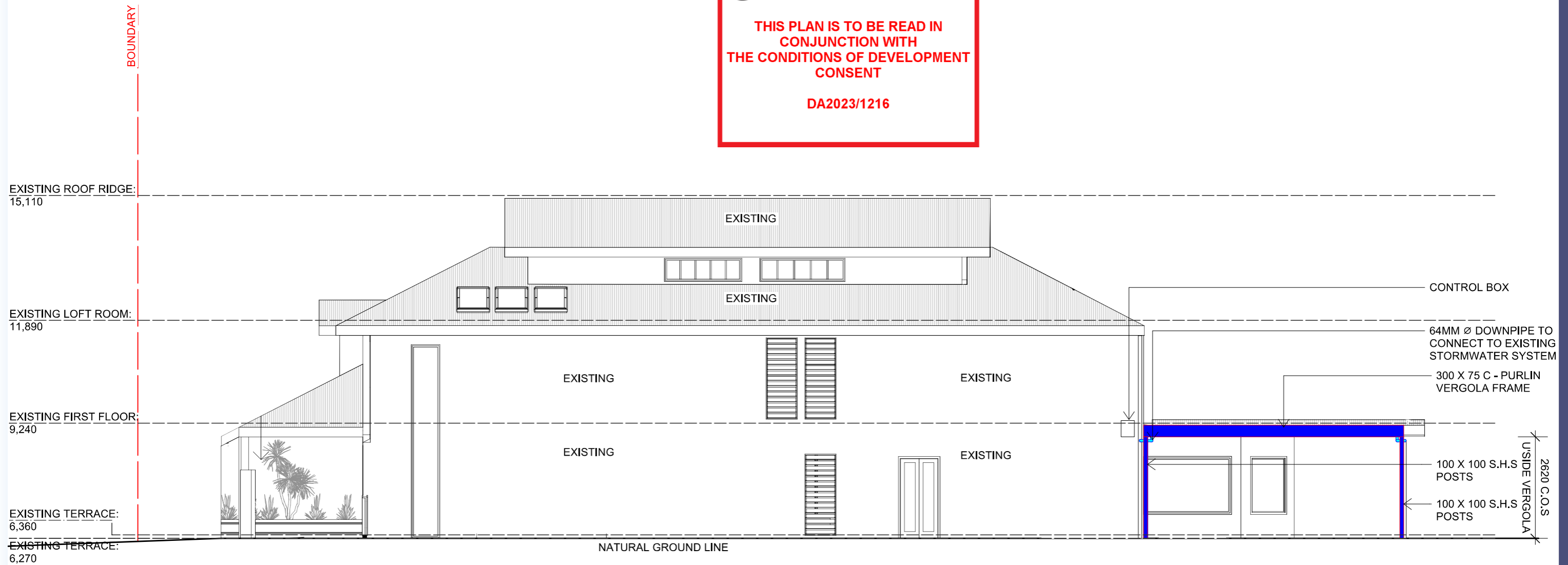

SOUTHERN ELEVATION

SCALE 1:100

LEGEND:

| | |
|--|---|
| | METAL-STEEL FRAME/ "VERGOLA" - PAINTED - |
| | METAL DOWNPIPE/ GUTTERS - PAINTED |

**ALL MEASUREMENTS TO
BE VERIFIED AT C/M**

GENERAL NOTES

All work to be carried out in accordance with the Building Code of Australia, all Local and State Government Ordinances, relevant Australian Standards, Local Electricity and Water Authorities Regulations and all other relevant Authorities concerned.
All timbers to be in accordance with SAA Timber Structure Code AS1720 and SAA Timber Framing Code AS 1684.
All work to be carried out in a professional and workmanlike manner according to the plans and specification.
Do not scale off the drawings unless otherwise stated and use figured dimensions in preference.
All dimensions are to be checked and verified on site before the commencement of any work.
Locate and protect all services prior to construction.



(NSW) PTY. LTD.

7 TEPKO ROAD TERREY HILLS NSW 2084
TEL: (02) 9450 3300
FAX: (02) 9450 3333

Project:

**PROPOSED VERGOLA
LOUVERED ROOF SYSTEM
AT EXISTING RESIDENCE**

Client:

CHARLES & JOANNE HOATSON

Address:

**1156 PITTWATER ROAD
COLLARROY - NSW - 2097**

| | | | |
|--------------------|---------------|--------------|--------|
| DATE DRAFTED | 15-08-23 | AMENDED DATE | A - |
| SALES REP. | B.P. | | B - |
| | | | C - |
| DRAWN | JGW/AC | SHEET No. | 4 OF 5 |
| DRAWING No. | 19528 | DATE SIGNED | |
| SCALE. | AS NOTED @ A3 | | |
| CLIENT'S SIGNATURE | | | |

 northern
beaches
council

**THIS PLAN IS TO BE READ IN
CONJUNCTION WITH
THE CONDITIONS OF DEVELOPMENT
CONSENT**

DA2023/1216

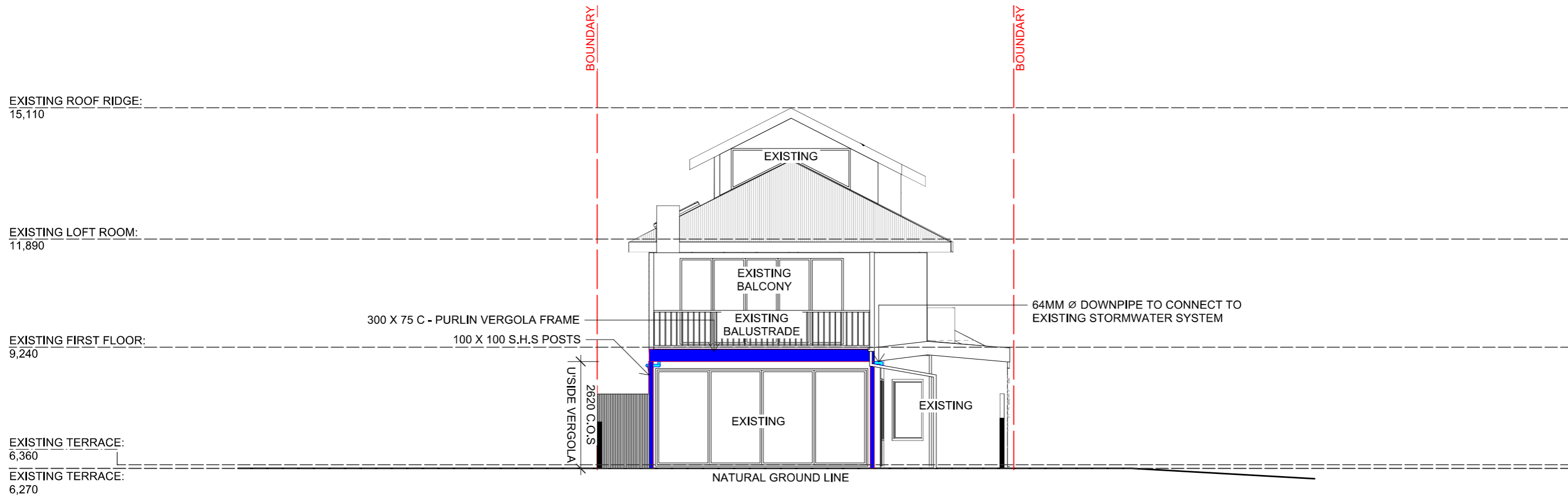

EASTERN ELEVATION

SCALE 1:100

LEGEND:

| | |
|---|---|
|  | METAL-STEEL FRAME/ "VERGOLA" - PAINTED - |
|  | METAL DOWNPIPE/ GUTTERS - PAINTED |

**ALL MEASUREMENTS TO
BE VERIFIED AT C/M**

GENERAL NOTES
 All work to be carried out in accordance with the Building Code of Australia, all Local and State Government Ordinances, relevant Australian Standards, Local Electricity and Water Authorities Regulations and all other relevant Authorities concerned.
 All timbers to be in accordance with SAA Timber Structure Code AS1720 and SAA Timber Framing Code AS 1684.
 All work to be carried out in a professional and workmanlike manner according to the plans and specification.
 Do not scale off the drawings unless otherwise stated and use figured dimensions in preference.
 All dimensions are to be checked and verified on site before the commencement of any work.
 Locate and protect all services prior to construction.

VERGOLA
 (NSW) PTY. LTD.
 7 TEPKO ROAD TERREY HILLS NSW 2084
 TEL: (02) 9450 3300
 FAX: (02) 9450 3333

Project:
**PROPOSED VERGOLA
LOUVERED ROOF SYSTEM
AT EXISTING RESIDENCE**
 Client:
CHARLES & JOANNE HOATSON
 Address:
**1156 PITTWATER ROAD
COLLARROY - NSW - 2097**

| | | | |
|--------------------|---------------|--------------|--------|
| DATE DRAFTED | 15-08-23 | AMENDED DATE | A - |
| SALES REP. | B.P. | | B - |
| | | | C - |
| DRAWN | JGW/AC | SHEET No. | 6 OF 5 |
| DRAWING No. | 19528 | DATE SIGNED | |
| SCALE. | AS NOTED @ A3 | | |
| CLIENT'S SIGNATURE | | | |