

The Drop

STATEMENT OF ENVIRONMENTAL EFFECTS

The Drop Festival

KEIRLE PARK,

MANLY NSW

Saturday 14th March 2020

This document has been prepared for key stakeholders as part of the planning and development application process of the proposed event and is subject to revision.

VERSION 3

Revised: 27th February 2020

Table of Contents

1. Letter of Intention	2
2. Event Overview	3
3. Our Commitment to Excellence	4
4. Festival Infrastructure And Overlay	4
5. Festival Layout	6
6. Sustainable Event Management	7
7. Noise Management	7
8. Waste Management	8
9. Fuel Generation Carbon Reduction (Pollution Waste Management)	10
10. Amenities / Toilets Waste (Pollution Waste Management)	10
11. Transport & Access Management, Public and Patron safety	11
12. Food, Beverages & Merchandise	13
13. Contingencies in the Event of Emergencies, Cancellation or Postponement	13
14. Site Suitability	13
15. Potential Environmental Impacts	14
16. Building & Infrastructure works	14

1. Letter of Intention

The Drop Music Festival Pty Ltd
23 Lamrock Ave, Bondi Beach
NSW 2026

To whom it may concern,

The Drop Music Festival are proposing to Stage the second iteration of their Manly, Northern Beaches event on Saturday 14th March 2020, with a capacity of 7,000 persons.

Presented in conjunction with World Surf League's and annual Sydney Pro Competition (Manly), The Drop Festival is yet another way to promote the Northern Beaches on the world map.

The Drop Festival 2020 is designed as a summer experience encompassing all areas of entertainment from showcasing current international music artists, in addition to the entertainment of the professional surfing competition.

The festival promotes Manly to the world map through music, assisting with growth and development of the community, attracting people to the region and a larger volume of visitors to the area from around Australia.

The Drop Music Festival provides support to the local businesses and economy, by engaging local suppliers whom are able to supply services to the event.

The festival will be delivered as 18+ Licensed event, with prices on sale at \$99.00 – \$109.00 for 18+ General Admission

Understanding Manly's iconic status, we appreciate the variety of public and private components associated with holding a ticketed festival in this area, which is reflected in our planning. We endeavor to provide an event that satisfies the requirements of the Northern Beaches Council and minimizes impact to local residents.

Sincerely,



Jeremy Stones

Event Operations Manager

The Drop Music Festival Pty Ltd.

2. Event Overview

Event Name:	The Drop Festival 2020
Event Date:	Saturday 14 th March, 2020
Proposed Venue:	Keirle Park, Manly, NSW
Venue Owner:	Northern Beaches Council
Event Operating Hours:	13:00 to 22:30
Music Curfew:	22:00
Estimated Attendance:	4,500 - 5,000
Proposed Capacity:	7,000
Ticketed Event:	Pre-Purchase & Door Sales (Unless Sold Out)
Ticket Price:	\$99.00 - \$109.00
Licensed Event:	Yes (Service of alcohol to finish @ 21:30)
Age Restriction:	Licensed 18+

Dates of Occupation:

Date	Activity	Times
Tuesday 10 th March 2020	Site Markup, Site Build, Plant Deliveries	07:00 to 19:00
Wednesday 11 th March 2020	Stage Build, Site Build & Temp Structures	07:00 to 19:00
Thursday 12 th March 2020	Stage Build, Site Build & Stock Deliveries	07:00 to 19:00
Friday 13 th March 2020	Production Load In, Site Dress & Stock	07:00 to 19:00
	Audio System Checks & PA Time Align	15:00 to 17:00
Saturday 14 th March 2020	Site Lighting Test, Stage Lighting Focus	19:00 to 21:30
	Vendors, Site Dress, Signage, Final Checks	07:00 to 12:00
	Audio Sound Checks @ 95%	09:30 to 11:30
	Show Level Amplification	11:30 to 22:00
	Event Open	13:00 to 22:30
	Load Out Production & Vendors	22:30 to 02:00 (+1)
Sunday 15 th March 2020	Load Out Site & Staging	07:00 to 19:00
Monday 16 th March 2020	Load Out Site & Staging	07:00 to 17:00
	Final Sweep & Venue Handover	17:00 to 19:00

3. Our Commitment to Excellence

KEY COMMITMENTS INCLUDE

- Acceptance of ongoing commitment to planning consultation.
- Compliance with Northern Beaches Council control measures.
- Structures built & erected in accordance to design certificates
- Festival dedicated NSW user pay police officers
- Comprehensive onsite medical and harm minimisation services, including user pays NSW Ambulance.
- Licensed security officer's deployment linked to attendance figures
- A limited licensed bar area operated by specialist festival bar provider
- A comprehensive site safety management system for construction, production and deconstruction.
- A comprehensive sustainability (environmental) management system across all festival operations.
- Sims Events & Entertainment Pty Ltd practices and supports sustainable event management and will ensure The Drop Music Festival's benchmark environmental protection processes (Waste management, designated shuttle buses, local procurement where available).

4. Festival Infrastructure And Overlay

The event precinct created by The Drop will be created by the installation of temporary structures such as stages, marquee structures, portable buildings, outdoor furniture, shade elements and food and beverage areas. Additional physical overlay will include plant equipment, fencing, amenities, generators & power distribution and production requirements. All structures are designed and installed according to engineering specifications.

The following infrastructure will be brought into the site for the festival:

- 2.4m non-climbable temporary fence, to secure the event perimeter
- 1.8m mesh panel fencing surrounding to zone of internal infrastructure & create BOH Area
- Crowd control fencing
- Crowd stage barrier
- Generators & power distribution
- Food service vans
- Bar fronts service infrastructure
- Merchandise outlet
- Entry & exit points
- Event "Chillout" and peer education zones
- Adequate provision of shade
- Adequate provision of free water stations
- Event Medical Area
- Event Police Compound
- Sponsor / Brand Activations
- 6m x 3m site sheds for offices, talent and green rooms
- Portaloo's (including accessible toilets), Urinals, Handwash Stations & other amenities

The primary power source for the festival will be provided by generators. The main stage generators will power the stage and related production elements. All other infrastructure will be powered by a mix of existing ground power & generators.

5. Festival Layout

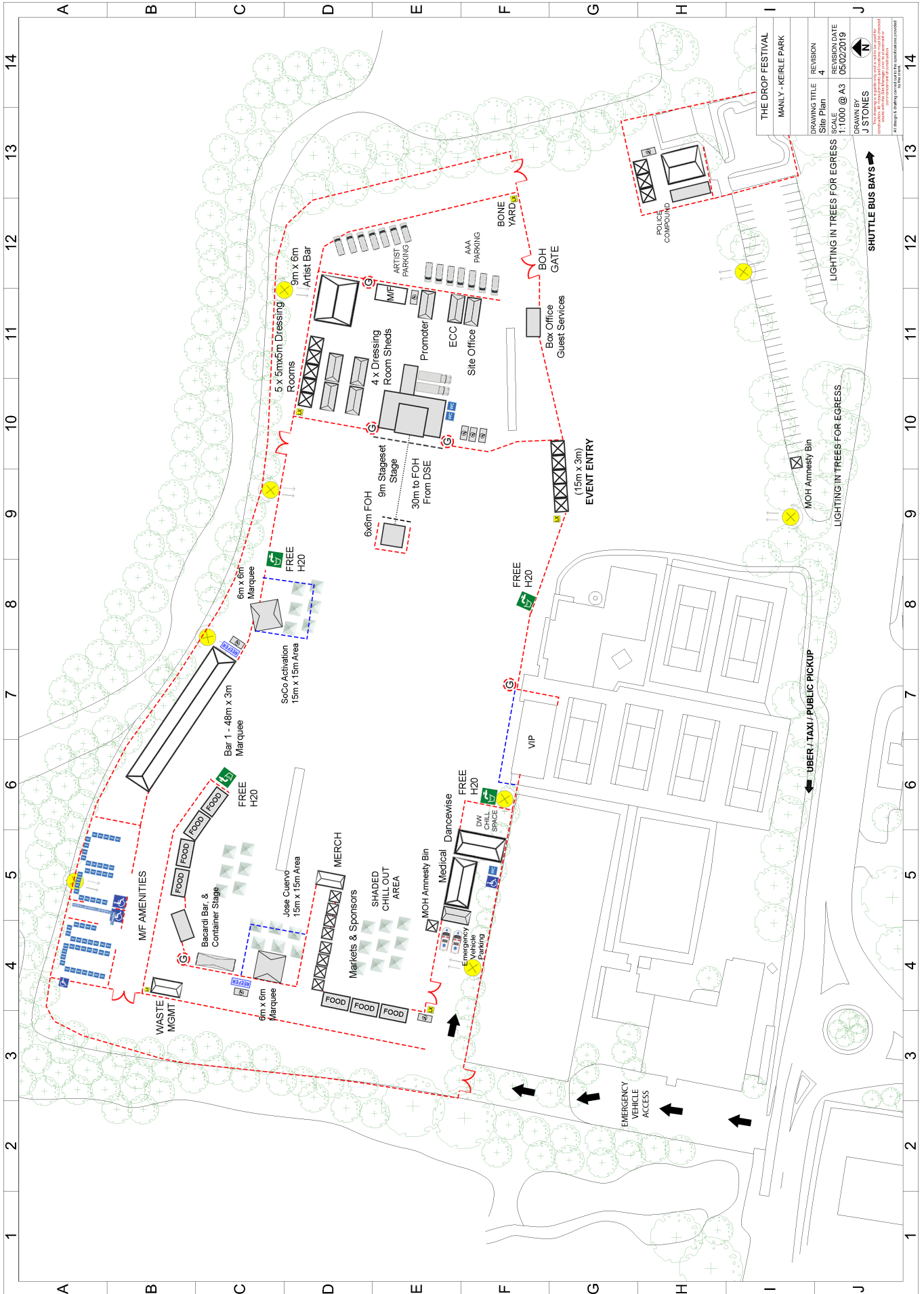

THE DROP 2020 – SoEE – Manly V3 – COMMERCIAL IN CONFIDENCE
 Authored by Jeremy Stones – jeremy@thedropfestival.com // +61 401 422 696

6. Sustainable Event Management

The Drop demonstrates a commitment to sustainable event management and the impacts that events may have on the economic, environmental and social aspects of local communities. Management teams frequently consider the diverse effects, which events have on the environment, pursuing efforts to adopt best practice, sustainable processes and outcomes. Strategic management can also increase the efficiency & cost effectiveness of event implementation.

The Drop will include the following factors to assess the environmental impact:

- Waste Impacts
- Waste Management
- Waste and landfill Reduction
- Waste Recycling
- Environmental Impacts
- Preventing Pollution
- Biodiversity protection Keirle Park
- Noise & Sound Pollution
- Energy Impacts
- Water Impacts
- Transport & Travel Impacts
- Food & Drink Impacts

7. Noise Management

The festival will consist of live music performances. The sound equipment to be used at the festival will be consistent with the requirements of a typical outdoor festival for 7,000 people. The production specifications can be provided upon request if required.

The times for amplified sound to be used at the festival are as follows:

Friday 13th March

- 15:00 – 18:00: Audio System Checks & PA Time Align (95% of show level)

Saturday 14th March

- 10:00 – 13:00: Intermittent sound checking (95% of show level)
- 13:00 – 22:00: Music performances

Noise limit criteria set by the Local Government Act and EPA are designed to protect the amenity around venues that operate on a daily basis and not for one off outdoor events. Noise Consulting & Management Pty Ltd has been engaged to analyse and prepare recommendations and controls regarding music noise for this event.

A noise management plan will outline contains the abatement measures to ensure that the festival adheres to the proposed noise limit. The series of actions outlined in the noise management plan will be implemented to minimise the impact of noise on nearby residences during the event.

The Drop Music Festival has setup an event noise complaint hotline, which will be provided closer to the event day. This number will go out to the residents during our letterbox drop about the event, we will also place a public notice into the local online noticeboards and publish newspaper notifications.

8. Waste Management

The Festivals cleaning and waste management contractor; Clean Vibes are passionate about sustainability and our environment which is why Clean Vibes' waste management objective at the Drop Festivals is to implement a plan which will yield high volumes of diversion from landfill through increased recycling and biodegradable waste management strategies.

Minimizing and controlling what comes on to site ultimately affects what comes out, which is why Clean Vibes will work with all stakeholders to ensure that our most effective plan is executed by all parties throughout all phases of the event.

Efforts include liaison with festival organizers, contractors and vendors to ensure they are adhering to strict sustainability requirements, such as minimal to zero plastic distribution across site, enforcing alternatives such as biodegradable cardboard, wood or bamboo packaging and cutlery. Additional efforts include auditing and enforcing these requirements from planning to event delivery stages.

KEY PERFORMANCE INDICATORS

1. Patrons have adequate receptacles for recyclable material in all patron areas and for general waste at appropriate areas such as food outlets and bars.
2. Vendors have well-labelled and appropriate receptacles for recyclable materials and general waste.
3. All Clean Vibes staff are aware of the waste objective and are trained in the waste system as implemented.
4. Vendors are aware of the waste objective and understand the waste management system and requirements.
5. General cleanliness of the site, at all times, does not deteriorate as a result of implementing this plan.
6. Opportunities for improvement for future years are identified.
7. A report is provided to event organisers within two weeks of the completion of the event

BUMP IN & BUMP OUT PHASE:

- 240L general waste and commingled waste bins will be paired up and strategically placed around site to capture waste from vendors and contractors onsite.
- 1x general waste 25mtr skip will be placed as per the Bin allocation maps.
- 1x commingled recycling 25mtr skip will be placed as per the Bin allocation maps.

EVENT PHASE: FOH WASTE

240L bins will be paired up and strategically placed around the site to capture waste from patrons. Cleaning staff will service the bins the duration of the event prior to being full by removing and replacing the bin liner. The Waste removed will then be transported to the corresponding skip for storage prior to it being removed from site.

EVENT PHASE: BOH WASTE

1100L bins will be distributed around site as per the Bin allocation maps. Bins will be monitored by the Cleaning manager and a service request given to cleaning staff before becoming full and transported to the 1100Ls bins for storage prior to being disposed into the corresponding skip for storage prior to it being removed from site. 240L Food waste bins will be placed behind food vendors and serviced post event.

RESPONSIBILITIES

Clean Vibes management will have the following responsibilities for delivery of this waste plan:

- Implement this plan
- Liaise with client on issues arising during the event
- Liaise with Waste service provider
- Ensure Clean Vibes staff are appropriately trained to deliver on this plan
- Liaise with event caterers and beverage staff to ensure their appropriate contribution
- Note issues for future years
- Prepare event waste and recycling report
- Prepare plan for next year's event, taking account of 2019 experience.

9. Fuel Generation Carbon Reduction (Pollution Waste Management)

Carbon emissions are contribute a large portion of the effect the event has on the environment. The Drop Festival looks to minimise emissions from fuel usage from machinery and generators by utilising existing ground power wherever possible. For Generator load will be reduced by running at optimum capacity and below maximum capacity further reducing emissions.

Multiple smaller generators will be using split power to allow operation at optimum capacity for each generator. Generator will only be run when absolutely necessary and also be used as a backup resource in case of house power failure.

10. Amenities / Toilets Waste (Pollution Waste Management)

The Drop Music Festival will engage an industry leading contractor to provide temporary amenities to handle the requirements for an outdoor event at a ratio of 1:60 patrons. All onsite toilets and their facilities will have the some or all of the following environmental advantages:

- A fresh flushing toilet using a maximum of 500ml of water per flush, compared to the industry average of 3-6 litres. This enables a much lower consumption of water on site.
- The use of a spring-loaded return tap minimises water usage, which mean that less pump outs are required per event, thus reducing truck visits and diesel consumption.
- Odor in waste tanks is minimised by the use of an ecologically friendly product that does not affect sewers or septic systems.
- Toilet paper with toilet blocks and wherever possible a recycled product will be used.

11. Transport & Access Management, Public and Patron safety

A detailed Traffic Management Plan (TMP) has been provided by Avert Risk who will has been contracted for The Drop Festival to ensure traffic and pedestrian safety is managed throughout the event:

- VMS will be used up to two weeks prior to the event to inform the local community of any disruptions along with a VMS which will be located at the entrance to the festival to inform all patrons of event information.
- Bump in & Out – An event Security Representative will be placed on vehicle access to ensure only accredited vehicles entry & to also manage pedestrian safety
- Traffic controller will be stationed at the Bus Zone on Pittwater Road to ensure no vehicles or bus park in zone.
- Two traffic controllers will be stationed at the Drop Off & Pick up zone on Pittwater Road to manage patron safety & ensure that no one parks in area

The Drop Festival aims to cause as little or no disruption to the local residents and community as possible and is committed to and focused on developing itself into the future alongside the local community within Manly and the Northern beaches precinct.

We will erect and maintain Safe Work Zones which will clearly define limitations and restricted areas for general public.

12. Food, Beverages & Merchandise

The Drop Festival is currently investigating environmental initiatives to be implemented during the event to encourage patrons to recycle which will include the use of bio- degradable food packaging along with minimising single use plastics where possible and will be looking into a re-usable cup system.

13. Contingencies in the Event of Emergencies, Cancellation or Postponement

The Drop Festival 2020 is an all-weather event in the incidences of extreme weather our Central Management Team will implement an event cancellation or postponement. For further details please see the Event Management Plan & Corresponding Adverse Weather Plan & Flood Risk Mitigation Plan.

Appropriate media channels will be used to broadcast information to the general public and patrons to inform them of any changes to the event.

14. Site Suitability

Keirle Park has been chosen for its site suitability as the site itself has many positive aspects such as:

- A flat area with little obstructions or hazards. The site is on existing sport playing fields, low bushfire hazards.
- The site is suitable for the delivery & in of all infrastructure with the implementation of the TMP and the traffic controllers, causing limited congestion around the site and public roads.
- Large free flowing area with no bottle necks or corners to ensure easy patron flow throughout the event.
- Adjacent to the golf course so that the stage and sound equipment can be positioned towards this open space and away from any neighbors, thus reducing noise pollution.
- Close to all forms of transport hubs including Buses and Ferries.
- Activates the local economy in the Northern Beaches and draws worldwide attention and notoriety to the local area and thus generating tourism.
- Partnership with the world surfing league and the direct connection to the Manly leg of the world surfing competition. The World Surf League (WSL) has been championing the world's best surfing since 1976, running more than 180 global events. The WSL is dedicated to celebrating the world's best surfing on the world's best waves through a variety of best-in-class audience.

15. Potential Environmental Impacts

As the site is on a sporting field, there is little to no impact on any vegetation, plants or animals as the land has already been cleared and is well maintained by the local council. There is no evidence to suggest that it is an Aboriginal significant site or have any historic heritage.

The Perimeter fence line will be established an adequate distance away from the adjacent waterway to reduce any impact it may have.

16. Building & Infrastructure Works

LEGISLATIVE COMPLIANCE

All stakeholders working on The Drop Festival 2019, including contractors and suppliers, must work under the:

- Work Health Safety Act 2011
- Work Health Safety Regulation 2017
- Relevant Codes of Practice, as appropriate
- Relevant Australian Standards, as appropriate
- Relevant other support documents to the legislation, as appropriate

All temporary structures such as stages and marquees will be built by professional industry leading suppliers and will be inspected & certified by a structural engineer once complete and before public access to the site.