

EXISTING VEHICLE CROSSING
(TO REMAIN)

NEW PROPOSED DRIVEWAY

PROVIDE CROSS-FALL
TOWARDS THE CENTER OF
THE DRIVEWAY

EXISTING VEHICLE CROSSING
(TO REMAIN)

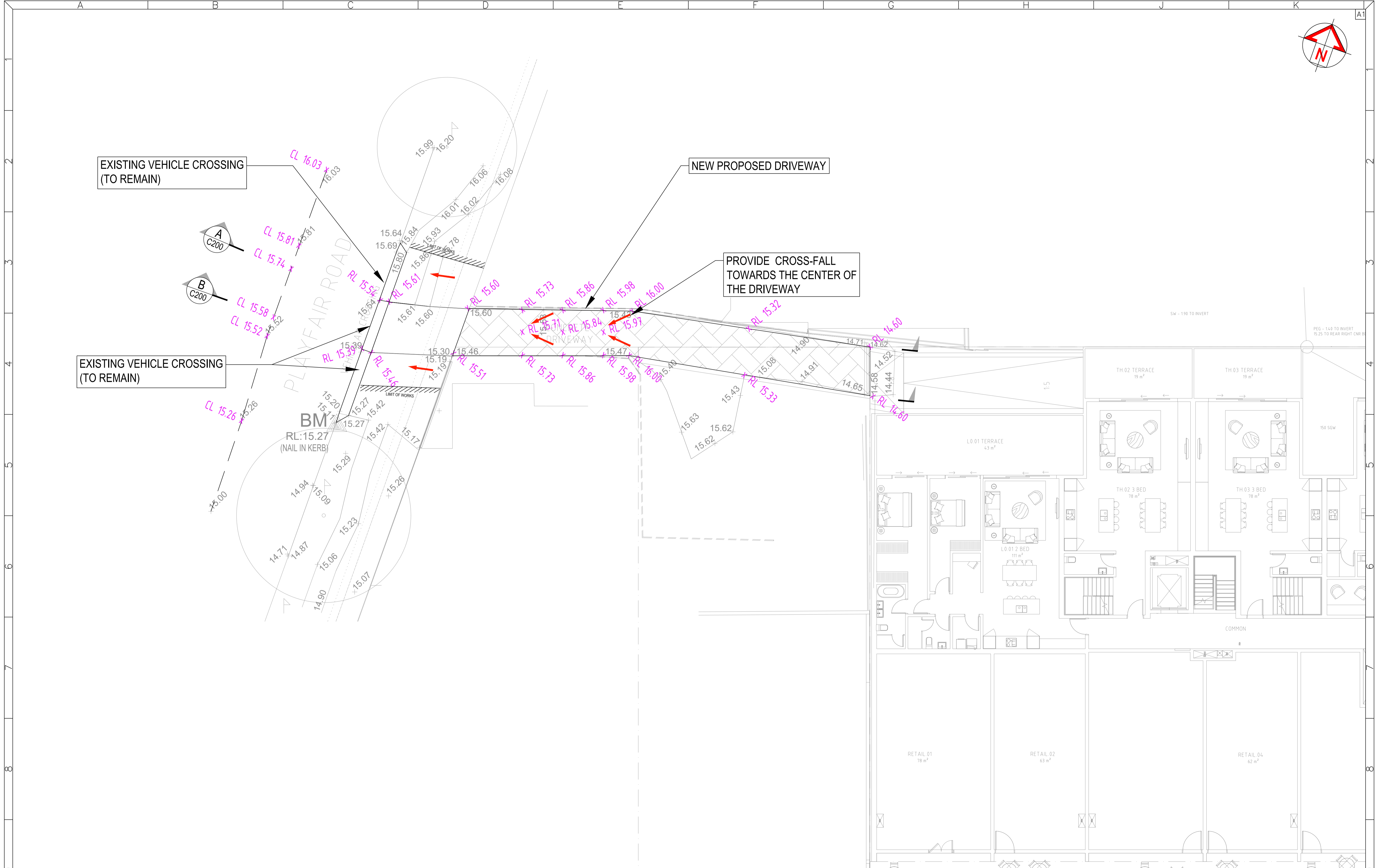

AMENDMENTS/REVISIONS				AMENDMENTS/REVISIONS			
Rev	Description	Initials	Date	Rev	Description	Initials	Date
01	PRELIMINARY	MS	30.11.23				
02	PRELIMINARY	MS	05.12.23				

CLIENT

ARCHITECT

CONSULTANT

Phone +61 2 8488 4600 Fax +61 2 9475 4588
Address Suite 1.11, 75 Mary St, St Peters, NSW 2044 Australia
Web www.igs.com.au

PROJECT

142 PITT ROAD,
CURL CURL

DRAWING TITLE

CIVIL
GROUND FLOOR PLAN
PLAYFAIR ROAD

PRELIMINARY
NOT TO BE USED FOR CONSTRUCTION PURPOSES

DRAWN	DESIGNED	CHECKED	SCALE (AT FULL SIZE)	DATE
MS	PS	BM	1:100 @ A1	Dec-23

PROJECT No. EN-N23_149 DRAWING No. C100 REVISION 02

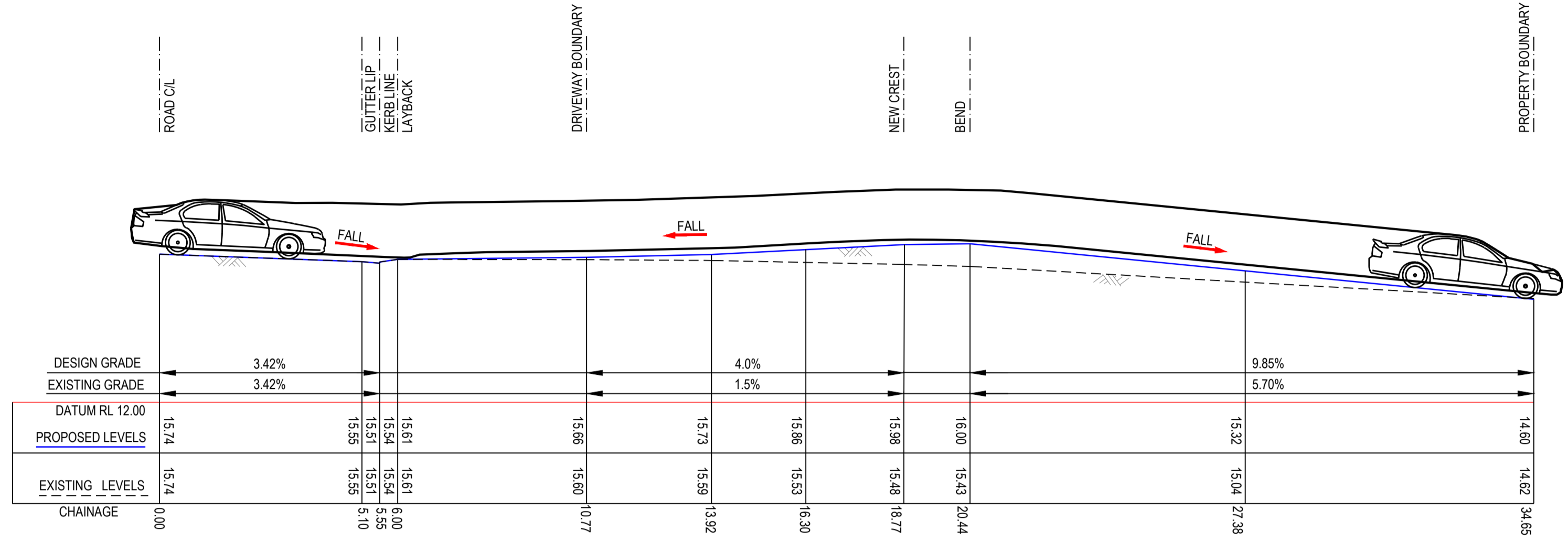

DRIVEWAY LONG-SECTION A
SCALE HOR. 1:100 VER. 1:100

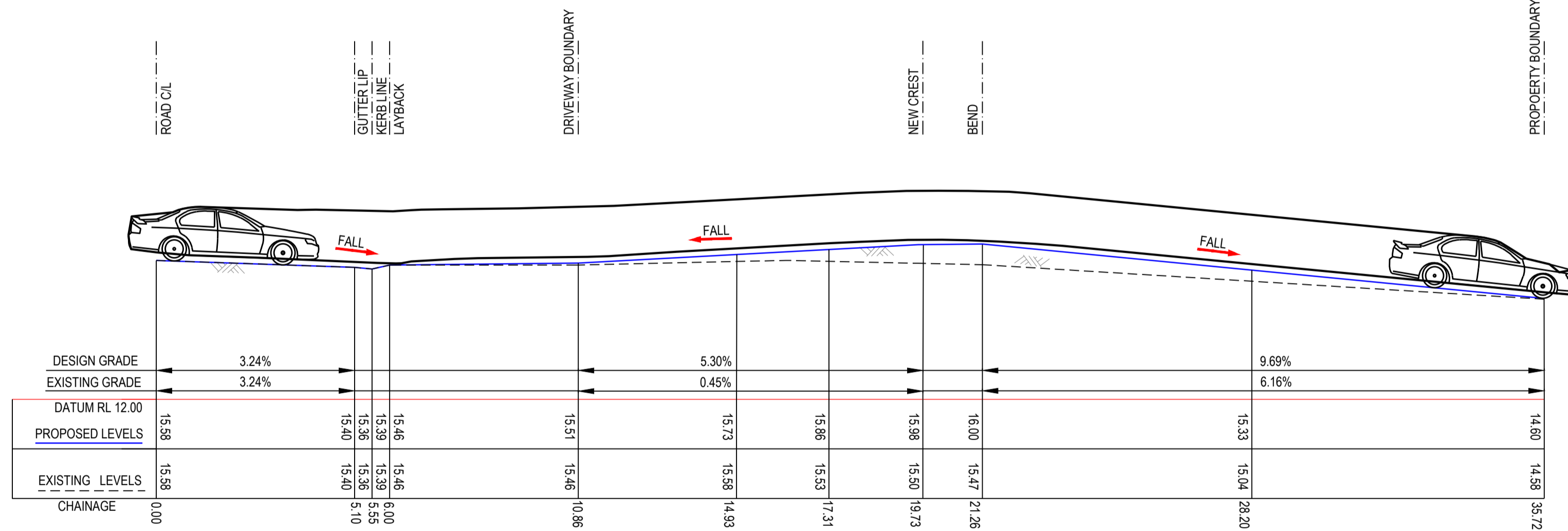

DRIVEWAY LONG-SECTION B
SCALE HOR. 1:100 VER. 1:100

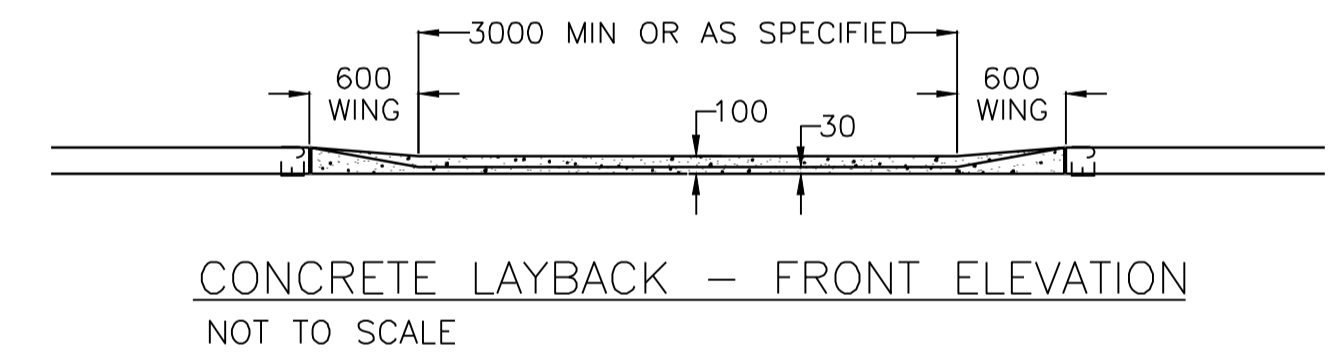
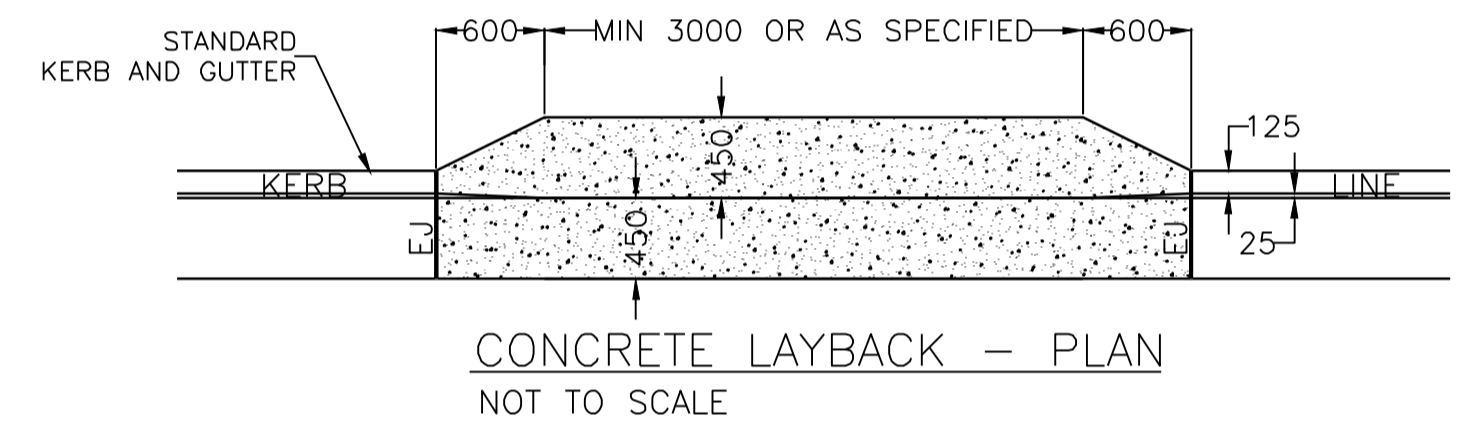
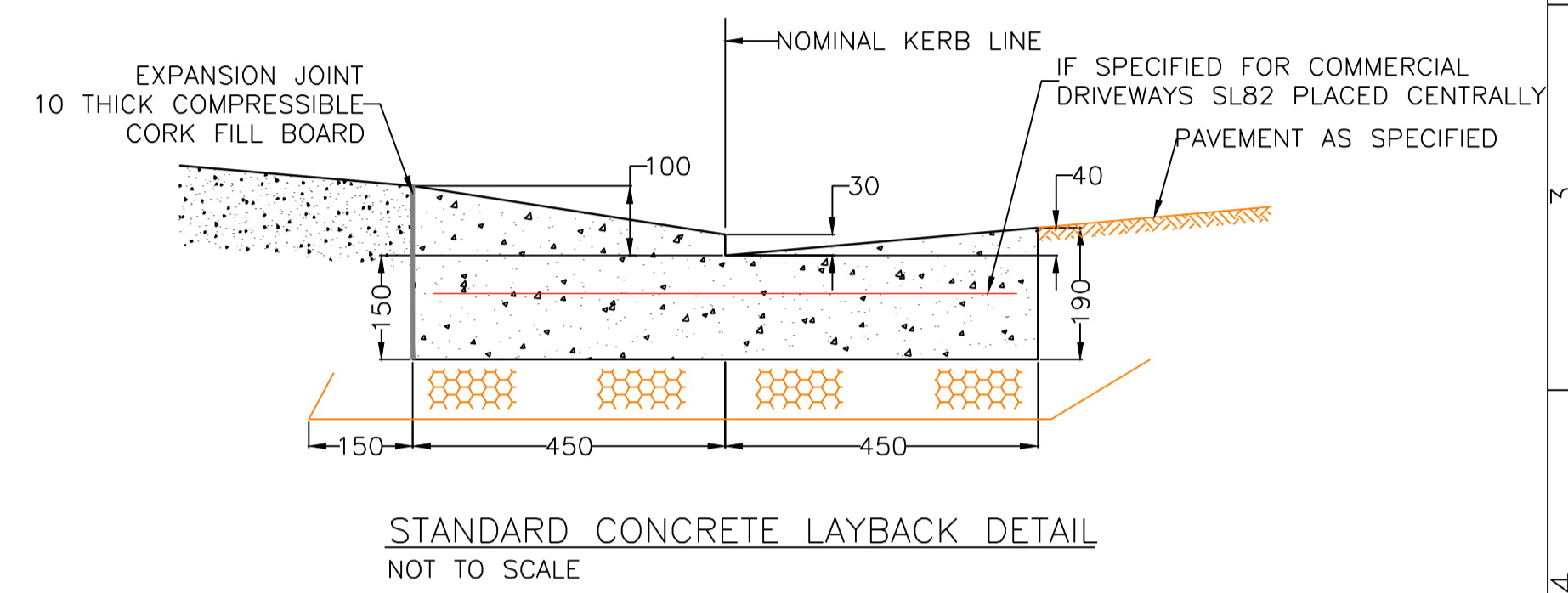
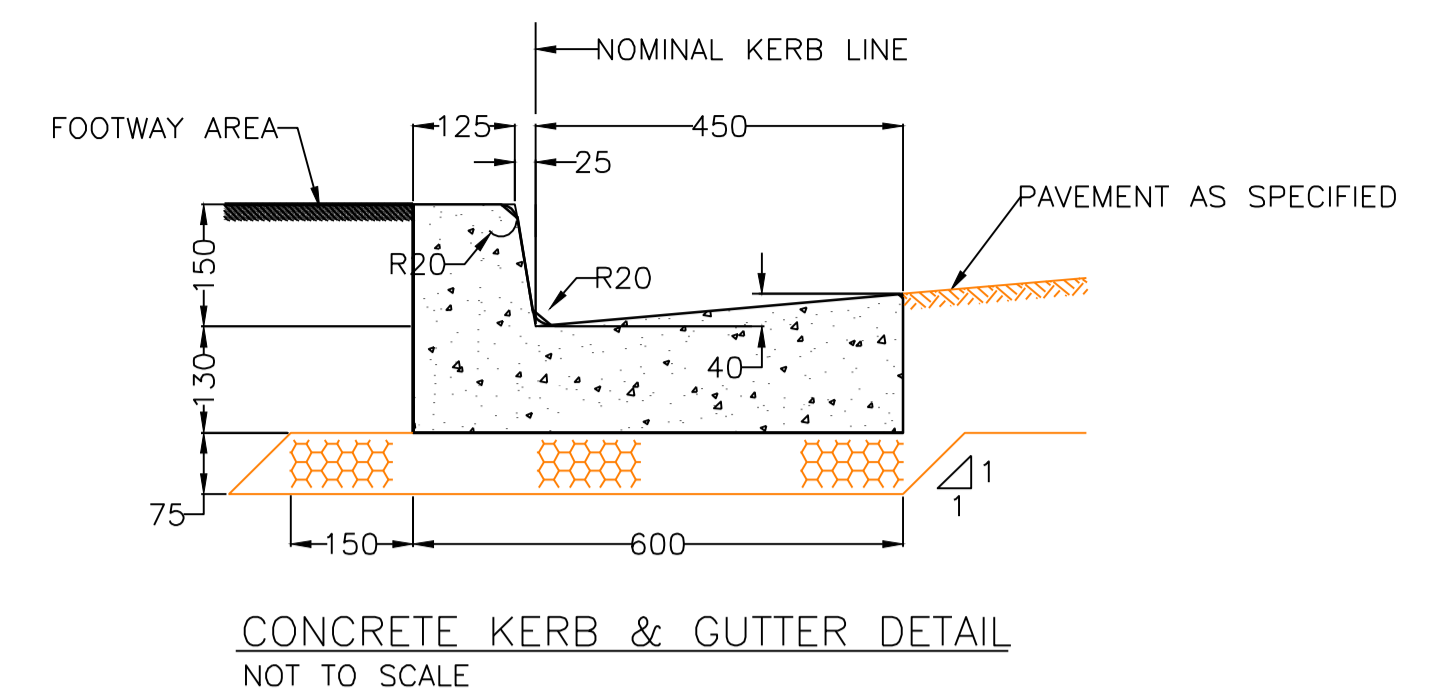
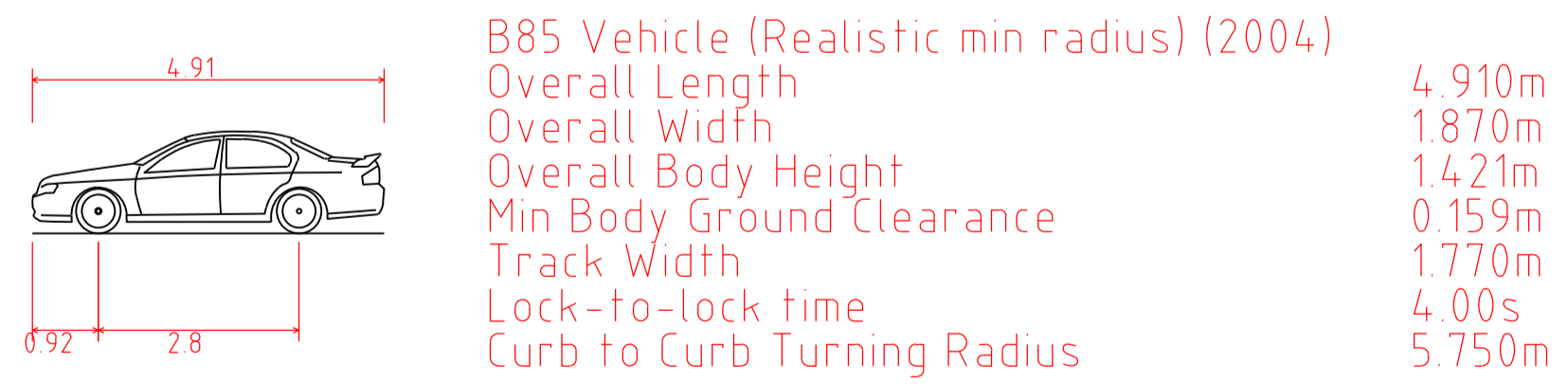

- STANDARD KERB AND GUTTER NOTES**
- KERB AND GUTTER, CONCRETE EDGING, DISH DRAINS AND THE LIKE SHALL BE POURED IN PLAIN CONCRETE AND FINISHED WITH A STEEL TROWEL.
 - THE MINIMUM COMPRESSIVE STRENGTH SHALL BE 25MPa AT 28 DAYS.
 - FOR ELEMENTS CONTRACTED USING SLIPFORM, REINFORCEMENT WILL NOT BE REQUIRED PROVIDED THAT THE CONCRETE COMPRESSIVE STRENGTH IS NOT LESS THAN 32MPa AT 28 DAYS.
 - WHERE COUNCIL OR ITS REPRESENTATIVE DIRECTS THAT THE GUTTER IS TO BE RETAINED, THE CONTRACTOR SHALL PLACE A 75mm DEEP SAW CUT IN THE GUTTER INVERT AND REMOVE THE KERB AND OR LAYBACK.
 - WHERE EXISTING KERB AND ASSOCIATED ELEMENT IS TO BE REPLACED SAW CUT IN THE ASPHALT MINIMUM 500mm FROM LIP OF GUTTER, COMPACT SUBGRADE AND INSTALL ASPHALT STRIP TO MAKE SMOOTH TRANSITION.
 - THE CONSTRUCTION OF ALL VEHICLE CROSSINGS AND ASSOCIATED WORKS WITHIN THE ROAD RESERVE MUST BE UNDERTAKEN BY A COUNCIL APPROVED CONTRACTOR.

AMENDMENTS/REVISIONS				AMENDMENTS/REVISIONS			
Rev	Description	Initials	Date	Rev	Description	Initials	Date
01	PRELIMINARY	MS	27.11.23				
02	PRELIMINARY	MS	30.11.23				
03	PRELIMINARY	MS	05.12.23				

CLIENT

BALITO INVESTMENTS

ARCHITECT

WARREN AND MAHONEY

CONSULTANT

IGS INTEGRATED GROUP SERVICES
Phone +61 2 8488 4600 Fax +61 2 9475 4588
Address Suite 1.11, 75 Mary St, St Peters, NSW 2044 Australia
Web www.igs.com.au

PROJECT

142 PITT ROAD, CURL CURL

DRAWING TITLE

DRIVEWAY AND FOOTPATH PROFILES

FOR APPROVAL
NOT TO BE USED FOR CONSTRUCTION PURPOSES

DRAWN	DESIGNED	CHECKED	SCALE (AT FULL SIZE)	DATE
MS	PS	BM	1:100 @ A1	Dec-23
PROJECT No.		DRAWING No.		REVISION
EN-N23_149		C200		03