

LEGEND

-  100mm Dia uPVC STORMWATER PIPE
- DP** 100mm Dia. DOWN-PIPE COLORBOND TO MATCH GUTTER
- SP** SPREADER COLORBOND TO MATCH GUTTER

STORMWATER NOTES:

- 1 - ALL PIPES TO BE 100mm DIA UNLESS NOTED OTHERWISE.
- 2 - ALL PIPES TO BE uPVC TO AS 1254-200:2 UNLESS NOTED OTHERWISE.
- 3 - ALL PIPES TO BE LAID AT 1% MINIMUM GRADE UNLESS NOTED OTHERWISE.
- 4 - ALL PIPES SHALL BE LAID ON A 75mm SAND BED, COMPACTED TO: 100% S.M.D.D. BELOW PAVEMENTS. (NO COMPACTION REQUIRED BELOW LANDSCAPING) COVER TO SURFACE FROM TOP OF PIPE TO BE 300mm MINIMUM. BACKFILL TO BE ADEQUATELY CONSOLIDATED AROUND PIPES BY METHOD OF RAMMING AND WATERING IN. TRENCHES TO BE FILLED WITH GRANULAR MATERIAL AS SPECIFIED.
- 5 - ALL DOWNPIPES TO BE 100mm UNLESS NOTED OTHERWISE.
- 6 - DOWNPIPE LOCATIONS ARE INDICATIVE ONLY. LOCATIONS TO BE CONFIRMED PRIOR TO COMMENCEMENT OF WORK.
- 7 - ALL PITS TO BE CAST INSITU OR IF PRECAST, APPROVED BY ENGINEER.
 - ALL PITS GREATER THAN 1000mm DEEP SHALL HAVE STEEL IRON BARS AS PER COUNCIL STANDARDS.
- 8 - ALL WORK TO BE IN ACCORDANCE WITH LOCAL COUNCIL STANDARDS AND SPECIFICATIONS.
- 9 - ALL LEVELS SHOWN ARE TO AHD.
- 10 - COMPLY WITH APPLICABLE CLAUSES OF THESE BUILDING STANDARDS Current Edition.

- AS/NZS 1260 1999 PVC Pipes and fittings for drain, waste and vent applications.
- AS 1432 1996 Copper tubes for plumbing, gasfitting and drainage applications.
- AS 3500 National plumbing and drainage code, There are 10 parts to this standard 1995-2000.
- AS/NZS 4494 1998 Discharge of commercial and industrial liquid waste to sewer
- AS 1379 1997 Specification and supply of concrete, plus 1 supplement.
- AS 3500.3.1 1998 Stormwater drainage - Performance requirements.
- AS/NZS 3500.3.2 1998 Stormwater drainage - Acceptable solutions.

SUMMIT AVENUE

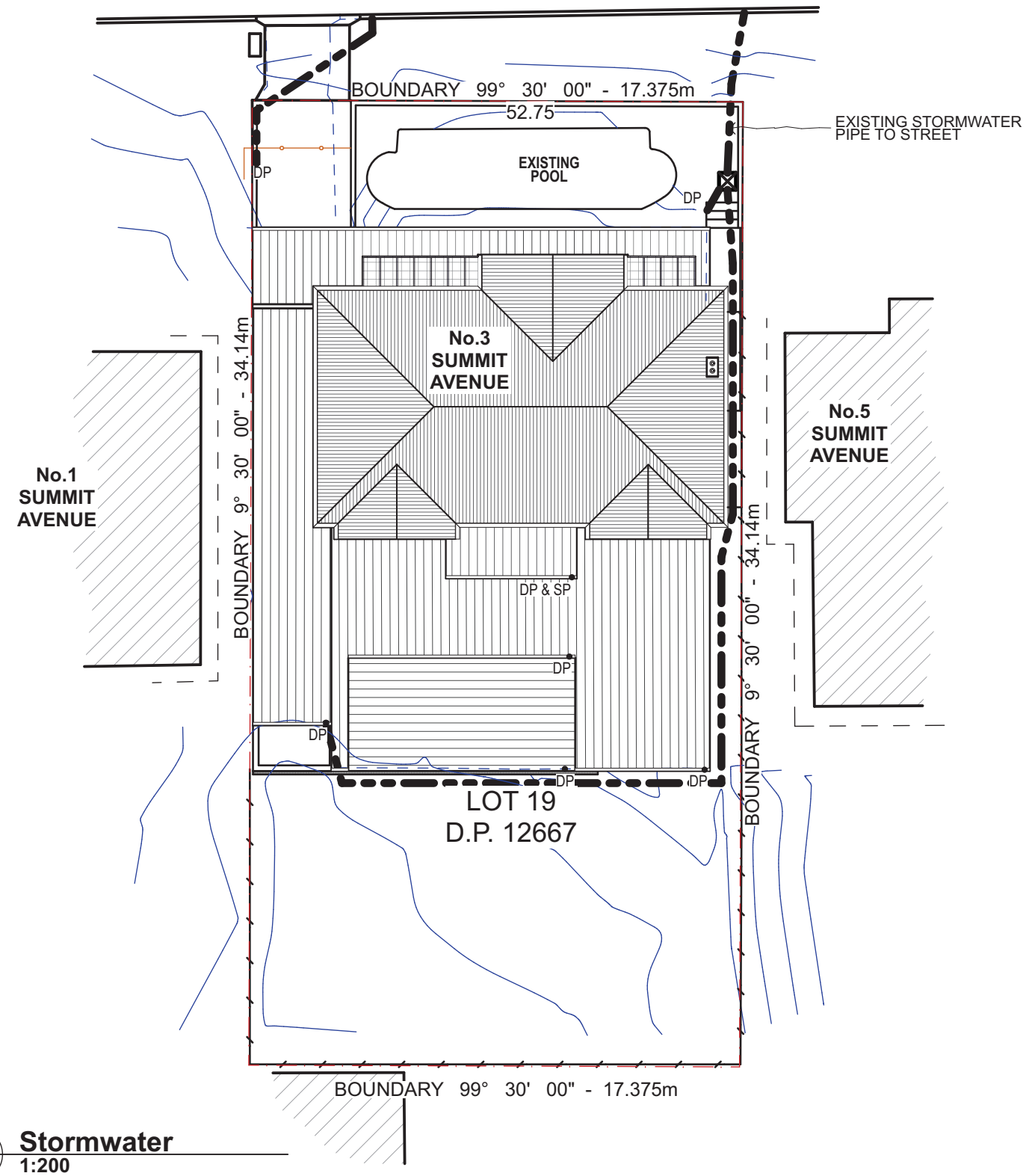

1 Stormwater
1:200

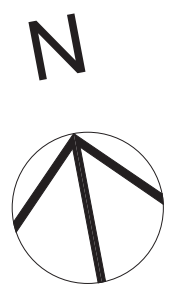

NOTES
This drawing shall be read in conjunction with all other drawings and specifications for the project.
Any discrepancies shall be referred to the architect for clarification before proceeding with work.
All dimensions shall be verified on site prior to commencement of construction or fabrication on and off site.
Figured dimensions to be used rather than scaling.
All building work must be carried out in accordance with the Building Code of Australia and all relevant Australian Standards.
CAD Ref: 3 Summit Ave DA04.pln
Grant Seghers Design

REV	DATE	AMENDMENT
A	MARCH 2018	ISSUE FOR DEVELOPMENT APPLICATION

grantseghers
architect

Grant Seghers
0424 428 602
grant.seghers@bigpond.com
www.grantseghers.com.au

PROJECT
SAKELLARIS RESIDENCE
3 Summit Avenue
DEE WHY NSW 2097
Lot 19 DP 12667
grantseghersdesign
42 The Scenic Road
Killcare Heights NSW 2257
0424 428 602

DRAWING TITLE
STORMWATER CONCEPT PLAN

SCALE	DRAWN BY	PLOT DATE
1:200@A3	GS	7/03/2018
PROJECT NO.	DRAWING NO.	REVISION
1619	DA-11	A