

PRELIMINARY SITE CONDITION ASSESSMENT

SERVICE STATION UPGRADE

209 PITTWATER ROAD
MANLY NSW 2095

FOR

ULTRA PETROLEUM GROUP Pty Ltd



Project No : **08 - 045 - 22**

Edition : **Edition ii**

Date : **4th April 2023**

Prepared by

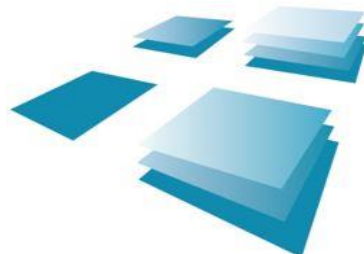

R.J. SINCLAIR Pty Ltd
Building **Design**

PO Box 503
ROUND CORNER, NSW 2158

ACN : 002 050 526
ABN : 74 002 050 526

Phone : 02 9654 2480
E-mail : designs@rjsinclair.com.au
Web : www.rjsinclair.com.au

Multi-Discipline Design + Project Management

PRELIMINARY ASSESSMENT OF SITE CONDITIONS

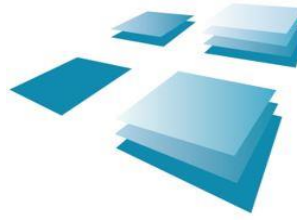

R.J. SINCLAIR Pty Ltd
Building Design

PO Box 503
ROUND CORNER NSW 2158

ACN : 002 050 526
ABN : 74 002 050 526

Phone : 02 9654 2480
E-mail : designs@rjsinclair.com.au
Web : www.rjsinclair.com.au

Multi-Discipline Design + Project Management

Site Address : **209 PITTWATER ROAD
MANLY NSW 2095**

Project No : 08 - 045 - 22

01 TABLE OF CONTENTS

01	TABLE OF CONTENTS	1
02	EDITIONS + REVISIONS	2
03	SITE DETAILS	3
04	SITE ASSESSMENT	6

PRELIMINARY ASSESSMENT OF SITE CONDITIONS

Site Address : **209 PITTWATER ROAD
MANLY NSW 2095**

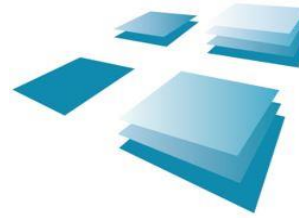

R.J. SINCLAIR Pty Ltd
Building Design

PO Box 503
ROUND CORNER, NSW 2158

ACN : 002 050 526
ABN : 74 002 050 526

Phone : 02 9654 2480
E-mail : designs@rjsinclair.com.au
Web : www.rjsinclair.com.au

Multi-Discipline Design + Project Management

Project No : 08 - 045 - 22

02 EDITIONS + REVISIONS

- i 2023-03-30 Edition i - Issued for Client Comment only.
- ii 2023-04-04 Edition ii - Issued for Development Approval only.

PRELIMINARY ASSESSMENT OF SITE CONDITIONS

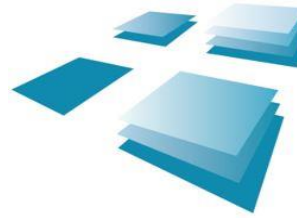

R.J. SINCLAIR Pty Ltd
Building Design

PO Box 503
ROUND CORNER NSW 2158

ACN : 002 050 526
ABN : 74 002 050 526

Phone : 02 9654 2480
E-mail : designs@rjsinclair.com.au
Web : www.rjsinclair.com.au

Multi-Discipline Design + Project Management

Site Address : **209 PITTWATER ROAD
MANLY NSW 2095**

Project No : 08 - 045 - 22

03 SITE DETAILS

Site Address : **209 PITTWATER ROAD
MANLY NSW 2095**

Site Plan :

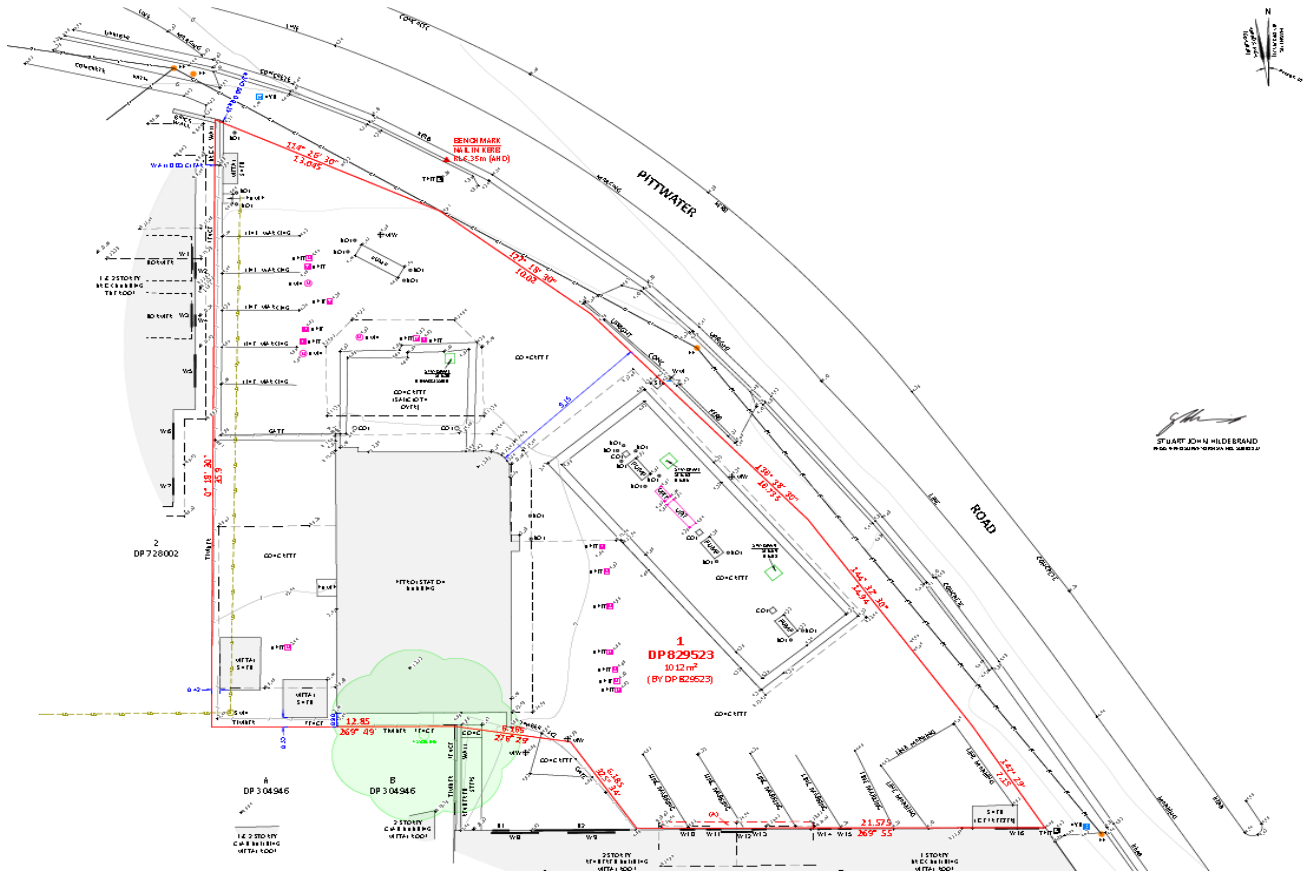

SURVEY PLAN

By SurveyPlus

Site Area : **1,012 m²**

Geotechnical Area :

Alluvial sands (Jeffery + Katauskas Pty Ltd Ref: 22583ZArpt - 19th December 2008)
Over Hawkesbury Sandstone (E.I.S. Ref: E22583KHlet - 22nd December 2008)

General description of proposed development :

Alterations to existing service station building comprising :

- Removal of internal walls.
- Removal of internal workshop floor slabs.
- Construction of new internal masonry + lightweight walls.
- Construction of new internal floor slabs.
- Plumbing and drainage underground works for new WC + car wash.
Max. depth of excavation for pipework approx. 1m
- New lightweight roof structure over new car wash exit.
Max depth of excavation for new footings approx. 800

PRELIMINARY ASSESSMENT OF SITE CONDITIONS

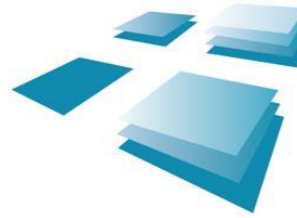

R.J. SINCLAIR Pty Ltd
Building Design
PO Box 503
ROUND CORNER NSW 2158
ACN : 002 050 526
ABN : 74 002 050 526
Phone : 02 9654 2480
E-mail : designs@rjsinclair.com.au
Web : www.rjsinclair.com.au
Multi-Discipline Design + Project Management

Site Address : **209 PITTWATER ROAD
MANLY NSW 2095**

Project No : 08 - 045 - 22

03 SITE DETAILS

Topography : Whole of site is developed with service station building and miscellaneous ancillary structures and concrete paving.
No natural land form is visible.
Site slope approx. 1% from west to east.
No evidence of ground instability evidenced by lack of any significant cracking of existing masonry structures.

PRELIMINARY ASSESSMENT OF SITE CONDITIONS

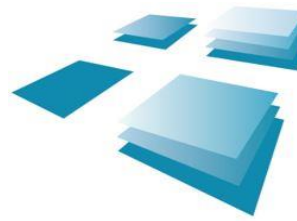

R.J. SINCLAIR Pty Ltd
Building Design
PO Box 503
ROUND CORNER, NSW 2158
ACN : 002 050 526
ABN : 74 002 050 526
Phone : 02 9654 2480
E-mail : designs@rjsinclair.com.au
Web : www.rjsinclair.com.au
Multi-Discipline Design + Project Management

Site Address : **209 PITTWATER ROAD
MANLY NSW 2095**

Project No : 08 - 045 - 22

04 SITE ASSESSMENT

This site assessment is based on :
Manly Development Control Plan 2013 Amendment 10
Schedule 11 - Checklist for Council's assessment of site conditions and need for geotechnical report
Graphic representation in Schedule 11 represented in text format :

CHECKPOINT	QUESTION	RESPONSE
Review of historical data	Does the site, or adjacent properties, have histories of slope instability ?	None known.
PROPOSED DEVELOPMENT	Are excavations or fills >2m depth proposed ?	No
SITE INSPECTION	Is the site Developed ort Undeveloped ?	Fully developed with 100% site coverage
DEVELOPED SITE	Is fill >1m in depth present ?	No (Jeffery + Katauskas Pty Ltd Ref: 22583ZArpt - 19th December 2008)
	Are cuts / excavations > 2m present ?	No
CONCLUSION :	Based on the responses above to each checkpoint question, a geotechnical report is NOT required.	