

JENNER STREET

SITE BENCHMARK
NAIL IN KERB
RL 57.78 (A.H.D.)

LOT C
DP 90826
748.6m²

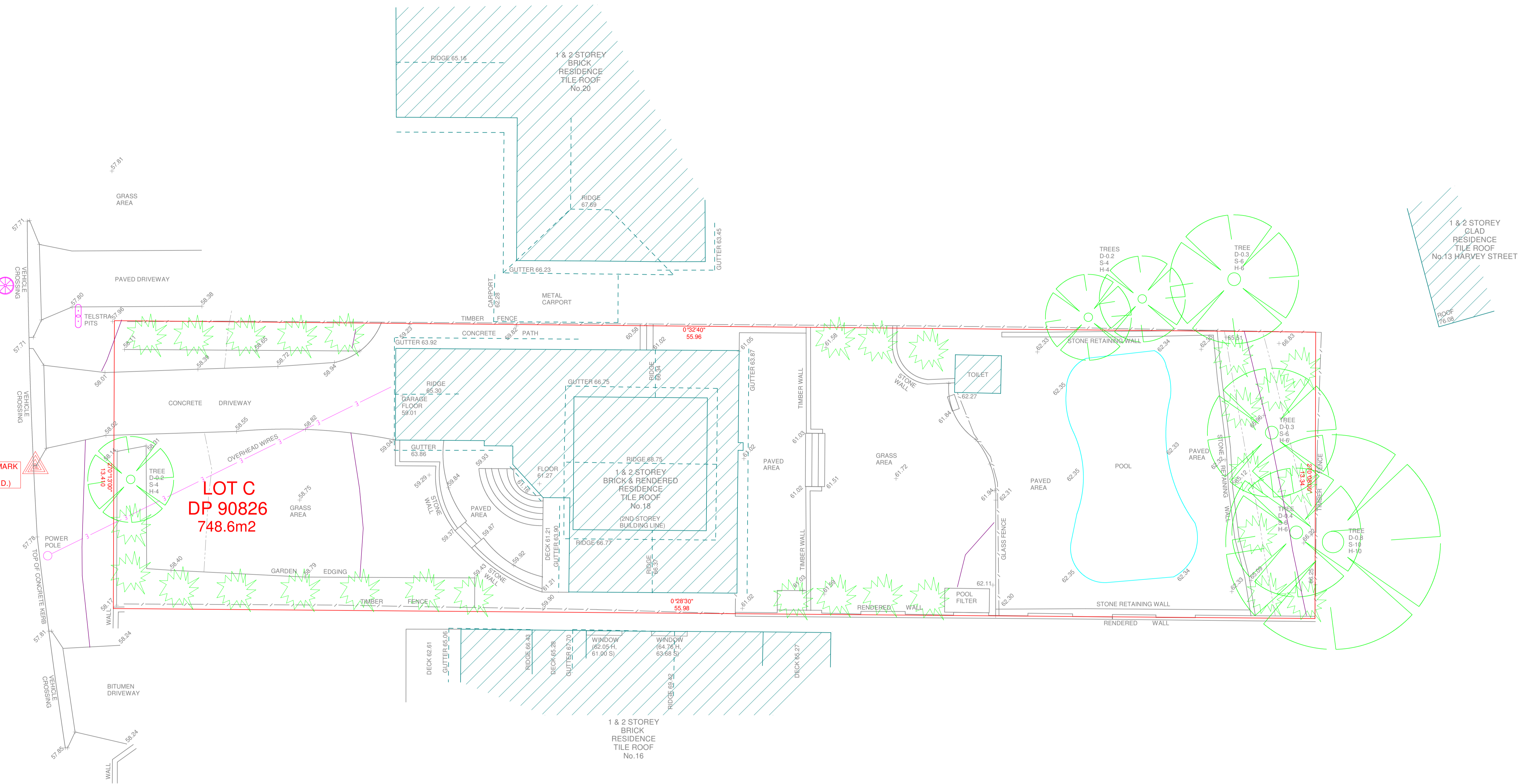

THIS PLAN IS PREPARED FOR DETAIL AND LEVEL PURPOSES ONLY AND THE BOUNDARIES OF THE LAND HAVE NOT BEEN MARKED.

THIS SURVEY IS LIMITED TO THOSE PARTS OF THE SUBJECT BUILDING AND OTHER IMPROVEMENTS THAT WERE VISIBLE AND ACCESSIBLE. ANY FUTURE DEVELOPMENT OR FENCING WOULD REQUIRE THE BOUNDARIES TO BE MARKED ON THE GROUND.

ANY STRUCTURES RELATED TO PHYSICAL FEATURES (BUILDINGS, TREES, ETC.) MUST BE CONFIRMED PRIOR TO FINAL DESIGN.

ALL SERVICES MUST BE VERIFIED BY THE CONTRACTOR PRIOR TO CONSTRUCTION.

THE DIAMETER OF TREE TRUNKS CONTAINED WITHIN TREE SYMBOLS ARE NOT TO SCALE AND ARE INDICATIVE ONLY.

THE BEARINGS ON THESE PLAN BOUNDARIES ARE FROM LAND PROPERTY INFORMATION PLANS. THEY ARE ON MM NORTH. IF ACCURATE TRUE NORTH IS REQUIRED A FURTHER SURVEY WOULD BE NECESSARY.

ORIGIN OF RL'S: SSM 82113 - RL 71.112 (A.H.D.)

<p>TRUE NORTH SURVEYS</p>	PROJECT : PLAN SHOWING DETAIL AND LEVELS OVER LOT C IN DP 90826, AT No.18 JENNER STREET, SEAFORTH.		SHEET No. 1 OF 1 SHEETS
	CLIENT : MR AND MRS RAE		DRAWING No. : 5665DT
16 / 9 NARABANG WAY, BELROSE 2085 TEL : 94500868 FAX : 94500268 EMAIL : admin@truenorthsurveys.com.au	DATUM : A.H.D	DATE : 23/07/2015	SCALE : 1 : 100
			JOB REF : 5665