

PROPOSED RESIDENTIAL DEVELOPMENT

AT 26 RIVERVIEW ROAD, AVALON BEACH, NSW, 2107

GENERAL NOTES

- G1 ALL WORKS SHALL BE IN ACCORDANCE WITH B.C.A AND AS3500.3.
- G2 ALL EXISTING LEVELS TO BE CONFIRMED BY BUILDER PRIOR TO CONSTRUCTION.
- G3 THE BUILDER SHALL ENSURE THAT THE STORMWATER ENGINEERS DRAWINGS CORRESPOND TO THE ARCHITECTURAL, STRUCTURAL, AND LANDSCAPING DRAWINGS. IF THERE EXISTS ANY DISCREPANCIES BETWEEN THE DRAWINGS, THE BUILDER SHALL REPORT THE DISCREPANCIES TO THE ENGINEER PRIOR TO COMMENCEMENT OF ANY WORKS.
- G4 PRIOR TO COMMENCING ANY WORKS, THE BUILDER SHALL ENSURE THAT THE INVERT LEVELS OF WHERE THE SITE STORMWATER SYSTEM CONNECTS INTO THE COUNCILS KERB/DRAINAGE SYSTEM MATCHED THE DESIGN LEVELS. ANY DISCREPANCIES SHALL BE REPORTED TO THE DESIGN ENGINEER.
- G5 THE DRAINAGE CONTRACTOR IS TO LOCATE AND RELOCATE AS NECESSARY ALL SERVICES ON SITE.
- G6 ALL LEVELS SHALL RELATE TO THE ESTABLISHED BENCH MARK. THIS IS TYPICALLY METRES TO AUSTRALIAN HEIGHT DATUM (AHD).
- G7 ALL DOWNPIPES TO BE 100MM DIAMETER UNLESS NOTED OTHERWISE.
- G8 ALL DOWN PIPES TO HAVE LEAF GUARDS.
- G9 ALL LINES ARE TO BE 100MM DIAMETER uPVC AT A MINIMUM 1.0% SLOPE UNLESS NOTED OTHERWISE. LINES ARE TO BE SEWER-GRADE AND SEALED.
- G10 ALL PIPES TO HAVE MINIMUM 150MM COVER IF LOCATED WITHIN PROPERTY.
- G11 ALL THE CLEANING EYES (OR INSPECTION EYES) FOR THE UNDERGROUND PIPES HAVE TO BE TAKEN UP TO THE FINISHED GROUND LEVEL FOR EASY IDENTIFICATION AND MAINTENANCE PURPOSES.
- G12 ALL SUB-SOIL DRAINAGE SHALL BE OF A MINIMUM 100MM DIAMETER AND SHALL BE PROVIDED WITH A FILTER SOCK. THE SUBSOIL DRAINAGE SHALL BE INSTALLED IN ACCORDANCE WITH DETAILS TO BE PROVIDED BY THE LANDSCAPE ARCHITECT OR STORMWATER ENGINEER.
- G13 ALL RETAINING WALLS SHALL BE CONSTRUCTED COMPLETELY WITHIN THE PROPERTY BOUNDARY LIMITS TO DETAILS PREPARED BY THE STRUCTURAL ENGINEER. WALLS FORMING THE ON-SITE DETENTION SYSTEM SHALL BE OF MASONARY/BRICK/CONCRETE CONSTRUCTION AND WATER TIGHT.
- G14 ALL MULCHING TO BE USED WITHIN THE AREA DESIGNATED AS ON-SITE DETENTION STORAGE SHALL BE OF A NON-FLOTABLE MATERIAL SUCH AS DECORATIVE RIVER GRAVEL. PINE PARK MULCHING SHALL NOT BE USED WITHIN THE DETENTION STORAGE AREA.
- G15 ALL DRAINAGE WORKS ARE TO AVOID TREE ROOTS. ROOT BARRIER TO BE INSTALLED ADJACENT TO TREE ZONES WHERE DRAINAGE MAY BE AT RISK.
- G16 ALL WORK WITHIN COUNCIL RESERVE TO BE INSPECTED BY COUNCIL PRIOR TO CONSTRUCTION.
- G17 COUNCIL'S ISSUED FOOTWAY DESIGN LEVELS TO BE INCORPORATED INTO THE FINISHED LEVELS ONCE ISSUED BY COUNCIL.

RAINWATER TANKS

- R1 RAINWATER TANK, DRAINED ROOF AREAS AND REUSE PLUMBING TO COMPLY WITH BASIX REQUIREMENTS AND CERTIFICATE.
- R2 ADEQUATE SCREENING TO PREVENT MOSQUITO BREEDING AND ENTRY OF ANIMAL OR FLOATING MATTER.
- R3 A 'FIRST FLUSH' DIVERSION TO REMOVE ROOF CONTAMINANTS MUST BE PROVIDED.
- R4 TANKS TO BE PUMPED TO TOP-UP FROM THE POTABLE WATER SUPPLY DURING DRY PERIOD WHEN THE TANK IS 80% EMPTY.
- R5 PUMP TO BE SUITABLY SOUNDPROOFED.
- R6 A SIGN IS TO BE INSTALLED NEAR THE RAINWATER TANK HIGHLIGHTING "NOT FOR HUMAN CONSUMPTION".

LEGEND

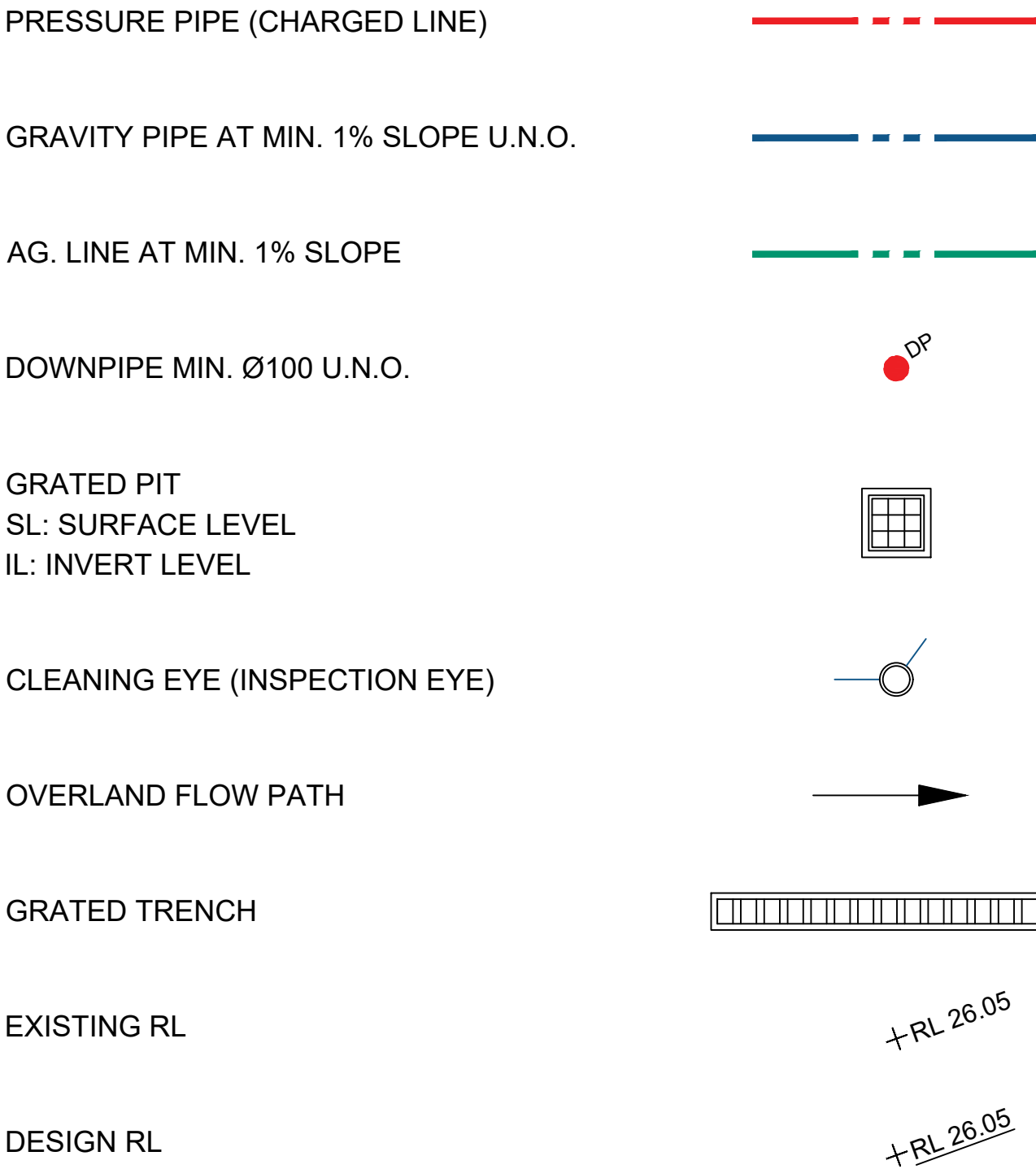

SEDIMENT & EROSION CONTROL

- S1 PLANS ARE MINIMUM REQUIREMENTS AND ARE TO BE USED AS A GUIDE ONLY. EXACT MEASURES USED SHALL BE DETERMINED ON SITE IN CONJUNCTION WITH PROGRAM OF CONTRACTORS WORKS.
- S2 IMMEDIATELY FOLLOWING SETTING OUT OF THE WORKS, BUT PRIOR TO COMMENCEMENT OF ANY CLEARING OR EARTHWORKS, THE CONTRACTOR AND SUPERINTENDENT SHALL WALK THE SITE TO NOMINATE THE LOCATIONS AND TYPES OF SEDIMENT AND EROSION CONTROL MEASURE TO BE ADOPTED. THESE MEASURES SHALL BE IMPLEMENTED PRIOR TO ANY CLEARING OR EARTHWORKS AND MAINTAINED UNTIL THE WORKS ARE COMPLETED AND NO LONGER POSE AN EROSION HAZARD, UNLESS OTHERWISE APPROVED BY THE SUPERINTENDENT.
- S3 IMMEDIATELY FOLLOWING SETTING OUT OF THE WORKS, BUT PRIOR TO COMMENCEMENT OF ANY CLEARING OR EARTHWORKS, THE CONTRACTOR AND SUPERINTENDENT SHALL WALK THE SITE TO IDENTIFY AND MARK TREES WHICH ARE TO BE PRESERVED. NOTWITHSTANDING THE ABOVE, THE CONTRACTOR SHALL TAKE ALL REASONABLE PRECAUTIONS TO MINIMISE DISTURBANCE TO EXISTING VEGETATION AND GROUND COVER OUTSIDE THE MINIMUM AREAS REQUIRED TO COMPLETE THE WORKS AND SHALL BE RESPONSIBLE FOR RECTIFICATION, AT ITS OWN COST, OF ANY DISTURBANCE BEYOND THOSE AREAS.
- S4 PROVIDE GULLY GRATE INLET SEDIMENT TRAPS AT ALL GULLY PITS.
- S5 PROVIDE SILT FENCING ALONG PROPERTY LINE AS DIRECTED BY SUPERINTENDENT.
- S6 ADDITIONAL CONTROL DEVICES TO BE PLACED WHERE DIRECTED BY THE PRINCIPLE.
- S7 ALTERNATIVE DESIGNS TO BE APPROVED BY SUPERINTENDENT PRIOR TO CONSTRUCTION.
- S8 WASH DOWN/RUMBLE AREA TO BE CONSTRUCTED WITH PROVISIONS RESTRICTING ALL SILT AND TRAFFICKED DEBRIS FROM ENTERING THE STORMWATER SYSTEM.
- S9 NO WORK OR STOCKPILING OF MATERIALS TO BE PLACED OUTSIDE OF SITE WORK BOUNDARY.
- S10 APPROPRIATE EROSION AND SEDIMENT CONTROLS TO BE USED TO PROTECT STOCKPILES AND MAINTAINED THROUGHOUT CONSTRUCTION.
- S11 IT IS THE CONTRACTORS RESPONSIBILITY TO TAKE DUE CARE OF NATURAL VEGETATION. NO CLEARING IS TO BE UNDERTAKEN WITHOUT PRIOR APPROVAL FROM THE SUPERINTENDENT.
- S12 TO AVOID DISTURBANCE TO EXISTING TREES, EARTHWORKS WILL BE MODIFIED AS DIRECTED ON SITE BY THE SUPERINTENDENT.

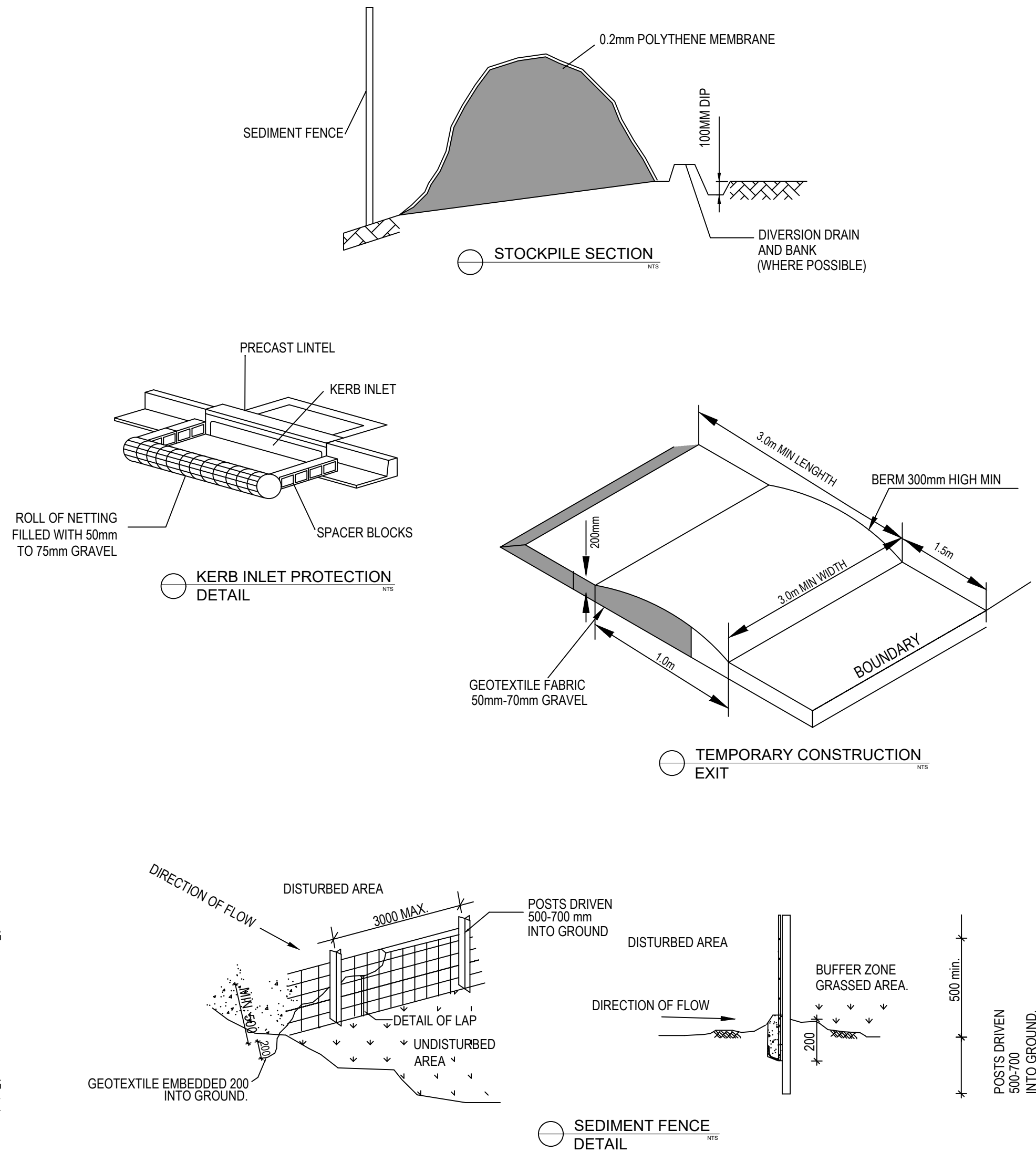

SEDIMENT FENCE

- F1 FILTER CLOTH TO BE FASTENED SECURELY TO POSTS WITH GALVANISED WIRE TIES, STAPLES OR ATTACHMENT BELTS.
- F2 WHEN TWO SECTIONS OF FILTER CLOTH ADJOIN EACH OTHER THEY SHALL BE OVERLAPPED BY 150MM AND FOLDED.
- F3 POSTS SHALL NOT BE SPACED MORE THAN 3.0 METRES APART.
- F4 FOR EXTRA STRENGTH TO SILT FENCE, WOVEN WIRE (14MM GAUGE, 150MM MESH SPACING) TO BE FASTENED SECURELY BETWEEN FILTER CLOTH AND POSTS BY WIRE TIES OR STAPLES
- F5 INSPECTIONS SHALL BE PROVIDED ON A REGULAR BASIS, SPECIALLY AFTER RAINFALL AND EXCESSIVE SILT DEPOSITS REMOVED WHEN "BULGES" DEVELOP IN SILT FENCE
- SEDIMENT FENCES SHALL BE CONSTRUCTED WITH SEDIMENT TRAPS AND EMERGENCY SPILLWAYS AT SPACINGS NO GREATER THAN 40M ON FLAT TERRAIN DECREASING TO 20M SPACINGS ON STEEP TERRAIN

NOTE

DO NOT SCALE OF DRAWINGS. REFER TO ARCHITECTURAL PLANS FOR LEVELS, STEPS, DIMENSIONS AND SETOUT. VERIFY DIMENSIONS ON SITE. THE ENGINEER SHALL BE NOTIFIED OF ANY VARIATIONS TO THAT SHOWN ON STRUCTURAL PLANS BEFORE COMMENCEMENT OF WORKS

A	09.03.2021	ISSUED FOR DA	R.P
REV	DATE	DESCRIPTION	BY

COPYRIGHT
All rights reserved.
These drawings, plans and specifications and the copyright are the property of SDS ENGINEERING and must not be used, reproduced or copied wholly or in part without the written permission of SDS ENGINEERING.

SDSEngineering

Suite 206/4 Columbia Ct
Norwest, NSW 2153
www.sdsengineering.com.au

PROPOSED RESIDENTIAL DEVELOPMENT
AT 26 RIVERVIEW ROAD, AVALON BEACH, NSW, 2107
FOR FUTURE FLIP

GENERAL NOTES

JOB NUMBER: 20922	DWG NUMBER: C000	ORIGINAL SIZE: A1
DESIGNED BY: R.P	DATE: 09.03.2021	
DRAWN BY: R.P	SCALE: AS SHOWN	

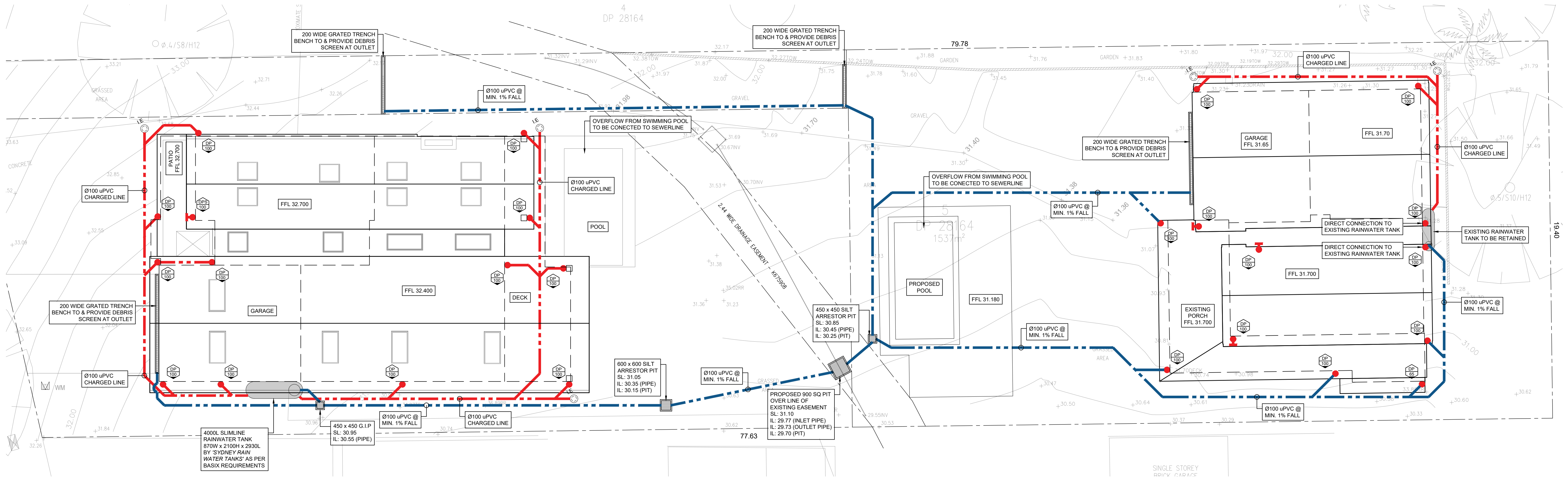

CONCEPT STORMWATER DRAINAGE PLAN

1:100

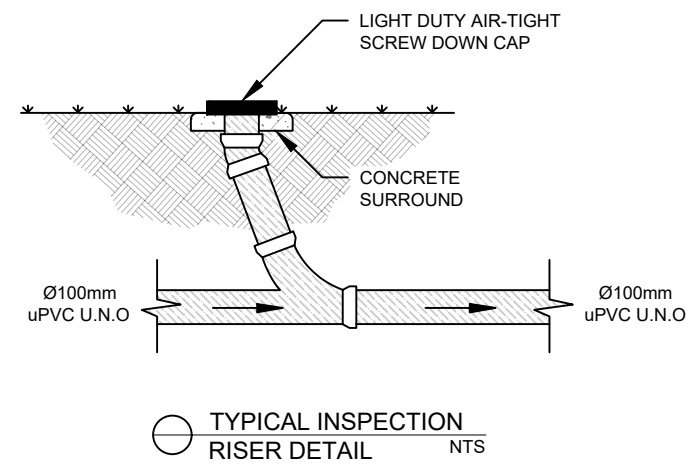
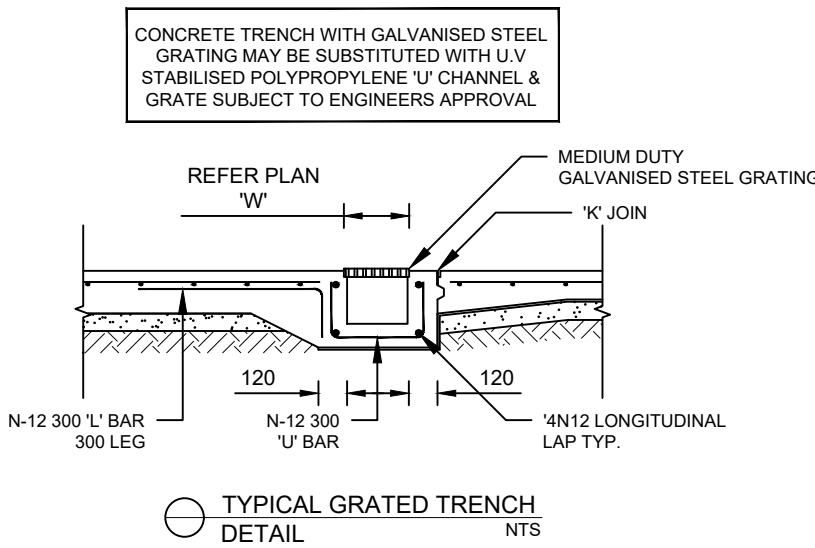
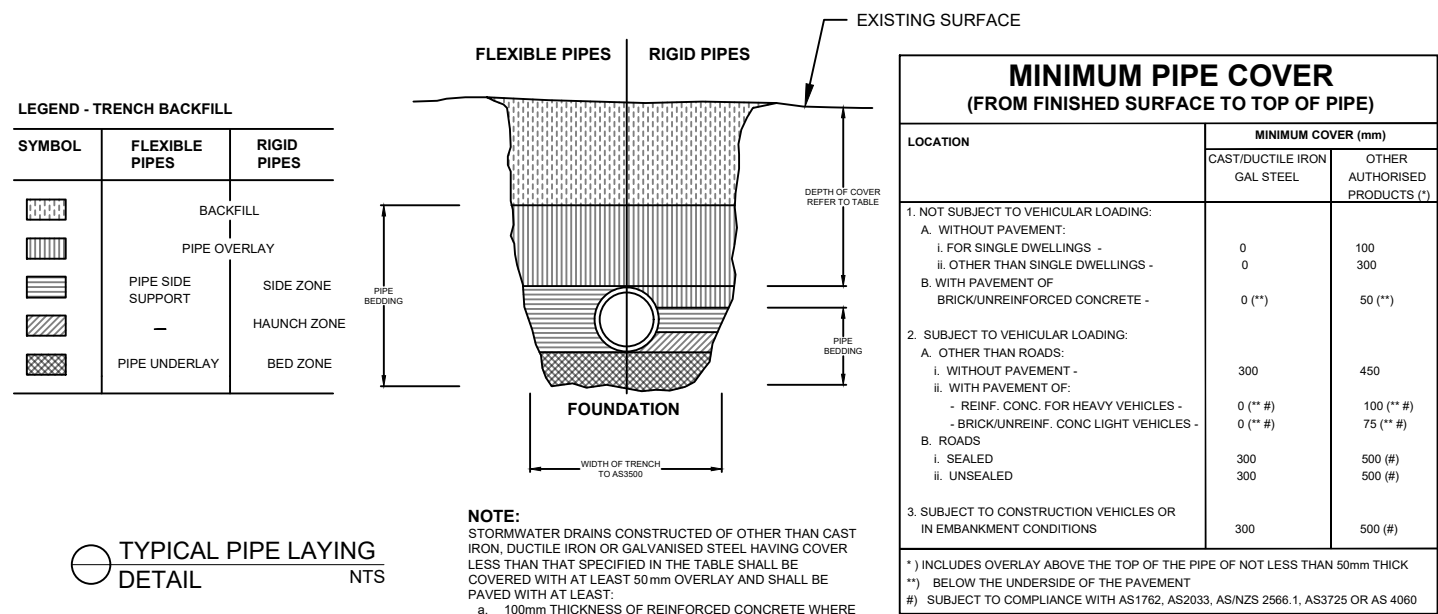

ON-SITE DETENTION NOTE:

AS PER CLAUSE 9.2 OF NORTHERN BEACHES DCP, OSD WILL NOT BE REQUIRED WHERE THE SITE OF THE DEVELOPMENT IS LOCATED WITHIN A COUNCIL ESTABLISHED 1 IN 100 YEAR ARI FLOOD PLAIN.

THEREFORE OSD SYSTEM HAS NOT BEEN DESIGNED FOR THE PROPOSED DEVELOPMENT OF THE SUBJECT SITES.

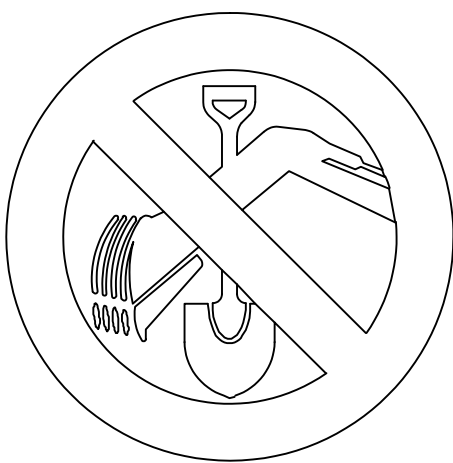
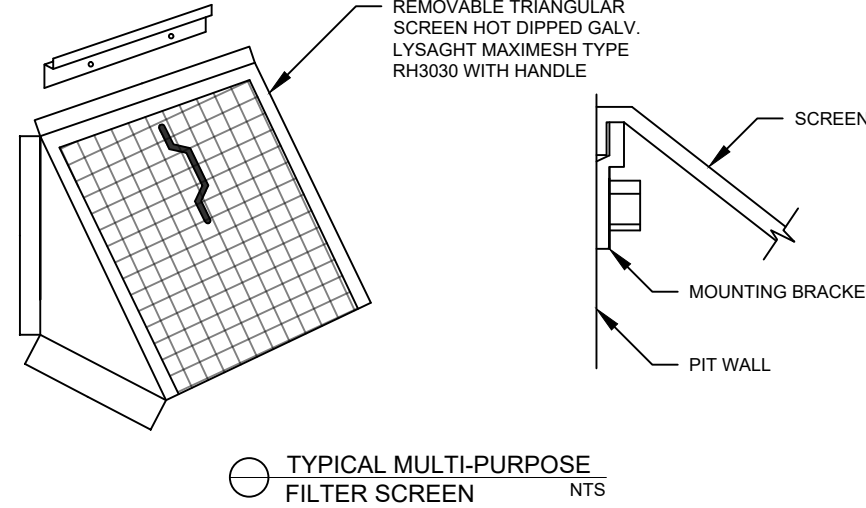
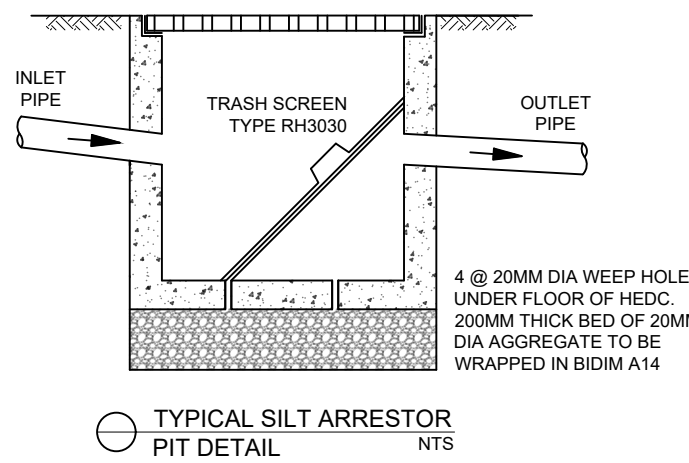
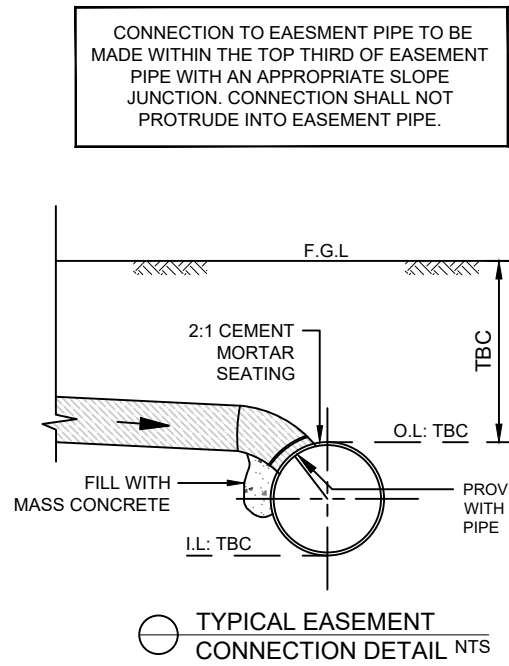
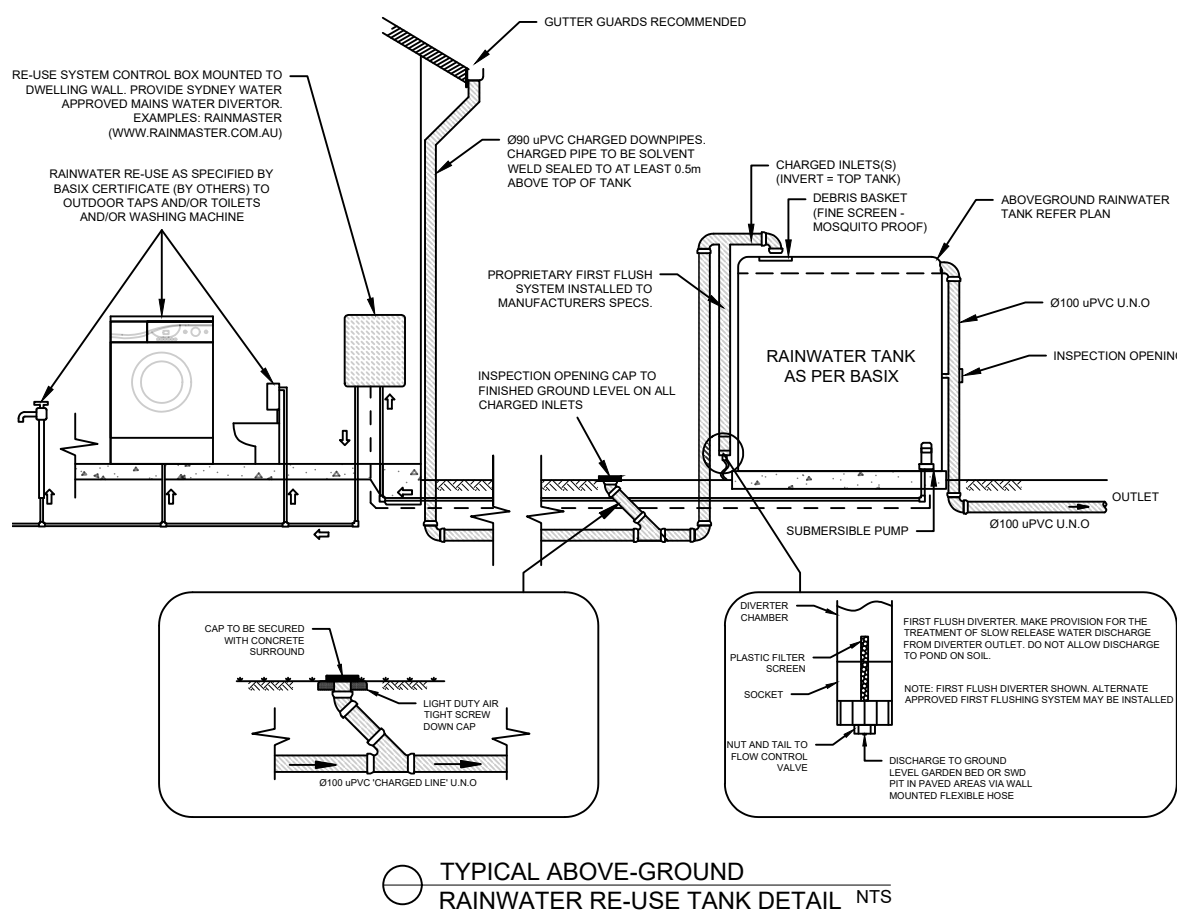

DIAL 1100 BEFORE YOU DIG

CONCEPT ONLY
NOT FOR CONSTRUCTION

NOTE
DO NOT SCALE OF DRAWINGS. REFER TO ARCHITECTURAL PLANS FOR LEVELS, STEPS, DIMENSIONS AND SETOUT. VERIFY DIMENSIONS ON SITE. THE ENGINEER SHALL BE NOTIFIED OF ANY VARIATIONS TO THAT SHOWN ON STRUCTURAL PLANS BEFORE COMMENCEMENT OF WORKS

REV	DATE	DESCRIPTION	BY
A	09.03.2021	ISSUED FOR DA	R.P

COPYRIGHT
All rights reserved.
These drawings, plans and specifications and the copyright are the property of SDS ENGINEERING and must not be used, reproduced or copied wholly or in part without the written permission of SDS ENGINEERING.

SDSEngineering
Suite 206/4 Columbia Ct
Norwest, NSW 2153
www.sdsengineering.com.au

PROPOSED RESIDENTIAL DEVELOPMENT
AT 26 RIVERVIEW ROAD, AVALON BEACH, NSW, 2107
FOR FUTURE FLIP
CONCEPT STORMWATER DRAINAGE PLAN/DETAILS

JOB NUMBER: 20922	DWG NUMBER: C001	ORIGINAL SIZE: A1
DESIGNED BY: R.P	DATE: 09.03.2021	
DRAWN BY: R.P	SCALE: AS SHOWN	