

Pitwater Council DCP C1.7 - Landscaping within front setback  
 - 173 m<sup>2</sup> proposed  
 - 265 m<sup>2</sup> Front setback area  
 = 66% landscaped area within DCP front setback  
 Note: Using the proposed setback would provide a greater percentage due to the proposed variation to the control. Therefore the calculation has used the compliant setback line.

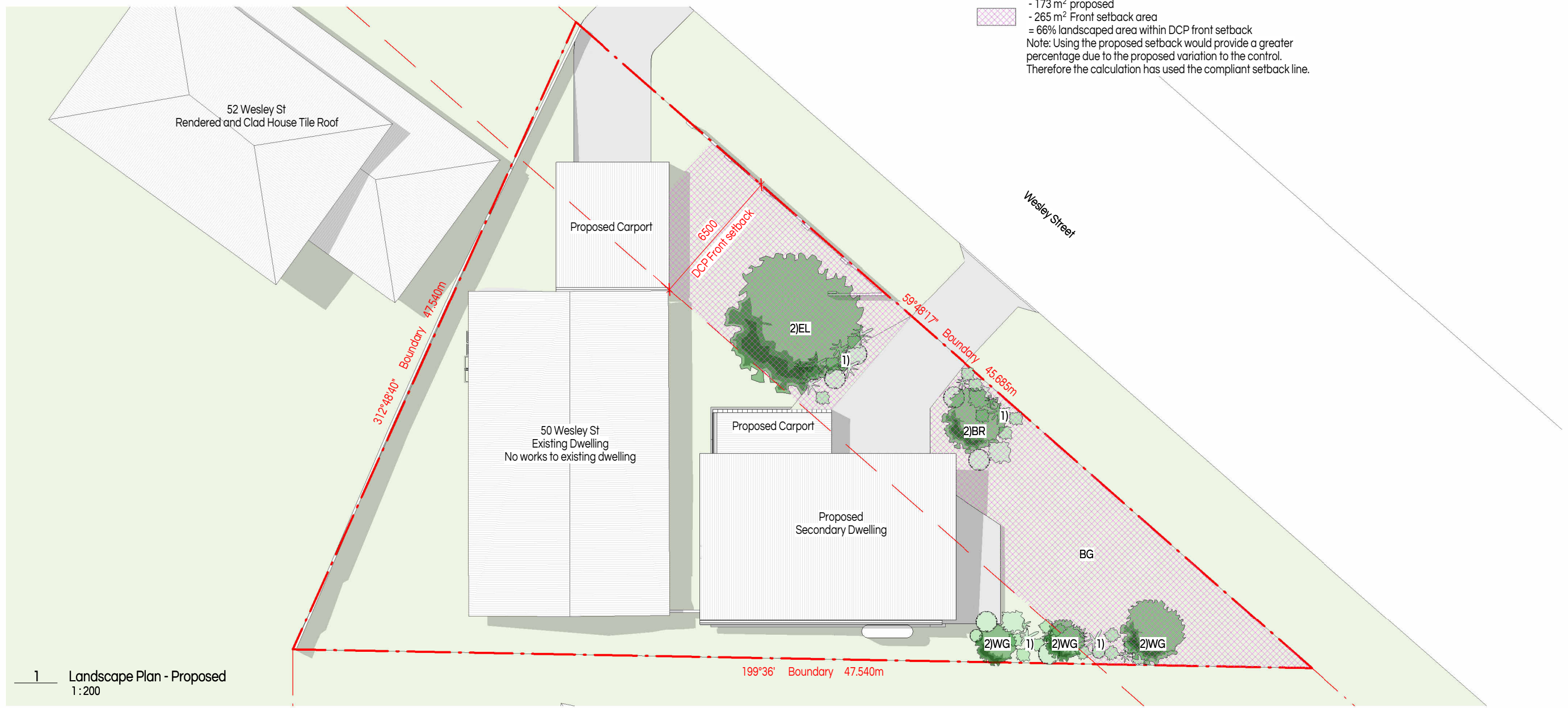

1 Landscape Plan - Proposed  
1:200

**Proposed Species List & application.**  
 Where suitable Australian plant species in a/w Native Plant Species Guide - Narrabeen Ward are to be utilised.

**Notes:**  
 All planted areas to be mulched with 100mm layer of leaf litter.  
 Trees above 300mm to be staked for 12 month establishment period.  
 Drip irrigation system to be installed connected to water storage tank.

- 1) Shrubs:**  
 CA Carissa Desert Star  
 CO Correa nummulariifolia  
 FF Actinotus Helianthi (Flannel Flower)  
 RO Rosmarinus officinalis (Rosemary)  
 XA Xanthorrhoea spp.(Grass Tree)

- 2) Trees:**  
 BR Banksia robur (Swamp Banksia)  
/>
 EL Eucalyptus lansdowneana  
 WG Tristaniopsis Laurina (Water Gum)

- 3) Lawn:**  
 BG Buffalo Grass  
 BO Natural Boulders



**buck&simple.**  
doers of stuff

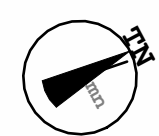

**General Notes**  
 The copyright of this design remains the property of buck&simple. This design is not to be used, copied or reproduced without the authority of buck&simple.  
 Do not scale from drawings. Confirm dimensions on site prior to the commencement of works. Where a discrepancy arises, seek direction prior to proceeding with the works.  
 This drawing is only to be used by the stated Client in the stated location for the purpose it was created. Do not use this drawing for construction unless designated.

Contact: info@buckandsimple.com  
 ABN : 86 106 604 025  
 NSW #8631 VIC #19664  
**www.buckandsimple.com**  
 Issue for DA

| No. | Description  | Date       |
|-----|--------------|------------|
| A   | Issue for DA | 18/10/2024 |

|          |   |
|----------|---|
| Project  | Proposed Secondary Dwelling and Carport |
| Location | 50 Wesley St, Elanora Heights           |
| Client   | Lachlan and Zoe Isles                   |
| Drawing  | Landscape Plan                          |

|                    |              |                  |            |            |    |
|--------------------|--------------|------------------|------------|------------|----|
| Scale @ A3         | As indicated | Drawn by         | BS         | Checked by | BS |
| Project Issue Date | 20/06/2024   | Sheet Issue Date | 18/10/2024 |            |    |
| Project number     | 1271         | Drawing #        | D070       | Revision   | A  |