

WASTE MANAGEMENT ,DEMOLITION & CONSTRUCTION PLAN



DESIGNER HOME ADDITIONS
Licence 60007c

9938 5611
www.yourstyle.com.au

PO BOX 1183 • DEE WHY 2099
TEL : 9938 5611
FAX : 9938 5911
EMAIL : sales@yourstyle.com.au
WEB : www.yourstyle.com.au
ABN 92 003 918 116 • ACN 003 918 116
BUILDER LICENCE • 60007C
A DIVISION OF TAG TEAM CONSTRUCTIONS PTY LTD

Client Name : MATHEW & REBECCA MIRABITO

Client Address : 13 CORRIE RD, NORTH MANLY 2100

Client No. : MIR 1024 04 DA

All construction work to be performed in accordance with Australian Standards and National Construction Code 2022.

© Copyright Acknowledgement

We agree and understand these drawings and plans are solely and entirely the interlectual property of Your Style Designer Home Additions and the normal copyright laws apply. License is not granted for the use of these designs or drawings.

Project Number: MIR 1024 04 DA Included Pages: 1-

Signed..... Date: Wednesday, 19 February 2025

Client's signature

Project Acceptance

We agree to these works in accordance with Your Style's Building Specification & Quote Document and this Design.

Signed..... Date:Wednesday, 19 February 2025

Your Style Designer Home Additions

Signed..... Date:Wednesday, 19 February 2025

Client's signature

Signed..... Date:Wednesday, 19 February 2025

Client's signature

Drawing Title : WASTE/DEMO/CONSTRUCTION PLAN

Project Name : First Floor Addition

Architect: Your Style Designer Home Additions

Status : DA STAGE Scale : 1:200

Plot Date : Wednesday, 19 February 2025 Drawing No. : 3

File Location: MIR 1024 04 DA.pln

Your Style Construction Certificate Excludes:

Items in red and/or listed here do not form part of Your Style's Construction Certificate and will not be approved for construction under Your Style's Construction Certificate and will require a seperate CC Application.

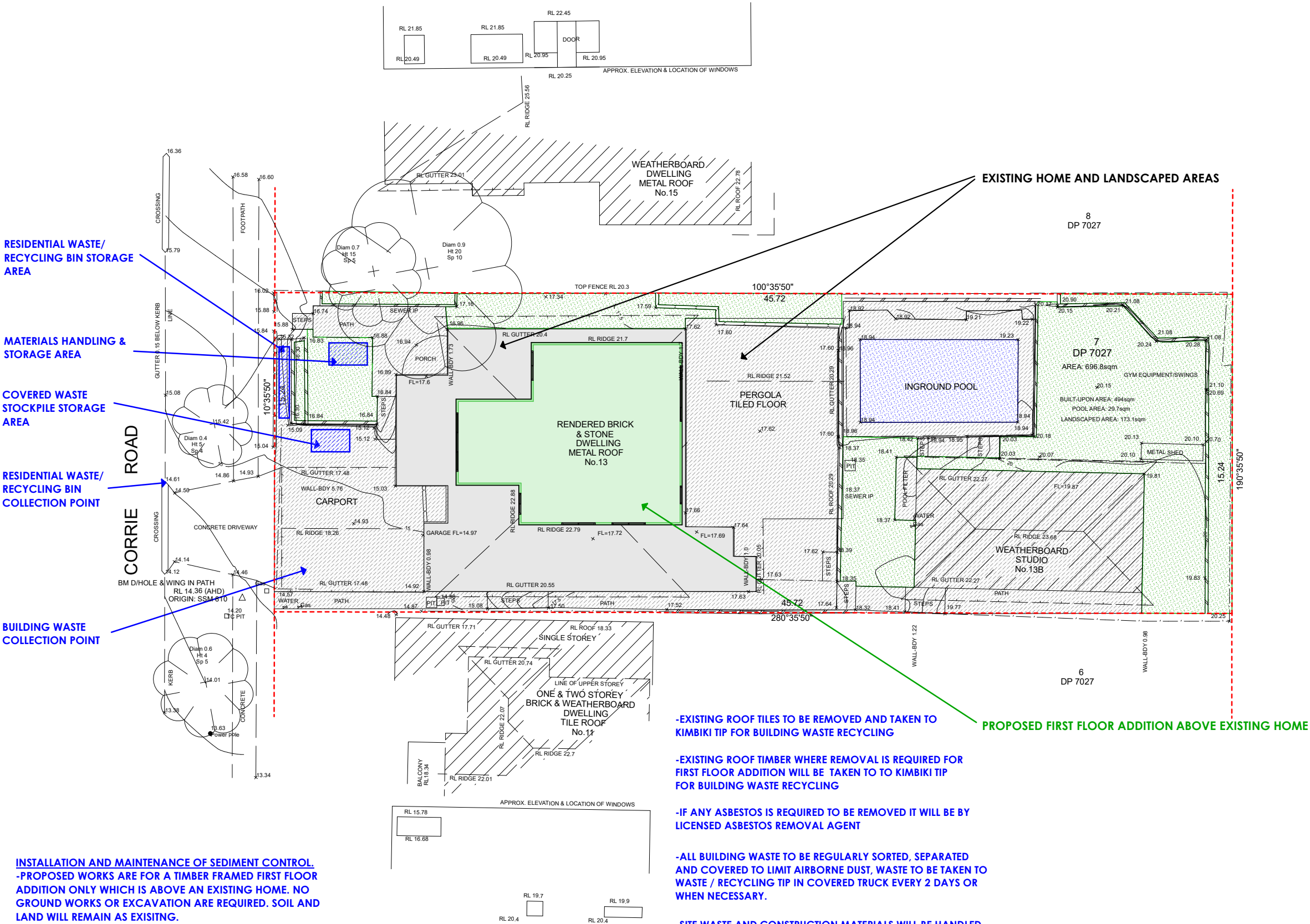

INSTALLATION AND MAINTENANCE OF SEDIMENT CONTROL.
-PROPOSED WORKS ARE FOR A TIMBER FRAMED FIRST FLOOR ADDITION ONLY WHICH IS ABOVE AN EXISTING HOME. NO GROUND WORKS OR EXCAVATION ARE REQUIRED. SOIL AND LAND WILL REMAIN AS EXISTING.

-EXISTING ROOF TILES TO BE REMOVED AND TAKEN TO KIMBIKI TIP FOR BUILDING WASTE RECYCLING

-EXISTING ROOF TIMBER WHERE REMOVAL IS REQUIRED FOR FIRST FLOOR ADDITION WILL BE TAKEN TO TO KIMBIKI TIP FOR BUILDING WASTE RECYCLING

-IF ANY ASBESTOS IS REQUIRED TO BE REMOVED IT WILL BE BY LICENSED ASBESTOS REMOVAL AGENT

-ALL BUILDING WASTE TO BE REGULARLY SORTED, SEPARATED AND COVERED TO LIMIT AIRBORNE DUST, WASTE TO BE TAKEN TO WASTE / RECYCLING TIP IN COVERED TRUCK EVERY 2 DAYS OR WHEN NECESSARY.

-SITE WASTE AND CONSTRUCTION MATERIALS WILL BE HANDLED AND KEPT ONSITE AND WILL NOT EFFECT PEDESTRIAN OR TRAFFIC MOVEMENT.

PROPOSED FIRST FLOOR ADDITION ABOVE EXISTING HOME

COPYRIGHT © DETAILED SURVEYS
NOTE: Title information has been taken from original D.P.
Any copying, altering, editing, forwarding or scanning of this plan in paper or electronic form without the permission of a Director of Detailed Surveys is strictly prohibited.
This plan has copyrights to Detailed Surveys and can be withdrawn at anytime from councils, legal professions or the like unless payment of the account has been made in full.

NOTES 1. ONLY VISIBLE UTILITY SERVICES HAVE BEEN LOCATED.
RELEVANT AUTHORITIES SHOULD BE NOTIFIED PRIOR TO EXCAVATION ON OR NEAR THE SITE.
2. BOUNDARIES HAVE BEEN DEFINED BY SURVEY TO IDENTIFICATION STANDARD. HOWEVER, IF ANY CONSTRUCTION IS PROPOSED IN PROXIMITY OF BOUNDARIES, IT IS RECOMMENDED THAT A FURTHER SURVEY BE REQUESTED FOR MARKING OF RELEVANT BOUNDARIES.
3. COVENANTS, RESTRICTIONS ON LAND USE (IF ANY) NOT INVESTIGATED.
4. ROOF LINES SHOWN ARE APPROXIMATE. SIGNIFICANT TREES (WHERE ACCESSIBLE) GREATER THAN 0.4 DIAM. SHOWN
5. APPROX. SEWER LINE (IF SHOWN) MUST BE VERIFIED BY SYDNEY WATER.

NOTE: CONTOURS ARE FOR INDICATIVE PURPOSES ONLY. FOR MORE CONCLUSIVE EVIDENCE OF LEVELS USE THE SPOT HEIGHTS GIVEN.

| | | | | | | | |
|----------------------------|---|---|--|----------|-------------|--|----------------------|
| 13 CORRIE ROAD NORTH MANLY | DETAILED SURVEYS (A.B.N. 36 233 529 164) CONSULTING SURVEYORS 87 ELANORA ROAD, ELANORA HEIGHTS, 2101 PHONE: 9913-9525 Email: jsurveyor@live.com.au | J. MCCLURE SURVEYOR REGISTERED UNDER THE SURVEYING AND SPATIAL INFORMATION ACT, 2002 Registration No 3861 J. McClure | M. MIRABITO | | | | |
| | | | LOT 7 DP 7027 BOUNDARY DEFINITION & LEVELS | | | | |
| | | | A1 REDUCTION RATIO: 1:100 | | | | DRAWING No. 1 |
| | | | SURVEY | J.McC | | | |
| | | | DRAWN | A1 J.McC | | | |
| | | | REFERENCE | 058/24 | 21 NOV 2024 | | |

