

TANK REPLACEMENT
940 PITTWATER ROAD
DEE WHY, NSW

SITE SPECIFIC DRAWINGS	
Dwg. No.	Sheet Title
NOTES	
DO 1	DRAWING LIST
DO2	GENERAL NOTES
ARCHITECTURAL	
AO 1	SITE PLAN EXISTING CONDITIONS
AO2	DEMOLITION LAYOUT
AO3	PROPOSED SITE PLAN
AO4	TANKER PATH LAYOUT
AO5	EROSION AND SEDIMENT CONTROL PLAN
AO6	ASSET LOCATION PLAN
FUEL SYSTEM	
TO 1	FUEL SYSTEM LAYOUT
LPG	
GO 1	LPG SYSTEM LAYOUT
GO2	POPULATION AND EXCLUSION ZONES
ELECTRICAL	
EO 1	ELECTRICAL CONDUIT LAYOUT
HAZARDOUS	
HZO 1	HAZARDOUS AREA LAYOUT
HZO2	HAZARDOUS AREA ELEVATIONS
DRAINAGE & CONCRETE	
HO 1	SITE DRAINAGE PLAN
CO 1	CONCRETE REPLACEMENT PLAN

INFORMATION ISSUE

-	-	-	-	
0	16.12.19	EZ	INITIAL HAZKEM ISSUE	
NO.	DATE	BY	AMENDMENT	APPROVED

7-ELEVEN STORES

INCORPORATED IN VICTORIA TELEPHONE (03) 9541 0711 FAX (03) 9541 0782

357 FERNTREE GULLY ROAD MOUNT WAVERLEY
VICTORIA 3149 AUSTRALIA

PTY LTD

A.B.N. 48 005 289 427



DATE CREATED 16.12.19	PROJECT 7 ELEVEN SERVICE STATION TANK REPLACEMENT 940 PITTWATER ROAD DEE WHY, NSW			
DRAWN BY EZ	TITLE DRAWING LIST			
CHECKED BY				
APPROVAL FOR ISSUE				
SCALE NTS @A3	SHEET A3	SHEET SIZE A3	DRAWING No. HAZ-2563-D01	REVISION NO. 0
DATE PLOTTED				

NOTES

1 GENERAL

THESE DRAWINGS ARE TO BE READ IN CONJUNCTION WITH:
7ELEVEN STORES SPECIFICATION " THE DESIGN & INSTALLATION OF UPSS"

2 TANK PIT - EXCAVATION

- . DEWATERING & TEMPORARY SHORING MAY BE REQUIRED DURING TANK EXCAVATION/INSTALLATION. REFER TO GEOTECHNICAL REPORT FOR SHORING AND ADDITIONAL GEOTECHNICAL PROTECTIVE MEASURES TO BE ADOPTED.
- . SHORING WILL BE REQUIRED, REGARDLESS OF GEOTECHNICAL RECOMMENDATIONS, WHERE EXCAVATION ENCROACHES INTO ADJOINING PROPERTIES OR MAY INTERFERE WITH EXISTING FOOTINGS OR FOUNDATIONS.
- . SHORING IS TO BE DESIGNED AT CONTRACTOR'S COST BY A CHARTERED CIVIL ENGINEER AND SUBMITTED TO THE CONSTRUCTION MANAGER FOR APPROVAL PRIOR TO COMMENCEMENT OF EARTHWORKS. IT IS THE CONTRACTOR'S RESPONSIBILITY TO LOCATE ALL EXISTING SERVICES PRIOR TO EXCAVATION.
- . PROTECTION OF ALL SERVICES & COUNCIL PROPERTY IS THE RESPONSIBILITY OF THE CONTRACTOR. ALL DAMAGE TO OFF-SITE PROPERTY CAUSED BY THE CONSTRUCTION SHALL BE MADE GOOD BY THE CONTRACTOR AT THE CONTRACTOR'S EXPENSE.
- . FINAL LOCATION OF TRENCHING FOR FUEL SYSTEM PIPEWORK AND ELECTRICAL SYSTEM CONDUITS IS TO BE APPROVED BY THE CONSTRUCTION MANAGER. TRENCHING TO BE RATIONALISED AS MUCH AS PRACTICABLE.
- . CONTRACTOR TO ALLOW TO BATTER OR STEP EXCAVATION UNLESS GEOTECHNICAL RECOMMENDATION CALLS FOR A SHORED EXCAVATION.
- . EXCAVATED MATERIALS REMOVED FROM EXISTING EXCAVATIONS CANNOT BE RE-USED AS FILL MATERIAL.
- . FILL EXCAVATIONS ARE TO BE BACKFILLED WITH APPROVED IMPORTED BACKFILL MATERIAL AS PER TANK MANUFACTURER INSTALLATION PROCEDURES.
- . GEOTEX FABRIC IS TO BE USED TO LINE THE TANK EXCAVATION. NOTE : STORAGE TANK BACKFILL MATERIAL SHALL BE IN ACCORDANCE WITH TANK MANUFACTURER SPECIFICATIONS.

3 TANK INSTALLATION

- . MINIMUM TANK BURIAL DEPTH TO BE 900 mm.
- . MINIMUM CLEARANCE TANK TO BOUNDARIES IS 2000 mm UNO.
- . IT IS THE CONTRACTOR'S RESPONSIBILITY TO LOCATE ALL EXISTING SERVICES PRIOR TO EXCAVATION.
- . REFER TO STANDARD DRAWING GEN I 7-TOO3 FOR TANK EXCAVATION CLEARANCES FOR SHORED AND NON-SHORED INSTALLATIONS.
- . PROPERTY DAMAGE CAUSED BY THE CONSTRUCTION SHALL BE MADE GOOD. INSTALLATION CONTRACTOR IS TO OBTAIN TANK MANUFACTURER'S APPROVAL OF BACKFILL MATERIAL AND MATERIAL GRADING CHART.
- . TANK PRIMARY AND SECONDARY SPACE INTEGRITY IS TO BE PROVEN PRIOR TO INSTALLATION, IN ACCORDANCE WITH THE SPECIFICATION.
- . INSTALLATION CONTRACTOR IS TO PROVIDE SUITABLE AND ADEQUATE TANK INSTALLATION AND INSTALLATION SAFETY PROCEDURES IN THE SITE SAFETY MANAGEMENT PLAN, AND SHALL PROVE SUFFICIENT COMMUNICATION OF THESE TO THE SITE STAFF.
- . ALL TANKS ARE TO BE HELD DOWN TO MANUFACTURER'S SPECIFICATIONS.
- . TOP OF EXCAVATION BATTER IS SHOWN DIAGRAMMATIC ONLY. REFER STANDARD DRAWING GEN I 7-TOO3 AND SITE SPECIFIC DRAWINGS FOR FINAL NUMBER AND LOCATIONS OF WELLS.
- . NO SERVICES ARE PERMITTED TO CROSS THE TANK EXCAVATION.

4 TANK FITTINGS - TANK REPLACEMENT/NEW INSTALLATION

- . TANK MANWAY PAVEMENT COVER. REFER STANDARD DRAWING GEN I 7-TO10-2 FOR DETAILS.
- . PAVEMENT TO BE RAISED AROUND ALL FORECOURT PENETRATIONS TO RESIST WATER INGRESS AND TO PROMOTE SURFACE WATER RUNOFF AWAY FROM PAVEMENT COVERS.
- . NEW TANK SUMPS AND LIDS TO BE INSTALLED.
- . CONTRACTOR IS TO PROVIDE CLEAR PERMANENT NOTICE ON TANK SUMP INNER LID "DO NOT ENTER-TRAINED PERSONNEL ONLY".
- . TANK SUMP AND LID SEAL TO BE WATERTIGHT. SUMPS ARE TO BE WATER TESTED TO CONFIRM.
- . SUMPS TO HAVE TELEFLEX AND BALL VALVES.

5 FUEL SYSTEM LINEWORK

- . MINIMUM PIPE GRADE IS 1 : 100 BACK TOWARDS THE TANKS.
- . MINIMUM PIPE COVER TO BE 300mm (UNDER CONCRETE) OR 450mm UNDER LANDSCAPED AREAS.
- . ALL DIRECT BURIED STEEL FITTINGS ARE TO BE DENSO WRAPPED OR OTHERWISE CATHOLICALLY PROTECTED.
- . FUEL SYSTEM PIPEWORK IS TO PENETRATE AS CLOSE AS PERPENDICULAR TO TANK SUMP WALLS AS POSSIBLE.
- . ALL PRODUCT LINES ARE TO BE TAGGED AT BOTH ENDS IMMEDIATELY ON INSTALLATION TO PERMIT CORRECT EQUIPMENT FIT-OFF.
- . ALL PRODUCT LINES ARE TO BE TAGGED AT BOTH ENDS IMMEDIATELY ON INSTALLATION TO PERMIT CORRECT EQUIPMENT FIT-OFF.
- . ALL PRODUCT, FILL, VENT,VR LINES ARE TO BE PRECISION TESTED, IN ISOLATION, IN ACCORDANCE WITH THE SPECIFICATION.
- . PIPING IS TO BE LAID TO MANUFACTURER'S PROCEDURES AND WITH A MINIMUM NUMBER OF BENDS. ROUTES SHOWN ARE INDICATIVE ONLY, USE SHORTEST PRACTICABLE ROUTE TO MINIMISE PIPE LENGTH.
- . MAX LENGTH OF SINGLE STRAIGHT FILL PIPING RUN IS 12m.
- . PRODUCT PIPING TERMINATION TO BE DIRECT PIPED. FLANGES & TITEFLEX HOSES ARE NOT TO BE USED.

6 IN-GROUND REMOTE FILL POINTS

- . SPILL CONTAINMENT BOX TO BE INSTALLED. REFER TO STANDARD DRAWINGS.
- . FUEL SPILL CONTAINMENT BOX TO BE APPROVED BY 7-ELEVEN ENGINEER AND TO BE CAPABLE OF CONTAINING A MINIMUM OF 15 LITRES OF PRODUCT
- . FILL POINT PERMANENT PAVEMENT MARKERS ARE TO BE FIXED TO THE PAVEMENT FACING THE TANKER DRIVER.
- . FILL RISERS AND INTERNAL SPILL CONTAINERS ARE TO BE EARTHED.
- . VERIFY THE SETTING AND OPERATION OF ALL FILL LINE OVERFILL PROTECTION VALVES IF FITTED. VALVES TO BE SET TO 95% ACTUAL TANK CAPACITY.
- . CHAIN AND TAGS TO BE NOMINATED AROUND ALL RISERS.
- . FILL LINES TO BE TAGGED AT BOTH ENDS PRIOR TO BACKFILLING
- . FILL/ SPILL CONTAINMENT SUMPS TO BE TESTED AFTER INSTALLATION TO ENSURE NO LEAKAGE
- . DIRECT FILL RISERS TO BE DENSO WRAPPED.

7 DIP POINTS

- . DIP RISERS ARE TO HAVE LOCKABLE SIDE SEAL CAPS FIXED BY CHAINS AND PRODUCT ID MARKERS FIXED TO THE RISERS BELOW THE ADAPTORS.
- . PAVEMENT DIP POINT COVERS ARE TO BE PAINTED APPROPRIATE TO PRODUCT AND/OR HAVE PERMANENT PAVEMENT MARKERS FITTED.
- . DIP RISERS TO BE DENSO WRAPPED.
- . ADEQUATE CLEARANCE TO BE GIVEN BETWEEN ALL RISERS CAPS AND UNDERSIDE OF PAVEMENT COVERS. (REFER STANDARD DRAWINGS)
- . RISERS AND CAPS TO BE CLEAR OF PROTECTIVE SURROUND TO PERMIT EASY OPENING AND CLOSING OF CAPS.
- . DIP CAPS TO BE 100mm SCREWED BRASS CAPS.

8 VENTS

- . NEW VENT STACK. REFER STANDARD DRAWING GEN I 7-TOO5 FOR DETAILS.
- . FREE FLOW VENT CAPS TO BE INSTALLED UNO.
- . VENT STACK TO BE PAINTED TO 7ELEVEN PAINT SPECIFICATION.
- . VENT TERMINATION TO BE ISOLATABLE VIA EXTRACTOR IF DIRECT BURIED.
- . VENT RISERS TO BE DENSO WRAPPED.

9 MONITORING SYSTEMS

- . GVR-TLS-450PLUS TO BE INSTALLED UNO.
- . AUTOMATIC TANK GAUGE PROBES ARE TO BE FITTED TO ALL TANK COMPARTMENTS. REFER STANDARD DRAWING GEN I 7-TO10
- . CONTRACTOR IS TO CONFIRM LOCATION OF PROBES IN TANKS WITH THE CONSTRUCTION MANAGER PRIOR TO INSTALLATION.
- . PRESSURE LINE LEAK DETECTION IS TO BE INSTALLED IN ALL PRESSURE PRODUCT DELIVERY SYSTEMS.
- . CONDUITS AND CABLES ARE TO BE INSTALLED AS NOTED ON STANDARD DRAWINGS. REFER TO SITE ELECTRICAL DRAWING FOR APPROXIMATE LOCATIONS OF EQUIPMENT AND CONDUIT PATHS.
- . WHERE POSSIBLE, PROBES ARE TO BE INSTALLED IN TANK SUMPS.
- . PROBE, CONSOLE, SENSOR & CABLING INSTALLATION, PROGRAMMING, TESTING COMMISSIONING AND TRAINING TO BE CONDUCTED BY CERTIFIED AND ENDORSED CONTRACTORS. SYSTEM MUST BE FULLY OPERATIONAL FOR PRODUCT TO BE SAFELY STORED. COMMISSIONING CHECK SHEETS MUST BE PRESENTED TO CM AND STAFF TRAINED.

10 PUMPS/DISPENSERS

- . ALL PUMPS/DISPENSERS TO HAVE CONTAINMENT SUMPS FITTED. REFER STANDARD DRAWINGS FOR DETAILS.
- . WHERE ISLANDS ARE REQUIRED, CONSTRUCT IN ACCORDANCE WITH 7ELEVEN STANDARD.
- . SUPPLY AND INSTALL INVERTED "U" BOLLARDS WHERE SHOWN.
- . SHEAR VALVE TO PRESSURE PIPE CONNECTION TO BE VIA TITEFLEX LINE. REFER STANDARD DRAWING GEN I 7-TOO8-3 FOR DETAILS.
- . EXPOSURE OF CANOPY FOOTINGS MAY REVEAL FOOTING AS BEING TOO HIGH. 7ELEVEN IS TO ORGANISE A STRUCTURAL ENGINEER TO INSPECT AND ADVISE REGARDING SUMP INSTALLATION.
- . DISPENSERS ARE TO BE INSTALLED & COMMISSIONED BY DISPENSER SUPPLIERS.

11 FORECOURT

- . PAVEMENT THICKNESS, JOINTING, COLOUR AND FINISH IS TO BE IN ACCORDANCE WITH SITE CIVIL DRAWING.
- . CONTRACTOR IS TO PROVIDE ALL LINE MARKING AS SHOWN ON DRAWINGS.
- . FILL POINT PAVEMENT LIDS TO BE ELEVATED TO PROMOTE WATER RUNOFF.
- . FILL LINES TO BE TAGGED AT BOTH ENDS PRIOR TO BACK FILLING.
- . SPILL CONTAINERS TO BE WATER TESTED AGAINST RISERS TO ENSURE NO LEAKAGE.
- . SPILL CONTAINERS ARE TO BE LEFT CLEAN AND DRY.
- . CONTRACTOR TO HOARD/SECURE SITE FOR DURATION OF WORKS
- . CONTRACTOR TO INSTALL TEMPORARY FENCING AROUND SITE BOUNDARIES.



INFORMATION ISSUE

- 0	- 16.12.19	- EZ	- INITIAL HAZKEM ISSUE	
NO.	DATE	BY	AMENDMENT	APPROVED

7-ELEVEN STORES

INCORPORATED IN VICTORIA TELEPHONE (03) 9541 0711 FAX (03) 9541 0782

357 FERNTREE GULLY ROAD MOUNT WAVERLEY
VICTORIA 3149 AUSTRALIA

PTY LTD

A.B.N. 48 005 299 427

DATE CREATED 16.12.19	PROJECT 7 ELEVEN SERVICE STATION TANK REPLACEMENT 940 PITTWATER ROAD DEE WHY, NSW			
DRAWN BY EZ	TITLE GENERAL NOTES			
CHECKED BY				
APPROVAL FOR ISSUE	SHEET	SHEET SIZE A3	DRAWING No. HAZ-2563-D02	REVISION No. 0
SCALE NTS @A3				
DATE PLOTTED				

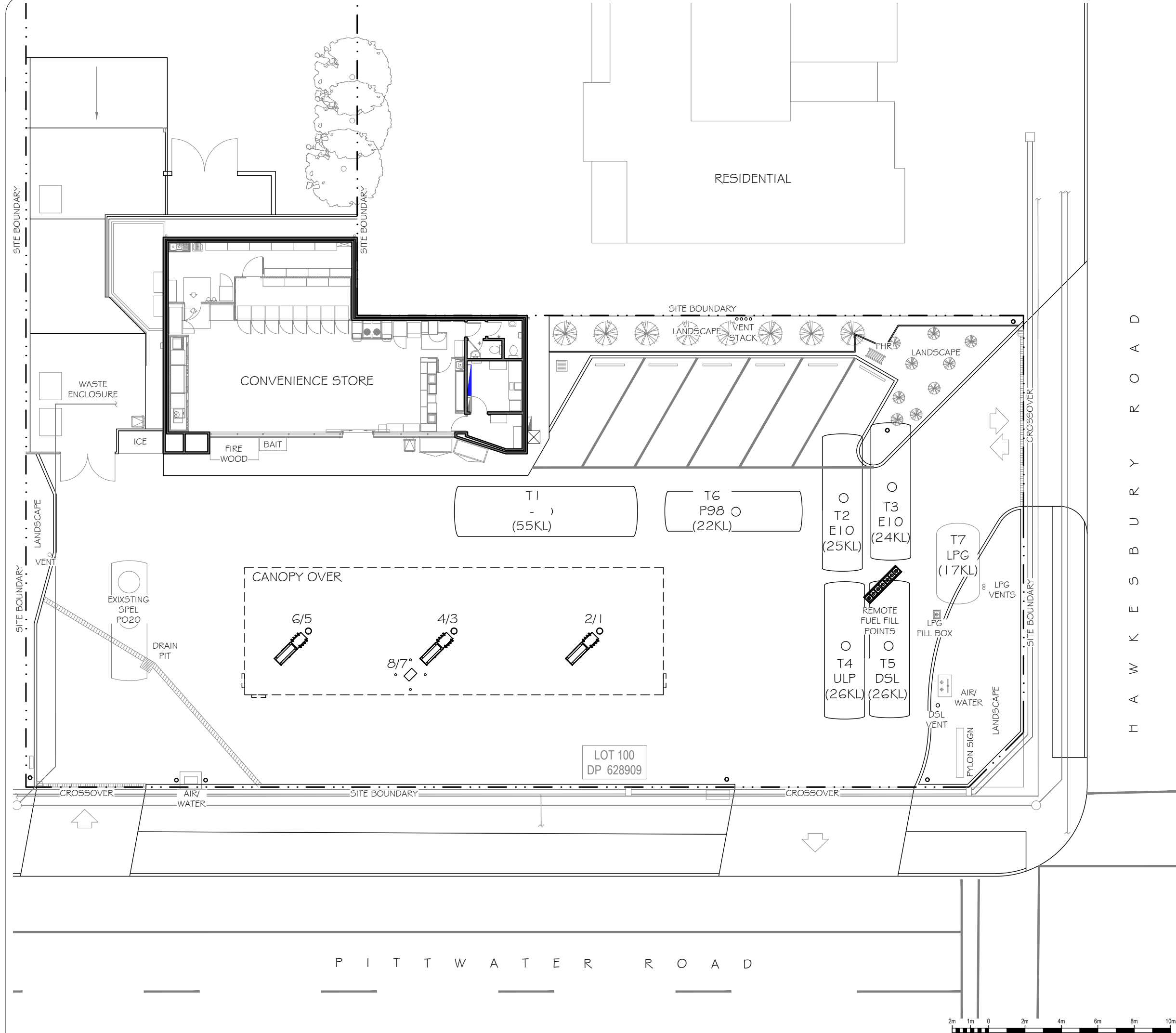

INFORMATION ISSUE

0	16.12.19	EZ	INITIAL HAZKEM ISSUE	APPROVED
NO.	DATE	BY	AMENDMENT	

7-ELEVEN STORES PTY LTD
INCORPORATED IN VICTORIA TELEPHONE (03) 9541 0711 FAX (03) 9541 0782
357 FERN TREE GULLY ROAD MOUNT WAVERLEY
VICTORIA 3149 AUSTRALIA



DATE CREATED 16.12.19
DRAWN BY EZ
CHECKED BY
APPROVAL FOR ISSUE
SCALE 1:200 @A3
DATE PLOTTED

PROJECT 7 ELEVEN SERVICE STATION TANK REPLACEMENT 940 PITTWATER ROAD DEE WHY, NSW			
TITLE SITE PLAN EXISTING CONDITIONS			
SHEET	SHEET SIZE A3	DRAWING No. HAZ-2563-A01	REVISION NO. 0

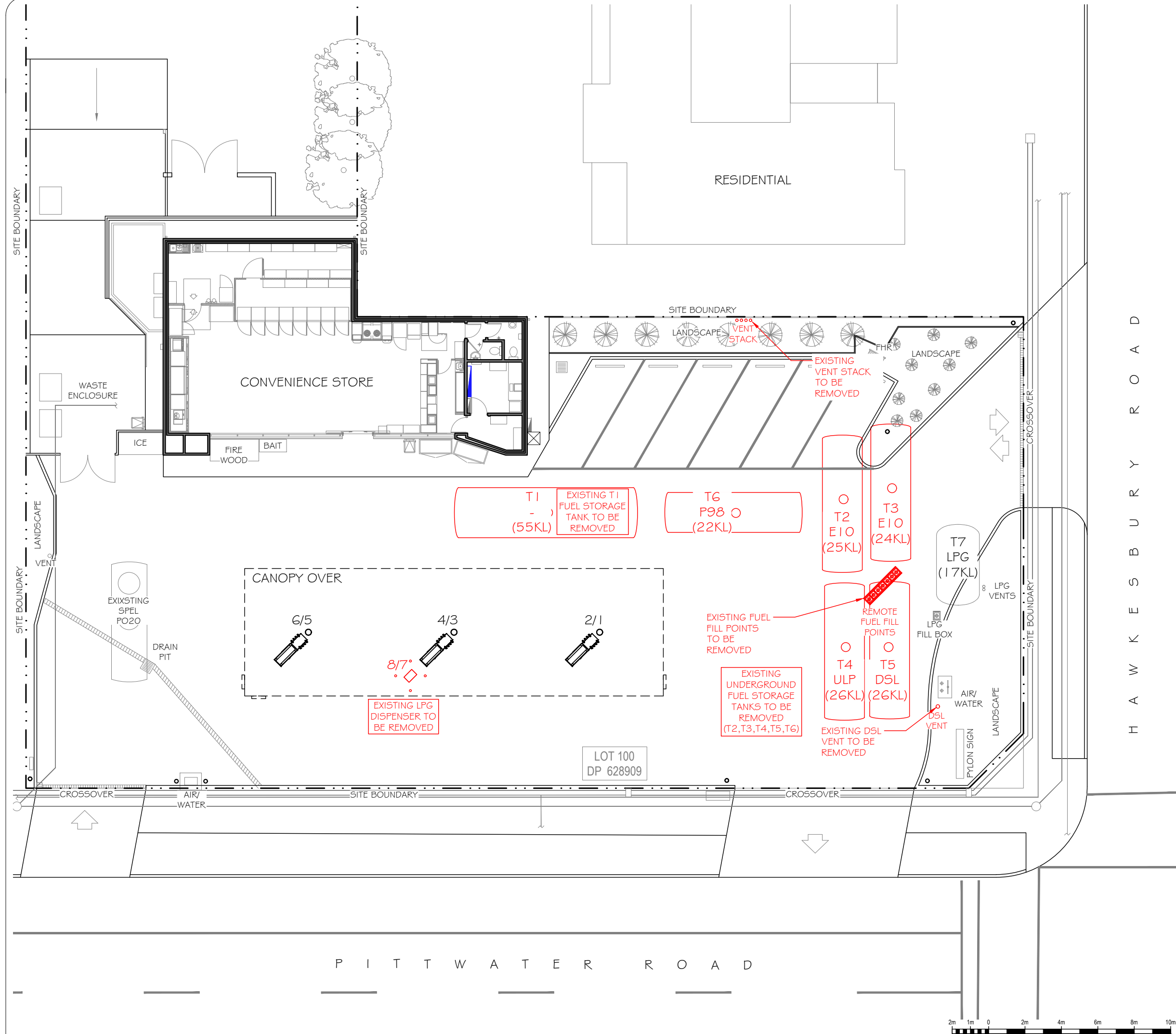

INFORMATION ISSUE

10	10.02.20	EZ	55KL TANK REMOVED	
NO.	DATE	BY	AMENDMENT	APPROVED

7-ELEVEN STORES PTY LTD
INCORPORATED IN VICTORIA TELEPHONE (03) 9541 0711 FAX (03) 9541 0782
357 FERN TREE GULLY ROAD MOUNT WAVERLEY
VICTORIA 3149 AUSTRALIA



DATE CREATED 16.12.19	PROJECT 7 ELEVEN SERVICE STATION TANK REPLACEMENT 940 PITTWATER ROAD DEE WHY, NSW
DRAWN BY EZ	TITLE DEMOLITION LAYOUT
CHECKED BY	SHEET A3
APPROVAL FOR ISSUE	DRAWING No. HAZ-2563-A02
SCALE 1:200 @A3	REVISION NO. 0
DATE PLOTTED	

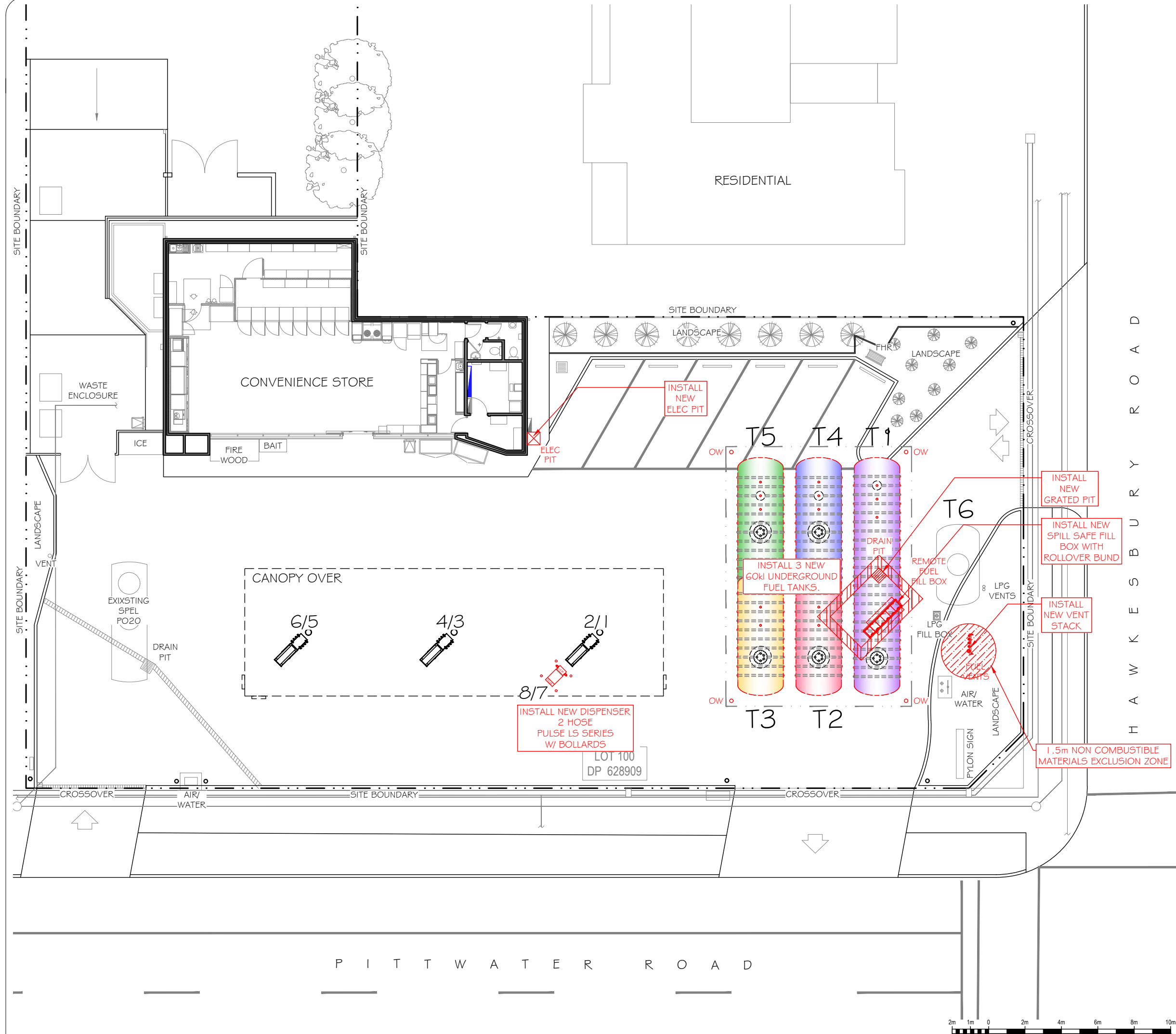

INFORMATION ISSUE

10	10.02.20	EZ	55KL TANK REMOVED	
0	16.12.19	EZ	INITIAL HAZKEM ISSUE	
NO.	DATE	BY	AMENDMENT	APPROVED

7-ELEVEN STORES
INCORPORATED IN VICTORIA TELEPHONE (03) 9541 0711 FAX (03) 9541 0782
357 FERNTREE GULLY ROAD MOUNT WAVERLEY
VICTORIA 3149 AUSTRALIA

PTY LTD
A.B.N. 48 005 299 427

DATE CREATED 16.12.19	PROJECT 7 ELEVEN SERVICE STATION TANK REPLACEMENT 940 PITTWATER ROAD DEE WHY, NSW
DRAWN BY EZ	TITLE PROPOSED SITE PLAN
CHECKED BY	SHEET A3
APPROVAL FOR ISSUE	DRAWING No. HAZ-2563-A03
SCALE 1:200 @A3	REVISION No. 0
DATE PLOTTED	

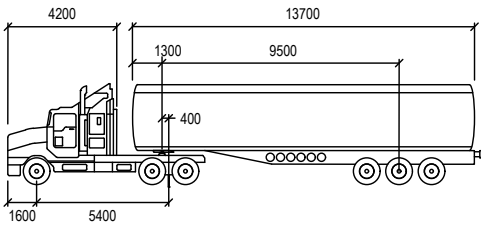

19M TRI AXLE TANKER		mm	
Tractor Width	: 2500	Lock to Lock Time	: 6.0
Trailer Width	: 2500	Steering Angle	: 25.1
Tractor Track	: 2500	Articulating Angle	: 70.0
Trailer Track	: 2500		

INFORMATION ISSUE

1	10.02.20	EZ	55KL TANK REMOVED	
0	16.12.19	EZ	INITIAL HAZKEM ISSUE	
NO.	DATE	BY	AMENDMENT	APPROVED

7-ELEVEN STORES PTY LTD
INCORPORATED IN VICTORIA TELEPHONE (03) 9541 0711 FAX (03) 9541 0782
357 FERNTREE GULLY ROAD MOUNT WAVERLEY
VICTORIA 3149 AUSTRALIA



DATE CREATED 16.12.19
DRAWN BY EZ
CHECKED BY
APPROVAL FOR ISSUE
SCALE 1:250 @A3
DATE PLOTTED

PROJECT 7 ELEVEN SERVICE STATION TANK REPLACEMENT 940 PITTWATER ROAD DEE WHY, NSW			
TITLE TANKER PATH LAYOUT			
SHEET	SHEET SIZE A3	DRAWING No. HAZ-2563-A04	REVISION NO. 0

LEGEND

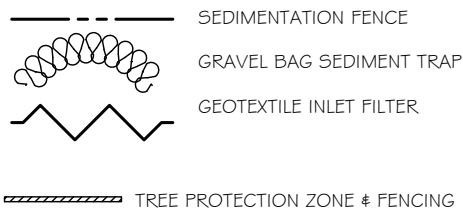

TREE PROTECTION MEASURES

- TREE PROTECTION FENCING IS TO BE ERECTED DEFINING A 5m RADIUS.
- PROTECTIVE FENCING SHALL COMPRISE CHAIN LINK WIRE AND NO LESS THAN 1.8m HIGH AND ANCHORED DOWN WITH CONCRETE BLOCKS/STIFFUPS IN A NON-INTRUSIVE MANNER.
- THE FENCING MUST BE SIGN POSTED, INCLUDING PROJECT ARBORIST DETAILS, TO WARN ALL RELEVANT CONTRACTORS OF TPZ AND STATE THE FOLLOWING:
"TREE PROTECTION ZONE: ENTRY NOT PERMITTED INTO THE TPZ WITHOUT CONSULTING THE PA."

SEQUENCE OF WORKS

THE INSTALLATION OF SOIL AND WATER MANAGEMENT FEATURE MUST BE INSTALLED IN THE FOLLOWING ORDER -

- CONSTRUCT SILT FENCES BELOW SITE AND ACROSS ALL RUNOFF AREAS.
- PROVIDE SANDBAG KERB INLET SEDIMENT TRAPS AROUND ANY EXISTING STORMWATER PITS AND WITHIN TABLE DRAINS.
- CONSTRUCT DETENTION TANK FOR USE AS A SILTATION BASIN. LIMIT OUTFLOW FROM BASIN.
- CONSTRUCT MEASURES TO DIVERT UPSTREAM FLOWS AWAY FROM SITE, WHERE POSSIBLE.
- DIVERT ALL RUNOFF FROM SITE TO DETENTION TANK/SEDIMENT POND VIA FENCES, SWALES AND BUNDS.
- PROVIDE SANDBAG KERB INLET SEDIMENT TRAPS AROUND STORMWATER PITS AS THEY ARE CONSTRUCTED.

HAZKEM

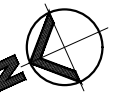

TEMP. CONSTRUCTION EXIT

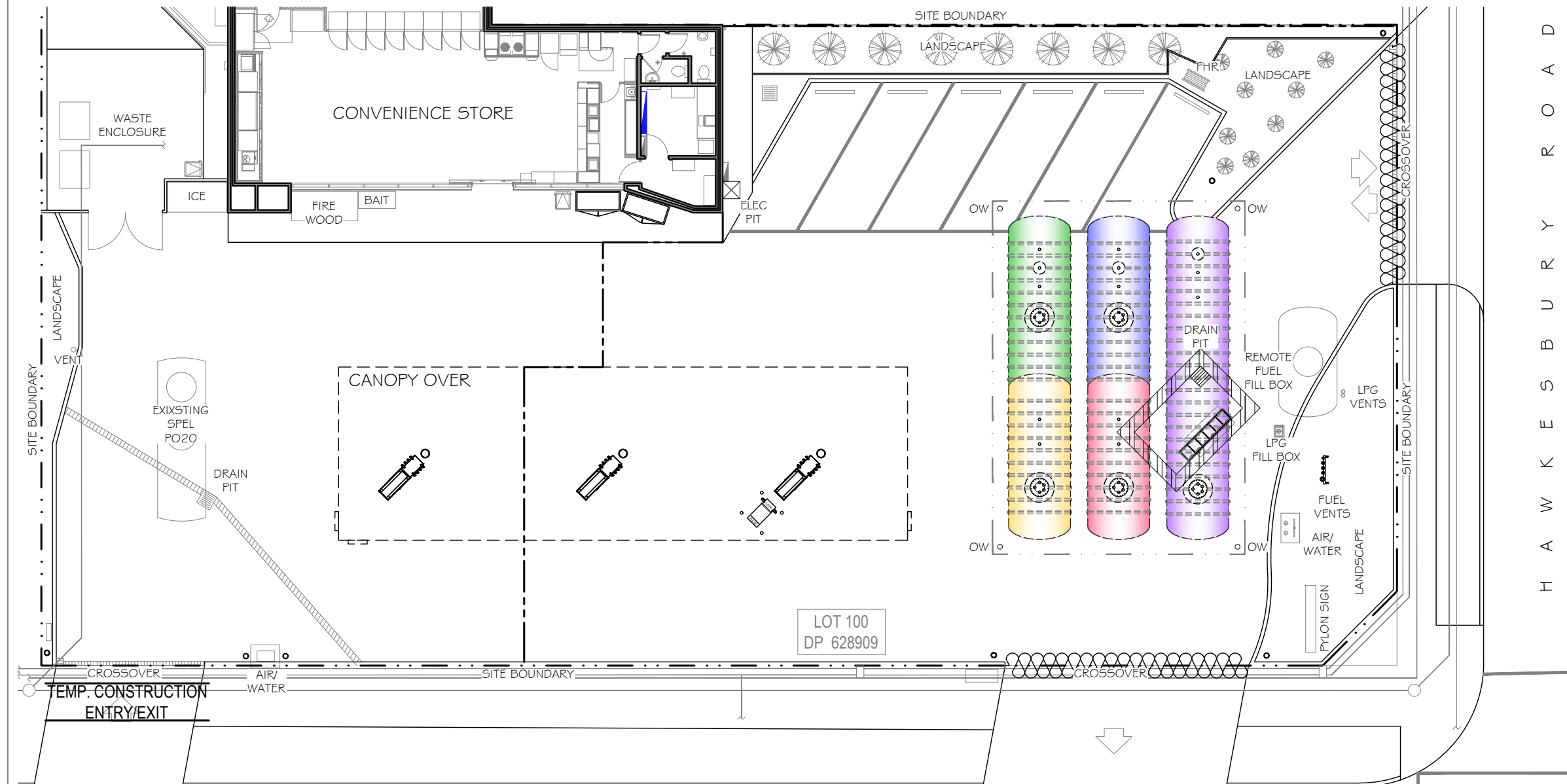

EROSION AND SEDIMENT CONTROL

- ALL WORK TO BE CARRIED OUT IN ACCORDANCE WITH: MANAGING URBAN STORMWATER - SOILS AND CONSTRUCTION, MARCH 2004.
- EROSION AND SEDIMENT DEVICES TO BE INSTALLED PRIOR TO COMMENCEMENT OF WORK.
- MAINTAIN ALL EROSION AND SEDIMENT CONTROL DEVICES IN ACCORDANCE WITH THE REQUIREMENTS IN THE NOMINATED DOCUMENTS TO THE SATISFACTION OF THE SUPERVISING ENGINEER.
- PREVENT SITE RUNOFF ENTERING ANY STORMWATER PITS THAT WERE NOT PROTECTED BY SATISFACTORY EROSION AND SEDIMENT CONTROL.
- MINIMISE THE AREA OF THE SITE BEING DISTURBED AT ANY ONE TIME. MAXIMUM LENGTH OF OPEN EXCAVATION SHOULD NOT EXCEED 40m, WHERE PRACTICAL.
 - PROVIDE SEDIMENT FENCES AT THE DOWNSTREAM END OF ALL DISTURBED AREAS.
 - SURROUND ALL CONSTRUCTION AREAS WITH SEDIMENT FENCES.
 - SURROUND ALL STOCKPILES WITH SEDIMENT FENCES.
 - TURF STRIPS SHALL BE PLACED ON THE DOWN SLOPE SIDE OF THE SEDIMENT FENCES WHERE THERE IS NO EXISTING VEGETATION COVER.
- ANY SOIL AND WATER CONTROL MEASURES AFFECTED DURING THE DAYS WORK ARE TO BE REINSTATED AT THE END OF EACH WORKING DAY.
- ALL AVAILABLE TOPSOIL FROM WITHIN THE AREA OF DISTURBANCE SHALL BE STOCKPILED FOR THE PURPOSE OF RE-VEGETATION OR REMOVED FROM SITE TO AN APPROVED LANDFILL.
- STOCKPILE OF SOIL MATERIALS SHALL NOT BE PLACED ON NATURE STRIPS, FOOTPATHS, ROADWAYS, KERBS, ACCESS CROSSING OR WITHIN WATER WAYS.
- SOIL AND WATER CONTROL MEASURES MAY BE MODIFIED TO BEST SUIT THE CONDITIONS APPLICABLE TO ANY ONE TIME. ANY MODIFICATION MUST BE IN ACCORDANCE WITH THE NOMINATED DOCUMENTS OR AS DIRECTED BY THE SUPERVISING ENGINEER. THE SOIL & WATER CONTROL MEASURES SHOWN ON THE PLAN ARE INDICATIVE ONLY.
- CLEAN SURFACE WATER FROM UPSTREAM OF ANY WORKING AREA MUST BE CONTROLLED SO THAT IT DOES NOT ENTER THE DISTURBED AREA.
- THE UNDERBODY AND TYRES OF ANY VEHICLES LEAVING THE SITE MUST BE INSPECTED AND CLEANED AS NECESSARY.
- THE EROSION AND SEDIMENT CONTROL WORKS ARE TO BE PROVIDED OR MODIFIED IN THE SEQUENCE SPECIFIED IN THE NOMINATED DOCUMENTS.

INFORMATION ISSUE

NO.	DATE	BY	AMENDMENT	APPROVED
1	10.02.20	EZ	55KL TANK REMOVED, SEDIMENTATION FENCE ADJUSTED	
0	16.12.19	EZ	INITIAL HAZKEM ISSUE	

7-ELEVEN STORES

INCORPORATED IN VICTORIA TELEPHONE (03) 9541 0711 FAX (03) 9541 0782
357 FERNTREE GULLY ROAD MOUNT WAVERLEY
VICTORIA 3149 AUSTRALIA



DATE CREATED 16.12.19	PROJECT 7 ELEVEN SERVICE STATION TANK REPLACEMENT 940 PITTWATER ROAD DEE WHY, NSW
DRAWN BY EZ	TITLE EROSION AND SEDIMENT CONTROL PLAN
CHECKED BY	SHEET
APPROVAL FOR ISSUE	SHEET SIZE A3
SCALE 1:200 @A3	DRAWING No. HAZ-2563-A05
DATE PLOTTED	REVISION No. 0

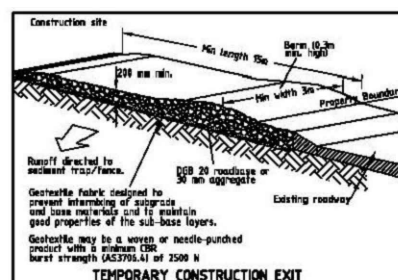
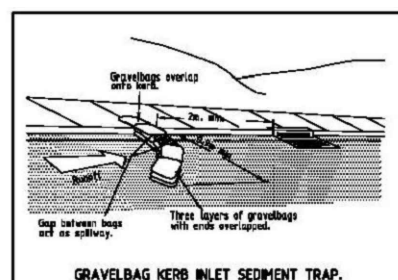
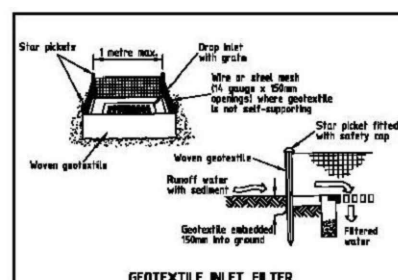
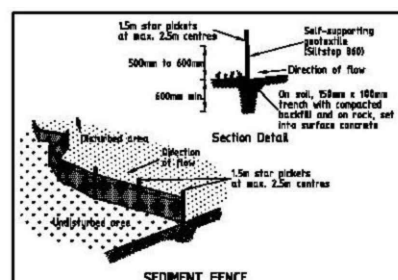
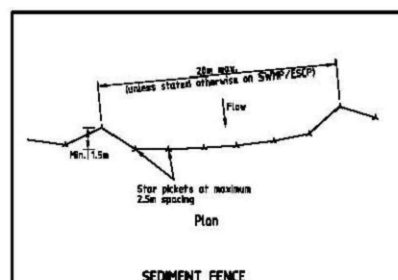

2m 1m 0 2m 4m 6m 8m 10m

SCALE 1: 200



LEGEND:

- SERVICES - NBN
- SERVICES - TELSTRA
- SERVICES - JEMENA DBYD
- SERVICES - AARNET
- SERVICES - AUSGRID

NOTE:
ASSETS ARE SHOWN FOR TENDERING
PURPOSES ONLY, ADDITIONAL
INDEPENDENT CONFIRMATION SHOULD BE
MADE PRIOR TO ANY EXCAVATION.

INFORMATION ISSUE

10	10.02.20	EZ	55KL TANK REMOVED	
0	19.12.19	EZ	INITIAL HAZKEM ISSUE	
NO.	DATE	BY	AMENDMENT	APPROVED
7-ELEVEN STORES PTY LTD INCORPORATED IN VICTORIA TELEPHONE (03) 9541 0711 FAX (03) 9541 0782 357 FERNTREE GULLY ROAD MOUNT WAVERLEY VICTORIA 3149 AUSTRALIA				

DATE CREATED 16.12.19	PROJECT 7 ELEVEN SERVICE STATION TANK REPLACEMENT 940 PITTWATER ROAD DEE WHY, NSW			
DRAWN BY EZ	TITLE ASSET LOCATION PLAN			
CHECKED BY				
APPROVAL FOR ISSUE				
SCALE 1:200 @A3	SHEET A3	SHEET SIZE A3	DRAWING No. HAZ-2563-A06	REVISION NO. 0
DATE PLOTTED				

TANK SCHEDULE						
TANK-ID	TANK-SIZE	TANK MANUFACTURER	COMPARTMENT-SIZE	SUB-PUMP	PRODUCT	DISPENSER-FEEDS
T1	60, 000LT	TANK SOLUTIONS DWT	60, 000LT	RED JACKET 1.5 HP	ULP	1,2,3,4,5,6
T2	60, 000LT	TANK SOLUTIONS DWT	30, 000LT	RED JACKET 1.5 HP	EIO	1,2,3,4,5,6
T3	60, 000LT	TANK SOLUTIONS DWT	30, 000LT	RED JACKET 1.5 HP	P95	3,4
T4	60, 000LT	TANK SOLUTIONS DWT	30, 000LT	RED JACKET 1.5 HP	P98	1,2,5,6
T5	60, 000LT	TANK SOLUTIONS DWT	30, 000LT	RED JACKET 1.5 HP	DSL	1,2,3,4,5,6

- STP SUPPLIER & CAPACITY TO BE CONFIRMED BY 7-ELEVEN ENGINEER.

FUEL LINE QUANTITIES		
PIPE NOM. SIZE	PIPE DESCRIPTION	PIPE LENGTH (Meters)
63.00 NB	PIPES VENT VR2	37 M
63.00 NB	PIPES VENT PRODUCT	46 M
63.75 NB	PIPES PRESSURE DOUBLE CONTAINMENT	168 M
90.00 NB	PIPES VENT VR1	6 M
110.00 NB	PIPES FILL	32 M

LINE QUANTITIES ARE FOR REFERENCE PURPOSES ONLY.

NOTE:
EXISTING LINework UNDER CANOPY ARE
REPRESENTATIVE ONLY.
EXACT ROUTE AND POSITION UNKNOWN.

LEGEND

PRESSURE LINES- 63nb
DOUBLE CONTAINED NCPP

FILL LINES- 110nb
SINGLE WALL NCPP

VENT LINES
VR1 - VAPOUR RECOVERY- 90nb SINGLE WALL NCPP
VR2 - SECONDARY VAPOUR RECOVERY- 63/90nb
SINGLE WALL NCPP. ONLY TO BE CONNECTED
WHERE REQUIRED BY STATE/LOCAL LEGISLATION OR
COMPANY ENGINEER.

FUTURE SYPHON LINES- 63nb (NOT CONNECTED)
DOUBLE CONTAINED NCPP

FS - FUTURE SYPHON LINES - CAPPED OFF
ATG - AUTOMATIC TANK GAUGE
OW - OBSERVATION WELL
HYD - HYDROGUARD

FUEL SYSTEM NOTES:

1. INSTALL OVERFILL PROTECTION TO ALL TANK FILL LINES.
2. INSTALL BOTTOM ANCHORS IN ACCORDANCE WITH MANUFACTURERS RECOMMENDATIONS
3. TANKS ARE TO BE INSTALLED IN ACCORDANCE WITH AS1940 AND AS 4897 AND MANUFACTURERS GUIDELINES
4. ALL TANK FILL & DIP POINTS TO HAVE NOMINATED IDENTIFICATION MARKERS FITTED TO AS 4977
5. ALL PIPING TO FALL MIN 1:100 BACK TO TANKS
6. INTERNAL LIDS TO FILL BOX PRODUCT FILL POINTS TO BE SECURELY LABELLED WITH STANDARD COLOUR CODED PRODUCT MARKER INDICATORS
7. PLUG UNUSED TANK OPENINGS, CLEARLY COLOUR CODE & LABEL ALL PRODUCT LINES AT STP'S, DISPENSERS AND FILL BOX
8. SUPPLY & INSTALL Ø300 LOCK BOXES AT DIP POINTS, TANK MONITORS, AND EXCAVATION OBSERVATION WELLS.
9. SUPPLY Ø300 RISER AROUND ALL DIP, ATG, RISERS OUTSIDE TURRETS

NOTE:
OBSERVATION WELLS SHOWN.
GROUND WATER MONITORING WELLS
LOCATIONS, AS REQUIRED BY AS4897,
TO BE DETERMINED BY SITE ENGINEER.

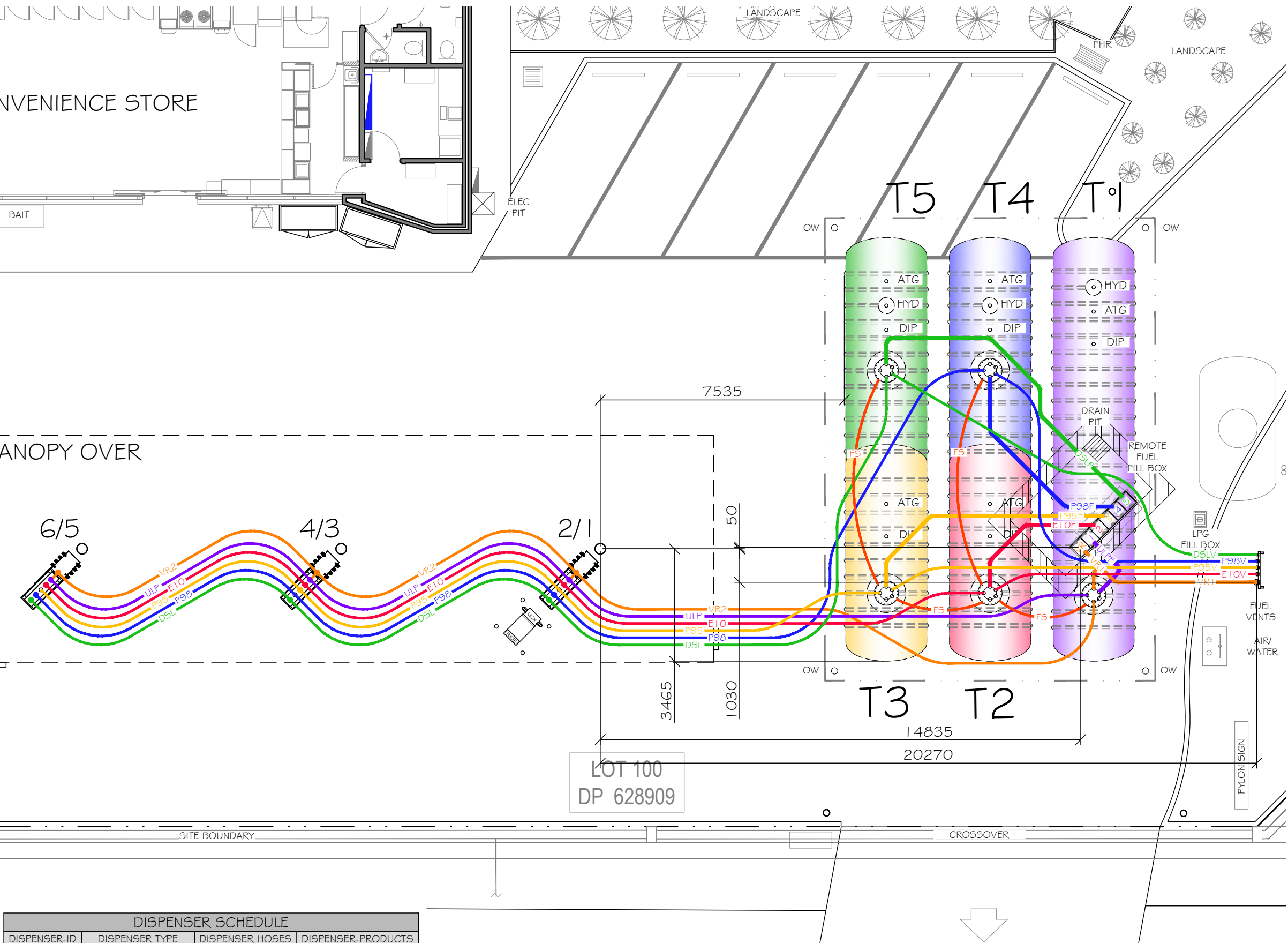

DISPENSER SCHEDULE			
DISPENSER-ID	DISPENSER TYPE	DISPENSER HOSES	DISPENSER-PRODUCTS
2/1	GALLAGHER PULSE LX	8 HOSE	P98 / EIO / ULP / DSL
4/3	GALLAGHER PULSE LX	8 HOSE	P95 / EIO / ULP / DSL
6/5	GALLAGHER PULSE LX	8 HOSE	P98 / EIO / ULP / DSL
8/7	SK700 SII	2 HOSE	LPG

COPYRIGHT NOTICE: ALL RIGHTS RESERVED. THIS DRAWING REMAINS THE PROPERTY OF HAZKEM PTY LTD AND MAY NOT BE COPIED, OR REPRODUCED, IN ANY WAY, WITHOUT THE PRIOR WRITTEN PERMISSION OF HAZKEM PTY LTD.

INFORMATION ISSUE

NO.	DATE	BY	AMENDMENT	APPROVED
10	10.02.20	EZ	DSL VENT RELOCATED, 55KL TANK REMOVED	
11	16.12.19	EZ	INITIAL HAZKEM ISSUE	

7-ELEVEN STORES
INCORPORATED IN VICTORIA TELEPHONE (03) 9541 0711 FAX (03) 9541 0782
357 FERNTREE GULLY ROAD MOUNT WAVERLEY
VICTORIA 3149 AUSTRALIA

PTV LTD
A.B.N. 48 005 299 427

DATE CREATED 16.12.19	PROJECT 7 ELEVEN SERVICE STATION TANK REPLACEMENT 940 PITTWATER ROAD DEE WHY, NSW			
DRAWN BY EZ	TITLE FUEL SYSTEM LAYOUT			
CHECKED BY				
APPROVAL FOR ISSUE				
SCALE 1:125 @A3	SHEET	SHEET SIZE A3	DRAWING No. HAZ-2563-T01	REVISION NO. 0
DATE PLOTTED				



NOTE:
EXISTING LPG TANK AND FILL SHOWN ARE
REPRESENTATIVE ONLY.
EXACT ROUTE AND POSITION UNKNOWN.

- NOTES:
- 1. DISPENSER AREA TO BE LEVEL AND PAVED.
 - 2. EMERGENCY STOP MAX 10.0m FROM TANK FILL POINT.
 - 3. NO UNDERGROUND DRAIN ENTRY POINT TO BE WITHIN 3m OF TANK FILL POINT.
 - 4. A MINIMUM OF A TAP & HOSE MUST BE AVAILABLE FOR FIRE FIGHTING PURPOSES WITH AN LPG TANK INSTALLATION UP TO 8kl.
 - 5. INSTALLATION TO CONFORM WITH AS/NZS 1596-2014 & AS/NZS 60079.10.1-2009 AS APPROPRIATE.

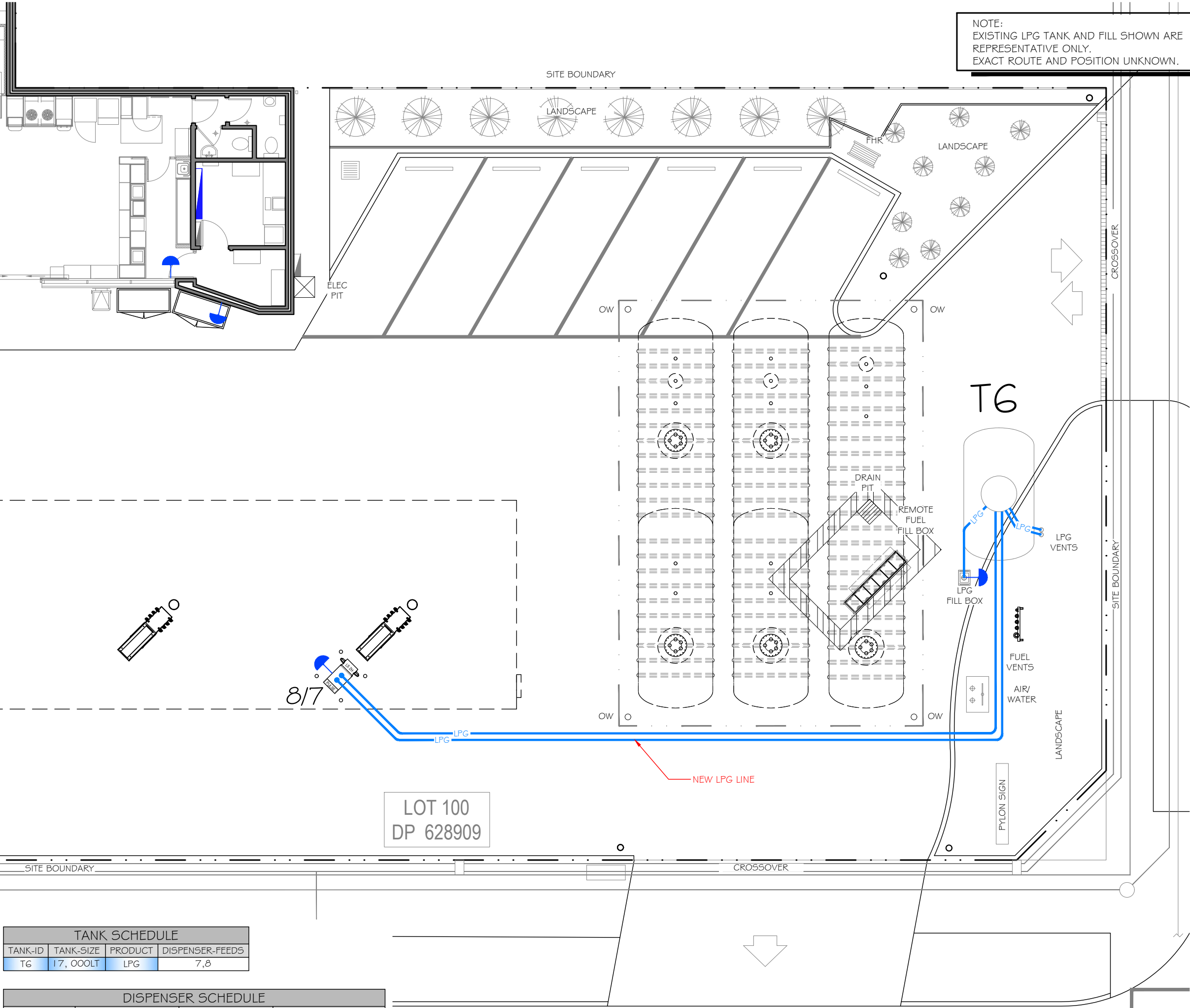

TANK SCHEDULE			
TANK-ID	TANK-SIZE	PRODUCT	DISPENSER-FEEDS
T6	17,000LT	LPG	7,8

DISPENSER SCHEDULE			
DISPENSER-ID	DISPENSER TYPE	DISPENSER HOSES	DISPENSER-PRODUCTS
2/1	GALLAGHER PULSE LX	8 HOSE	P98 / E10 / ULP / DSL
4/3	GALLAGHER PULSE LX	8 HOSE	P95 / E10 / ULP / DSL
6/5	GALLAGHER PULSE LX	8 HOSE	P98 / E10 / ULP / DSL
8/7	SK700 SII	2 HOSE	LPG

COPYRIGHT NOTICE: ALL RIGHTS RESERVED. THIS DRAWING REMAINS THE PROPERTY OF HAZKEM PTY LTD AND MAY NOT BE COPIED, OR REPRODUCED, IN ANY WAY, WITHOUT THE PRIOR WRITTEN PERMISSION OF HAZKEM PTY LTD.

INFORMATION ISSUE

1	10.02.20	EZ	55KL TANK REMOVED, NEW LPG LINE TAGGED	
0	16.12.19	EZ	INITIAL HAZKEM ISSUE	
NO.	DATE	BY	AMENDMENT	APPROVED

7-ELEVEN STORES PTY LTD
INCORPORATED IN VICTORIA TELEPHONE (03) 9541 0711 FAX (03) 9541 0782
357 FERN TREE GULLY ROAD MOUNT WAVERLEY
VICTORIA 3149 AUSTRALIA



DATE CREATED	16.12.19
DRAWN BY	EZ
CHECKED BY	
APPROVAL FOR ISSUE	
SCALE	1:125 @A3
DATE PLOTTED	

PROJECT			
7 ELEVEN SERVICE STATION TANK REPLACEMENT 940 PIT TWATER ROAD DEE WHY, NSW			
TITLE			
LPG SYSTEM LAYOUT			
SHEET	SHEET SIZE	DRAWING No.	REVISION NO.
	A3	HAZ-2563-G01	0

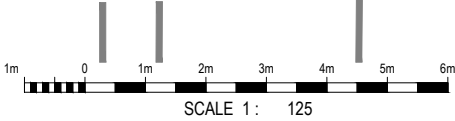

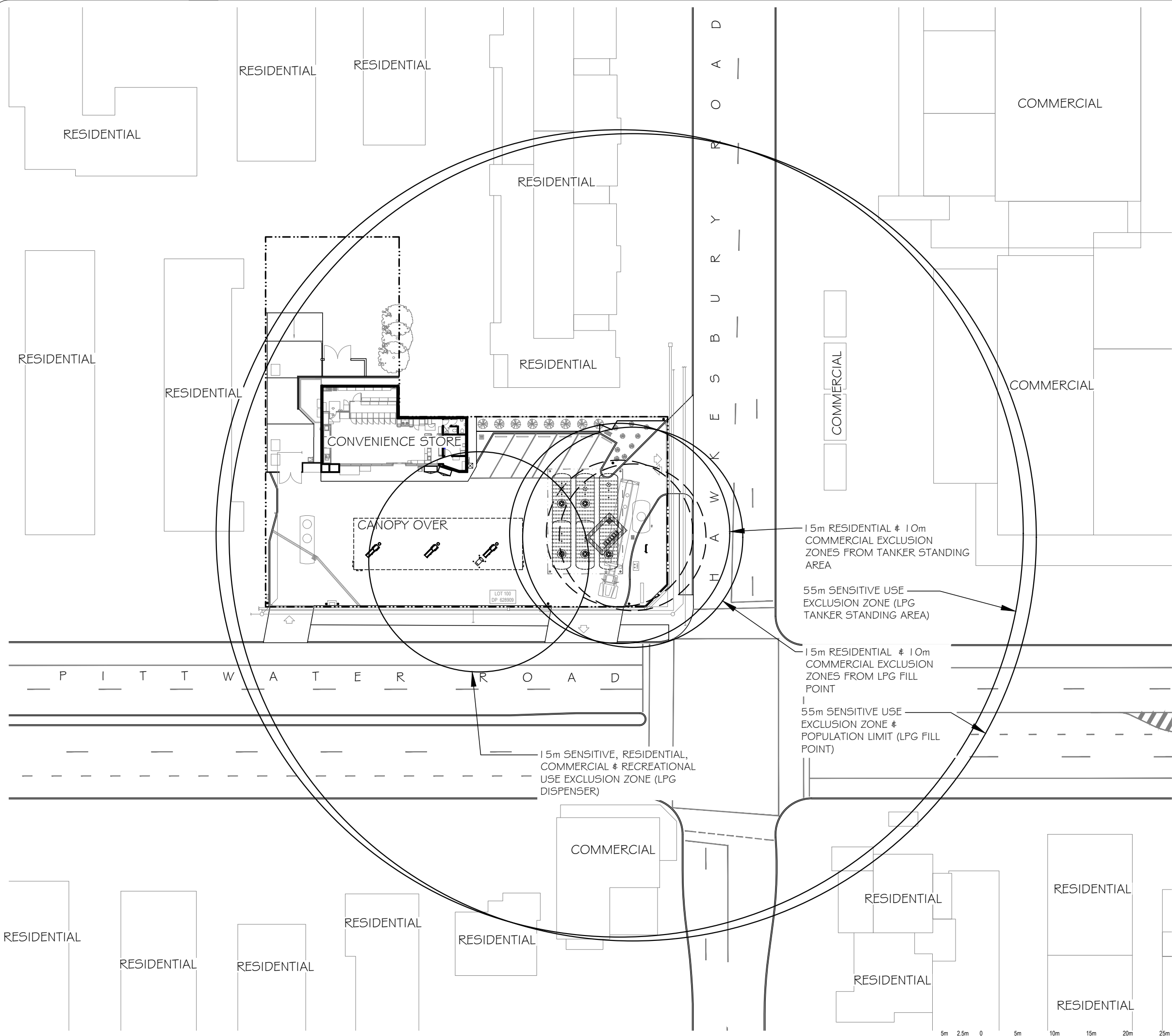

INFORMATION ISSUE

10	10.02.20	EZ	55KL TANK REMOVED	
0	16.12.19	EZ	INITIAL HAZKEM ISSUE	
NO.	DATE	BY	AMENDMENT	APPROVED

7-ELEVEN STORES PTY LTD
INCORPORATED IN VICTORIA TELEPHONE (03) 9541 0711 FAX (03) 9541 0782
357 FERNTREE GULLY ROAD MOUNT WAVERLEY
VICTORIA 3149 AUSTRALIA



DATE CREATED 16.12.19
DRAWN BY EZ
CHECKED BY
APPROVAL FOR ISSUE
SCALE 1:500 @A3
DATE PLOTTED

PROJECT 7 ELEVEN SERVICE STATION TANK REPLACEMENT 940 PITTWATER ROAD DEE WHY, NSW			
TITLE POPULATION AND EXCLUSION ZONES			
SHEET	SHEET SIZE A3	DRAWING No. HAZ-2563-G02	REVISION NO. 0

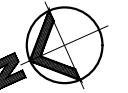

SITE BOUNDARY

SITE BOUNDARY

RESIDENTIAL

SITE BOUNDARY

LANDSCAPE

LANDSCAPE

CROSSOVER

H A W K E S B U R Y R O A D

CONVENIENCE STORE

WASTE ENCLOSURE

ICE

FIRE WOOD

BAIT

MAIN ELECTRICAL SWITCH BOARD
ELECTRICAL PIT

ELEC PIT

OW

OW

HYD
1X 32NB NUPI CONDUIT
ATG
1X 32NB NUPI CONDUIT.

U/G LPG TANK
1X 32NB UPP CONDUIT &
1X 32NB UPP CONDUIT
FOR 6mm NYLON AIR LINE

8 LPG VENTS

LPG FILL BOX

FUEL VENTS

AIR/WATER

LANDSCAPE

PYLON SIGN

SITE BOUNDARY

WASTE WATER
1X 32NB NUPI CONDUIT
WASTE WATER TANK FOR HIGH
LEVEL ALARM

CANOPY OVER

EXISTING SPEL PO20

DRAIN PIT

DISPENSERS
1X 32NB NUPI CONDUIT
VMS COMMS (if required)
1X 32NB NUPI CONDUIT
PROVIDE DRAW WIRE IF VMS
NOT REQUIRED.
DETECTION
1X 32NB NUPI CONDUIT

OBSERVATION WELL
1X 32NB NUPI CONDUIT

LOT 100
DP 628909

VENT
1X 32NB NUPI CONDUIT.

TURRET SUBMERSIBLE
1X 32NB NUPI CONDUIT.
TURRET LEAK DETECTION
1X 32NB NUPI CONDUIT.

INFORMATION ISSUE

1 0	10.02.20 16.12.19	EZ EZ	55KL TANK REMOVED, TURRET SPARE CONDUIT REMOVED INITIAL HAZKEM ISSUE	APPROVED
NO.	DATE	BY	AMENDMENT	

7-ELEVEN STORES PTY LTD
INCORPORATED IN VICTORIA TELEPHONE (03) 9541 0711 FAX (03) 9541 0782
357 FERN TREE GULLY ROAD MOUNT WAVERLEY
VICTORIA 3149 AUSTRALIA



DATE CREATED 16.12.19	PROJECT 7 ELEVEN SERVICE STATION TANK REPLACEMENT 940 PITTSWATER ROAD DEE WHY, NSW
DRAWN BY EZ	TITLE ELECTRICAL CONDUIT LAYOUT
CHECKED BY	SHEET
APPROVAL FOR ISSUE	SHEET SIZE A3
SCALE 1:200 @A3	DRAWING No. HAZ-2563-E01
DATE PLOTTED	REVISION NO. 0

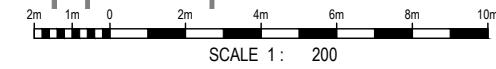

LEGEND:

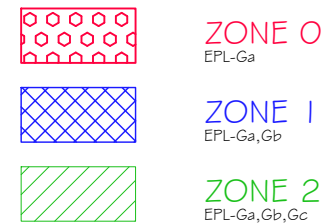

HAZARDOUS AREAS ARE AS DESCRIBED IN AS/NZS 60079.10.1 - 2009 EXPLOSIVE ATMOSPHERES - CLASSIFICATION OF AREAS - EXPLOSIVE GAS ATMOSPHERES PART ZA.4 VEHICLES & FUEL DISPENSING PART ZA.5 FLAMMABLE LIQUIDS PART ZA.6 FLAMMABLE GASES



NOTE:
1. HAZARDOUS AREAS SHOWN ARE DEPENDANT ON ADEQUATE VENTILATION WITHIN THE ROOM OR AREA.
2. THIS DRAWING HAS BEEN PRODUCED BY PERSONS WITH APPROPRIATE KNOWLEDGE & ACCREDITED WITH UEENEEMO52A "CLASSIFYING HAZARDOUS AREAS".
3. ELECTRICAL EQUIPMENT WITHIN HAZARDOUS AREA ON SITE TO MEET THE FOLLOWING:
TEMPERATURE CLASS T3
GAS GROUP IIB

INFORMATION ISSUE

10.02.20	16.12.19	EZ	55KL TANK REMOVED
NO.	DATE	BY	AMENDMENT
1	0	EZ	INITIAL HAZKEM ISSUE
7-ELEVEN STORES			PTY LTD
INCORPORATED IN VICTORIA			A.B.N. 48 005 286 427
357 FERNTREE GULLY ROAD			MOUNT WAVERLEY
VICTORIA 3149			AUSTRALIA

DATE CREATED	16.12.19	PROJECT	7 ELEVEN SERVICE STATION
DRAWN BY	EZ	TANK REPLACEMENT	940 PITTWATER ROAD
CHECKED BY		DEE WHY, NSW	
APPROVAL FOR ISSUE		TITLE	HAZARDOUS AREA LAYOUT
SCALE	1:200 @A3	SHEET	HAZ-2563-HZ01
DATE PLOTTED		SHEET SIZE	A3
		DRAWING No.	
		REVISION No.	0

LEGEND:

-  **ZONE 0**
EPL-Ga
-  **ZONE 1**
EPL-Ga,Gb
-  **ZONE 2**
EPL-Ga,Gb,Gc

HAZARDOUS AREAS ARE AS DESCRIBED IN AS/NZS 60079.10.1 - 2009 EXPLOSIVE ATMOSPHERES - CLASSIFICATION OF AREAS - EXPLOSIVE GAS ATMOSPHERES PART ZA.4 VEHICLES & FUEL DISPENSING PART ZA.5 FLAMMABLE LIQUIDS PART ZA.6 FLAMMABLE GASES

- NOTE:**
- HAZARDOUS AREAS SHOWN ARE DEPENDANT ON ADEQUATE VENTILATION WITHIN THE ROOM OR AREA.
 - THIS DRAWING HAS BEEN PRODUCED BY PERSONS WITH APPROPRIATE KNOWLEDGE & ACCREDITED WITH UEENEEM052A "CLASSIFYING HAZARDOUS AREAS".
 - ELECTRICAL EQUIPMENT WITHIN HAZARDOUS AREA ON SITE TO MEET THE FOLLOWING:
TEMPERATURE CLASS T3
GAS GROUP IIB

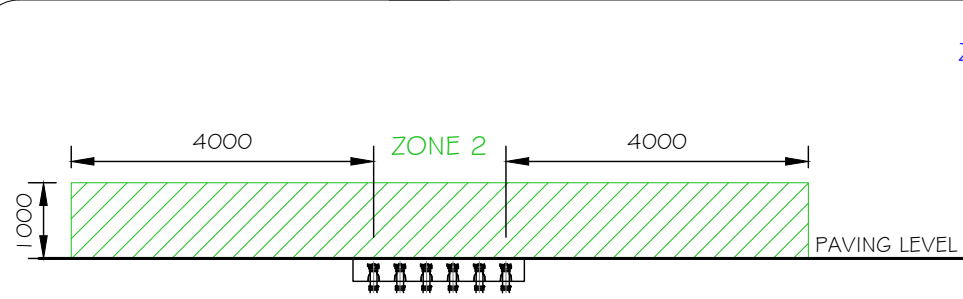

FIGURE 1
HAZARDOUS ZONE SURROUNDING FUEL FILL POINTS
AS/NZS 60079.10.1-2009
ZA.4.4.2.5

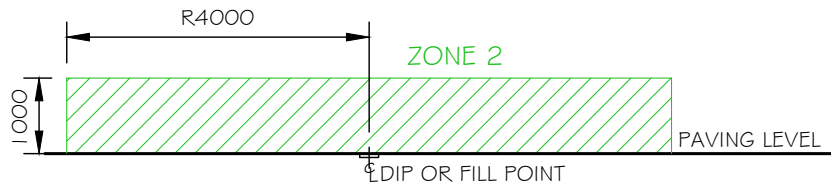

FIGURE 2
HAZARDOUS ZONE SURROUNDING DIP POINTS
AS/NZS 60079.10.1-2009
ZA.4.4.2.5

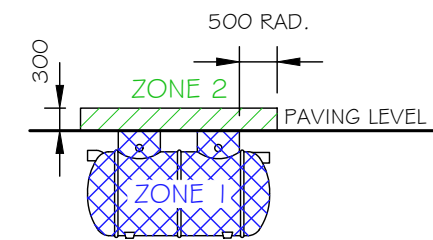

FIGURE 7
HAZARDOUS ZONE SURROUNDING SQID
AS/NZS 60079.10.1-2009
ZA.5.2.10

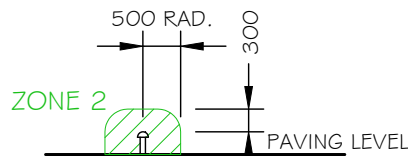

FIGURE 8
HAZARDOUS ZONE SURROUNDING SQID VENT
AS/NZS 60079.10.1-2009
ZA.5.2.10

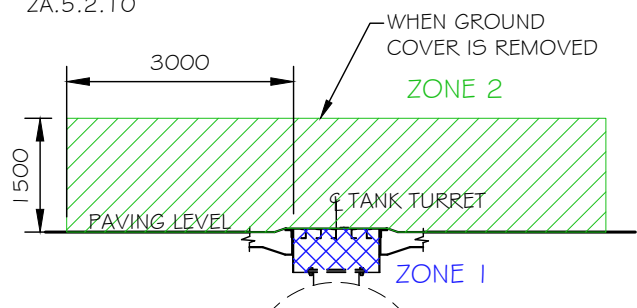

FIGURE 10
HAZARDOUS ZONE INSIDE LPG TANK TURRETS
AS/NZS 60079.10.1-2009
ZA.6.3.2.3

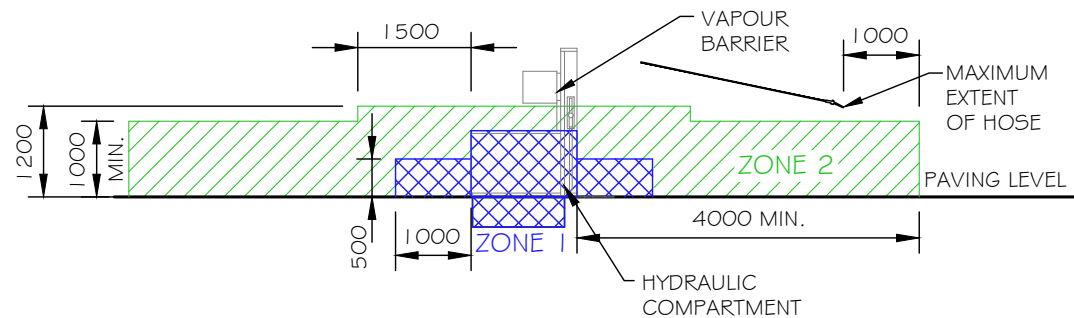

FIGURE 11
HAZARDOUS ZONE SURROUNDING GALLAGHER PULSE LPG DISPENSER/PUMPS
AS/NZS 60079.10.1-2009
ZA.4.4.2.7

*AS PER SAFEWORK NSW AGREEMENT

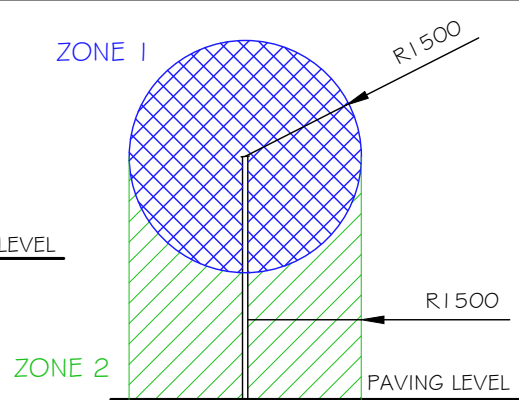

FIGURE 3
HAZARDOUS ZONE SURROUNDING FUEL VENT PIPES
AS/NZS 60079.10.1-2009
ZA.4.4.2.5 - Fig. ZA.8

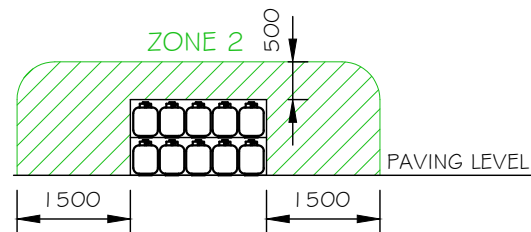

FIGURE 9
HAZARDOUS ZONE SURROUNDING LPG EXCHANGE CYLINDER CAGE STORAGE FRONT ELEVATION
AS/NZS 60079.10.1-2009
ZA.6.5.2.16

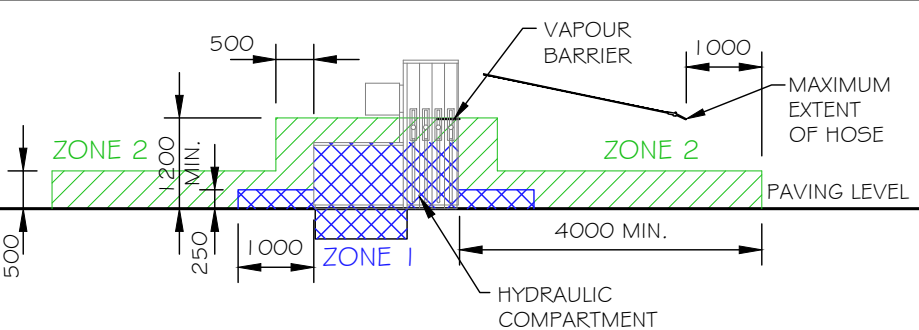

FIGURE 5
HAZARDOUS ZONE SURROUNDING ADEQUATELY VENTILATED FUEL DISPENSERS/PUMPS
AS/NZS 60079.10.1-2009
ZA.4.4.2.2

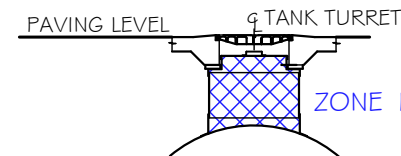

FIGURE 4
HAZARDOUS ZONE INSIDE FUEL TANK TURRETS
AS/NZS 60079.10.1-2009
ZA.5.2.9

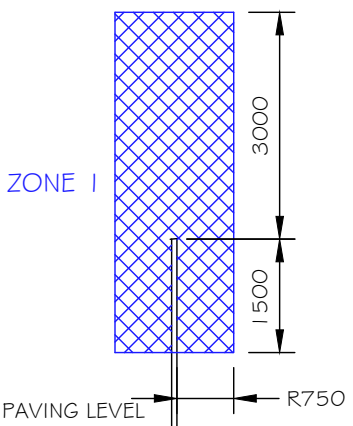

FIGURE 13
HAZARDOUS ZONE SURROUNDING LPG VENT PIPES
AS/NZS 60079.10.1-2009
ZA.6.5.2.4

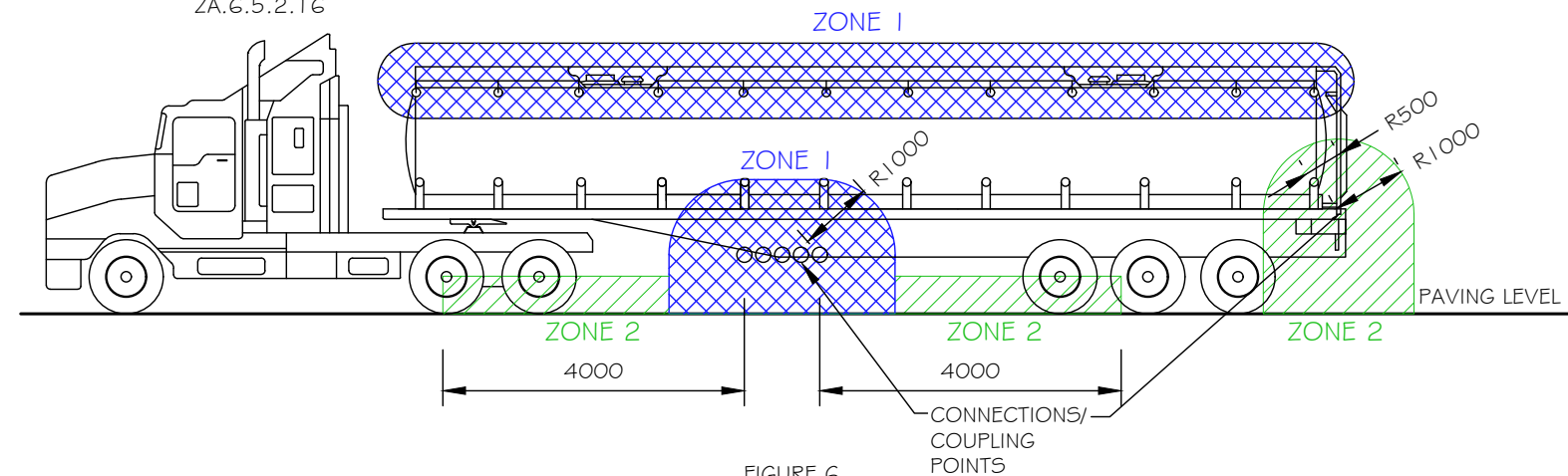

FIGURE 6
HAZARDOUS ZONE SURROUNDING ROAD FUEL TANKER DISCHARGE WITH OR WITHOUT VAPOUR RECOVERY
AS/NZS 60079.10.1-2009
ZA.5.2.6.3 - Fig. ZA.33

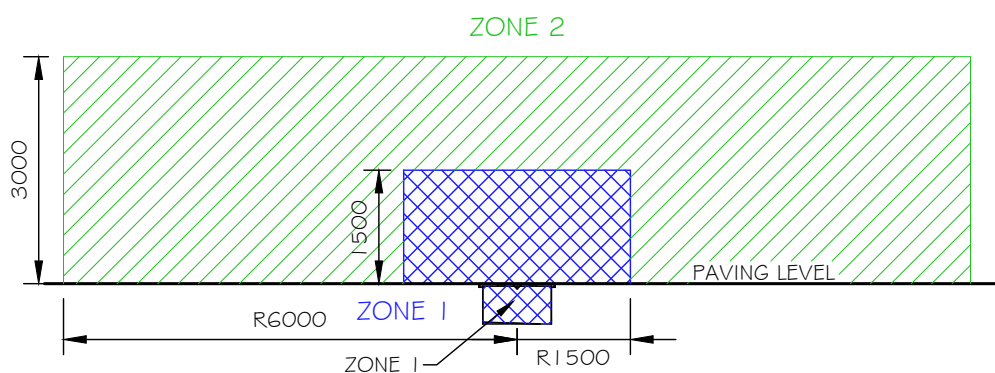

FIGURE 12
HAZARDOUS ZONE AROUND LPG REMOTE FILL BOX
AS/NZS 60079.10.1-2009
ZA.6.5.2.2



INFORMATION ISSUE

NO.	DATE	BY	AMENDMENT	APPROVED
0	16.12.19	EZ	INITIAL HAZKEM ISSUE	

7-ELEVEN STORES PTY LTD
INCORPORATED IN VICTORIA TELEPHONE (03) 9541 0711 FAX (03) 9541 0782
357 FERNTREE GULLY ROAD MOUNT WAVERLEY
VICTORIA 3149 AUSTRALIA



DATE CREATED 16.12.19	PROJECT 7 ELEVEN SERVICE STATION TANK REPLACEMENT 940 PITTWATER ROAD DEE WHY, NSW
DRAWN BY EZ	TITLE HAZARDOUS AREA ELEVATIONS
CHECKED BY	SHEET A3
APPROVAL FOR ISSUE	DRAWING No. HAZ-2563-HZ02
SCALE 1:100 @A3	REVISION NO. 0
DATE PLOTTED	



DRAINAGE NOTES:

- 1. WHEN HOLDING TANK FITTED, INSTALL HIGH LEVEL ALARM SET AT A LEVEL WHICH STILL ALLOWS A FULL DELIVERY TANKER COMPARTMENT IN TANK. HIGH HIGH LEVEL SET AT 90% TANK CAPACITY. INDICATOR LIGHTS TO BE INSTALLED INSIDE CONSOLE AREA.
- 2. PROVISION SHALL BE MADE FOR FUTURE FIT OUT OF AN OILSET-1000 HYDROCARBON ALARM WITHIN THE HOLDING TANK / SQID / SPEL PURACEPTOR.

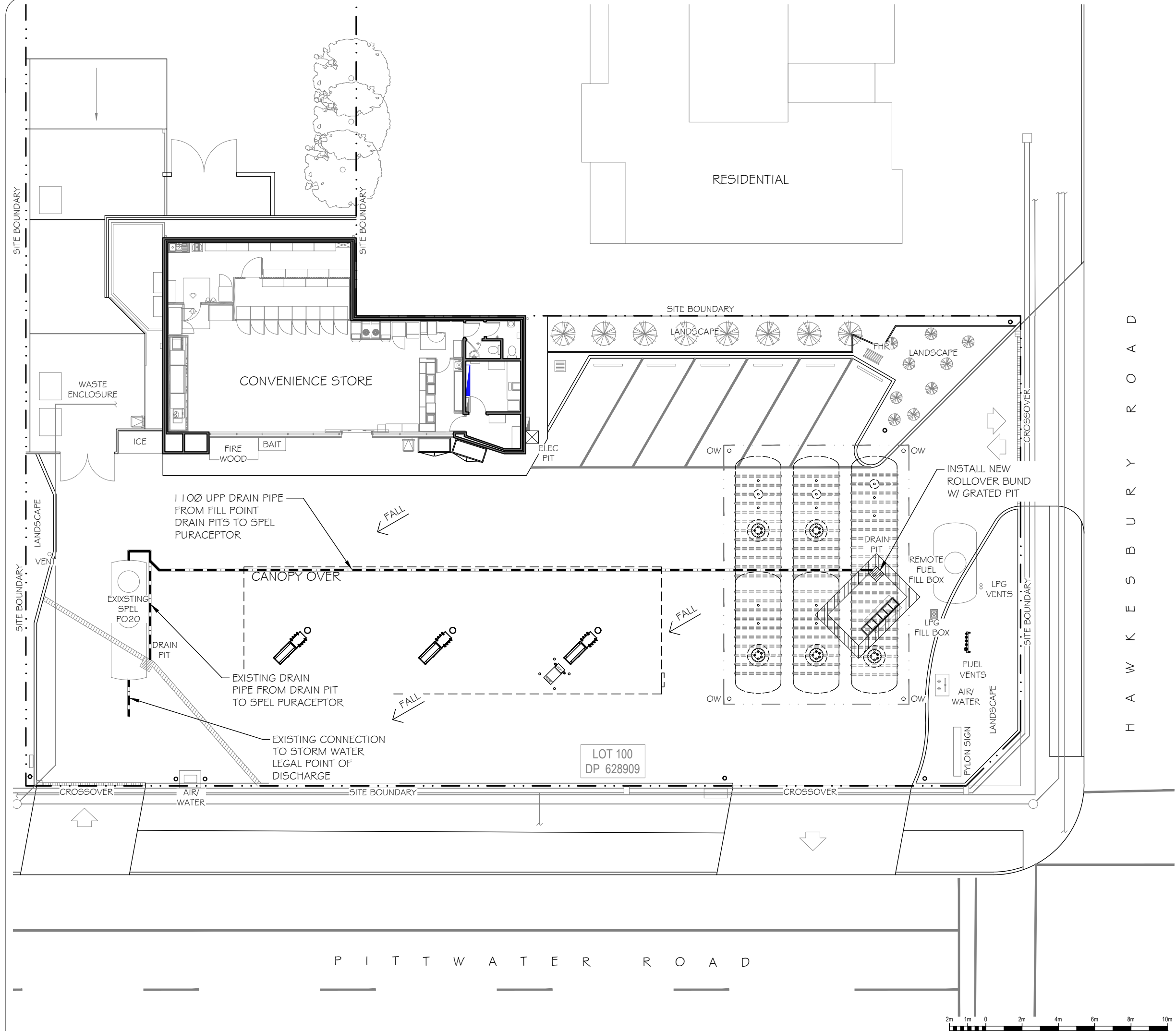

INFORMATION ISSUE

10	10.02.20	EZ	55KL TANK REMOVED	
0	16.12.19	EZ	INITIAL HAZKEM ISSUE	
NO.	DATE	BY	AMENDMENT	APPROVED

7-ELEVEN STORES PTY LTD
INCORPORATED IN VICTORIA TELEPHONE (03) 9541 0711 FAX (03) 9541 0782
357 FERNTREE GULLY ROAD MOUNT WAVERLEY
VICTORIA 3149 AUSTRALIA



DATE CREATED 16.12.19	PROJECT 7 ELEVEN SERVICE STATION TANK REPLACEMENT 940 PITTWATER ROAD DEE WHY, NSW
DRAWN BY EZ	TITLE SITE DRAINAGE PLAN
CHECKED BY	SHEET A3
APPROVAL FOR ISSUE	DRAWING No. HAZ-2563-H01
SCALE 1:200 @A3	REVISION NO. 0
DATE PLOTTED	



175mm THICK CONCRETE 265.4m²



200mm THICK CONCRETE 194.5m²

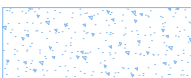

AREA TO BE LANDSCAPED 40m²



SITE BOUNDARY

SITE BOUNDARY

SITE BOUNDARY

CROSSOVER

SITE BOUNDARY

H A W K E S B U R Y R O A D

SITE BOUNDARY

CROSSOVER

P I T T W A T E R R O A D

2m 1m 0 2m 4m 6m 8m 10m

SCALE 1: 200

INFORMATION ISSUE

10	10.02.20	EZ	55KL TANK REMOVED, 175mm THK CONCRETE ADJUSTED	
0	16.12.19	EZ	INITIAL HAZKEM ISSUE	
NO.	DATE	BY	AMENDMENT	APPROVED

7-ELEVEN STORES PTY LTD
INCORPORATED IN VICTORIA TELEPHONE (03) 9541 0711 FAX (03) 9541 0782
357 FERN TREE GULLY ROAD MOUNT WAVERLEY
VICTORIA 3149 AUSTRALIA



DATE CREATED 16.12.19	PROJECT 7 ELEVEN SERVICE STATION TANK REPLACEMENT 940 PIT TWATER ROAD DEE WHY, NSW			
DRAWN BY EZ	TITLE CONCRETE REPLACEMENT PLAN			
CHECKED BY				
APPROVAL FOR ISSUE				
SCALE 1:200 @A3	SHEET	SHEET SIZE A3	DRAWING No. HAZ-2563-C01	REVISION NO. 0
DATE PLOTTED				

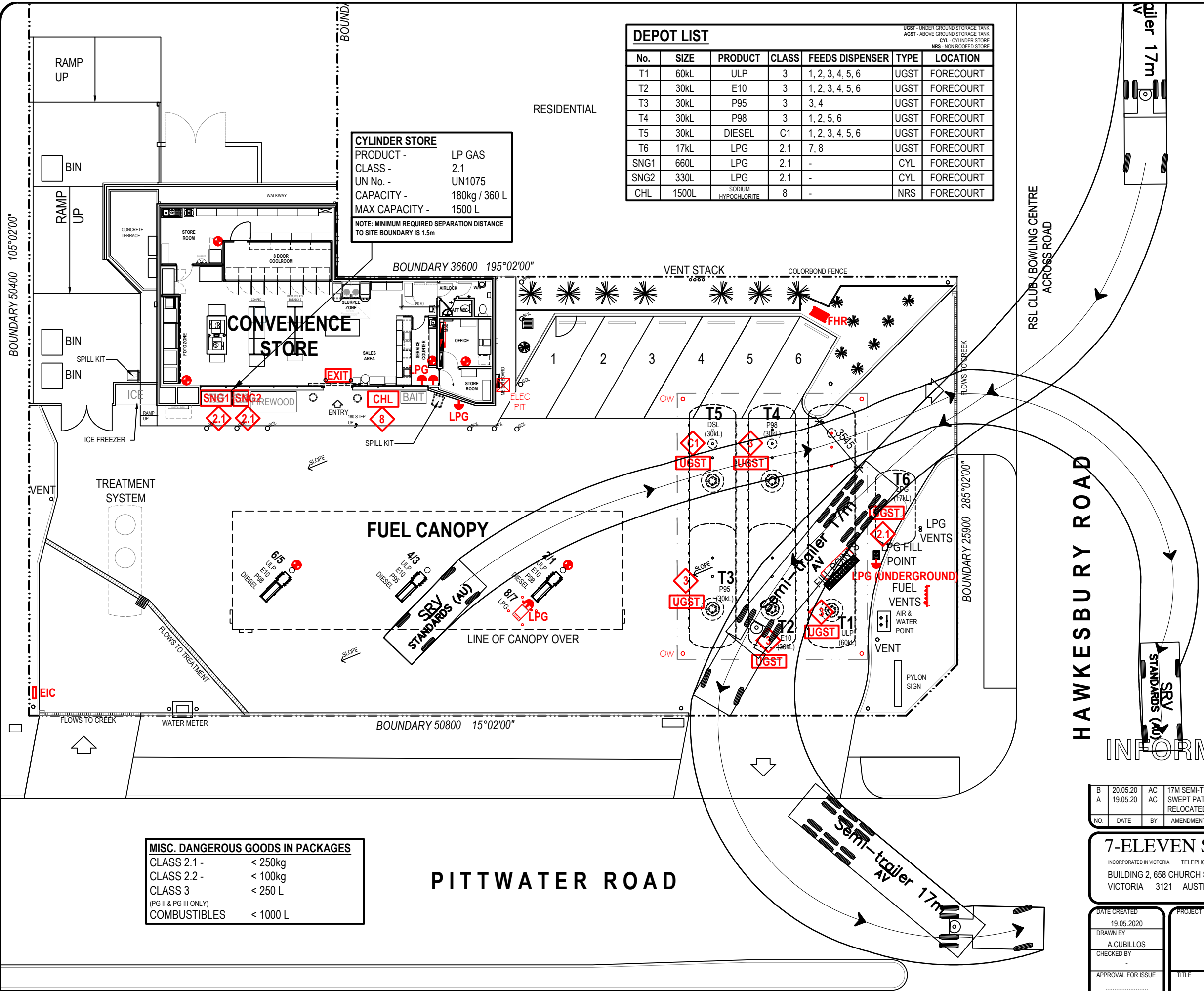

DEPOT LIST						
No.	SIZE	PRODUCT	CLASS	FEEDS DISPENSER	TYPE	LOCATION
T1	60kL	ULP	3	1, 2, 3, 4, 5, 6	UGST	FORECOURT
T2	30kL	E10	3	1, 2, 3, 4, 5, 6	UGST	FORECOURT
T3	30kL	P95	3	3, 4	UGST	FORECOURT
T4	30kL	P98	3	1, 2, 5, 6	UGST	FORECOURT
T5	30kL	DIESEL	C1	1, 2, 3, 4, 5, 6	UGST	FORECOURT
T6	17kL	LPG	2.1	7, 8	UGST	FORECOURT
SNG1	660L	LPG	2.1	-	CYL	FORECOURT
SNG2	330L	LPG	2.1	-	CYL	FORECOURT
CHL	1500L	SODIUM HYPOCHLORITE	8	-	NRS	FORECOURT

CYLINDER STORE
PRODUCT - LP GAS
CLASS - 2.1
UN No. - UN1075
CAPACITY - 180kg / 360 L
MAX CAPACITY - 1500 L
NOTE: MINIMUM REQUIRED SEPARATION DISTANCE TO SITE BOUNDARY IS 1.5m

LEGEND	
	FIRE EXTINGUISHER
	EMERGENCY STOP BUTTON (ALL FUELS)
	EMERGENCY STOP BUTTON (LPG)
	FILL POINTS
	EXIT
	SWITCHBOARD
	EMERGENCY INFORMATION
	DANGEROUS GOODS CLASS
	DANGEROUS GOODS CLASS
	DANGEROUS GOODS CLASS
	DANGEROUS GOODS CLASS
	UNDERGROUND BULK STORAGE TANK
	GAS CYLINDER STORE
	GAS CYLINDER STORE
	CHLORINE
	DRAIN
	FIRE HOSE REEL

SITE EMERGENCY CONTACT
24/7 EMERGENCY COMM. HUB
PH: 1800 655 160

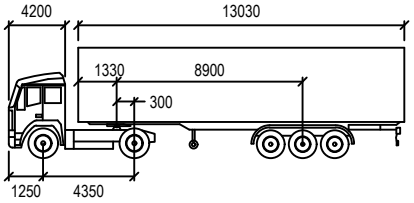

SEMI-TRAILER AV			
mm			
Tractor Width	: 2500	Lock to Lock Time	: 6.0
Trailer Width	: 2500	Steering Angle	: 23.8
Tractor Track	: 2500	Articulating Angle	: 70.0
Trailer Track	: 2500		

AV TRANSPORT TRUCK DETAILS
AUSTRALIAN STANDARDS

INFORMATION ISSUE

B	20.05.20	AC	17M SEMI-TRAILER TANKER PROPOSED ON SWEEP PATH	
A	19.05.20	AC	SWEEP PATH REVIEWED TO COMPLY WITH A/S. CAR-PARK SPOT RELOCATED & KERB MODIFIED TO SUIT CIRCULATION	
NO.	DATE	BY	AMENDMENT	APPROVED

7-ELEVEN STORES

INCORPORATED IN VICTORIA TELEPHONE (03) 9541 0711 FAX (03) 9965 1954

BUILDING 2, 658 CHURCH STREET RICHMOND VICTORIA 3121 AUSTRALIA

PTY LTD
A.B.N. 48 055 299 427

DATE CREATED	19.05.2020
DRAWN BY	A.CUBILLOS
CHECKED BY	-
APPROVAL FOR ISSUE	-
SCALE	1:250 (A3)
DATE PLOTTED	-

PROJECT			
SERVICE STATION AT 940 PITTWATER ROAD DEE WHY NEW SOUTH WALES			
TITLE			
SWEEP PATH FUEL PLAN			
SHEET	SHEET SIZE	DRAWING No.	REVISION No.
1 OF 1	A3	2212-SFP	B

MISC. DANGEROUS GOODS IN PACKAGES	
CLASS 2.1 -	< 250kg
CLASS 2.2 -	< 100kg
CLASS 3	< 250 L
(PG II & PG III ONLY)	
COMBUSTIBLES	< 1000 L

GROUND FLOOR PLAN
SCALE 1:100 (A3)

0 0.5 1.0 1.5 2.0 2.5 3.0 metres

RETAIL / RESIDENTIAL
ACROSS ROAD

HAZKEM

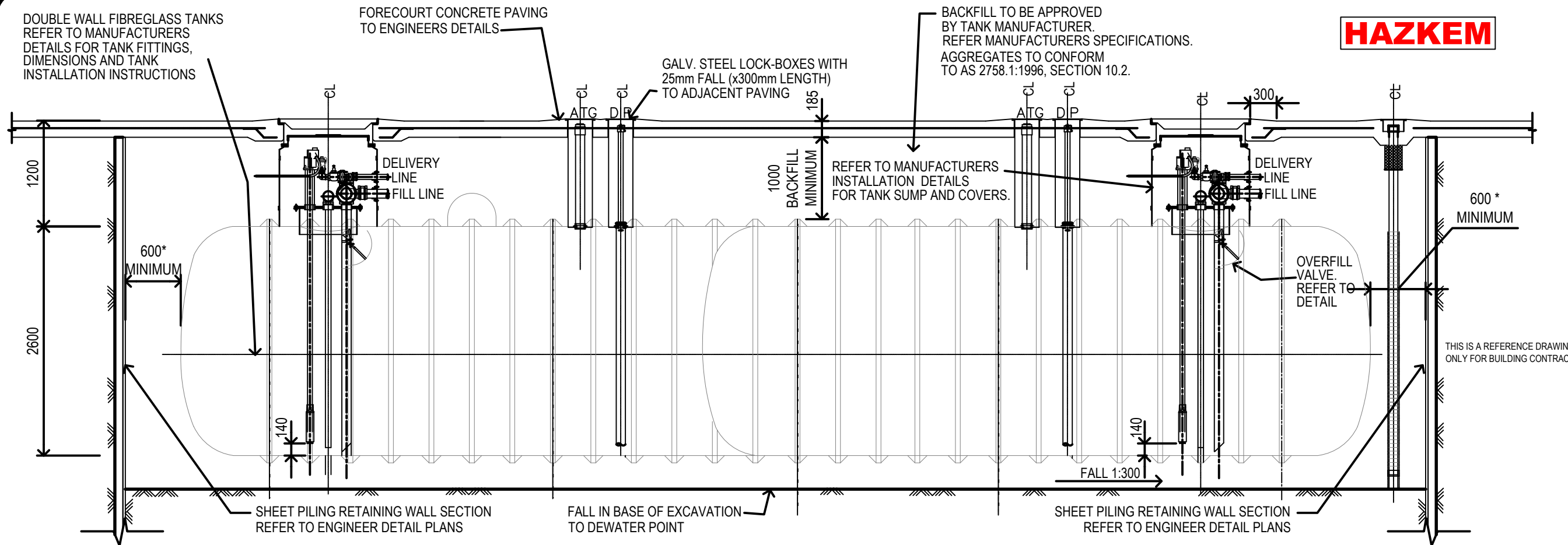

- FULL-LENGTH TANK SECTION
- SCALE 1:50

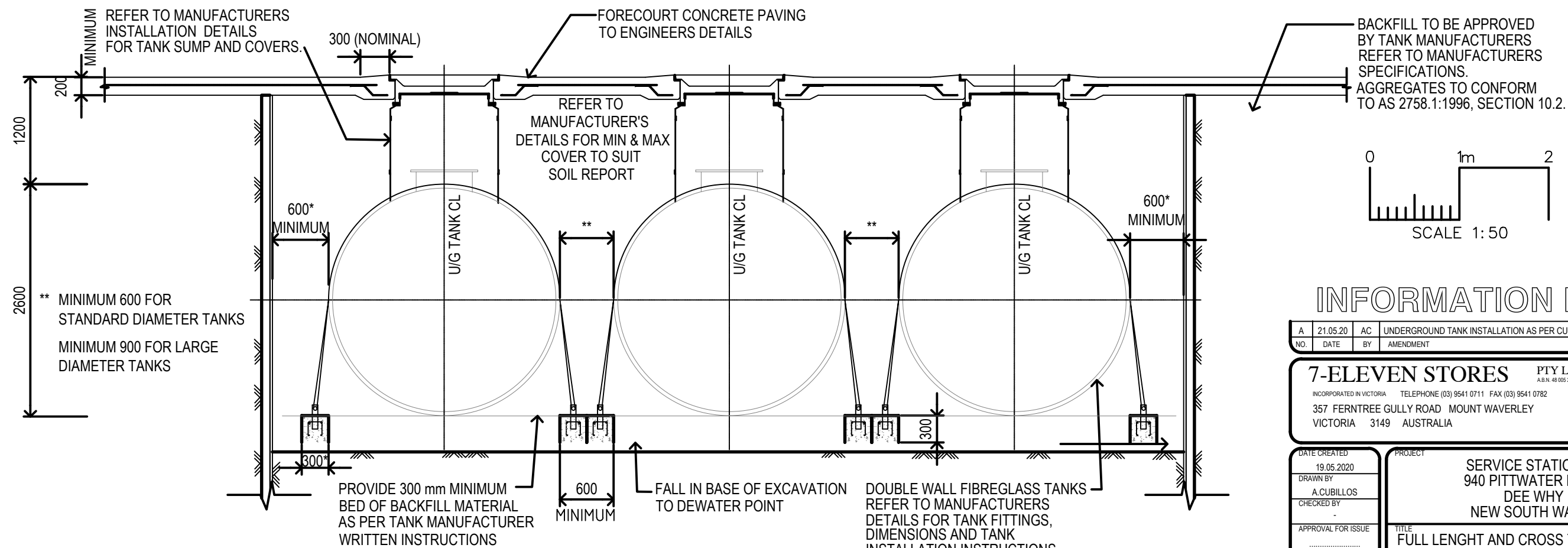

- TANK FARM CROSS SECTION
- SCALE 1:50

INFORMATION ISSUE

A	21.05.20	AC	UNDERGROUND TANK INSTALLATION AS PER CURRENT CONDITIONS
NO.	DATE	BY	AMENDMENT

7-ELEVEN STORES

INCORPORATED IN VICTORIA
357 FERNTREE GULLY ROAD
VICTORIA 3149 AUSTRALIA

PTY LTD
A.B.N. 48 005 299 427



DATE CREATED	19.05.2020
DRAWN BY	A.CUBILLOS
CHECKED BY	-
APPROVAL FOR ISSUE	-
SCALE	1:50 (A3)
DATE PLOTTED	-

PROJECT	SERVICE STATION AT 940 PITTSWATER ROAD DEE WHY NEW SOUTH WALES
TITLE	FULL LENGTH AND CROSS TANK SECTIONS
SHEET	1 OF 1
SHEET SIZE	A3
DRAWING No.	2212-FT
REVISION NO.	A