

NOTES

- Do not scale from this plan.
- This purpose of this plan is to show a proposed subdivision layout. It must not be used for any other purpose.
- Boundary dimensions and areas have been compiled from the current subject site Deposited Plan. No boundaries have been surveyed or marked. If any work is to be undertaken on or adjacent to a boundary then a Boundary Survey is recommended to define the boundaries of the site.
- All proposed lot dimensions, areas and easements shown are approximate only and subject to services and engineering design, regulatory approval, construction, final survey and registration of the Plan of Subdivision at Land and Property Information NSW.
- This drawing and the information it contains is copyright and remains the property of SurveyPlus Pty Ltd. It must not be copied, used or altered without the express authority of SurveyPlus.
- These notes form an integral part of this plan and any other plan that relies on the information shown herein.

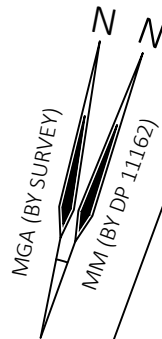

ALTO
AVENUE

PRINCE EDWARD ROAD

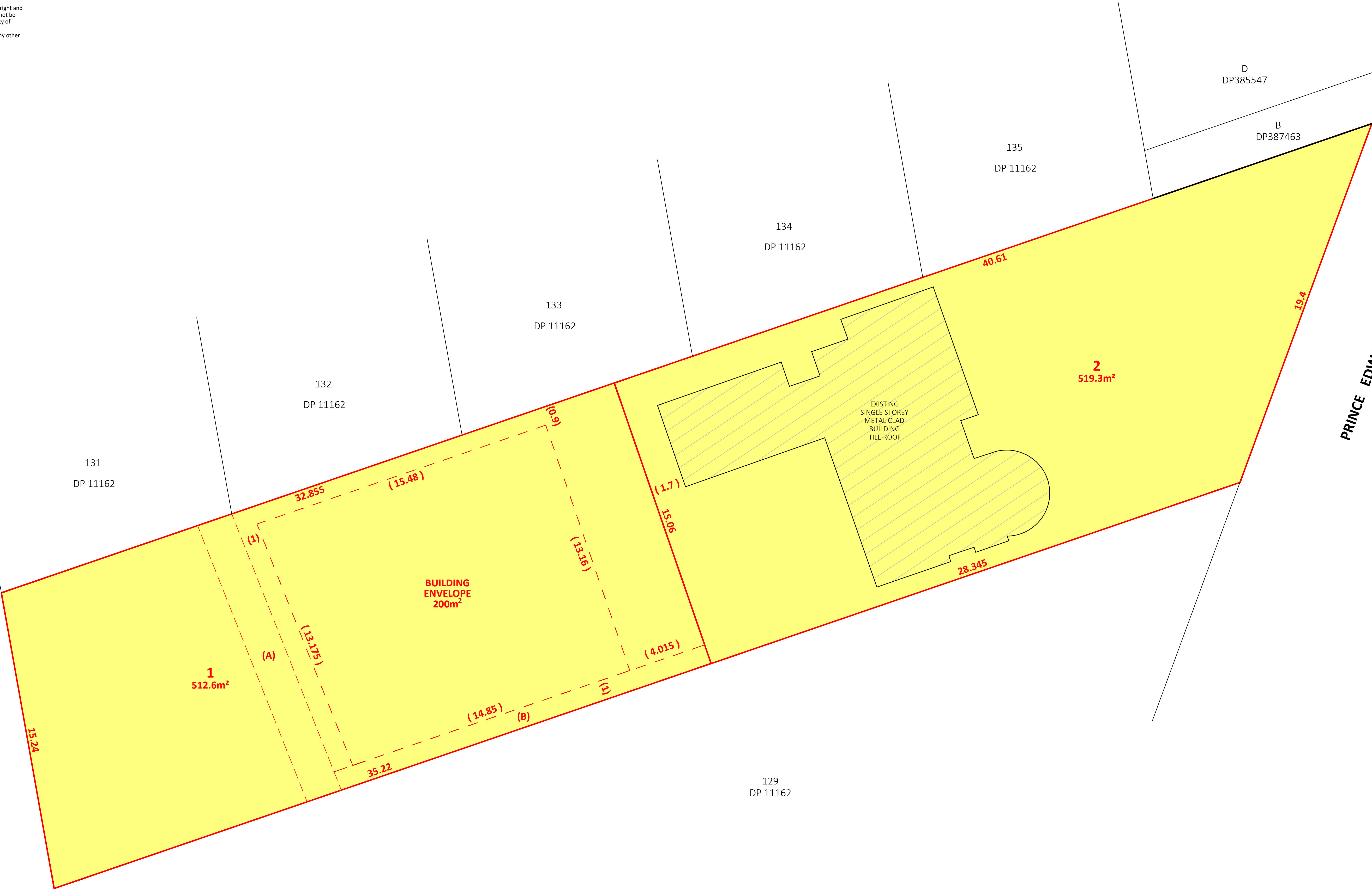

(A) - EASEMENT FOR DRAINAGE 1.83 WIDE (G793114)
(B) - PROPOSED EASEMENT TO DRAIN WATER 1 WIDE

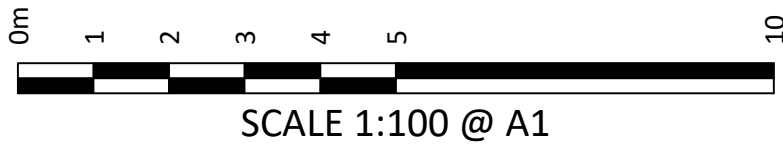

CLIENT Shannon Deeran	REVISION / DATE		REVISION DETAILS		SURVEY BY		DRAWN BY		CHECKED BY		<div><div><div>We make it easy. We make it happen.</div><div>02 9651 2921 info@surveyplus.com.au www.surveyplus.com.au</div></div></div>	DATE OF SURVEY		N / A		DRAWING TITLE CONCEPT SUBDIVISION PLAN CONCEPT SUBDIVISION OF LOT 130 DP 11162 No. 15 ALTO AVENUE, SEAFORTH	SCALE		1:100 @ A1			
												ORIGIN OF LEVELS		N / A			REVISION		B			
												ORIGIN OF COORDS		PM 365 (MGA)			SHEET		1 OF 2			
												CONTOUR INTERVAL		N / A			REF		16123_SUB_1B			
	B 14.03.2019		TREE DETAILS UPDATED		--		PK		PK			land development consultants										
	A 30.06.2017		INITIAL ISSUE		--		CE		PM													

CLIENT Shannon Deeran	REVISION / DATE	REVISION DETAILS	SURVEY BY	DRAWN BY	CHECKED BY	 <p>surveyplus land development consultants</p> <p><i>We make it easy. We make it happen.</i></p> <p>02 9651 2921 info@surveyplus.com.au www.surveyplus.com.au</p>	DATE OF SURVEY	30.03.2017	DRAWING TITLE <h1>DETAIL SURVEY PLAN</h1> <h2>PROPOSED SUBDIVISION OF LOT 130 DP 11162</h2> <h3>No.15 ALTO AVENUE, SEAFORTH</h3>	SCALE	1:100 @ A1
							ORIGIN OF LEVELS	PM 364 RL 91.923 (AHD)		REVISION	B
							ORIGIN OF COORDS	PM 365 (MGA)		SHEET	2 OF 2
							CONTOUR INTERVAL	0.5m		REF	16123 SUB 1B
	B 14.03.2019	TREE DETAILS UPDATED	--	PK	PK						
	A 30.06.2017	INITIAL JSS:IE	PK	FE	PM						

