

COLOURS:

PROPOSED ITEM IS **BLACK**

EXISTING ITEM IS **BLUE / BLUE**

DEMOLISHED ITEM IS **RED**

DA COLOURS TO
AS 1100.301-1985 & AS 2700S-1996



THIS PLAN IS TO BE READ IN
CONJUNCTION WITH
DEFERRED COMMENCEMENT CONSENT

DA NUMBER: DA2022/0936

(Activation of consent must be obtained
from Northern Beaches Council)

- Drawing Notes
- 01 New glass balustrade
 - 02 Extended tiled balcony
 - 03 Flue for new gas fireplace
 - 04 -
 - 05 New opening
 - 06 New timber weatherboards to match existing
 - 07 Metal balustrade and overhang timber deck
 - 08 New fireplace / tv wall
 - 09 -
 - 10 New outdoor cooking

Highlighted work is partially completed for deferred commencement approval and building information certificate.

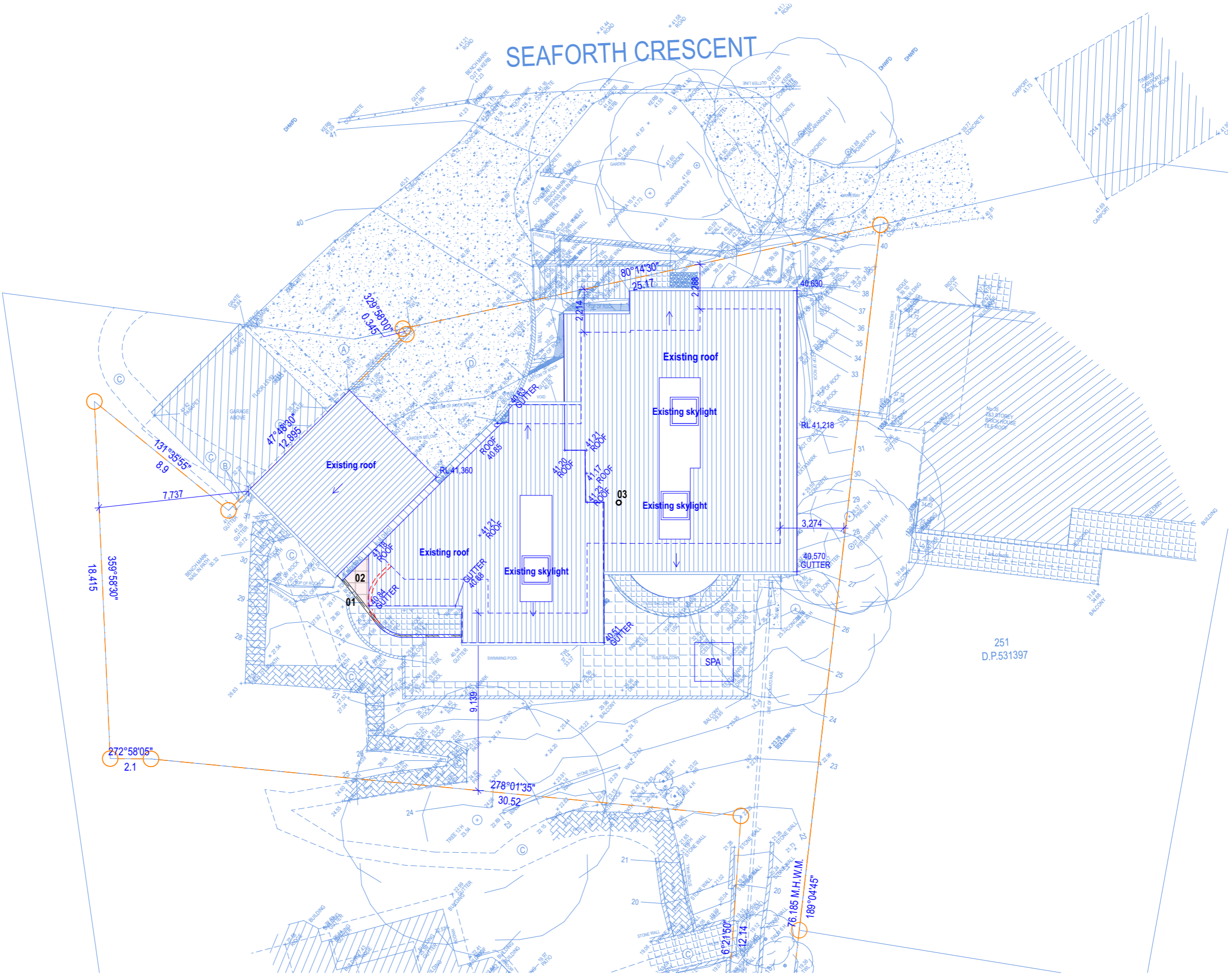



Address:
Suite 206, 20 Dale Street
Brookvale NSW 2100
info@aaarchitect.com.au
www.aaarchitect.com.au
Mobile: 0412 348 575

Architect:
Adam Pressley FRAIA
Principal & Nominated Architect
NSW No.6007

ABN 95 492 673 232



MEMBER

THE ROYAL AUSTRALIAN
INSTITUTE OF ARCHITECTS

Project:
Alterations & Additions

Printed: Monday, 23 May 2022
/Volumes/AAA Serv/01 Projects Active/39Sea/02 Models/
39Sea_Model.pln

Client:
Ron Thomson & Pamela Robertson-Gregg

39 Seaforth Crescent Seaforth 2092
Lot 11 & D.P.1026519

Title:
Site / Roof Plan

Scale 1:200 @ A3

0 1 2 3 4 5

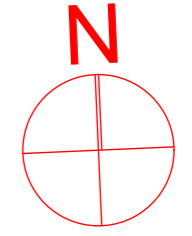

39Sea
DA.02

Issue:
Q

Amended DA Plans - For Approval

COLOURS:

PROPOSED ITEM IS BLACK

EXISTING ITEM IS BLUE / BLUE

DEMOLISHED ITEM IS RED

DA COLOURS TO
AS 1100.301-1985 & AS 2700S-1996

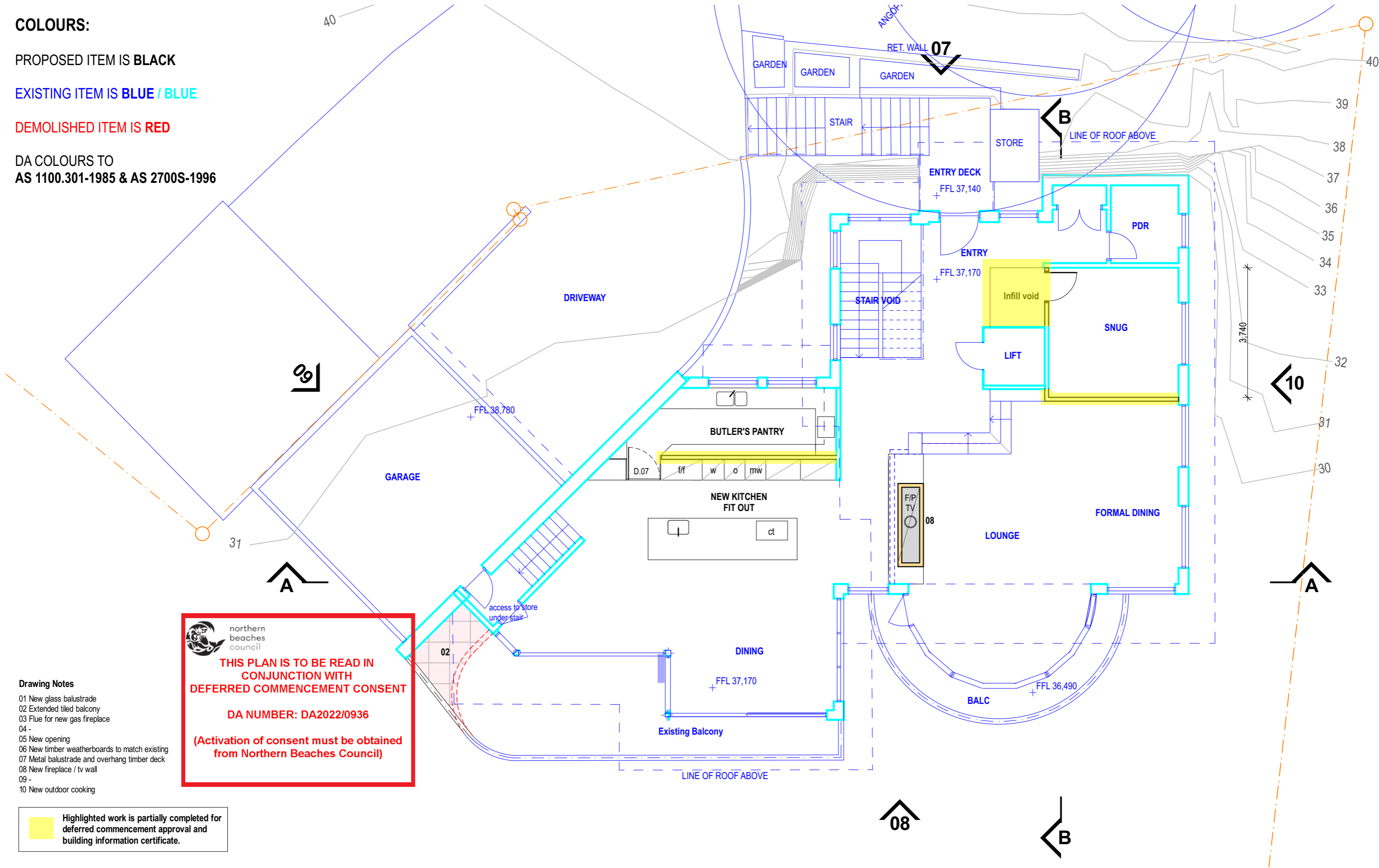

Drawing Notes

01 New glass balustrade

02 Extended tiled balcony

03 Flue for new gas fireplace

04 -

05 New opening

06 New timber weatherboards to match existing

07 Metal balustrade and overhang timber deck

08 New fireplace / tv wall

09 -

10 New outdoor cooking



Address:
Suite 206, 20 Dale Street
Brookvale NSW 2100
info@aaarchitect.com.au
www.aaarchitect.com.au
Mobile: 0412 348 575

Architect:
Adam Pressley FRAIA
Principal & Nominated Architect
NSW No.6007
ABN 95 492 673 232



Project:
Alterations & Additions

Printed: Monday, 23 May 2022
/Volumes/AAA Serv/01 Projects Active/39Sea/02 Models/
39Sea_Model.pln

Client:
Ron Thomson & Pamela Robertson-Gregg

39 Seaforth Crescent Seaforth 2092
Lot 11 & D.P.1026519

Title:
Level 1 Floor Plan
Scale 1:100 @ A3

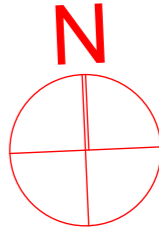

39Sea
DA.03

Issue:
Q

Amended DA Plans - For Approval

COLOURS:

PROPOSED ITEM IS BLACK

EXISTING ITEM IS BLUE / BLUE

DEMOLISHED ITEM IS RED

DA COLOURS TO
AS 1100.301-1985 & AS 2700S-1996



northern
beaches
council

THIS PLAN IS TO BE READ IN
CONJUNCTION WITH
DEFERRED COMMENCEMENT CONSENT

DA NUMBER: DA2022/0936

(Activation of consent must be obtained
from Northern Beaches Council)

- Drawing Notes
- 01 New glass balustrade
 - 02 Extended tiled balcony
 - 03 Flue for new gas fireplace
 - 04 -
 - 05 New opening
 - 06 New timber weatherboards to match existing
 - 07 Metal balustrade and overhang timber deck
 - 08 New fireplace / tv wall
 - 09 -
 - 10 New outdoor cooking

Highlighted work is partially completed for
deferred commencement approval and
building information certificate.



Address:
Suite 206, 20 Dale Street
Brookvale NSW 2100
info@aaarchitect.com.au
www.aaarchitect.com.au
Mobile: 0412 348 575

Architect:
Adam Pressley FRAIA
Principal & Nominated Architect
NSW No.6007

ABN 95 492 673 232



Project:
Alterations & Additions

Printed: Monday, 23 May 2022
/Volumes/AAA Serv/01 Projects Active/39Sea/02 Models/
39Sea_Model.pln

Client:
Ron Thomson & Pamela Robertson-Gregg

39 Seaforth Crescent Seaforth 2092
Lot 11 & D.P.1026519

Title:
Ground Floor Plan
Scale 1:100 @ A3
0 1 2 3 4 5

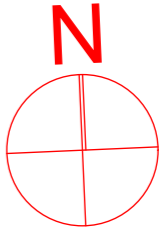

39Sea
DA.04

Issue:
Q

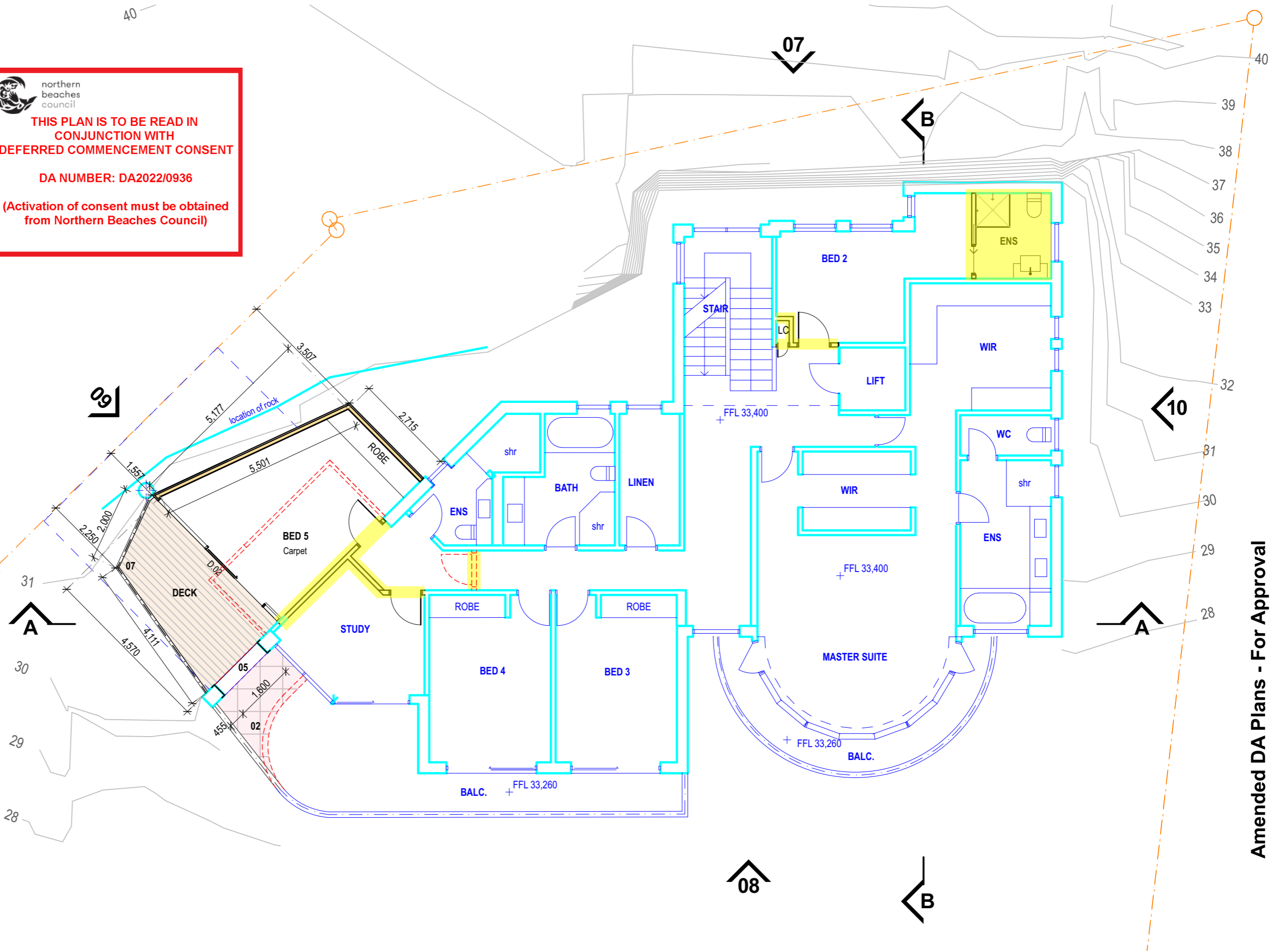

Amended DA Plans - For Approval

COLOURS:

PROPOSED ITEM IS BLACK

EXISTING ITEM IS BLUE / BLUE

DEMOLISHED ITEM IS RED

DA COLOURS TO
AS 1100.301-1985 & AS 2700S-1996



northern
beaches
council

THIS PLAN IS TO BE READ IN
CONJUNCTION WITH
DEFERRED COMMENCEMENT CONSENT

DA NUMBER: DA2022/0936

(Activation of consent must be obtained
from Northern Beaches Council)

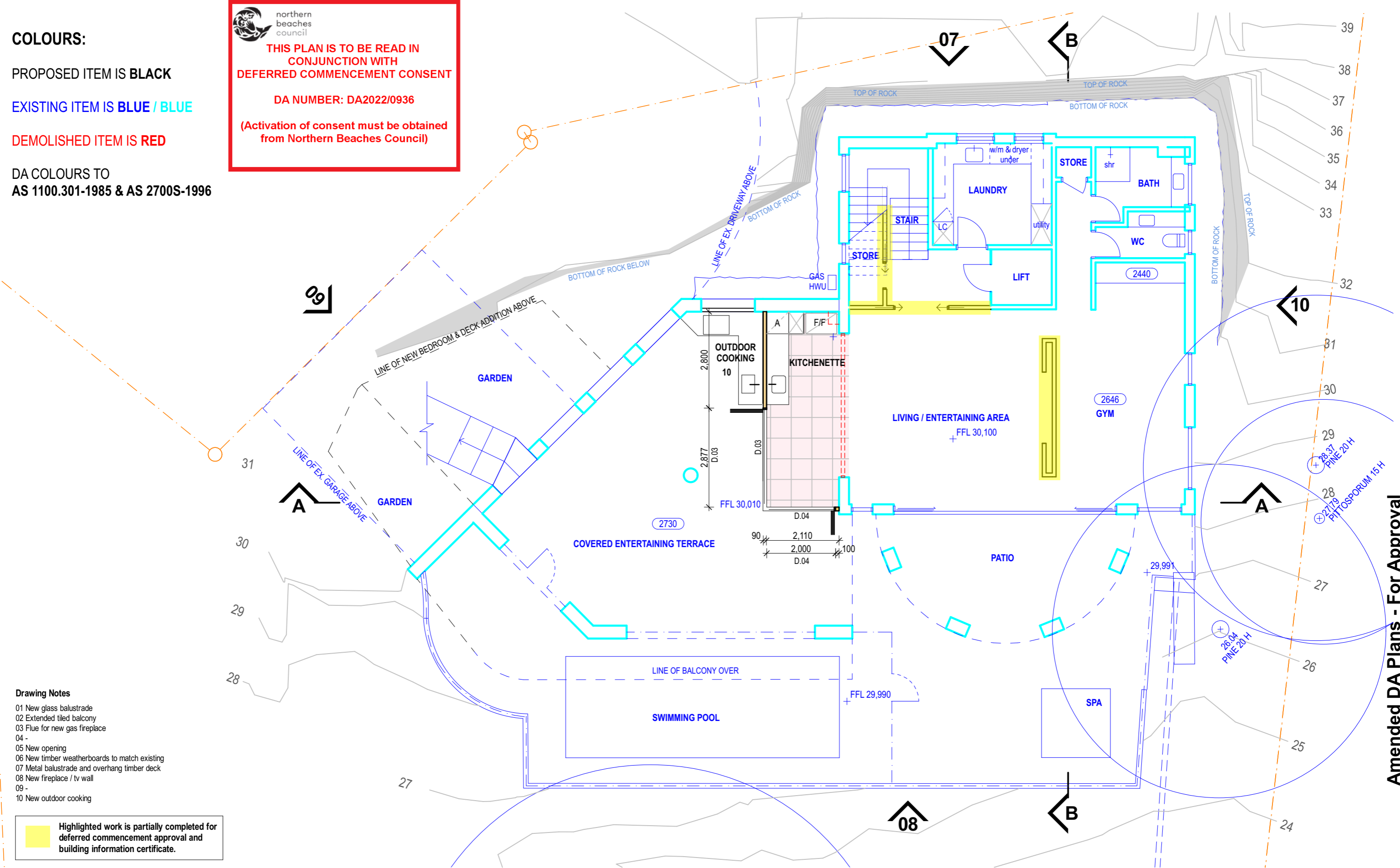

- Drawing Notes
- 01 New glass balustrade
 - 02 Extended tiled balcony
 - 03 Flue for new gas fireplace
 - 04 -
 - 05 New opening
 - 06 New timber weatherboards to match existing
 - 07 Metal balustrade and overhang timber deck
 - 08 New fireplace / tv wall
 - 09 -
 - 10 New outdoor cooking

Highlighted work is partially completed for deferred commencement approval and building information certificate.



Address:
Suite 206, 20 Dale Street
Brookvale NSW 2100
info@aaarchitect.com.au
www.aaarchitect.com.au
Mobile: 0412 348 575

Architect:
Adam Pressley FRAIA
Principal & Nominated Architect
NSW No.6007
ABN 95 492 673 232



Project:
Alterations & Additions

Printed: Monday, 23 May 2022
/Volumes/AAA Serv/01 Projects Active/39Sea/02 Models/
39Sea_Model.pln

Client:
Ron Thomson & Pamela Robertson-Gregg

39 Seaforth Crescent Seaforth 2092
Lot 11 & D.P.1026519

Title:
Lower Ground Floor Plan
Scale 1:100 @ A3

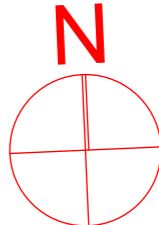
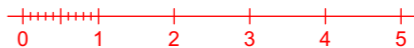

39Sea
DA.05

Issue:
Q

Amended DA Plans - For Approval

- 01 New glass balustrade
- 02 Extended tiled balcony
- 03 Flue for new gas fireplace
- 04 -
- 05 New opening
- 06 New timber weatherboards to match existing
- 07 Metal balustrade and overhang timber deck
- 08 New fireplace / tv wall
- 09 -
- 10 New outdoor cooking

Highlighted work is partially completed for deferred commencement approval and building information certificate.

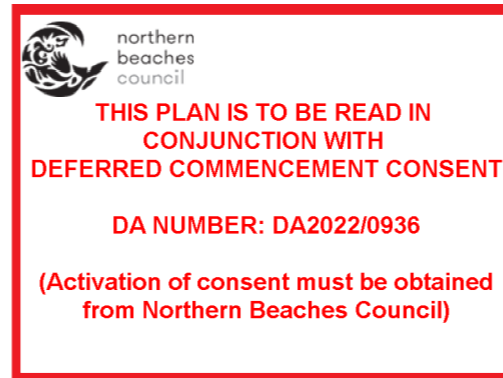

DA COLOURS TO
AS 1100.301-1985 & AS 2700S-1996

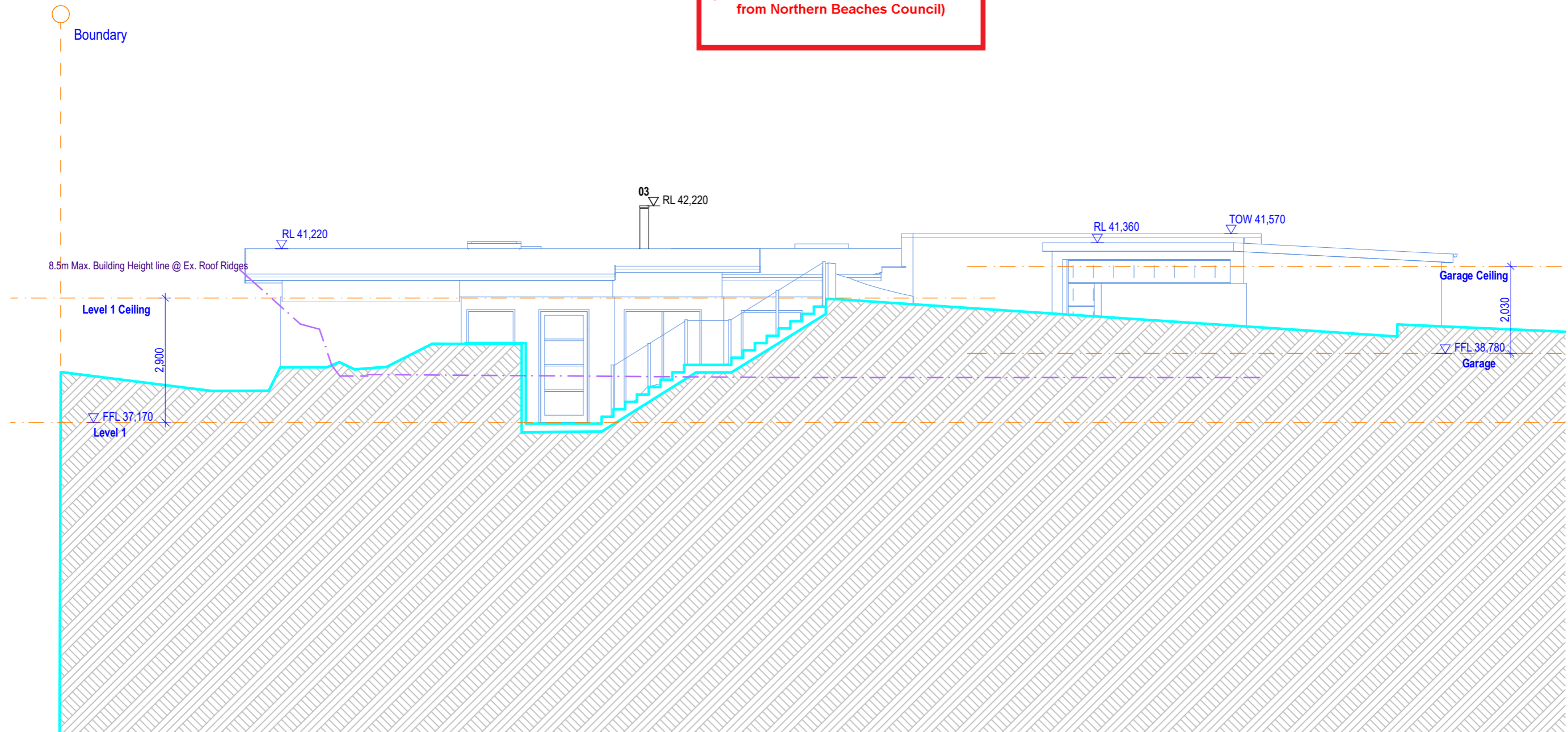

Amended DA Plans - For Approval



Address:
Suite 206, 20 Dale Street
Brookvale NSW 2100
info@aaarchitect.com.au
www.aaarchitect.com.au
Mobile: 0412 348 575

Architect:
Adam Pressley FRAIA
Principal & Nominated Architect
NSW No.6007

ABN 95 492 673 232



Project:
Alterations & Additions

Printed: Monday, 23 May 2022
/Volumes/AAA Serv/01 Projects Active/39Sea/02 Models/
39Sea_Model.pln

Client:
Ron Thomson & Pamela Robertson-Gregg

39 Seaforth Crescent Seaforth 2092
Lot 11 & D.P.1026519

Title:

North / Street Elevation

Scale 1:100 @ A3

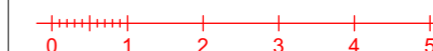

39Sea
DA.06

Issue:
Q

- 01 New glass balustrade
- 02 Extended tiled balcony
- 03 Flue for new gas fireplace
- 04 -
- 05 New opening
- 06 New timber weatherboards to match existing
- 07 Metal balustrade and overhang timber deck
- 08 New fireplace / tv wall
- 09 -
- 10 New outdoor cooking

Highlighted work is partially completed for deferred commencement approval and building information certificate.



northern
beaches
council

**THIS PLAN IS TO BE READ IN
CONJUNCTION WITH
DEFERRED COMMENCEMENT CONSENT**

DA NUMBER: DA2022/0936

(Activation of consent must be obtained from Northern Beaches Council)

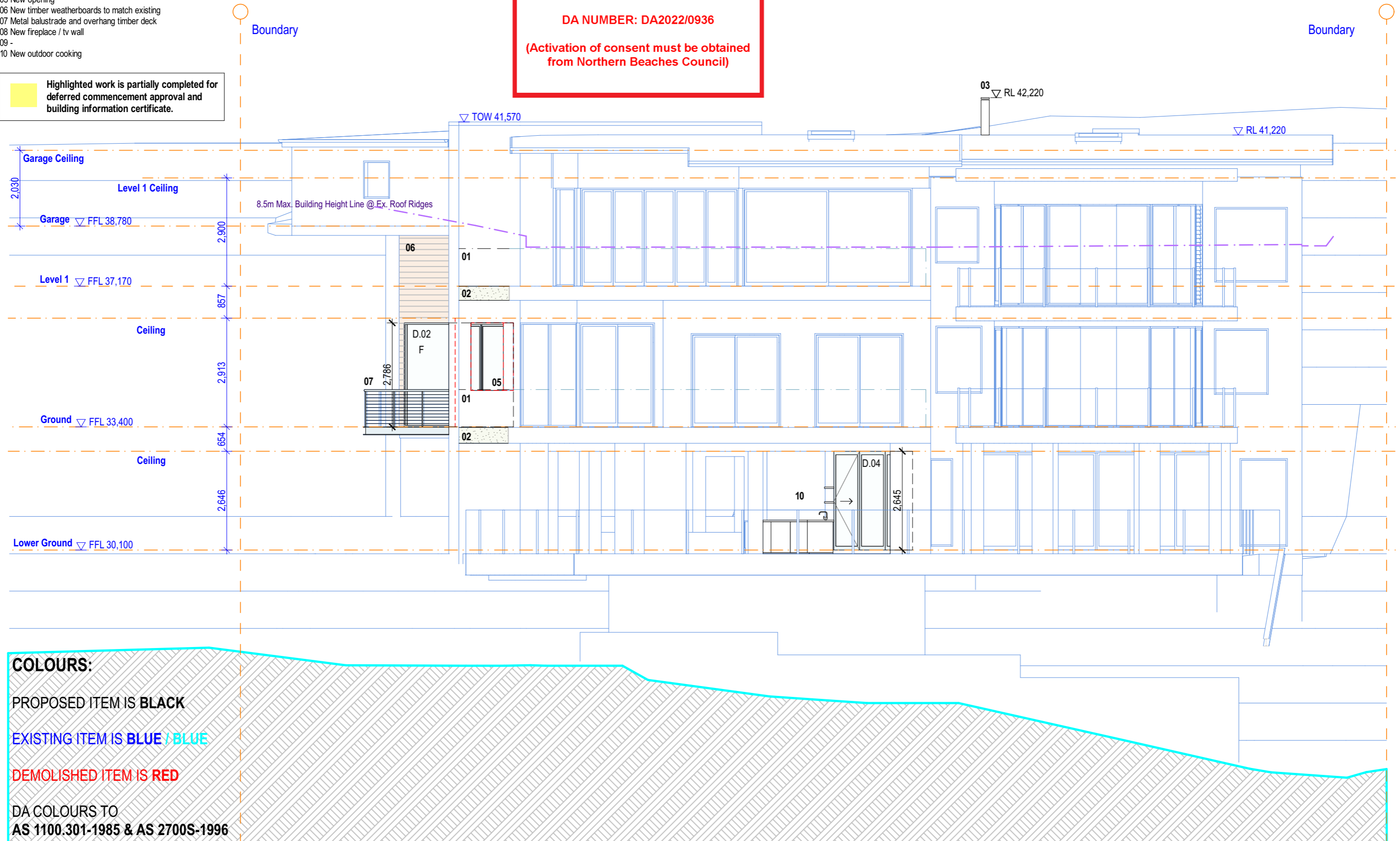

COLOURS:

PROPOSED ITEM IS **BLACK**

EXISTING ITEM IS BLUE / BLUE

DEMOLISHED ITEM IS RED

DA COLOURS TO
AS 1100.301-1985 & AS 2700S-1996



Address:
Suite 206, 20 Dale Street
Brookvale NSW 2100
info@aaarchitect.com.au
www.aaarchitect.com.au
Mobile: 0412 348 575

Architect:
Adam Pressley FRAIA
Principal & Nominated Architect
NSW No.6007

ABN 95 492 673 232



Project:
Alterations & Additions

Printed: Monday, 23 May 2022
/Volumes/AAA Serv/01 Projects Active/39Sea/02 Models/
39Sea_Model.pln

Client:
Ron Thomson & Pamela Robertson-Gregg

39 Seaforth Crescent Seaforth 2092
Lot 11 & D.P.1026519

Title:

South Elevation

Scale 1:100 @ A3



39Sea

DA.07

Issue:

Q

Amended DA Plans - For Approval

- Drawing Notes**
- 01 New glass balustrade
 - 02 Extended tiled balcony
 - 03 Flue for new gas fireplace
 - 04 -
 - 05 New opening
 - 06 New timber weatherboards to match existing
 - 07 Metal balustrade and overhang timber deck
 - 08 New fireplace / tv wall
 - 09 -
 - 10 New outdoor cooking

Highlighted work is partially completed for deferred commencement approval and building information certificate.

 **northern beaches council**

THIS PLAN IS TO BE READ IN CONJUNCTION WITH DEFERRED COMMENCEMENT CONSENT

DA NUMBER: DA2022/0936

(Activation of consent must be obtained from Northern Beaches Council)

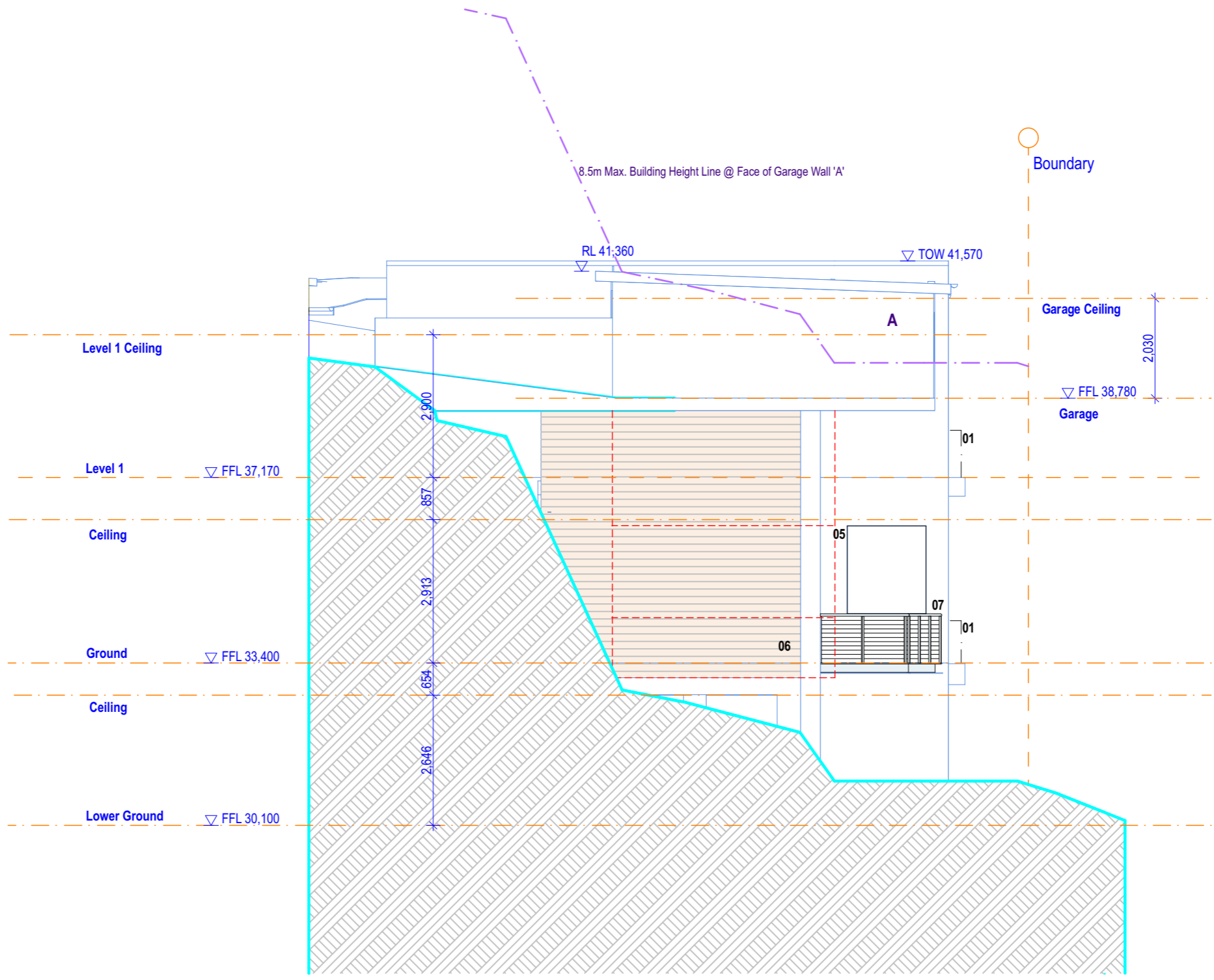

COLOURS:

PROPOSED ITEM IS **BLACK**

EXISTING ITEM IS **BLUE / BLUE**

DEMOLISHED ITEM IS **RED**

DA COLOURS TO
AS 1100.301-1985 & AS 2700S-1996

Amended DA Plans - For Approval

 **ALL AUSTRALIAN ARCHITECTURE**

Address:
Suite 206, 20 Dale Street
Brookvale NSW 2100
info@aaarchitect.com.au
www.aaarchitect.com.au
Mobile: 0412 348 575

Architect:
Adam Pressley FRAIA
Principal & Nominated Architect
NSW No.6007

ABN 95 492 673 232



Project:
Alterations & Additions

Printed: Monday, 23 May 2022
/Volumes/AAA Serv/01 Projects Active/39Sea/02 Models/
39Sea_Model.pln

Client:
Ron Thomson & Pamela Robertson-Gregg

39 Seaforth Crescent Seaforth 2092
Lot 11 & D.P.1026519

Title:
West Elevation
Scale 1:100 @ A3

0 1 2 3 4 5

39Sea
DA.08

Issue:
Q

Drawing Notes

- 01 New glass balustrade
- 02 Extended tiled balcony
- 03 Flue for new gas fireplace
- 04 -
- 05 New opening
- 06 New timber weatherboards to match existing
- 07 Metal balustrade and overhang timber deck
- 08 New fireplace / tv wall
- 09 -
- 10 New outdoor cooking

Highlighted work is partially completed for deferred commencement approval and building information certificate.



northern
beaches
council

THIS PLAN IS TO BE READ IN
CONJUNCTION WITH
DEFERRED COMMENCEMENT CONSENT

DA NUMBER: DA2022/0936

(Activation of consent must be obtained
from Northern Beaches Council)

COLOURS:

PROPOSED ITEM IS **BLACK**

EXISTING ITEM IS **BLUE / BLUE**

DEMOLISHED ITEM IS **RED**

DA COLOURS TO
AS 1100.301-1985 & AS 2700S-1996



Amended DA Plans - For Approval



Address:
Suite 206, 20 Dale Street
Brookvale NSW 2100
info@aaarchitect.com.au
www.aaarchitect.com.au
Mobile: 0412 348 575

Architect:
Adam Pressley FRAIA
Principal & Nominated Architect
NSW No.6007
ABN 95 492 673 232



Project:
Alterations & Additions

Printed: Monday, 23 May 2022
/Volumes/AAA Serv/01 Projects Active/39Sea/02 Models/
39Sea_Model.pln

Client:
Ron Thomson & Pamela Robertson-Gregg

39 Seaforth Crescent Seaforth 2092
Lot 11 & D.P.1026519

Title:
East Elevation
Scale 1:100 @ A3



39Sea
DA.09

Issue:
Q

- Drawing Notes**
- 01 New glass balustrade
 - 02 Extended tiled balcony
 - 03 Flue for new gas fireplace
 - 04 -
 - 05 New opening
 - 06 New timber weatherboards to match existing
 - 07 Metal balustrade and overhang timber deck
 - 08 New fireplace / tv wall
 - 09 -
 - 10 New outdoor cooking

Highlighted work is partially completed for deferred commencement approval and building information certificate.



northern
beaches
council

**THIS PLAN IS TO BE READ IN
CONJUNCTION WITH
DEFERRED COMMENCEMENT CONSENT**

DA NUMBER: DA2022/0936

**(Activation of consent must be obtained
from Northern Beaches Council)**

COLOURS:

PROPOSED ITEM IS **BLACK**

EXISTING ITEM IS **BLUE / BLUE**

DEMOLISHED ITEM IS **RED**

DA COLOURS TO
AS 1100.301-1985 & AS 2700S-1996

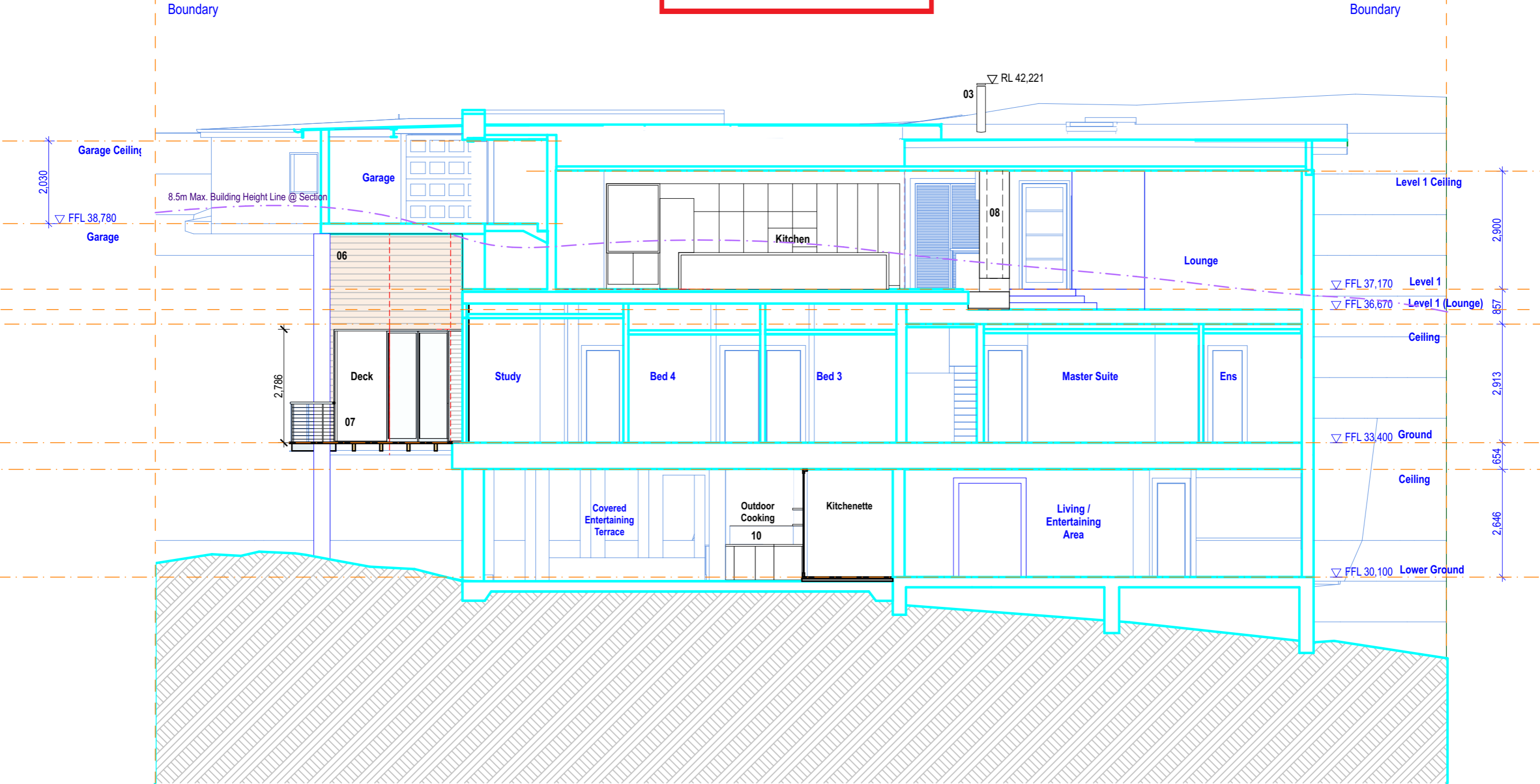

Amended DA Plans - For Approval



Address:
Suite 206, 20 Dale Street
Brookvale NSW 2100
info@aaarchitect.com.au
www.aaarchitect.com.au
Mobile: 0412 348 575

Architect:
Adam Pressley FRAIA
Principal & Nominated Architect
NSW No.6007
ABN 95 492 673 232



Project:
Alterations & Additions
Printed: Monday, 23 May 2022
/Volumes/AAA Serv/01 Projects Active/39Sea/02 Models/
39Sea_Model.pln

Client:
Ron Thomson & Pamela Robertson-Gregg
39 Seaforth Crescent Seaforth 2092
Lot 11 & D.P.1026519

Title:
Section AA
Scale 1:100 @ A3
0 1 2 3 4 5

39Sea
DA.10
Issue:
Q

Drawing Notes

- 01 New glass balustrade
- 02 Extended tiled balcony
- 03 Flue for new gas fireplace
- 04 -
- 05 New opening
- 06 New timber weatherboards to match existing
- 07 Metal balustrade and overhang timber deck
- 08 New fireplace / tv wall
- 09 -
- 10 New outdoor cooking

Highlighted work is partially completed for deferred commencement approval and building information certificate.



THIS PLAN IS TO BE READ IN CONJUNCTION WITH DEFERRED COMMENCEMENT CONSENT

DA NUMBER: DA2022/0936

(Activation of consent must be obtained from Northern Beaches Council)

COLOURS:

PROPOSED ITEM IS BLACK

EXISTING ITEM IS BLUE / BLUE

DEMOLISHED ITEM IS RED

DA COLOURS TO AS 1100.301-1985 & AS 2700S-1996

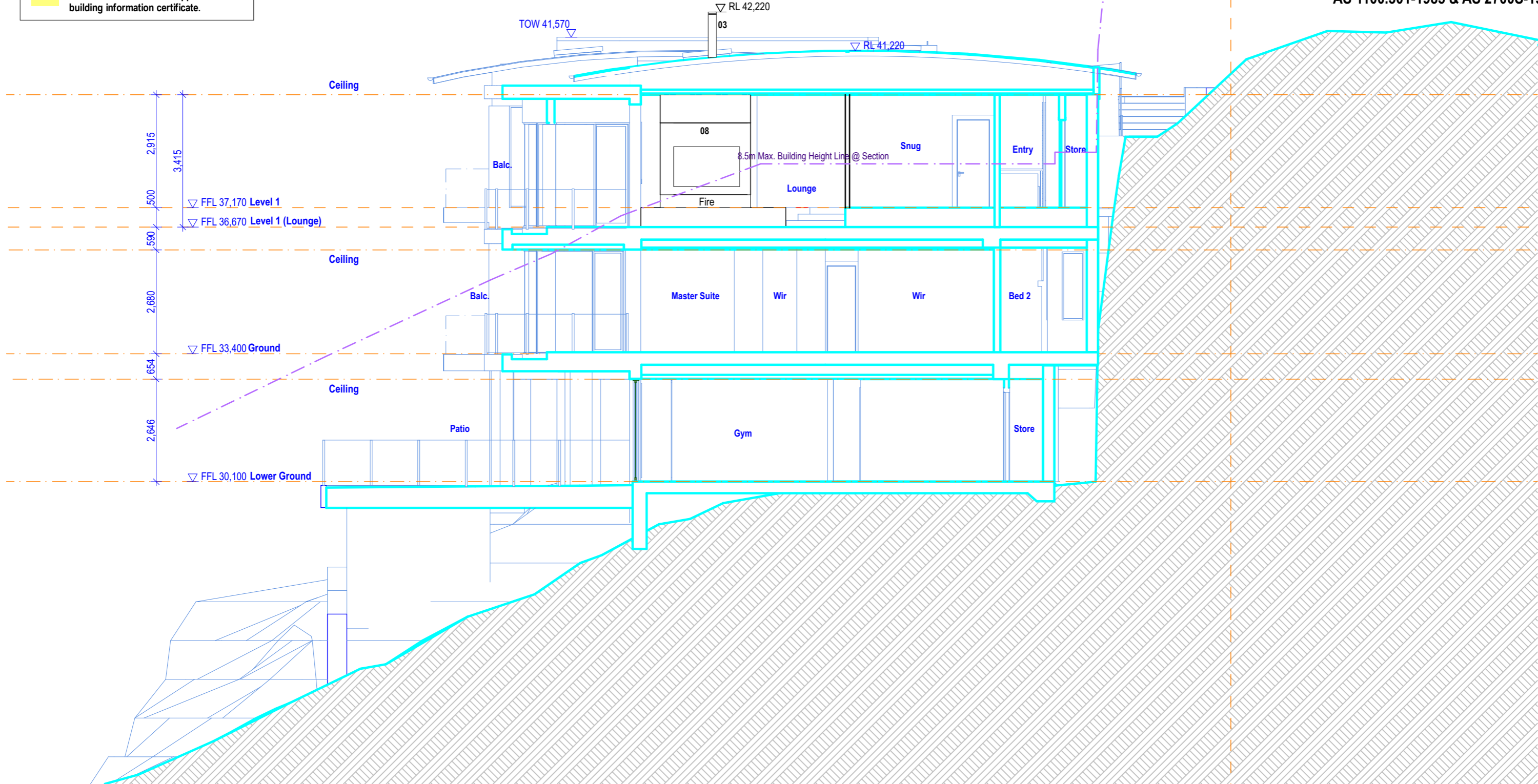

Amended DA Plans - For Approval



Address:
Suite 206, 20 Dale Street
Brookvale NSW 2100
info@aaarchitect.com.au
www.aaarchitect.com.au
Mobile: 0412 348 575

Architect:
Adam Pressley FRAIA
Principal & Nominated Architect
NSW No.6007
ABN 95 492 673 232



Project:
Alterations & Additions

Printed: Monday, 23 May 2022
/Volumes/AAA Serv/01 Projects Active/39Sea/02 Models/
39Sea_Model.pln

Client:
Ron Thomson & Pamela Robertson-Gregg

39 Seaforth Crescent Seaforth 2092
Lot 11 & D.P.1026519

Title:
Section BB
Scale 1:100 @ A3



39Sea
DA.11

Issue:
Q