

- (B) - EASEMENT TO DRAIN WATER 1.3 WIDE
- (C) - EASEMENT FOR SERVICES 1.3 WIDE
- (D) - EASEMENT TO DRAIN WATER 6.4 WIDE
- (E) - RIGHT OF CARRIAGEWAY 1.56 WIDE & VARIABLE
- (F) - EASEMENT FOR SERVICES 1.56 WIDE & VARIABLE
- (G) - EASEMENT TO DRAIN WATER 1.56 WIDE & VARIABLE
- (H) - RIGHT OF CARRIAGEWAY 1.44 WIDE
- (J) - EASEMENT FOR DRAINAGE 1.83 WIDE
- (X) - HEIGHT RESTRICTED AREA VARIABLE WIDTH LIMITED IN HEIGHT TO RL114.27 AHD



- LEGEND**
- BM - BENCH MARK
 - C - CONCRETE
 - ELEC - ELECTRICITY KIOSK
 - GR - GRATE (PIT)
 - H - WINDOW HEADER
 - HYD - HYDRANT
 - KOP - KERB OUTLET POINT
 - LNT - KERB INLET PIT/LINTEL
 - LP - LIGHT POLE
 - PC - PRAM CROSSING
 - S - WINDOW SILL
 - SIP - SEWER INSPECTION POINT
 - SMH - SEWER MANHOLE
 - SV - STOP VALVE
 - TEL - TELECOMMUNICATIONS PIT
 - TK - TOP KERB
 - TW - TOP OF WALL
 - VC - VEHICLE CROSSING
 - WM - WATER METER
 - 5/0.3 - TREE 5m SPREAD 0.3m TRUNK

© APEX SURVEYING PTY LTD
 NO PART OF THIS SURVEY MAY BE REPRODUCED, STORED IN A RETRIEVAL SYSTEM OR TRANSMITTED IN ANY FORM WITHOUT THE EXPRESS PERMISSION OF THE CREATOR UNDER THE COPYRIGHT ACT 1968. THE SURVEY IS FOR THE EXPRESS USE OF THE CLIENT IDENTIFIED IN THE TITLE BLOCK ONLY.

NOTE:

- * THIS PLAN HAS BEEN PREPARED FROM A COMBINATION OF FIELD SURVEY AND EXISTING RECORDS
- * THE LOCATION OF CERTAIN FEATURES & IMPROVEMENTS SHOWN HEREON MAY BE INDICATIVE & THERE IS NO GUARANTEE OF THEIR SPATIAL ACCURACY
- * THE TITLE BOUNDARIES SHOWN HEREIN HAVE BEEN DETERMINED BY SURVEY
- * PRIOR TO ANY DEMOLITION, EXCAVATION OR CONSTRUCTION ON THE SITE, THE RELEVANT AUTHORITY SHOULD BE CONTACTED FOR POSSIBLE LOCATION OF FURTHER UNDERGROUND SERVICES AND DETAILED LOCATION OF ALL SERVICES
- * CONTOURS HAVE BEEN INTERPOLATED FROM SPOT HEIGHTS TAKEN AND ARE APPROXIMATE ONLY
- * THIS NOTE IS AN INTEGRAL PART OF THIS PLAN. ANY RE-PRODUCTION OF THE INFORMATION CONTAINED IN THIS FILE MUST DISPLAY THIS NOTE

CONTACT DIAL BEFORE YOU DIG PH: 1100, PRIOR TO ANY EXCAVATION



Suite 6, 16 HILL STREET, CAMDEN NSW 2570
 POSTAL ADDRESS: P.O. BOX 659 CAMDEN NSW 2570
 Ph: (02) 4655 9485 Fax: (02) 4655 9487
 Email: admin@apexsurveying.com.au
 www.apexsurveying.com.au

DATUM	AHD	SCALE	1:100 ON A2	DRAWN	DF
ORIGIN OF LEVELS	PM 2765	SUBURB	FORESTVILLE	SURVEYED	DF & JH
CONTOUR INTERVAL	N/A	L.G.A.	NORTHERN BEACHES	DATE:	7/06/2023
CLIENT: FAIRMONT HOMES				SHEET NO.	1 OF 1 SHEETS

PLAN OF DETAIL SURVEY OVER LOT 141 IN DP 1039441 AT No.9 FERGUSON STREET, FORESTVILLE

SURVEYORS REFERENCE 23300

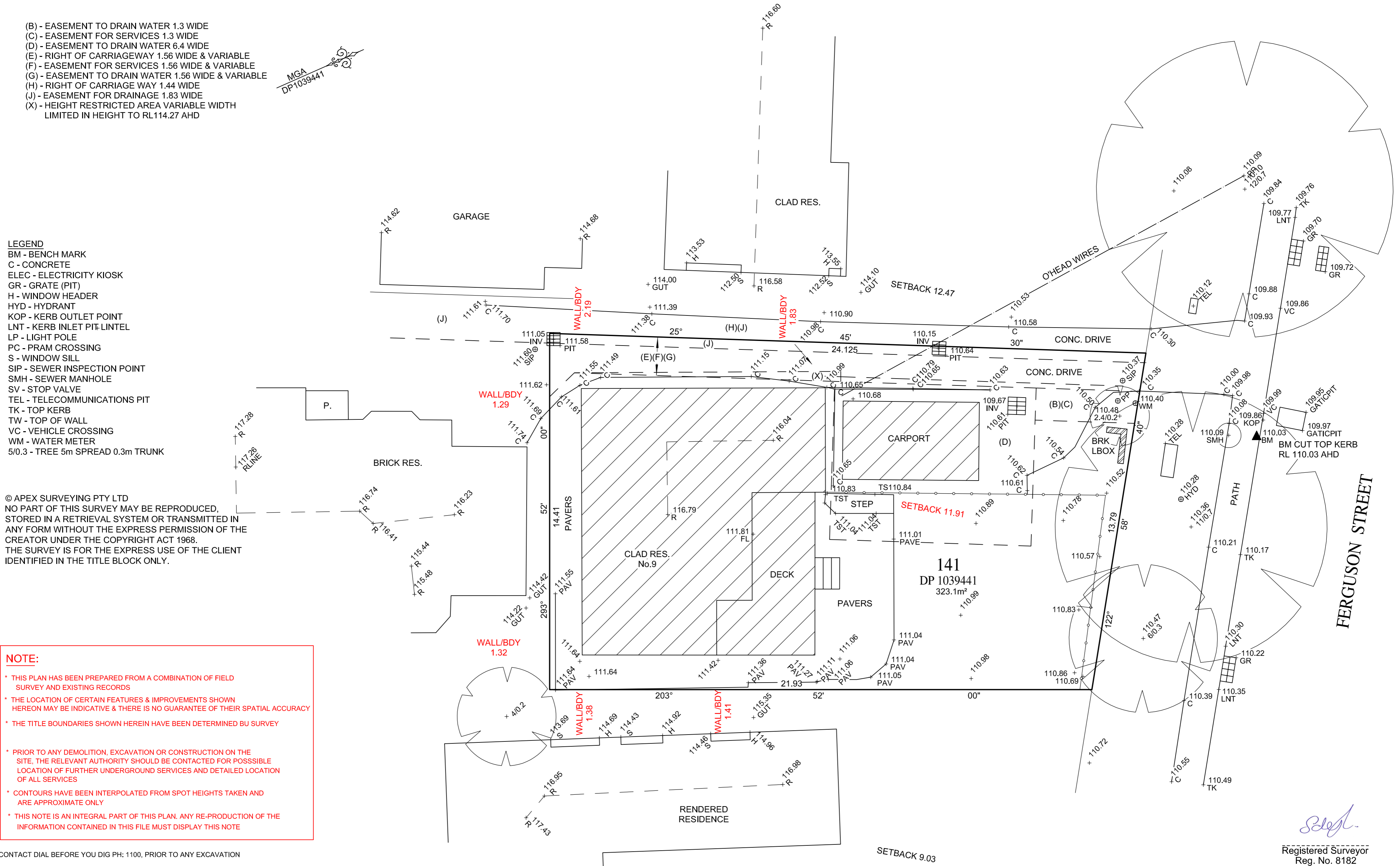

Selet
 Registered Surveyor
 Reg. No. 8182